



Interoffice Memorandum

05-16-19A11:00 RCVD

05-16-19A11:14 RCVD

DATE: May 15, 2019

TO: Katie A. Smith, Deputy Clerk of the Board of County Commissioners, County Comptroller's Office

THROUGH: Cheryl Gilléspeie, Supervisor, Agenda Development Office

FROM: Alberto A. Vargas, MArch., Manager, Planning Division

CONTACT PERSON: Eric Raasch, Interim DRC Chairman Development Review Committee Planning Division (407) 836-5523 or Eric.RaaschJr@ocfl.net

SUBJECT: Request for Board of County Commissioners (BCC) Public Hearing

Note: Schedule this public hearing concurrently with PSP-16-12-421, CAI-17-04-014, and RAG-18-02-008

Applicant: Adam Smith, VHB, Inc.

Case Information: Lake Reams Neighborhood Planned Development / Land Use Plan (PD / LUP) – Case # CDR-15-10-293

Type of Hearing: Substantial Change

Commission District: 1

General Location: East of the Reams Road & Ficquette Road intersection

BCC Public Hearing Required by: Orange County Code, Chapter 38, Article VIII, Division 1, Section 38-1207

**Clerk's Advertising
Requirements:**

(1) At least 15 days before the BCC public hearing date, publish an advertisement in the Legal Notices section of *The Orlando Sentinel* describing the particular request, the general location of the subject property, and the date, time, and place when the BCC public hearing will be held;

and

(2) At least 10 days before the BCC public hearing date, send notices of BCC public hearing by U.S. mail to owners of property within 300 feet of the subject property and beyond.

Spanish Contact Person:

IF YOU HAVE ANY QUESTIONS REGARDING THIS NOTICE, CONTACT THE ORANGE COUNTY PLANNING DIVISION: Front Desk, 407-836-8181

PARA MÁS INFORMACIÓN, REFERENTE A ESTA VISTA PUBLICA CON RESPECTO A UNA AUDENCIA PUBLICA SOBRE PROPIEDAD EN SU AREA/VECINDAD, FAVOR COMUNICARSE CON LA DIVISIÓN DE PLANIFICACION, AL NUMERO, 407-836-8181

Advertising Language:

A PD substantial change to modify the wetland boundary and acres, to accurately reflect CAD-15-05-066, to increase Parcel 25 acreage and change the land use district from Upland Greenbelt / Wetlands to Estate District allowing 74 residential units.

In addition, the following waiver from Orange County Code is requested:

A waiver from Section 38-1385(b)(4) to allow a minimum lot width of sixty (60) feet, in lieu of eighty-five (85) feet.

Material Provided:

- (1) Names and last known addresses of property owners within 300 feet and beyond (*via email from Fiscal and Operational Support Division*); and
- (2) Location map (*to be mailed to property owners*).

Special instructions to the Clerk:

Please place this request on the **June 18, 2019** BCC agenda. Unless stated otherwise, the public hearing should be advertised to begin at 2:00 p.m., or as soon thereafter as the matter may be heard.

Attachment (location map)

c: Chris R. Testerman, AICP, Deputy County Administrator
Jon V. Weiss, Director, Planning, Environmental, and Development Services
Department

Location Map

CDR-15-10-293

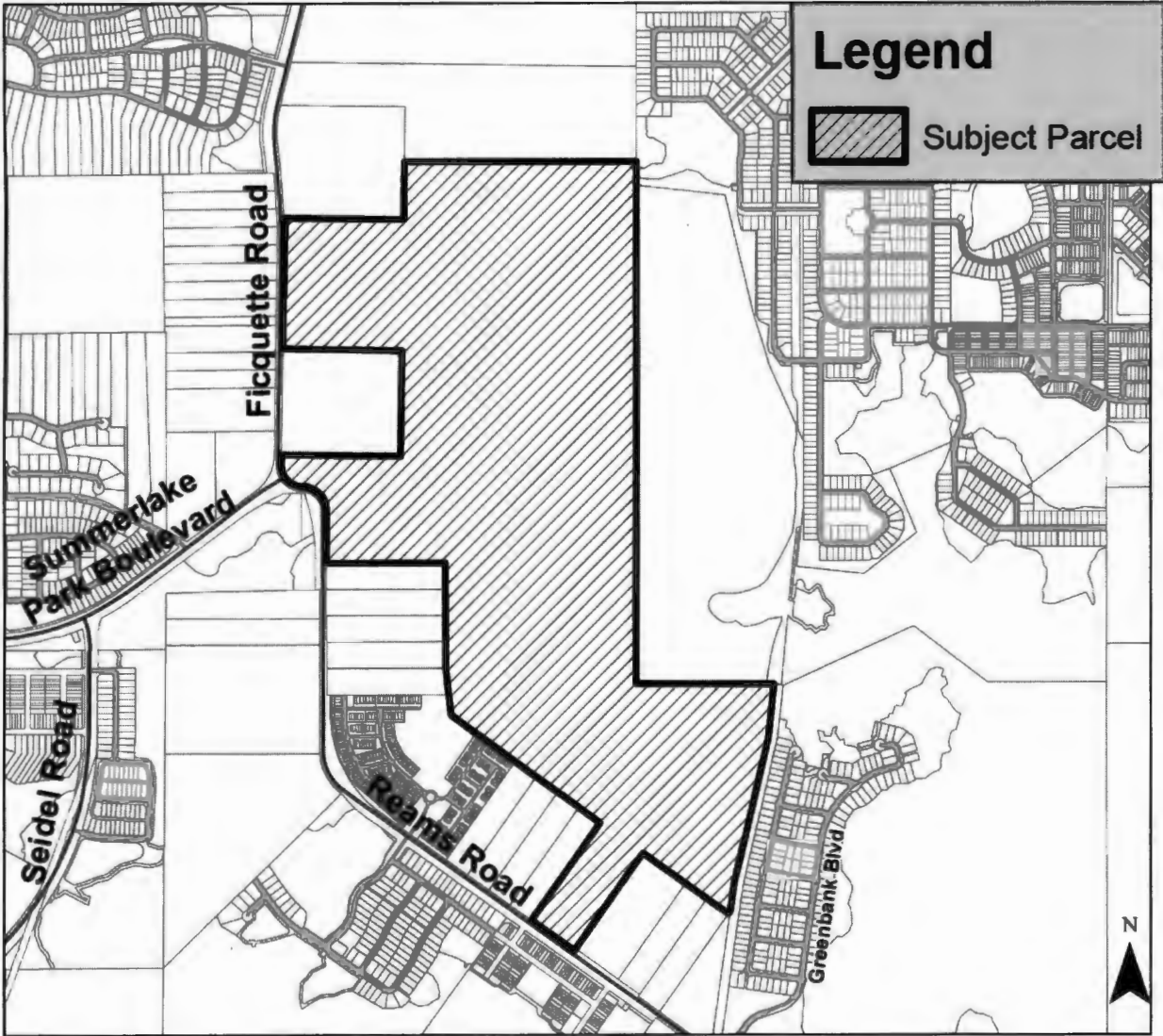

If you have any questions regarding this map, please call the Planning Division at 407-836-5600.

Legal Description

CDR-15-10-293

10292/8716 RECORDED WITHOUT A LEGAL-PORTION OF LAND LYING IN SECTIONS 26 27 34 & 35-23-27 DESC AS COMM NE COR SEC 27 TH W 489.22 FT TO E R/W FICQUETTE RD TH SLY ALONG R/W 3423.12 FT FOR POB TH RUN E 1005.84 FT N 481.08 FT E 1950.56 FT S 79.46 FT TO S LINE OF NW1/4 SEC 26 TH E 1321.59 FT S 2648.24 FT E 10 FT S 144.57 FT S 06 DEG W 1947.10 FT S 13 DEG W 1244.92 FT S 08 DEG W 233.29 FT S 35 DEG W 30.47 FT N 54 DEG W 880 FT S 35 DEG W 1000 FT TO NELY R/W REAMS RD TH N 54 DEG W 440 FT N 35 DEG E 1000 FT N 54 DEG W 1540 FT N 06 DEG W 393.84 FT N 880 FT W 1000 FT N 440 FT NWLY 320.38 FT NWLY 277.01 FT N 84.67 FT E 1000 FT N 880 FT W 1000 FT N 1029.30 FT N 03 DEG W 70.94 FT TO POB (LESS THAT PART OF SW1/4 OF SEC 26-23-27 DESC IN OR 7509/4525) & (LESS COMM AT NE COR OF SEC 35-23-27 TH RUN S00-03-26E 1619.73 FT TH S89-56-39W 999.90 FT TH N52-53-29W 778.01 FT TH S65-32-44W 1196.87 FT TH S83-35-17W 80.15 FT TH N89-57-55W 1164.37 FT TH N00-02-05E 4162.54 FT TH S83-57-32E 749.16 FT TH S13-22-57E 1020.80 FT TH S17-34-34E 467.95 FT TH S24-27-42E 681.41 FT TH S00-02-58W 537.95 FT TH S06-24-22W 507.86 FT TH S83-35-38E 567.99 FT TH N52-22-11E 561.70 FT TH S55-18-20E 511.14 FT TH S15-55-15E 159.28 FT TH S55-18-20E 511.14 FT TH S15-55-15E 159.28 FT TH S55-18-20E 511.14 FT TH N53-22-39E 834.18 FT TH S00-36-37W 505.32 FT TO POB)