



Interoffice Memorandum

RCUD

JUN15'20PM4:52

DATE: June 15, 2020

TO: Katie A. Smith, Deputy Clerk of the Board of County Commissioners, County Comptroller's Office

THROUGH: Cheryl Gillespie, Supervisor, Agenda Development Office

FROM: Alberto A. Vargas, MArch., Manager, Planning Division

CONTACT PERSON: Eric Raasch, DRC Chairman
Development Review Committee
Planning Division
(407) 836-5523 or Eric.RaaschJr@ocfl.net

SUBJECT: Request for Board of County Commissioners (BCC) Public Hearing

Applicant: Mary D. Solik, Doty Solik Law, P.A.

Case Information: Case # LUP-19-01-044 (West Orange Environmental Resources C&D Disposal & Recycling Facility / Communication Tower Planned Development / Land Use Plan)
Planning and Zoning Commission (PZC)
Meeting Date: June 5, 2020

Type of Hearing: Rezoning Public Hearing

Commission District: 1

General Location: North of Schofield Road, east of SR 429, and west of Avalon Road

BCC Public Hearing Required by: Orange County Code, Chapter 30

LEGISLATIVE FILE # 20-821

July 28, 2020
@ 2pm

**Clerk's Advertising
Requirements:**

(1) At least 15 days before the BCC public hearing date, publish an advertisement in the Legal Notices section of *The Orlando Sentinel* describing the particular request, the general location of the subject property, and the date, time, and place when the BCC public hearing will be held;

and

(2) At least 10 days before the BCC public hearing date, send notices of BCC public hearing by U.S. mail to owners of property within 300 feet of the subject property and beyond.

Spanish Contact Person:

IF YOU HAVE ANY QUESTIONS REGARDING THIS NOTICE, CONTACT THE ORANGE COUNTY PLANNING DIVISION: Front desk, 407-836-8181

PARA MÁS INFORMACIÓN, REFERENTE A ESTA VISTA PUBLICA CON RESPECTO A UNA AUDENCIA PUBLICA SOBRE PROPIEDAD EN SU AREA/VECINDAD, FAVOR COMUNICARSE CON LA DIVISIÓN DE PLANIFICACION, AL NUMERO, 407-836-8181

Advertising Language:

To rezone 44.02 gross acres from A-1 (Citrus Rural District) to PD (Planned Development District) to allow the use of an existing landfill and a new 140-foot tall monopole communication tower.

Material Provided:

- (1) Names and last known addresses of property owners within 300 feet and beyond (*via email from Fiscal and Operational Support Division*); and
- (2) Location map (*to be mailed to property owners*).

Special instructions to the Clerk:

Please place this request on the next available BCC agenda. Unless stated otherwise, the public hearing should be advertised to begin at 2:00 p.m., or as soon thereafter as the matter may be heard.

Attachment (location map)

c: Chris R. Testerman, AICP, Deputy County Administrator
Jon V. Weiss, Director, Planning, Environmental, and Development Services,
Department

Legal Description

LUP-19-01-044

**West Orange Environmental Resources C&D Disposal & Recycling Facility / Communication
Tower PD**

Parcel #: 29-23-27-0000-00-008

S 5/8 OF W1/2 OF SW1/4 SEC 29-23-27 & (LESS COMM AT THE SW CORNER OF THE SW 1/4 SEC 29-23-27 TH N00-08-21W 60 FT TO THE POB TH CONT N00-08-21W 30 FT TH N86-29-36E 265.63 FT TO A POC OF A TANGENT CURVE CONCAVE SELY HAVING A RADIUS 7692 FT DELTA 03-07-55 AN ARC LENGTH 420.45 FT TH N89-37-31E 534.23 FT TH N44-35-49E 35.34 FT TH N00-25-52W 1513.61 FT TH N89-42-11E 54 FT TH S00-25-52E 1594.53 FT TH S89-37-31W 1298.89 FT TO THE POB SEE 10872/0775)

Location Map

LUP-19-01-044

**West Orange Environmental Resources C&D Disposal & Recycling Facility / Communication
Tower PD**

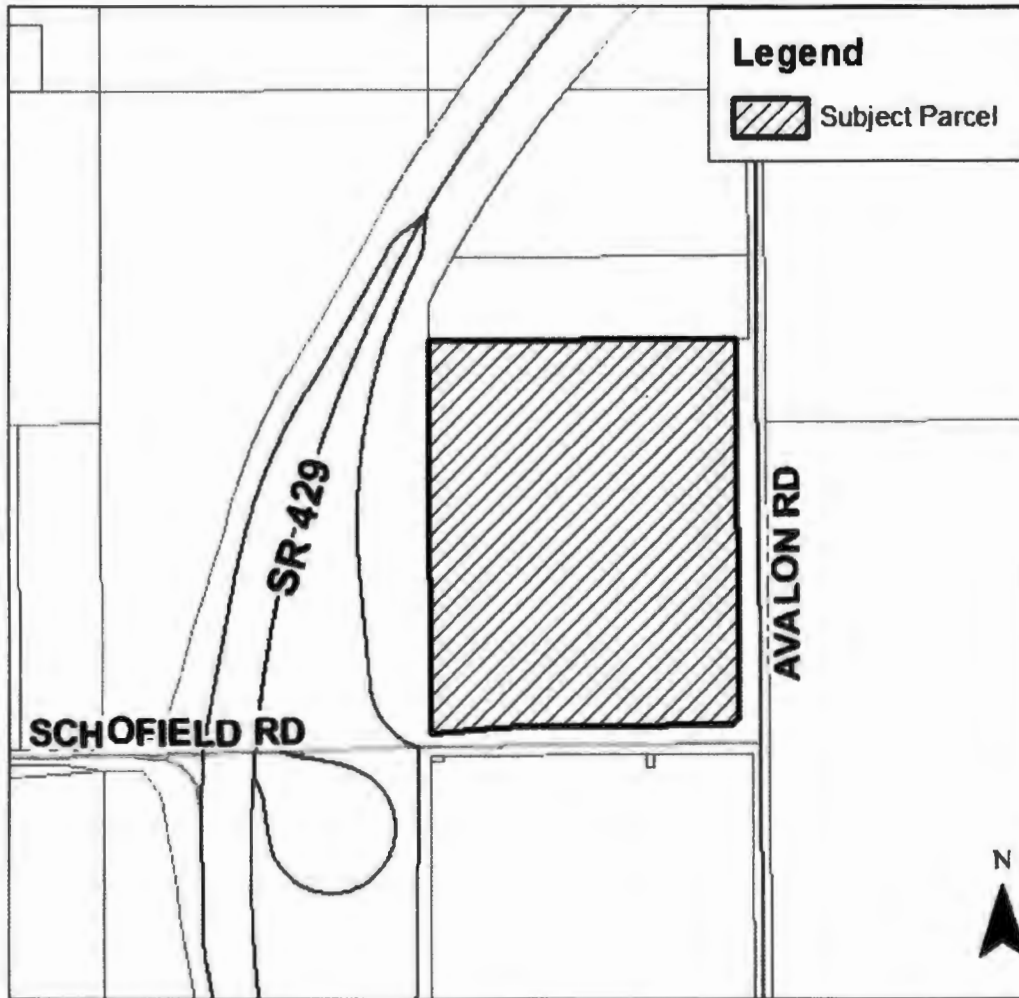

**If you have any questions regarding
this map, please call the Planning
Division at 407-836-5600.**