



**OFFICE OF COMPTROLLER**

**INTEROFFICE MEMO**

**ORANGE  
COUNTY  
FLORIDA**

**Phil Diamond, CPA**  
**County Comptroller**  
Finance and Accounting Department  
Special Assessments  
PO Box 38  
Orlando, FL 32802  
Telephone: 407-836-5770  
Fax: 407-836-5753

Date: August 11, 2023

To: Mayor Jerry L. Demings  
and  
County Commissioners

From: Eric Gassman, Chief Deputy Comptroller 

Contact: Ann Dawkins, 407-836-5770

Subject: Public Hearing to amend the existing Municipal Service Taxing Unit (MSTU) for General Lake Cleaning Maintenance, Aquatic Plant Control to include Navigational Improvements

MSTU District: **Lake Pickett**

Applicant: Elizabeth R. Johnson  
Environmental Protection Division (EPD)

District: Commissioner Emily Bonilla, District 5

Report: The attached resolution will amend the Lake Pickett Municipal Service Taxing Unit (MSTU) for General Lake Cleaning Maintenance and Aquatic Plant Control to allow additional authorized use of funds in the MSTU (Municipal Service Taxing Unit) for navigational improvements.

Effective Date: This amendment does not change the current ad valorem assessment.

Action Requested: Approval of the attached resolution.

# Lake Pickett MSTU

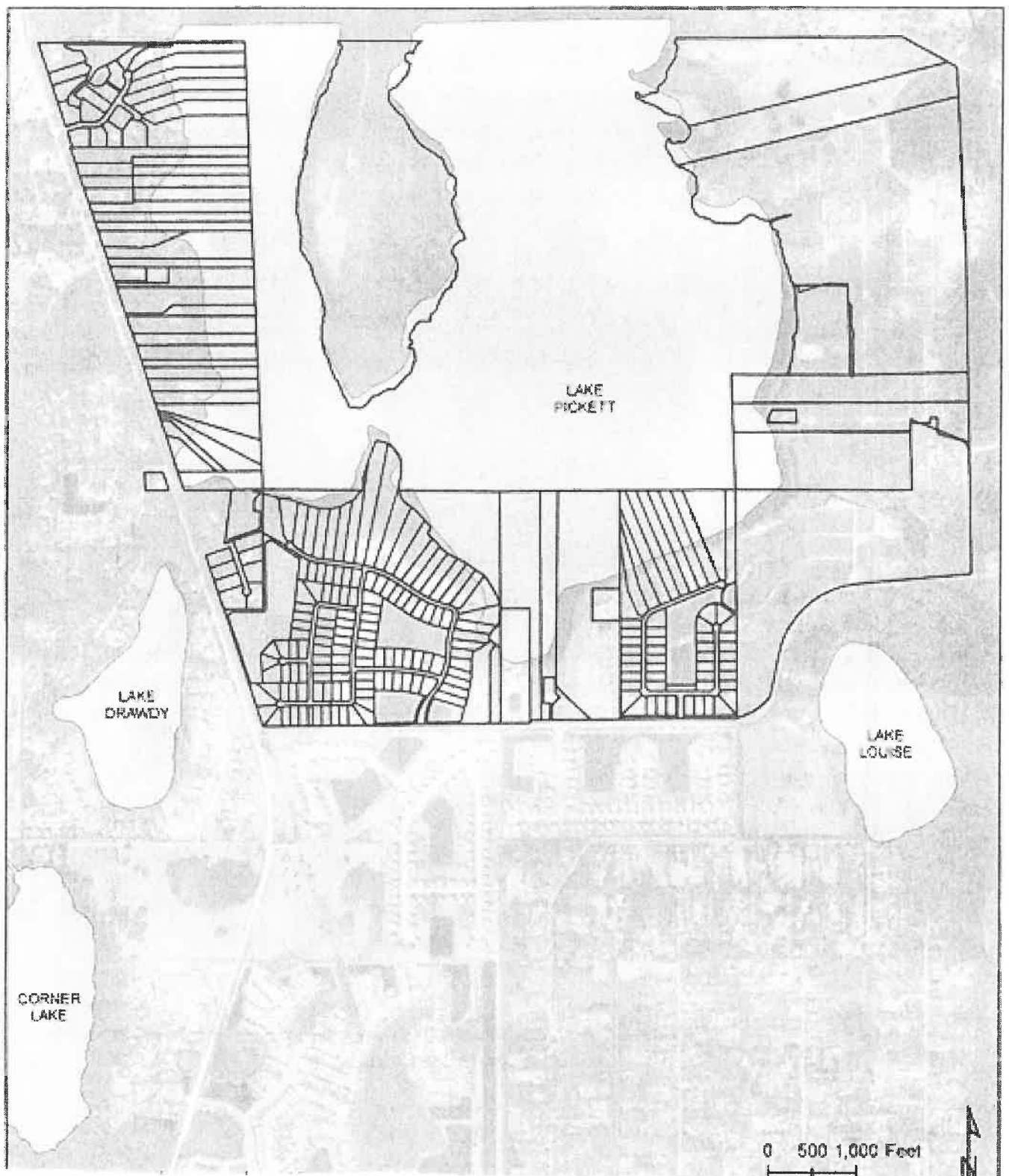

**RESOLUTION  
OF THE  
ORANGE COUNTY BOARD OF COUNTY COMMISSIONERS  
ADOPTING THE EIGHTH AMENDMENT  
TO THE RESOLUTION OF THE  
BOARD OF COUNTY COMMISSIONERS  
(ORIGINALLY ADOPTED ON DECEMBER 5, 1995,  
FIRST AMENDMENT ADOPTED ON JULY 12, 2005  
SECOND AMENDMENT ADOPTED ON DECEMBER 1, 2015  
THIRD AMENDMENT ADOPTED SEPTEMBER 19, 2017  
FOURTH AMENDMENT ADOPTED OCTOBER 16, 2018  
FIFTH AMENDMENT ADOPTED DECEMBER 1, 2020  
SIXTH AMENDMENT ADOPTED OCTOBER 26, 2021  
SEVENTH AMENDMENT ADOPTED OCTOBER 25, 2022)  
AMENDING A MUNICIPAL SERVICE TAXING UNIT  
FOR GENERAL LAKE CLEANING MAINTENANCE,  
AQUATIC PLANT CONTROL AND NAVIGATIONAL  
IMPROVEMENTS FOR  
LAKE PICKETT  
08/2023**

WHEREAS, Chapter 125.01 (01) (q), Florida Statutes, grants Orange County ("County") the power to establish Municipal Service Taxing Units ("MSTU") for any part of the unincorporated areas of the County; and

WHEREAS, the Board of County Commissioners of Orange County ("Board") is the governing board of the County; and,

WHEREAS, the Board established an MSTU by resolution adopted on December 5, 1995 recorded in Book 4986, Pages 2158 through 2163 in the Public Records of Orange County, as amended on July 12, 2005 and recorded in Book 08083, Pages 4491 through 4493, amended on December 1, 2015 and recorded in Book 11025, Pages 2763 through 2769, amended on September 19, 2017 recorded in Document Number 20170530501, amended on October 16, 2018 recorded on Document Number 20180632987 amended on December 1, 2020 recorded on Document Number 20200642627 and amended on October 26, 2021 recorded on Document Number 20210692546, Public Records of Orange County and further amended on October 25, 2022 recorded on Document Number 20220673359 (such resolutions are collectively referred to herein as the "MSTU Resolution" and such MSTU is referred to herein as the "Lake Pickett MSTU"); and

WHEREAS, the purpose of the Lake Pickett MSTU is to provide for general lake cleaning maintenance and aquatic plant control, together with certain other costs pertaining to the operation of such MSTU; and

WHEREAS, the Board now desires to amend the Resolution to allow additional authorized use of funds in the MSTU for navigational improvements; and

WHEREAS, the Board hereby finds that the boundaries of the Lake Pickett MSTU should continue to be as described in the MSTU Resolution of the Board which properties are set forth in Exhibit "A", which indicates the boundaries of the district and as set forth in Exhibit "B", which describes certain properties by metes and bounds and Exhibit "C" for subdivisions,

WHEREAS, it is the express intent of the Board to not otherwise alter or amend the Lake Pickett MSTU except as modified herein,

THEREFORE, BE IT RESOLVED BY THE BOARD OF COUNTY COMMISSIONERS OF ORANGE COUNTY, FLORIDA:

1. The Resolutions described in the above premises establishing the Lake Pickett MSTU for general lake cleaning maintenance and aquatic plant control of Lake Pickett of Orange County, Florida is hereby amended to allow additional authorized use of funds in the Lake Pickett MSTU for certain navigational improvements including waterway markers, signage, buoys, pilings and lake safety patrolling. The use of MSTU funds for such additional purposes shall be permitted only for such additional services and improvements rendered or installed after the effective date of this Resolution and for such navigational improvements as are authorized and permitted under the Florida Law.

THEREFORE, BE IT RESOLVED BY THE BOARD OF COUNTY COMMISSIONERS OF ORANGE COUNTY, FLORIDA:

1. The foregoing "WHEREAS" clauses are declared to be true and correct and are hereby incorporated into the text of the resolution.
2. This Eighth Amending Resolution shall become effective upon its adoption by the Board, and shall supplement the MSTU Resolution, as defined herein.
3. Except as herein specifically provided, all remaining terms and conditions of the MSTU Resolution shall remain in full force and effect.

ADOPTED THIS \_\_\_\_\_ DAY OF \_\_\_\_\_, 2023

ORANGE COUNTY, FLORIDA

BY: \_\_\_\_\_  
ORANGE COUNTY MAYOR

DATE: \_\_\_\_\_

ATTEST: Phil Diamond, County Comptroller  
as Clerk of the Board of County Commissioners

BY: \_\_\_\_\_

DEPUTY CLERK

Exhibit "A" - Boundary  
Lake Pickett MSTU

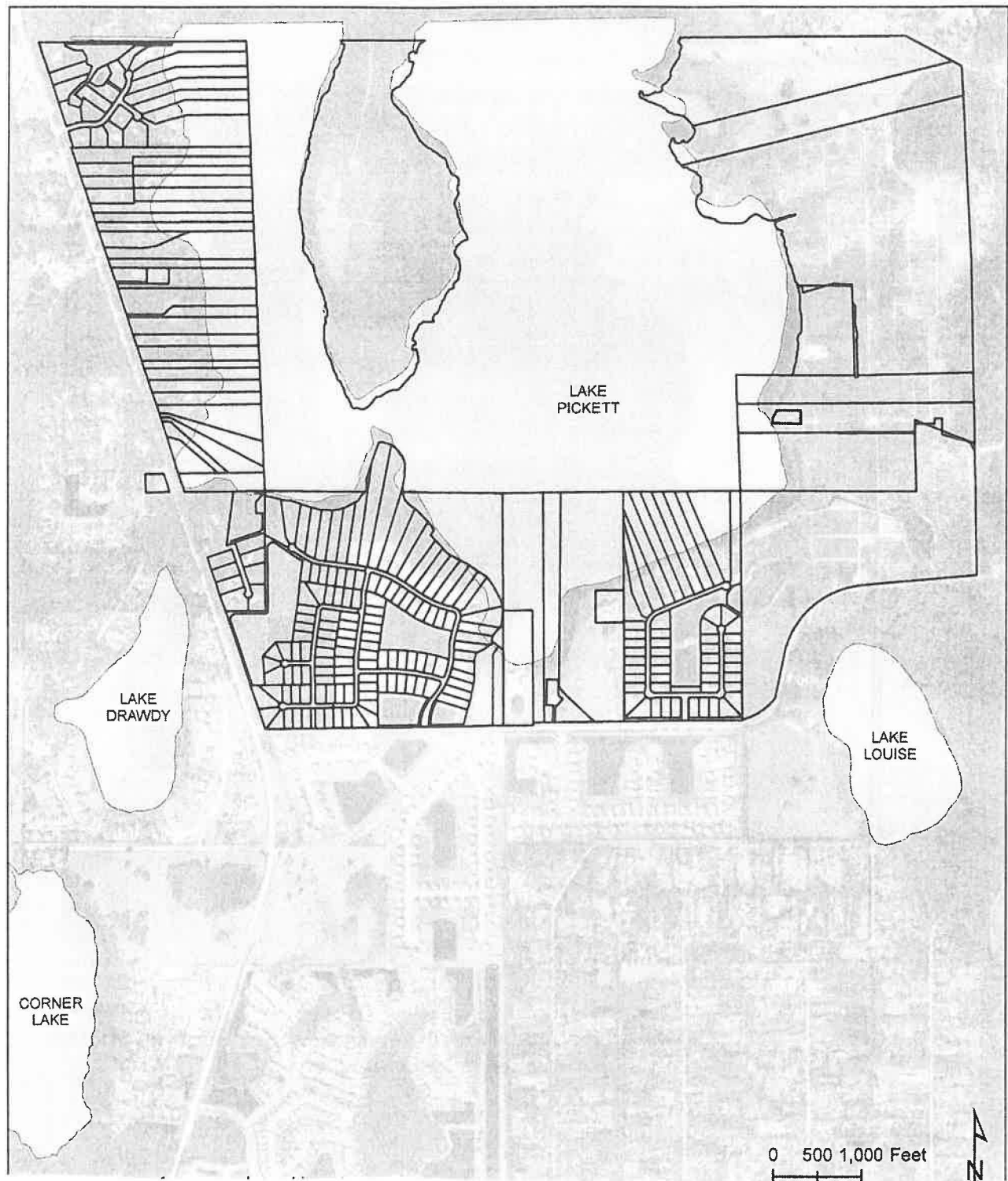

**Exhibit "B" - Parcels  
Lake Pickett MSTU**

Parcel ID Number	Parcel Legal Description
03-22-32-0000-00-001	THAT PART OF N 1/2 OF GOV LOT 1 & NE 1/4 OF NE 1/4 OF SEC 03-22-32 LYING N OF FOLLOWING DESCRIBED LINE BEG 564 FT N OF SE COR OF NE 1/4 OF NE 1/4 RUN S 76 DEG W ALONG CENTERLINE OF CANAL TO LAKE (LESS THE SLY 400 FT THEREOF) & (LESS THAT PART OF NE1/4 OF NE1/4 LYING NELY OF N FORT CHRISTMAS RD)
03-22-32-0000-00-002	(NOTE: HOMESTEAD PORTION OF THE FOLLOWING DESCRIBED PROPERTY) COMM AT THE SE COR OF SEC 03-22-32 TH N01-18-12W 541.85 FT TO POB N68-17-55W 722.25 FT S01-33-18E 139.47 FT S89-43-18W 1992.95 FT N02-19-47W 325.48 FT N89-30-34E 2662.93 FT S01-18-12E 466.10 FT TO POB
03-22-32-0000-00-005	THE SLY 400 FT OF THAT PART OF GOV LOT 1 & NE1/4 OF NE1/4 OF SEC LYING N OF A LINE DESCRIBED AS BEG 564 FT N OF SE COR OF NE1/4 OF NE1/4 RUN S 76 DEG W ALONG CENTER LINE OF CANAL TO LAKE IN SEC 3-22-32
03-22-32-0000-00-010	COMM AT THE SE COR OF SEC 03-22-32 TH RUN N01-18-12W 541.85 FT N68-17-55W 722.25 FT S01-33-18E 139.47 FT S89-43-18W 1992.95 FT N02-19-47W 325.48 FT CONT N02-19-47W 325.48 FT N89-17-54E 817 FT TO POB N01-18-12W 1019.42 FT N88-33-52E 508.22 FT S01-48-36E 1026.07 FT S89-17-54W 517.32 FT TO POB
03-22-32-0000-00-021	(NOTE: AG PORTION OF THE FOLLOWING DESCRIBED PROPERTY) COMM AT THE SE COR OF SEC 03-22-32 TH ALONG E LINE OF SEC 3 N1-14-41W 448.51 FT TO TH N28-21-13W 107.93 FT TH N61-28-57W 68.08 FT TH N7-24-34W 116.77 FT TH N72-29-52W 138.87 FT TH S89-20-44W 6.45 FT TH N0-39-36W 182.02 FT TH S89-20-44W 85 FT TH S0-40-20E 56.14 FT TH S89-20-44W 221.38 FT TH S1-29-58E 104.66 FT TH S89-46-38W 650.8 FT TH S 2.73 FT TH W 220 FT TH N 11.13 FT TH S89-46-38W 50 FT TO POB TH N 200 FT TH S89-46-38W 641.45 +/- FT TO WATERS EDGE TH S ALONG WATERS EDGE 300 +/- FT TH E 613 +/- FT TO POB
04-22-32-0000-00-010	BEG 310.8 FT N OF SW COR OF SE1/4 OF NW1/4 RUN W 421.51 FT S 17 DEG E 190.24 FT E 431.13 FT N 80 DEG E 149.24 FT N 66 DEG E 444.76 FT W 622.54 FT TO POB IN SEC 04-22-32
04-22-32-0000-00-011	N 138.18 FT OF S1/2 OF N1/2 OF SE1/4 OF NW1/4 OF SEC 04-22-32
04-22-32-0000-00-014	COMM AT THE NE COR OF THE NW1/4 OF SW1/4 OF SEC 04-22-32 TH S89-58-03W 332.95 FT S17-52-27E 105.05 FT TH N89-58-03E 658.86 FT TO POB TH CONT N89-58-03E 975.51 S02-06-34E 231.92 FT N89-58-59W 1568.94 FT N17-52-27W 52.54 FT S89-58-59E 600.79 FT N00-01-57W 180.91 FT TO POB
04-22-32-0000-00-015	FROM NW COR OF SW1/4 OF SEC 04-22-32 RUN S89-57-53E 1330.71 FT S01-39-03E 330.58 FT FOR POB RUN S89-57-51E 1331.30 FT S01-45-12E 330.56 FT N89-57-49W 1469.86 FT N17-49-10W 347.10 FT S89-57-51E 234.68 FT TO POB (FROM NW COR OF SW1/4 OF SEC 04-22-32 RUN S89-57-53E 1330.71 FT S01-39-03E 661.15 FT FOR POB TH N89-57-49W 137.97 FT N17-49-10W 31.54 FT TH S89-57-49E 408.94 FT TH N52-02-34E 162.45 FT TH S89-57-49E 938.56 FT TH S01-45-12E 130.06 FT TH N89-57-49W 1331.89 FT TO POB)
04-22-32-0000-00-016	N1/2 OF S1/2 OF N1/2 OF SW1/4 LYING E OF RD (LESS S 130 FT THEREOF) IN SEC 04-22-32
04-22-32-0000-00-017	N1/2 OF S1/2 OF S1/2 OF N1/2 OF SW1/4 LYING E OF ROAD SEC 04-22-32
04-22-32-0000-00-018	1/2 OF S1/4 OF S1/2 OF N1/2 OF SW1/4 LYING E OF RD & THE N 50 FT OF THE N 20 ACRES OF THE S1/2 OF SW1/4 OF SEC 04-22-32
04-22-32-0000-00-022	S 6 ACRES OF SE1/4 OF SW1/4 OF SEC 04-22-32 (LESS CR 419 R/W PER SRB 1/6) & (LESS RR R/W AKA SR 13 PER DB839/683 & OR3501/1137)
04-22-32-0000-00-023	FROM NW COR OF SE1/4 OF SW1/4 RUN S 331 FT S 87 DEG E 145.4 FT FOR POB S 15 DEG E 100 FT S 87 DEG E 105.44 FT S 69 DEG E 1135 FT TO E LINE

Exhibit "B" - Parcels  
Lake Pickett MSTU

Parcel ID Number	Parcel Legal Description
	OF SE 1/4 OF SW 1/4 N 420 FT M/L N 87 DEG W 1195 FT M/L TO POB IN SEC 04-22-32
04-22-32-0000-00-024	FROM NW COR SE 1/4 OF SW 1/4 RUN S 331 FT S 87 DEG E 145.4 FT S 15 DEG E 150 FT FOR POB TH S 87 DEG E 105.44 FT S 69 DEG E 29.72 FT S 57 DEG E 1200 FT M/L TO A PT ON E LINE OF SE1/4 OF SW1/4 TH S 80 FT TO PT ON N LINE OF S 6 ACRES OF SE1/4 OF SW1/4 TH W 360 FT N 45 DEG W 875 FT M/L N 87 DEG W 105.44 FT N 15 DEG W 50 FT TO POB IN SEC 04-22-32
04-22-32-0000-00-025	GOV LOTS 3 THROUGH 10 SEC 04-22-32
04-22-32-0000-00-026	FROM NW COR OF SE1/4 OF SW1/4 RUN 331 FT S 87 DEG E 145.44 FT S 15 DEG E 377.42 FT FOR POB TH RUN S 72 DEG E 162.64 FT S 45 DEG E 567 FT M/L W 436 M/L N 15 DEG W 460.75 FT TO POB IN SEC 04-22-32 SEE 5083/3047
04-22-32-0000-00-027	S1/2 OF N2/3 OF N1/2 OF S1/2 OF SE 1/4 OF NW1/4 & S1/2 OF N2/3 OF N1/2 OF S1/2 OF SW1/4 OF NW1/4 LYING E OF RR IN SEC 04-22-32
04-22-32-0000-00-028	N1/3 OF N1/2 OF S1/2 OF S1/2 OF NW1/4 E OF RR RY & S 26 FT OF N1/2 OF SE1/4 OF NW1/4 OF SEC 04-22-32
04-22-32-0000-00-029	THE S1/3 OF N1/4 OF SE1/4 OF NW1/4 OF SEC 04-22-32
04-22-32-0000-00-030	N1/3 OF N1/4 OF SE1/4 OF NW1/4 & S 3 FT OF NW1/4 OF NW1/4 E OF RD & N 30 FT OF N1/2 OF N1/2 OF SW1/4 OF NW1/4 E OF RD & S 142 FT OF N 172 FT OF N1/2 OF N1/2 OF THE SW1/4 OF NW1/4 LYING E OF SR RD 419 IN SEC 04-22-32
04-22-32-0000-00-031	S1/3 OF N1/2 OF S1/2 OF SE1/4 OF NW1/4 & S1/3 OF N1/2 OF S1/2 OF SW1/4 OF NW1/4 E OF RR RY IN SEC 04-22-32
04-22-32-0000-00-032	S1/2 OF N2/3 OF N1/4 OF SE1/4 OF NW1/4 OF SEC 04-22-32
04-22-32-0000-00-035	N1/2 OF S1/4 OF S1/2 OF N1/2 OF SW1/4 LYING E OF RD IN SEC 04-22-32
04-22-32-0000-00-036	S 142.21 FT OF N 146.43 FT OF S1/2 OF N1/2 OF SW1/4 OF NW1/4 LYING E OF SR 419 IN SEC 04-22-32
04-22-32-0000-00-038	FROM NW COR OF SE1/4 OF SW1/4 RUN S 331 FT S 87 DEG E 145.4 FT S 15 DEG E 100 FT FOR POB TH S 87 DEG E 105.44 FT S 69 DEG E 1135 FT M/L TO PT ON E LINE OF SE1/4 OF SW1/4 RUN S 285 FT TH N 57 DEG W 1200 FT M/L TH N 69 DEG W 29.72 FT N 87 DEG W 105.44 FT N 15 DEG W 50 FT TO POB IN SEC 04-22-32
04-22-32-0000-00-039	S1/2 OF N1/2 OF SE1/4 OF NW1/4 (LESS N 138.18 FT & LESS S 26 FT) OF SEC 04-22-32 SEE 5423/4043
04-22-32-0000-00-041	THAT PART OF THE S 140 FT OF N 190 FT OF N 20 ACRES OF S1/2 OF SW1/4 OF SEC 04-22-32 LYING ELY OF ABANDONED RR R/W DESC IN OR 3501/1137
04-22-32-0000-00-047	S 20 FT OF N 166.43 FT OF S1/2 OF N1/2 OF SW1/4 OF NW1/4 LYING E OF SR 419 & S1/2 OF N1/2 OF SW1/4 OF NW1/4 LYING E OF SR 419 SEC 04-22-32 (LESS N 166.43 FT)
04-22-32-0000-00-049	N1/2 OF N1/2 OF SW1/4 OF NW1/4 LYING E OF SR 419 (LESS N 172.7 FT) & N 4.22 FT OF S1/2 OF N1/2 OF SW1/4 OF NW1/4 LYING E OF SR 419 IN SEC 04-22-32
04-22-32-0000-00-051	BEG NE COR OF NW1/4 OF SW1/4 RUN W 332.96 FT S 17 DEG E 105.05 FT E 1634.39 FT N 100.06 FT W 1330 FT TO POB IN SEC 04-22-32
04-22-32-0000-00-054	S 130 FT OF N1/2 OF S1/2 OF N1/2 OF SW1/4 E OF RD IN SEC 04-22-32
04-22-32-0000-00-055	S 1/8 OF NW1/4 LYING E OF SR #419 (LESS BEG 310.8 FT N OF SW COR OF SE1/4 OF NW1/4 RUN W 421.51 FT S 17 DEG E 190.24 FT E 431.13 FT N 80 DEG E 149.24 FT N 66 DEG E 444.76 FT W 622.54 FT TO POB) IN SEC 04-22-32 SEE 3975/433

**Exhibit "B" - Parcels  
Lake Pickett MSTU**

<b>Parcel ID Number</b>	<b>Parcel Legal Description</b>
04-22-32-0000-00-057	FROM NW COR OF SE1/4 OF SW1/4 RUN S 331 FT S 87 DEG E 145.44 FT S 15 DEG E 200 FT FOR POB S 87 DEG E 105.44 FT S 45 DEG E 875 FT W 122 FT N 45 DEG W 567 FT M/L N 72 DEG W 162.64 FT N 15 DEG W 177.42 FT TO POB IN SEC 04-22-32
04-22-32-0000-00-064	THAT PT OF N 20 ACRES OF S1/2 OF SW1/4 LYING E OF CO RD 419 (LESS THE N 50 FT OF THE DESC PARCEL) IN SEC 04-22-32 DESC AS COMM AT W1/4 COR OF SEC THENCE E 999.66 FT TO POINT ON ELY R/W OF ABANDONED RR R/W S 17 DEG E 1598.77 FT FOR POB E 782 FT M/L TO LAKE PICKETT SWLY 185 FT M/L TO POINT ON S LINE OF SAID S1/2 OF SW1/4 W 620 FT M/L TO SAID ELY R/W N 17 DEG W 148.63 FT TO POB & THAT PART LYING E TO E LINE OF SW1/4
04-22-32-0000-00-065	FROM NW COR OF SW1/4 OF SEC 04-22-32 RUN S89-57-53E 1330.71 FT S01-39-03E 661.15 FT FOR POB TH N89-57-49W 137.97 FT N17-49-10W 31.54 FT TH S89-57-49E 408.94 FT TH N52-02-34E 162.45 FT TH S89-57-49E 938.56 FT TH S01-45-12E 130.06 FT TH N89-57-49W 1331.89 FT TO POB
04-22-32-0000-00-066	COMM AT THE NE COR OF THE NW1/4 OF SW1/4 OF SEC 04-22-32 TH S89-58-03W 332.95 FT S17-52-27E 105.05 FT TO POB TH N89-58-03E 408.86 FT S00-01-57E 160.69 FT N89-58-59W 357.23 FT N17-52-27W 168.48 FT TO POB
04-22-32-0000-00-067	COMM AT THE NE COR OF THE NW1/4 OF SW1/4 OF SEC 04-22-32 TH S89-58-03W 332.95 FT S17-52-27E 105.05 FT TH N89-58-03E 408.86 FT TO POB TH CONT N89-58-03E 250 FT S00-01-57E 180.91 FT N89-58-59W 600.79 FT N17-52-27W 21.02 FT S89-58-59E 357.23 FT N00-01-57W 160.69 FT TO POB
04-22-32-0000-00-068	COMM AT NW COR OF SW1/4 OF SEC 04-22-32 TH S89-57-53E 1330.71 FT TH S1-39-3E 330.58 FT TO POB TH S89-57-51E 207.2 FT TH S0-2-11W 130 FT TH N89-57-49W 400 FT TH N17-49-10W 136.6 FT TH S89-57-51E 234.68 FT TO POB
09-22-32-0000-00-009	THE NE1/4 OF SEC 09-22-32 LYING ABOVE ORDINARY HIGH WATER MARK AS DESC IN OR 662/428 (LESS COMM AT E1/4 COR OF SEC TH RUN N00-17-17W 30 FT TO N LINE OF R/W OLD LAKE PICKETT RD AKA CR 420 AND POB TH CONT N00-17-17W 855.15 FT TH N50-49-53W 142.34 FT TH S54-21-30W 144.32 FT TH S66-08-39W 80.9 FT TH S19-30-23W 22.55 FT TH S16-59-14W 34.83 FT TH S01-08-25W 276.92 FT TH S11-59-42W 190.92 FT TH S19-40-39W 15.7 FT TH S15-28-04W 311.67 FT TO N LINE OF SAID R/W TH N89-21-27E 457.27 FT TO POB PER LS-15-08-040)
09-22-32-0000-00-023	FROM NE COR OF LAKE DRAWDY EST 5/34 RUN S 76 DEG W 402.29 FT FOR POB TH N 3 DEG E 32.14 FT N 72 DEG E 332.95 FT NELY 62.58 FT N 163.56 FT W 70 FT N 130 FT N 40 DEG E 107.95 FT NWLY ALONG LAKE 142 FT M/L W 186.5 FT S 07 DEG W 616.14 FT N 76 DEG E 50 FT TO POB IN SEC 09-22-32
09-22-32-0000-00-045	COMM AT E1/4 COR OF 09-22-32 TH N00-17-17W 30 FT TO PT ON N R/W LINE OF R/W OLD LAKE PICKETT RD AKA CR 420 ALSO BEING POB TH CONT N00-17-17W 855.15 FT TH N50-49-53W 70.70 FT TH S36-24-30W 109.45 FT TH S00-17-17E 813.06 FT TH N89-21-27E 120 FT TO POB
09-22-32-0000-00-046	COMM AT E1/4 COR OF 09-22-32 TH N00-17-17W 30 FT TO PT ON N R/W LINE OF R/W OLD LAKE PICKETT RD AKA CR 420 TH S89-21-27W 120 FT ALONG SAID R/W TO POB TH N00-17-17W 813.06 FT TH N36-24-30E 109.45 FT TH N50-49-53W 71.64 FT TH S54-21-30W 144.32 FT TH S66-08-39W 80.9 FT S19-30-23W 22.55 FT TH S16-59-14W 34.83 FT TH S01-08-25W 276.92 FT TH S11-59-42W 190.92 FT TH S19-40-39W 15.7 FT TH S15-28-04W 311.67 FT TH N89-21-27E 337.27 FT TO POB

**Exhibit "B" - Parcels  
Lake Pickett MSTU**

Parcel ID Number	Parcel Legal Description
09-22-32-0000-00-047	COMM AT E1/4 OF SEC 09-22-32 E 30 FT TH S89-21-27W 140 FT TO POB TH S89-21-27W 20 FT TH N0-17-17W 165.26 FT TH S89-21-27W 250.56 FT TH N15-28-4E 139.66 FT TH N10-40-39E 15.7 FT TH N11-59-42E 190.92 FT TH N1-5-25E 184.23 FT TH S88-51-35E 78 FT TH S5-16-1W 50.91 FT TH S3-40-40W 164.7 FT TH S15-4-32W 36.43 FT TH N89-21-27E 139.06 FT TH S0-17-17E 432.17 FT TO POB
09-22-32-0000-00-048	COMM AT E1/4 COR OF SEC 9-22-32 TH N0-17-17W 30 FT TH S89-21-27W 120 FT TO POB TH S89-21-27W 20 FT TH N0-17-17W 432.17 FT TH S89-21-27W 130.06 FT TH N15-4-37E 36.43 FT TH N3-40-40E 164.76 FT TH N5-16-1E 50.91 FT TH N88-51-35W 78 FT TH N1-8-25E 92.69 FT TH N16-59-14E 34.83 FT TH N19-30-23E 22.55 FT TH N66-8-30E 80.9 FT TH N54-21-30E 144.32 FT TH S50-49-50E 71.84 FT S36-24-30W 109.45 FT TH S0-17-17E 813.06 FT TO POB
10-22-32-5342-00-010	M & H CITRUS, INC. 56/76 PT LOT 1 DESC AS BEG SWLY MOST COR LOT 1 TH RUN N00-42-48W 1303.22 FT S89-16-33W 332.26 FT N00-40-44W 1333.48 FT TO NW COR LOT 1 TH N89-19-16E 456.45 FT S00-42-48E 2636.24 FT S89-13-51W 125 FT TO POB
10-22-32-5342-00-011	M & H CITRUS, INC. 56/76 PT LOT 1 DESC AS BEG SWLY MOST COR LOT 1 TH RUN N89-13-51E 125 FT FOR POB TH N00-24-48W 2636.24 FT TH N89-19-16E 192.76 FT TH S00-00-00W 2204.41 FT TH S36-58-48E 95.59 FT S45-21-11E 97.02 FT S47-25-45E 335.26 FT S48-18-43E 82.06 FT TO S LINE LOT 1 TH S89-13-51W 594.68 FT TO POB
10-22-32-5342-00-012	M & H CITRUS, INC. 56/76 PT LOT 1 DESC AS COMM SWLY MOST COR LOT 1 TH N89-13-51E 1013.25 FT FOR POB TH RUN N00-38-14W 2634.84 FT TO N LINE LOT 1 TH S89-19-16W 698.99 FT S 2204.41 FT S36-58-48E 95.59 FT S45-21-11E 97.02 FT S47-25-45E 335.26 FT S48-18-43E 82.06 FT TO S LINE LOT 1 TH N89-13-51E 293.57 FT TO POB
10-22-32-5342-00-014	M & H CITRUS, INC. 56/76 PT LOT 1 DESC AS COMM SWLY MOST COR LOT 1 TH N89-13-51E 1013.25 FT FOR POB TH RUN N00-38-14W 2634.84 FT TO N LINE LOT 1 TH S89-19-16W 698.99 FT S 2204.41 FT S36-58-48E 95.59 FT S45-21-11E 97.02 FT S47-25-45E 335.26 FT S48-18-43E 82.06 FT TO S LINE LOT 1 TH N89-13-51E 293.57 FT TO POB

**Exhibit "C" - Subdivisions  
Lake Pickett MSTU**

Subdivision Name	Section Township Range Subcode	Plat Book / Page(s)	Lots / Parcels / Tracts / Units
Lake Drawdy Estates	09-22-32-4400	5/34	Lots 1 through 8
Lake Pickett Reserve	10-22-32-4430	86/130-135	Lots 1 through 52
Pickett's Cove	04-22-32-6889	25/10-11	Lots 1 through 23
Estates at Lake Pickett – Phase 1	09-22-32-2500	91/79-86	Lots 1 through 69
Estates at Lake Pickett - Tract R-1 Boat Ramp	09-22-32-2501	96/3	Tract R-1
Estates at Lake Pickett – Phase 2	09-22-32-2502	96/27-32	Lots 70 through 126
Sunset Preserve – Phase 1	03-22-32-7898	101/63-67	Lots 1 through 41
Sunset Preserve – Phase 4	10-22-32-7899	105/72-77	Lots 162 through 200
Sunset Preserve – Phase 5A	03-22-32-7902	108/95-98	Lots 42 through 72

**ORANGE COUNTY  
NOTICE OF PUBLIC HEARING**

**NOTICE BY ORANGE COUNTY BOARD OF COUNTY COMMISSIONERS TO ALLOW ADDITIONAL  
AUTHORIZED USE OF FUNDS IN THE MSTU FOR NAVIGATIONAL IMPROVEMENTS**

The Orange County Board of County Commissioners will hold a public hearing on **August 22, 2023**, at **2 p.m.** at the Orange County Administration Center, 201 South Rosalind Avenue, Orlando, Florida.

You are invited to attend and be heard regarding a request to consider the amendment of an existing Resolution authorizing the Orange County Board of County Commissioners to allow additional authorized use of funds in the MSTU (Municipal Service Taxing Unit) for navigational improvements. This amendment does not change the current ad valorem assessment.

\*\*\*IF YOU HAVE ANY QUESTIONS REGARDING THIS PUBLIC HEARING NOTICE, CONTACT ORANGE COUNTY COMPTROLLER SPECIAL ASSESSMENTS - 407-836-5770 – E-mail: Special.Assessments@occompt.com\*\*\*

PARA MAS INFORMACION, REFERENTE A ESTA VISTA PÚBLICA, FAVOR DE COMUNICARSE CON LAS OFICINAS DE FINANZAS DEL CONDADO ORANGE, AL NUMERO 407-836-5715

Notice is hereby given to all owners of lands located within the boundaries of Orange County, Florida that the Orange County Board of County Commissioners intends to allow additional authorized use of funds in the MSTU (Municipal Service Taxing Unit) for navigational improvements.

The MSTU Resolution establishing the Lake Pickett MSTU for general lake cleaning maintenance and aquatic plant control of Lake Pickett of Orange County, Florida is hereby amended to allow additional authorized use of funds in the Lake Pickett MSTU for certain navigational improvements including waterway markers, signage, buoys, pilings, and lake safety patrolling. The use of MSTU funds for such additional purposes shall be permitted only for such additional services and improvements rendered or installed after the effective date of this Resolution and for such navigational improvements as are authorized and permitted under Florida Law.

This ad valorem assessment would be levied for and would be collected by the Tax Collector on the **November 2023** real estate tax bill and each and every year thereafter until notification of discontinuance by the Orange County Board of County Commissioners. Failure to pay the assessment will cause a tax certificate to be issued against the property, which may result in a loss of title.

All affected property owners have the right to appear at the public hearing and the right to file written objections with the Orange County Board of County Commissioners within twenty (20) days of the publication of this notice. Assessments are due and payable the same as property taxes and bear the same penalties for delinquency as property taxes, including potential loss of property title through tax certificate and tax deed sale.

Estimates and specifications of the described properties are on file in the Office of the Orange County Comptroller (Special Assessments), Orange County Administration Center, 201 South Rosalind Avenue, Orlando, Florida, which are open to the public for inspection.

The following are parcel properties to be assessed and the proposed estimated ad valorem assessment for the **November 2023** tax roll would be **1.76 mills** or **\$1.76** per every One Thousand Dollars (\$1,000) of the property's values and this millage rate would not exceed 3 (three) mills.

03-22-32-0000-00-001	04-22-32-0000-00-038
03-22-32-0000-00-002	04-22-32-0000-00-039
03-22-32-0000-00-005	04-22-32-0000-00-041
03-22-32-0000-00-010	04-22-32-0000-00-047
03-22-32-0000-00-021	04-22-32-0000-00-049
04-22-32-0000-00-010	04-22-32-0000-00-051
04-22-32-0000-00-011	04-22-32-0000-00-054
04-22-32-0000-00-014	04-22-32-0000-00-055
04-22-32-0000-00-015	04-22-32-0000-00-057
04-22-32-0000-00-016	04-22-32-0000-00-064
04-22-32-0000-00-017	04-22-32-0000-00-065
04-22-32-0000-00-018	04-22-32-0000-00-066
04-22-32-0000-00-022	04-22-32-0000-00-067
04-22-32-0000-00-023	04-22-32-0000-00-068
04-22-32-0000-00-024	09-22-32-0000-00-009
04-22-32-0000-00-025	09-22-32-0000-00-023
04-22-32-0000-00-026	09-22-32-0000-00-045
04-22-32-0000-00-027	09-22-32-0000-00-046
04-22-32-0000-00-028	09-22-32-0000-00-047
04-22-32-0000-00-029	09-22-32-0000-00-048
04-22-32-0000-00-030	10-22-32-5342-00-010
04-22-32-0000-00-031	10-22-32-5342-00-011
04-22-32-0000-00-032	10-22-32-5342-00-012
04-22-32-0000-00-035	10-22-32-5342-00-014
04-22-32-0000-00-036	

The following are subdivision properties to be assessed and the proposed estimated ad valorem assessment for the **November 2023** tax roll would be **1.76 mills** or **\$1.76** per every One Thousand Dollars (\$1,000) of the property's values and this millage rate would not exceed 3 (three) mills.

#### **Lake Pickett**

#### **General Lake Cleaning Maintenance, Aquatic Plant Control and Navigational Improvements**

Subdivision Name: **Lake Drawdy Estates**, Plat Book **5**, Page **34**, Section **09**, Township **22**, Range **32**, Lots **1 through 8**; Public Records of Orange County, Florida. These lots / metes and bounds parcels are located in **District 5**.

Subdivision Name: **Lake Pickett Reserve**, Plat Book **86**, Pages **130 through 135**, Section **10**, Township **22**, Range **32**, Lots **1 through 52**, Public Records of Orange County, Florida. These lots / metes and bounds parcels are located in **District 5**.

Subdivision Name: **Pickett's Cove**, Plat Book **25**, Pages **10 and 11**, Section **04**, Township **22**, Range **32**, Lots **1 through 23**, Public Records of Orange County, Florida. These lots / metes and bounds parcels are located in **District 5**.

Subdivision Name: **Estates at Lake Pickett – Phase 1**, Plat Book **91**, Pages **79 through 86**, Section **09**, Township **22**, Range **32**, Lots **1 through 69**; Public Records of Orange County, Florida. These lots / metes and bounds parcels are located in **District 5**.

Subdivision Name: **Estates at Lake Pickett – Tract R-1 Boat Ramp**, Plat Book **96**, Page **3**, Section **09**, Township **22**, Range **32**, Tract **R-1**; Public Records of Orange County, Florida. These lots / metes and bounds parcels are located in **District 5**.

Subdivision Name: **Estates at Lake Pickett – Phase 2**, Plat Book **96**, Pages **27 through 32**, Section **09**, Township **22**, Range **32**, Lots **70 through 126**; Public Records of Orange County, Florida. These lots / metes and bounds parcels are located in **District 5**.

Subdivision Name: **Sunset Preserve – Phase 1**, Plat Book **101**, Pages **63 through 67**, Sections **03**, Township **22**, Range **32**, Lots **1 through 41**; Public Records of Orange County, Florida. These lots / metes and bounds parcels are located in **District 5**.

Subdivision Name: **Sunset Preserve – Phase 4**, Plat Book **105**, Pages **72 through 77**, Section **10**, Township **22**, Range **32**, Lots **162 through 200**; Public Records of Orange County, Florida. These lots / metes and bounds parcels are located in **District 5**.

Subdivision Name: **Sunset Preserve - Phase 5A**, Plat Book **108**, Pages **95 through 98**, Section **03**, Township **22**, Range **32**, Lots **42 through 72**; Public Records of Orange County, Florida. These lots / metes and bounds parcels are located in **District 5**.

If you wish to appeal any decision made by the Board of County Commissioners at this meeting, you will need a record of the proceedings. You should ensure that a verbatim record of the proceedings is made, which record includes the testimony and evidence upon which the appeal is to be based.

If you require special accommodations under the Americans with Disabilities Act of 1990, please call 407-836-3111 no later than two (2) business days prior to the hearing for assistance. Si usted requiere ayuda especial bajo la ley de Americanos con Incapacidades de 1990, por favor llame al 407-836-3111.

Phil Diamond, Orange County Comptroller  
As Clerk of the Board of County Commissioners  
Orange County, Florida

PUBLISH: July 30, 2023, Orlando Sentinel Public Record (Orange Extra)

Certify: MSTU for: Lake Pickett

c: All Board Members' Offices (e-mail)  
County Attorney's Office, BCC (e-mail to Angela Diaz)  
Jon Weiss, Deputy County Administrator, BCC (e-mail)  
Ann Dawkins, Special Assessments (e-mail)  
Cheryl Gillespie, Agenda Development (e-mail)  
Mike Seif, Orange TV, BCC (e-mail)  
James Jerome, Program Coordinator, BCC (e-mail)