

This instrument prepared by
and after recording return to:

Interplan, LLC
c/o Brandy Seago
220 East Central Parkway, Suite 4000
Altamonte Springs, Florida 32710

Parcel ID Number: 03-22-30-7874-00-020

-----[SPACE ABOVE THIS LINE FOR RECORDING DATA]-----

**PROPORTIONATE SHARE AGREEMENT FOR
CHICK-FIL-A #661 UNIVERSITY AND FORSYTH**

SEMORAN BOULEVARD

This Proportionate Share Agreement (the “Agreement”), effective as of the latest date of execution (the “**Effective Date**”), is made and entered into by and between Winter Park University 3391CFA, LLC a Florida limited liability company (“**Owner**”), with its principal place of business at 1401 Broad Street, Clifton, New Jersey 07013 and ORANGE COUNTY, a charter county and political subdivision of the State of Florida (“**County**”), with its principal address at P.O. Box 1393, Orlando, Florida 32802-1393. Owner and County may sometimes be referred to herein individually as “Party” and collectively as “Parties.”

WHEREAS, Owner holds fee simple title to certain real property, as generally depicted on Exhibit “A” and more particularly described on Exhibit “B”, both of which exhibits are attached hereto and incorporated herein by this reference (the “**Property**”); and

WHEREAS, the Property is located in County Commission District 5, and the proceeds of the PS Payment, as defined herein, will be allocated to Semoran Boulevard; and

WHEREAS, Owner intends a demolition and rebuild to include a 721sf expansion of the existing Chick-fil-A branded restaurant referred to and known as Chick-fil-A #661 University and Forsyth (the “**Project**”); and

WHEREAS, Owner received a letter from County dated August 22, 2024, stating that Owner’s Capacity Encumbrance Letter (“**CEL**”) application #24-03-025 for the Project was denied; and

WHEREAS, the Project will generate one (1) deficient PM Peak Hour trip (the “**Excess Trip**”) for the deficient roadway segment on Semoran Boulevard from University Boulevard to Seminole County Line (the “**Deficient Segment**”), and Zero (0) PM Peak Hour trips were available

on the Deficient Segment on the date the CEL was denied, as further described in Exhibit “C” attached hereto and incorporated herein; and

WHEREAS, the Excess Trip will cause the Deficient Segment to operate below adopted Level of Service standards; therefore, pursuant to Section 163.3180(5)(h), Florida Statutes, as amended, Owner has offered to provide County with proportionate share mitigation for the Excess Trip; and

WHEREAS, Owner and County have agreed that the proportionate share payment necessary to mitigate the impact of the Excess Trip on the Deficient Segment through the current anticipated Project buildout is nineteen thousand three hundred six and 00/100 Dollars (\$19,306.00) (the “**PS Payment**”); and

WHEREAS, County and Owner desire to set forth certain terms, conditions, and agreements between them as to the development of the Property into the Project.

NOW, THEREFORE, in consideration of the premises contained herein and other good and valuable consideration exchanged by and between Owner and County, the receipt and sufficiency of which are hereby acknowledged, the Parties stipulate and agree as follows:

Section 1. Recitals. The above recitals are true and correct and are incorporated herein by this reference.

Section 2. PS Payment; CEL.

(a) **Calculation of PS Payment:** The amount of the PS Payment for the Deficient Segment, as described in Exhibit “C”, totals nineteen thousand three hundred six and 00/100 Dollars (\$19,306.00). This PS Payment was calculated in accordance with the methodology outlined in Section 163.3180, Florida Statutes, as may be amended. Owner and County agree that the Excess Trips will constitute the Project’s impact on the aforementioned Deficient Segment based upon (i) Owner’s Traffic Study titled “University & Forsyth Chick-fil-A Traffic Impact Study” prepared by Kittleson & Associates, dated March 2024 and revised May 2024, for Chick-fil-A, Inc. (the “**Traffic Study**”), which is incorporated herein by this reference, and (ii) upon the calculations described in Exhibit “C”. The Traffic Study was accepted by the Orange County Transportation Planning Division in July 2024 and is on file and available for inspection with that division (CMS #2024025). Owner and County further acknowledge and agree that the PS Payment as set forth above shall be the final and binding calculation of the amount the Owner is required to pay through the buildout of the currently approved Project as proportionate share mitigation for impacts of the Project upon roadways within County’s jurisdiction, notwithstanding any subsequent variance in the actual cost of any improvement(s) to the Deficient Segment or actual traffic /travel impacts created by the Project; provided, however, that if Owner modifies the Project’s development program and/or subsequently increases the number of units and/or square footage, as applicable, of the Project, the Project may then be subject to an additional concurrency

evaluation and proportionate share agreement as set forth in Subsection 2(d) below. Owner and County further acknowledge and agree that the calculation of an agreement regarding the amount of the PS Payment constitute material inducements for the Parties to enter into this Agreement.

(b) *Timing of PS Payment, Issuance of CEL.* Not later than ninety (90) days following the Effective Date, Owner shall deliver a check to County in the amount of nineteen thousand three hundred six and 00/100 Dollars (\$19,306.00) as the PS Payment. The check shall be made payable to "Orange County Board of County Commissioners" and shall be delivered to the Fiscal and Operational Support Division of the Planning, Environmental, and Development Services Department. Within twenty-one (21) days following its receipt of the PS Payment, if the Property's future land use designation and zoning are consistent with the Project's proposed development, County shall issue a CEL sufficient to encumber traffic capacity for the Project, irrespective of any actual traffic deficiency on the Deficient Segment. Within the time frame provided in the CEL, Owner must reserve the encumbered trips by obtaining a Capacity Reservation Certificate as provided in Section 30-591 of the Orange County Code, as may be amended. An amount equal to the PS Payment shall be applied toward the amount of the initial capacity reservation payment (and any subsequent reservation payment(s), if the initial reservation payment does not exceed the amount of the PS Payment) as further set forth in Section 3 below. In the event Owner has not paid the PS Payment within ninety (90) days after the Effective Date, one extension of ninety (90) additional days may be granted by the manager of County's Transportation Planning Division. In the event Owner has not paid the PS Payment to County within one hundred eighty (180) days after the Effective Date, this Agreement shall become null and void.

(c) *Project Development.* Recordation of a subdivision plat and/or approval of a commercial site plan for the Project shall not be permitted prior to the issuance of a Capacity Reservation Certificate as contemplated in subparagraph 2(b) above.

(d) *Increase in Project Trips.* Any change or modification to the Project that increases the unit count and/or square footage, as applicable, may result in an increase in trips on the Deficient Segment or other segments within the transportation impact area, as defined by County. Owner understands and agrees that any such additional trips are neither vested nor otherwise permitted under this Agreement, and that Owner is precluded from asserting any such vesting. In addition, Owner understands and agrees that any such changes resulting in an increase in trips may cause this Agreement to become null and void, and/or may require application for and execution of an additional Proportionate Share Agreement, along with any other required documentation, for the number of increased trips.

(e) *Satisfaction of Transportation Improvement Requirements.* County hereby acknowledges and agrees that upon Owner's payment of the PS Payment as required herein, and absent any change or modification to the Project as set forth in Subsection 2(d) above, Owner shall be deemed to have satisfied all requirements for the mitigation of the traffic impacts of the Project on all roads affected by the Project within County's jurisdiction through buildout of the Project.

Owner shall be entitled to fully and completely develop the Project, without regard to whether improvements to the Deficient Segment are actually constructed; provided, however, Owner shall be required to obtain a Capacity Reservation Certificate prior to the expiration of Owner's Capacity Encumbrance Letter and shall be required to maintain the validity of the Capacity Reservation Certificate in accordance with its terms. Additionally, nothing herein shall be construed to exempt Owner from meeting the requirements of all other applicable laws, rules, regulations, and/or Orange County Code provisions or from making the required payment of transportation and other impact fees applicable to the Project, subject to any credits as set forth in Section 3 below. For avoidance of doubt, nothing herein is intended to, nor shall, constitute prepayment of any densities and/or intensities of development or of any development program.

Section 3. Transportation Impact Fee Credits. County and Owner agree that in accordance with Section 163.3180(5)(h)(2)(e), Florida Statutes, as may be amended, Owner shall receive a credit on a dollar for dollar basis for impact fees, paid or payable in the future for the Project in an amount up to but not exceeding the PS Payment as specifically described in Exhibit "C". County further agrees that such credits may be applied on a dollar for dollar basis against capacity reservation fees at such time as capacity reservation fees may be required to be paid by Owner in connection with the issuance of a Capacity Reservation Certificate as contemplated in Section 2 above. In no event shall Owner receive credits in excess of the PS Payment and in the event the PS Payment exceeds either the applicable transportation impact fees or capacity reservation fees, as the case may be, Owner shall not be entitled to a refund for the amount of the PS Payment in excess of such transportation impact fees or capacity reservation fees. For avoidance of doubt, nothing herein is intended to, nor shall, constitute prepayment of any densities and/or intensities of development or of any development program.

Section 4. No Refund. The PS Payment (including any capacity reservation fees paid with the PS Payment) is non-refundable and cannot be transferred or applied to another project or property.

Section 5. Notice. Any notice delivered with respect to this Agreement shall be in writing and be deemed to be delivered (whether or not actually received) (i) when hand delivered to the person(s) hereinafter designated, or (ii) upon deposit of such notice in the United States Mail, postage prepaid, certified mail, return receipt requested, addressed to the person at the address set forth opposite the party's name below, or to such other address or other person as the party shall have specified by written notice to the other party delivered in accordance herewith:

As to Owner: Winter Park University 3391CFA, LLC
1401 Broad Street
Clifton, New Jersey 07013

With copy to: Chick-fil-A, Inc.
Attention: Jacob Smith
5200 Buffington Road
Atlanta, Georgia 30349

As to County: Orange County Administrator
P. O. Box 1393
Orlando, Florida 32802-1393

With copy to: Orange County Planning, Environmental, and Development
Services Department
Manager, Fiscal and Operational Support Division
201 South Rosalind Avenue, 2nd Floor
Orlando, Florida 32801

Orange County Public Works Department
Manager, Transportation Planning Division
4200 South John Young Parkway, 2nd Floor
Orlando, Florida 32839

Orange County Planning, Environmental, and Development
Services Department
Manager, Planning Division
201 South Rosalind Avenue, 2nd Floor
Orlando, Florida 32801

Section 6. Covenants Running with the Property. This Agreement shall be binding upon and shall inure to the benefit and burden of the heirs, legal representatives, successors, and assigns of the Parties, and shall be a covenant running with the Property and be binding upon the successors and assigns of Owner and upon any person, firm, corporation, or entity who may become a successor in interest to the Property.

Section 7. Recordation of Agreement. Owner shall record an original of this Agreement in the Public Records of Orange County, Florida, at no expense to County, not later than thirty (30) days after the Effective Date.

Section 8. Applicable Law. This Agreement and the provisions contained herein shall be construed, controlled, and interpreted according to the laws of the State of Florida and in accordance with the Orange County Code.

Section 9. Specific Performance. County and Owner shall each have the right to enforce the terms and conditions of this Agreement only by an action for specific performance. Venue for any action(s) initiated under or in connection with this Agreement shall lie in the Circuit Court of the Ninth Judicial Circuit in and for Orange County, Florida. With the exception of the timing of the PS Payment as set forth in Section 2(b) hereof, the parties acknowledge and agree that no party shall be considered in default for failure to perform under this Agreement until such party has received written notice, in accordance with Section 5, specifying the nature of such default or failure to perform and said party fails to cure said default or fails to perform within thirty (30) days of receipt of written notice.

Section 10. Attorney Fees. In the event either Party brings an action or proceeding including any counterclaim, cross-claim, or third-party claim, against the other Party arising out of this Agreement, each Party in such action or proceeding, including appeals therefrom, shall be responsible for its own attorney and legal fees.

Section 11. Construction of Agreement; Severability. Captions of the Sections and Subsections of this Agreement are for convenience and reference only; any words contained therein shall in no way be held to explain, modify, amplify, or aid in the interpretation, construction, or meaning of the provisions of this Agreement. If any provision of this Agreement, the deletion of which would not adversely affect the receipt of any material benefits by any party hereunder or substantially increase the burden of any party hereunder, shall be held to be invalid or unenforceable to any extent by a court of competent jurisdiction, the same shall not affect in any respect whatsoever the validity or enforceability of the remainder of this Agreement.

Section 12. Amendments. No amendment, modification, or other change(s) to this Agreement shall be binding upon the parties unless in writing and formally executed by all of the parties.

Section 13. Termination. In the event either (i) Owner has not paid the PS Payment to County within one hundred eighty (180) days after the Effective Date, as contemplated in Subsection 2(b), or (ii) Owner has timely paid the PS Payment to County and the Project has been constructed on the Property and completed, pursuant to a County building permit, this Agreement shall automatically terminate and thereafter be null and void for all purposes.

Section 14. Counterparts. This Agreement may be executed in up to two (2) counterparts, each of which shall be deemed to be an original and both of which together shall constitute one and the same instrument.

[Signatures appear on following pages]

IN WITNESS WHEREOF, the parties have caused this Agreement to be duly executed by their respective duly authorized representatives on the dates set forth below.

“COUNTY”

ORANGE COUNTY, FLORIDA
By: Board of County Commissioners

By: _____
Jerry L. Demings
Orange County Mayor

Date: _____

ATTEST: Phil Diamond, CPA, County Comptroller
As Clerk of the Board of County Commissioners

By: _____
Deputy Clerk

Print Name: _____

WITNESSES:

Paula Maciel
Signature of Witness

Print Name: Paula Maciel

Mailing Address: 1401 Broad Street

Clifton, NJ 07013

Ashley L. Rose
Signature of Witness

Print Name: Ashley L. Rose

Mailing Address: 1401 Broad Street

Clifton, NJ 07013

“OWNER”

Winter Park University 3391CFA, LLC, a Florida limited liability company

By: ARCTRUST, Inc., a Maryland Corporation, its Manager

By: Gary S. Baumann

Print Name: Gary S. Baumann

Title: Chief Operating Officer

STATE OF: NEW JERSEY

COUNTY OF: PASSAIC

The foregoing instrument was acknowledged before me by means of physical presence or online notarization, this 16th day of September, 2024, by Gary S. Baumann, as Chief Operating Officer of ARCTRUST, Inc., a Maryland Corporation, which is Manager of Winter Park University 3391CFA, LLC, a Florida limited liability company, on behalf of such corporation, who is personally known to me or has produced _____ as identification.

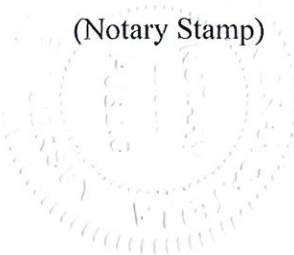

Karylyn Brancatella
Signature of Notary Public

Print Name: KARALYN BRANCATELLA

Notary Public, State of: New Jersey

Commission Expires: 1/5, 2025

Exhibit "A"

"Chick-fil-A #661 University and Forsyth"

Project Location Map

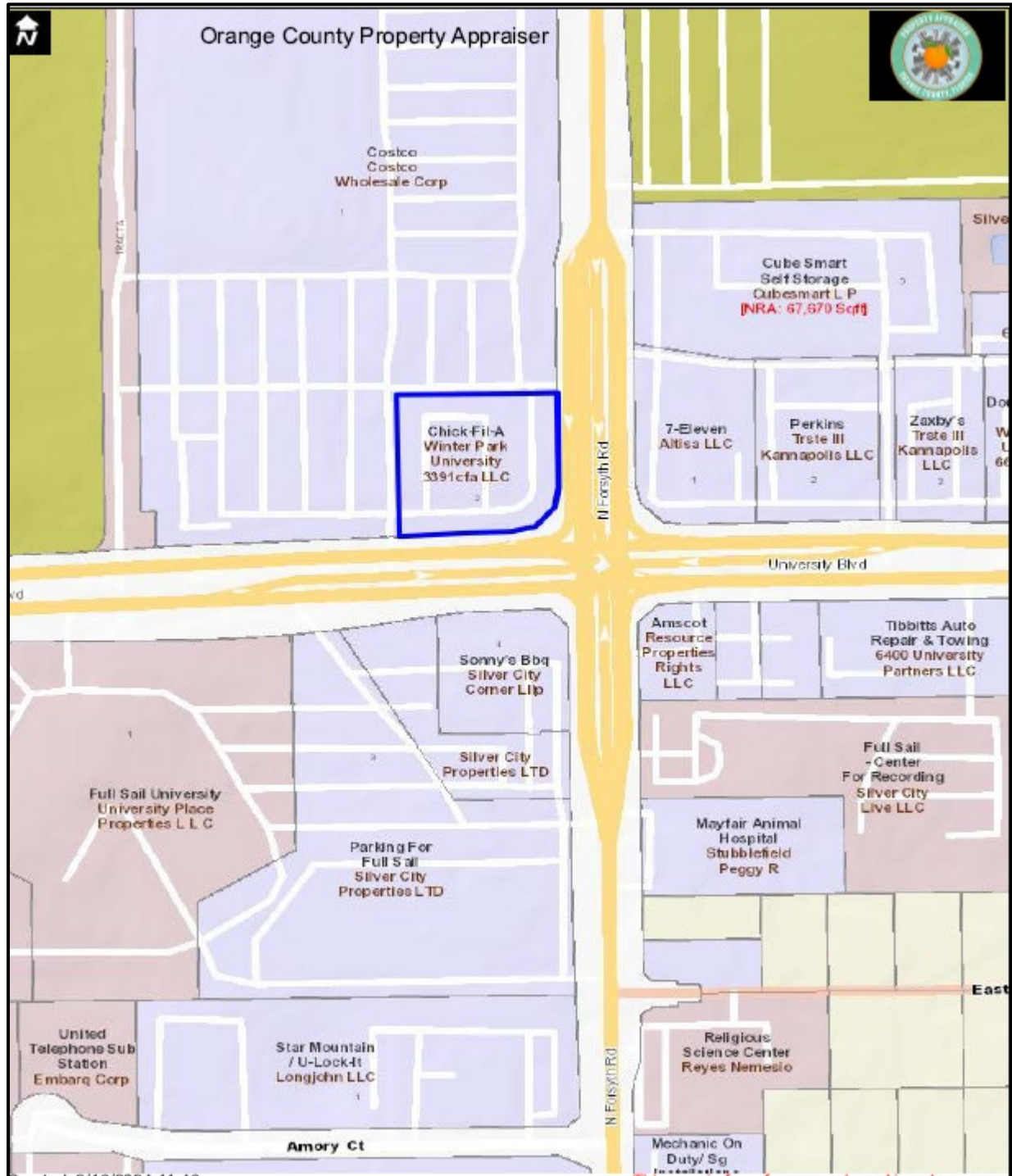

Proportionate Share Agreement, Chick-fil-A #661 University and Forsyth
Winter Park University 3391CFA, LLC for Semoran Boulevard, 2024

Exhibit "B"

"Chick-fil-A #661 University and Forsyth"

Parcel ID: 03-22-30-7874-00-020

Legal Description:

LOT 2, SILVER CITY, ACCORDING TO THE PLAT THEREOF AS RECORDED IN PLAT BOOK
43 PAGE 11, PUBLIC RECORDS OF ORANGE COUNTY, FLORIDA.

Exhibit "C"

"Chick-fil-A #661 University and Forsyth"

Log of Project Contributions
 Semoran Boulevard (University Boulevard to Seminole County Line)

Roadway Improvement Project Information									
Planned Improvement Roadway(s)	Limits of Improvement (From - To)	Segment Length	Adopted LOS	Existing Generalized Capacity	Type of Improvement	Improved Generalized Capacity	Capacity Increase	Total Project Cost	Cost / Trip
Semoran Blvd	University Blvd Seminole county Line	0.95	E	3020	Adding two lanes	4040	1020	\$19,691,880	\$19,306

County Share of Improvement								
Planned Improvement Roadway(s)	Limits of Improvement (From - To)	Segment Length	Adopted LOS	Existing Generalized Capacity	Backlogged Trips	Improved Generalized Capacity	Capacity Increase	County (Backlog) Responsibility
Semoran Blvd	University Blvd Seminole county Line	0.95	E	3020	32	4040	1020	\$617,784

Developer Share of Improvement										
Planned Improvement Roadway(s)	Limits of Improvement (From - To)	Segment Length	Adopted LOS	Existing Generalized Capacity	Improved Generalized Capacity	Capacity Increase	Backlogged Trips	Capacity Increase for New Development	Remaining Project Cost	Cost / Trip
Semoran Blvd	University Blvd Seminole county Line	0.95	E	3020	4040	1020	32	988	\$19,074,096	\$19,306

Updated: 8/23/24

Log of Project Contributions				
Date	Project	Project Trips	Prop Share	
Existing	Jun-21	Existing plus Committed	26	\$277,238
	Jan-22	3825 Forsyth Redevelopment	4	\$42,652
	Jul-22	Highland Hills Self Storage	2	\$22,688
		Backlogged Totals:	32	\$342,578
Proposed	Jul-22	Chick-Fil-A	1	\$19,306
				\$0
				\$0
				\$0
				\$0
		Totals:	33	\$361,884