

Board of County Commissioners

**Shoreline Alteration/Dredge and Fill Permit
Application**

SADF-22-09-023

Applicant: Robert Thollander

June 6, 2023



Location Map

813 Springwood Drive, Orlando, FL



Parcel ID No. 11-23-29-9592-04-080



Aerial Photo

813 Springwood Drive, Orlando, FL



Parcel ID No. 11-23-29-9592-04-080



Existing Conditions





Site Plan

Lake Holden

Legal Description:

Lot 8, Block D, Holden Park, according to Book Z, Page(s) 127, of The Public Record

Not Platted (Per Plat)

Flood Disclaimer:

By performing a search with the local governing municipality, This Property was found in Orange County, community number

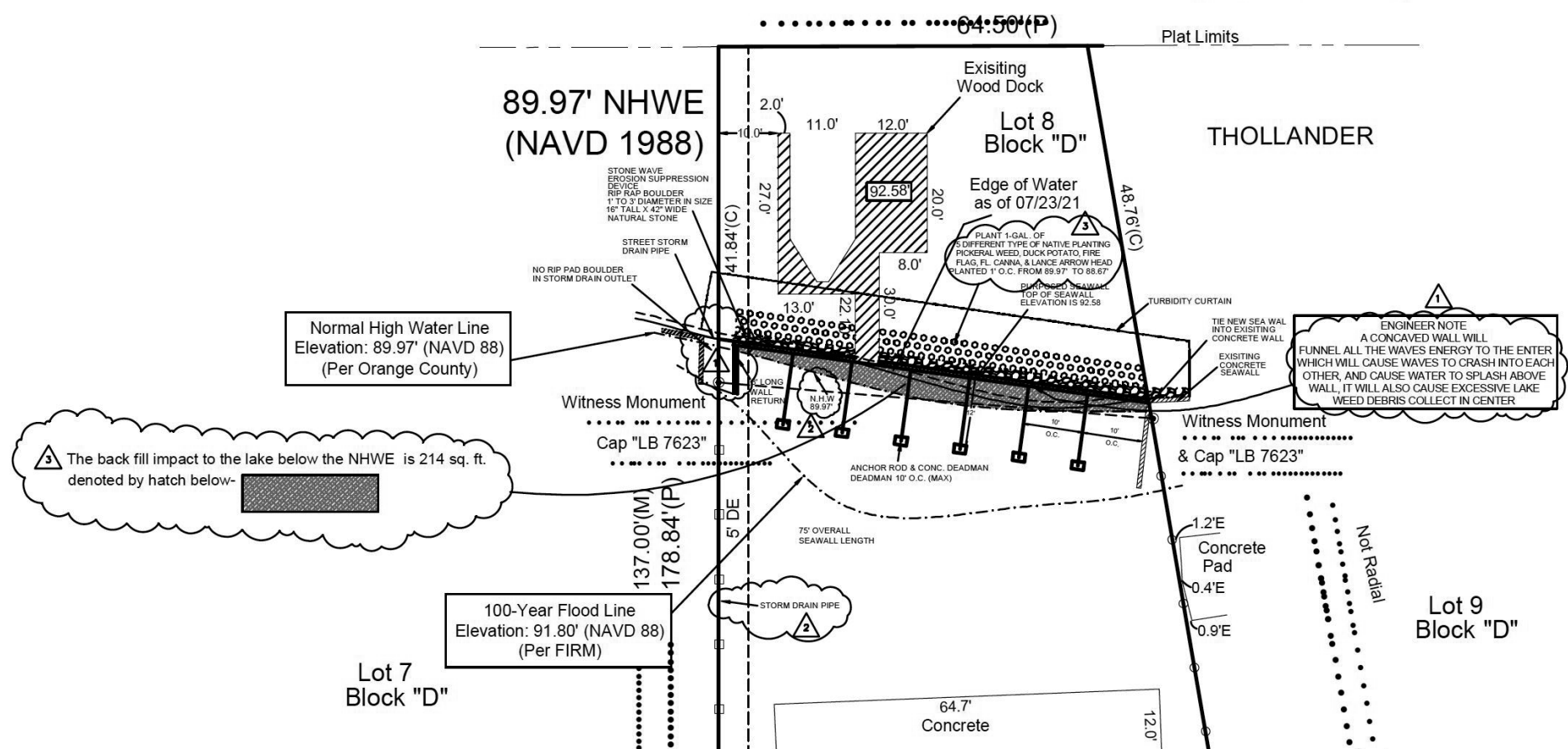

Normal High Water Line
Elevation: 89.97' (NAVD 88)
(Per Orange County)

3 The back fill impact to the lake below the NHWE is 214 sq. ft. denoted by hatch below:

100-Year Flood Line
Elevation: 91.80' (NAVD 88)
(Per FIRM)

1 ENGINEER NOTE
A CONCAVED WALL WILL
FUNNEL ALL THE WAVES ENERGY TO THE ENTER
WHICH WILL CAUSE WAVES TO CRASH INTO EACH
OTHER, AND CAUSE WATER TO SPLASH ABOVE
WALL, IT WILL ALSO CAUSE EXCESSIVE LAKE
WEED DEBRIS COLLECT IN CENTER

Witness Monument
& Cap "LB 7623"

Lot 7
Block "D"

Lot 9
Block "D"

64.7'
Concrete

1.2'E
Concrete
Pad
0.4'E
0.9'E

Not Radial

THOLLANDER

Lot 8
Block "D"

64.50'(P)

Plat Limits

48.76'(C)

89.97' NHWE
(NAVD 1988)

Existing
Wood Dock

Edge of Water
as of 07/23/21

3 PLANT 1-GAL. OF
5 DIFFERENT TYPE OF NATIVE PLANTING
PICKEREL WEED, DUCK POTATO, FIRE
FLAG, FL. CANNIA, & LANCE ARROWHEAD
PLANTED 1' O.C. FROM 89.97' TO 88.67'

STONE WAVE
EROSION SUPPRESSION
DEVICE
RIP RAP BOULDER
1" TO 3" DIAMETER IN SIZE
18" TALL X 42" WIDE
NATURAL STONE

STREET STORM
DRAIN PIPE

NO RIP PAD BOULDER
IN STORM DRAIN OUTLET

PLUNGED SEAWALL
TOP OF SEAWALL
ELEVATION IS 92.58

TURBIDITY CURTAIN

TIE NEW SEA WAL
INTO EXISTING
CONCRETE WALL

EXISTING
CONCRETE
SEAWALL

Witness Monument

Cap "LB 7623"

ANCHOR ROD & CONC. DEADMAN
DEADMAN 10' O.C. (MAX)

75' OVERALL
SEAWALL LENGTH

STORM DRAIN PIPE

137.00'(M)
178.84'(P)

5' DE

5' DE

12.0'



Site Plan

Pedro L. Medina
 PE 73579
 Digitally signed by Pedro L. Medina PE 73579
 Date: 2023.03.24 16:13:37 -04'00'

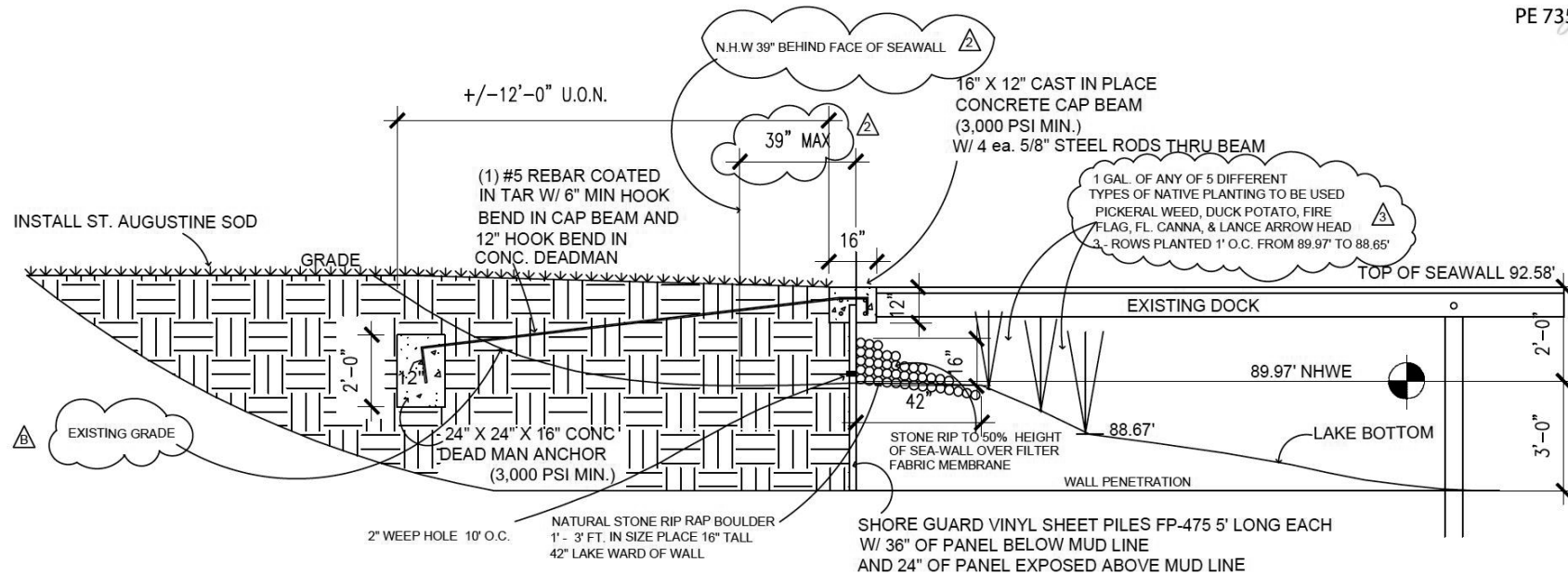

ENGINEER NOTE
 A CONCAVED WALL WILL FUNNEL ALL THE WAVES ENERGY TO THE ENTER WHICH WILL CAUSE WAVES TO CRASH INTO EACH OTHER, AND CAUSE WATER TO SPLASH ABOVE WALL, IT WILL ALSO CAUSE EXCESSIVE LAKE WEED DEBRIS COLLECT IN CENTER

SEA WALL CROSS SECTION

1/4" = 1'-0"



Considerations

- **Project reviewed in accordance with Chapter 15, Article VI and the review criteria and conditions of issuance therein.**
- **The applicant has agreed to pay \$375 into the Conservation Trust Fund as mitigation to offset the surface water impacts to Lake Holden.**
- **Riprap and plantings will be installed waterward of the new seawall.**
- **Notification of the public hearing was sent to property owners within 500 feet of the project site; no objections were received.**



Finding

- Pursuant to Orange County Code, Chapter 15, Article VI, EPD has evaluated the proposed SADF permit application and required documents and has made a finding that the request is consistent with Section 15-218.



Action Requested

- **Acceptance of the findings and recommendation of the Environmental Protection Division staff and approval of Shoreline Alteration/Dredge and Fill Permit SADF-22-09-023 for Robert Thollander, subject to the conditions listed in the staff report.**
District 3