

Board of County Commissioners

**Shoreline Alteration/Dredge and Fill Permit
Application**

SADF-23-08-021

**Applicant: KTM Property Holdings, LLC,
c/o Kyle Muehlstein**

January 9, 2024



Location Map

5620 Bay Side Drive, Orlando

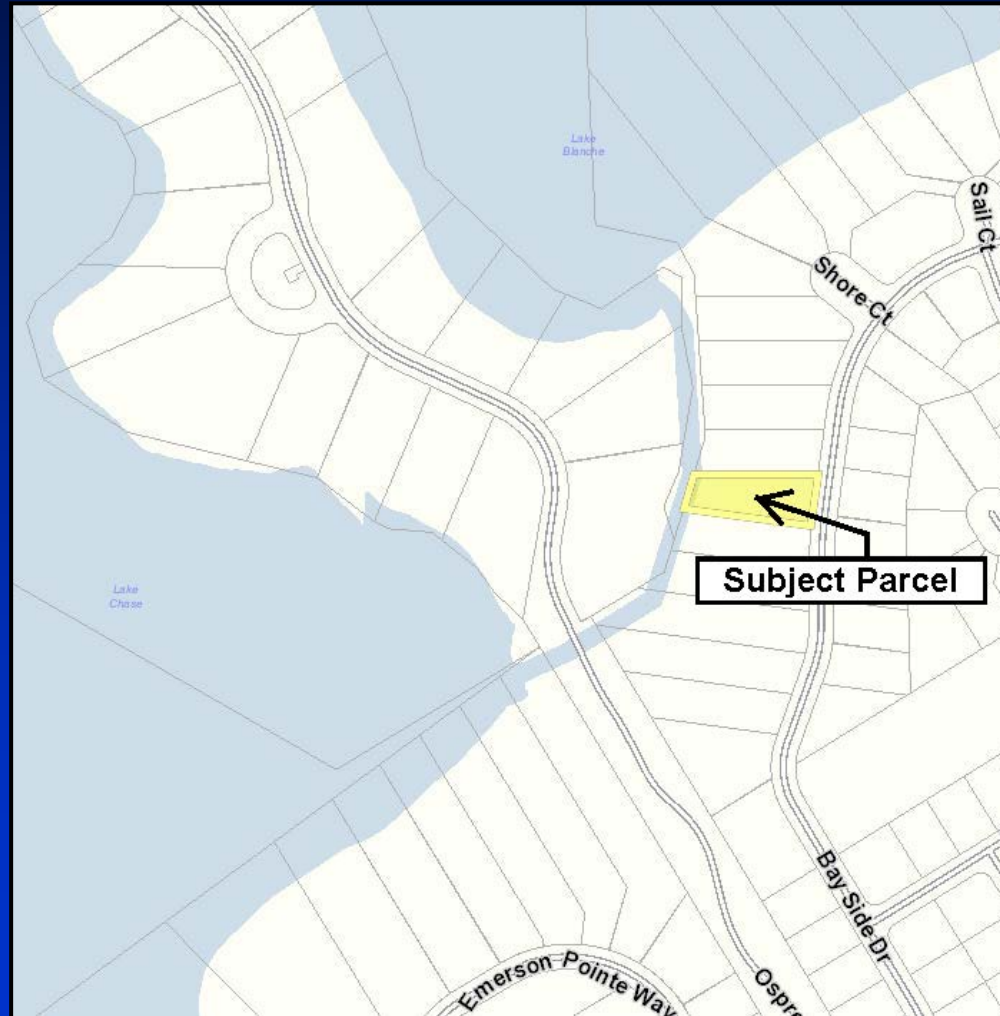

Parcel ID No.: 21-23-28-5938-00-460



Aerial Photo

5620 Bay Side Drive, Orlando



Parcel ID No.: 21-23-28-5938-00-460



Existing Conditions





Site Plan

Replacement vinyl seawall at the Normal High Water Elevation

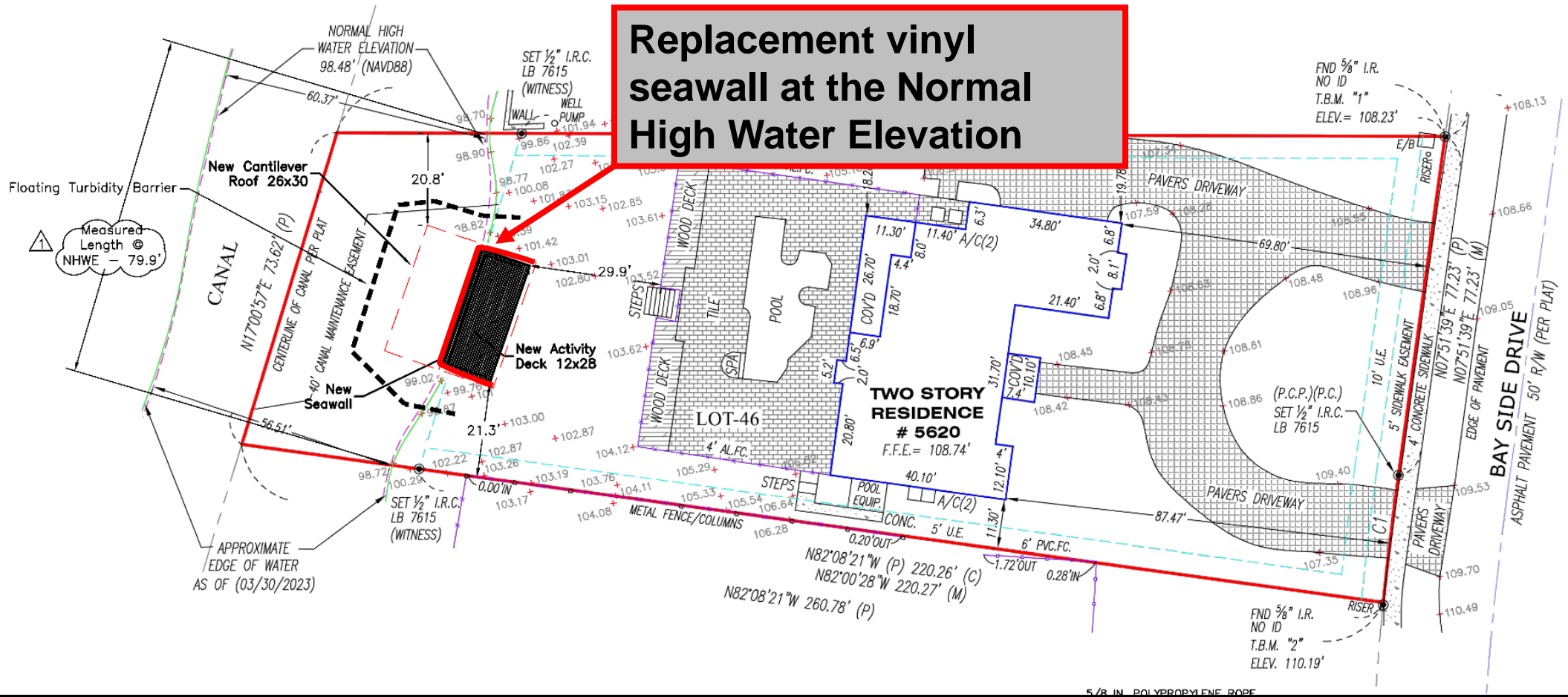

5/8 IN. POLYPROPYLENE ROPE



Site Plan

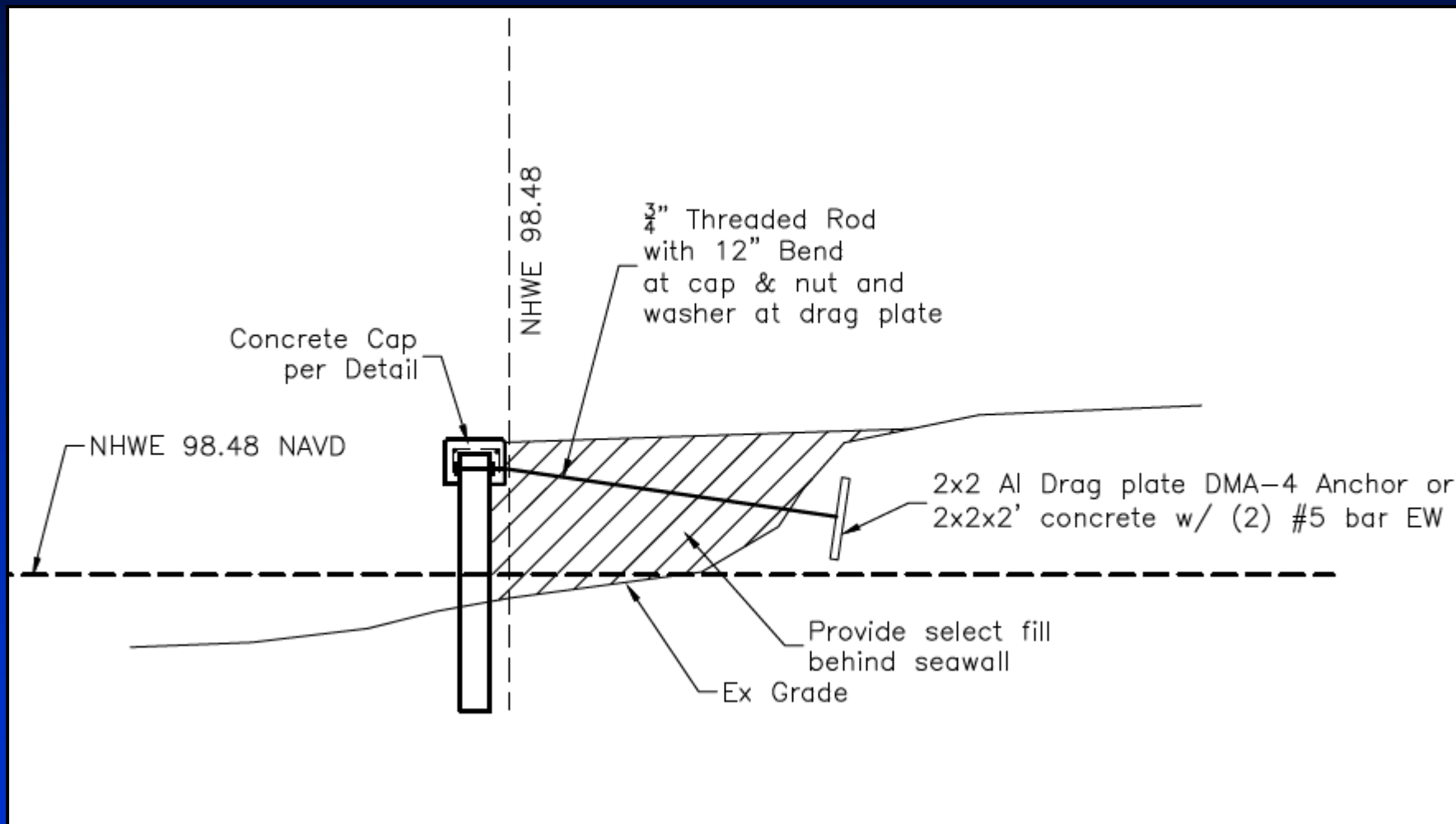



Considerations

- **Project reviewed in accordance with Chapter 33, Article IV, Section 33-129(d) and the review criteria and conditions of issuance therein.**
- **Notification of the public hearing was sent to property owners within 500 feet of the project site. EPD has received no objections to the request.**



Finding

- Pursuant to Orange County Code, Chapter 33, Article IV, EPD has evaluated the proposed SADF permit application and required documents and has made a finding that the request is consistent with Section 33-129.



Action Requested

- **Acceptance of the findings and recommendation of the Environmental Protection Division staff and approval of Shoreline Alteration/Dredge and Fill Permit SADF-23-08-021 for KTM Property Holdings, LLC, c/o Kyle Muehlstein, subject to the conditions listed in the staff report. District 1**