



Interoffice Memorandum

Received: October 7, 2021 @ 12:39pm

Publish: October 24, 2021

Deadline: October 19, 2021

DATE: September 17, 2021

TO: Katie A. Smith, Deputy Clerk of the Board of County Commissioners, County Comptroller's Office

THROUGH: Cheryl Gillespie, Supervisor, Agenda Development Office

FROM: Lisette M. Egipciaco, Development Coordinator Planning Division *Jme*

CONTACT PERSON(S): **Lisette M. Egipciaco,**
Development Coordinator
Planning Division 407-836-5684
Lisette.Egipciaco@ocfl.net

SUBJECT: Request for Board of County Commissioners Public Hearing

Project Name: Rhett's Ridge Preliminary Subdivision Plan
Case # PSP-21-03-084

Type of Hearing: Preliminary Subdivision Plan

Applicant(s): Lance Jackson
Lennar Homes
6750 Forum Drive, Suite 310
Orlando, Florida 32821

Commission District: 2

General Location: South of West Lester Road / East of Plymouth Sorrento Road

Parcel ID #(s) 31-20-28-0000-00-004, 31-20-28-0000-00-023,
31-20-28-0000-00-025, 31-20-28-0000-00-031

of Posters: 2

Use: 120 Single-Family Residential Dwelling Units

Size / Acreage: 42.78

BCC Public Hearing
Required by: Orange County Code, Chapter 34, Article III,
Section 34-69 and Chapter 30, Article III, Section
30-89

Clerk's Advertising
Requirements: (1) At least 7 days before the BCC public hearing
date, publish an advertisement in the Legal
Notices section of *The Orlando Sentinel*
describing the particular request, the general
location of the subject property, and the date,
time, and place when the BCC public hearing will
be held;

and

(2) At least 7 days before the BCC public
hearing date, send notices of BCC public hearing
by U.S. mail to owners of property within 300 feet
of the subject property and beyond.

Spanish Contact Person: Para más información referente a esta vista
pública, favor de comunicarse con la División de
Planificación (Planning Division) al número 407-
836-8181.

Advertising Language:

This Preliminary Subdivision Plan (PSP) is a request to subdivide 42.78 gross acres in order to construct 120 single-family residential dwelling units; District 2; South of West Lester Road / East of Plymouth Sorrento Road.

Material Provided:

- (1) Names and last known addresses of property owners (*via email from Fiscal and Operational Support Division*);
- (2) Location map (*to be mailed to property owners*);
- (3) Site plan sheet (*to be mailed to property owners*).

Special Instructions to Clerk (if any):

Unless stated otherwise, the public hearing should be advertised to begin at 2:00 p.m., or as soon thereafter as the matter may be heard.

Please notify Lisette Egipciano of the scheduled date and time. The Planning Division will notify the applicant.

Attachments (location map and site plan sheet)

For questions regarding this map, please call the Planning Division at 407-836-5600.

Location Map

PSP-21-03-084

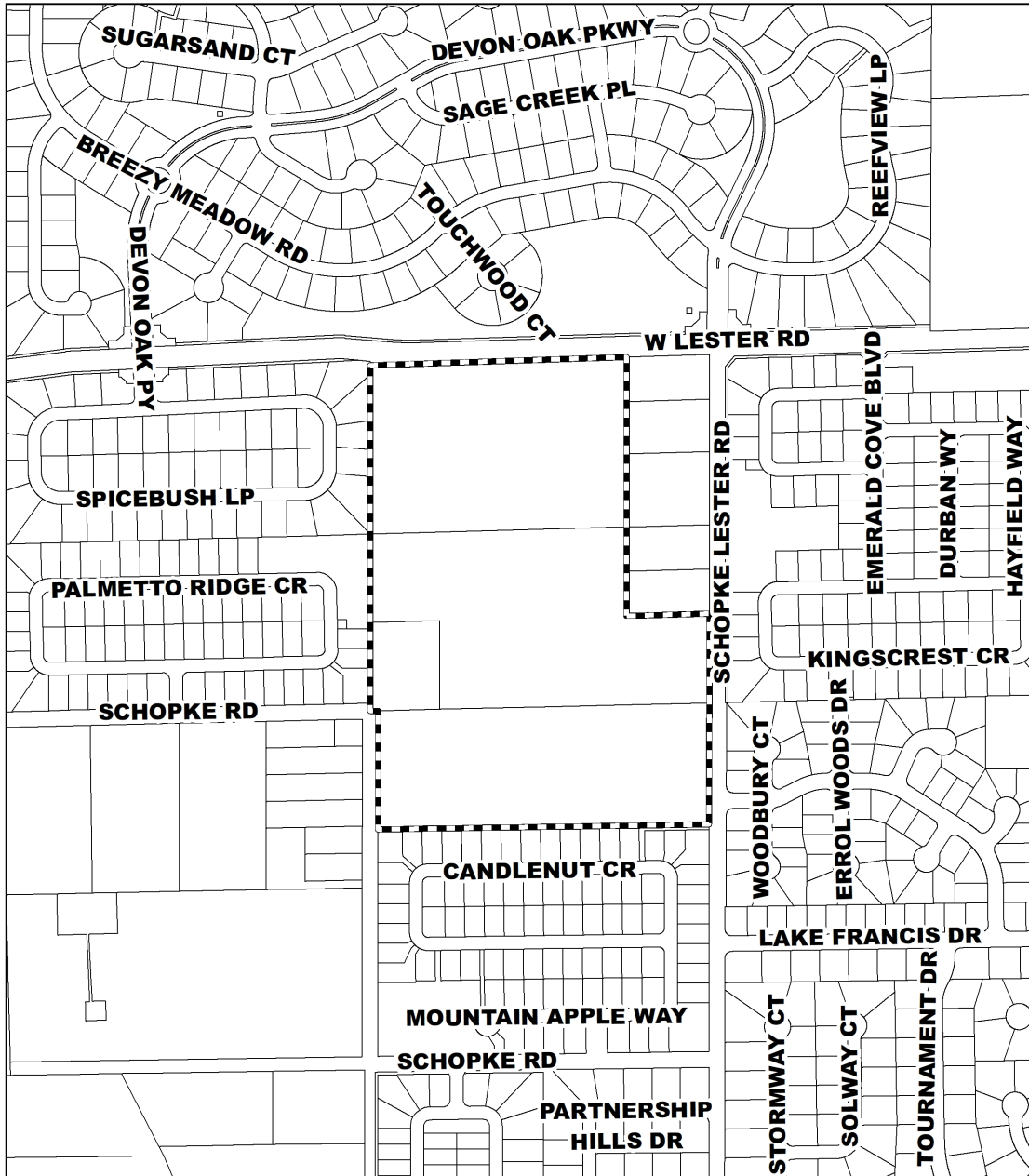

 Subject Property

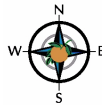

1 inch = 500 feet

Site Plan

J:\2020-04-0012 Rhett's Ridge\Design\Output\20-04-0012-PSP-MSP.dwg

Printed: Sep 06, 2021 4:26pm Printed By: rob

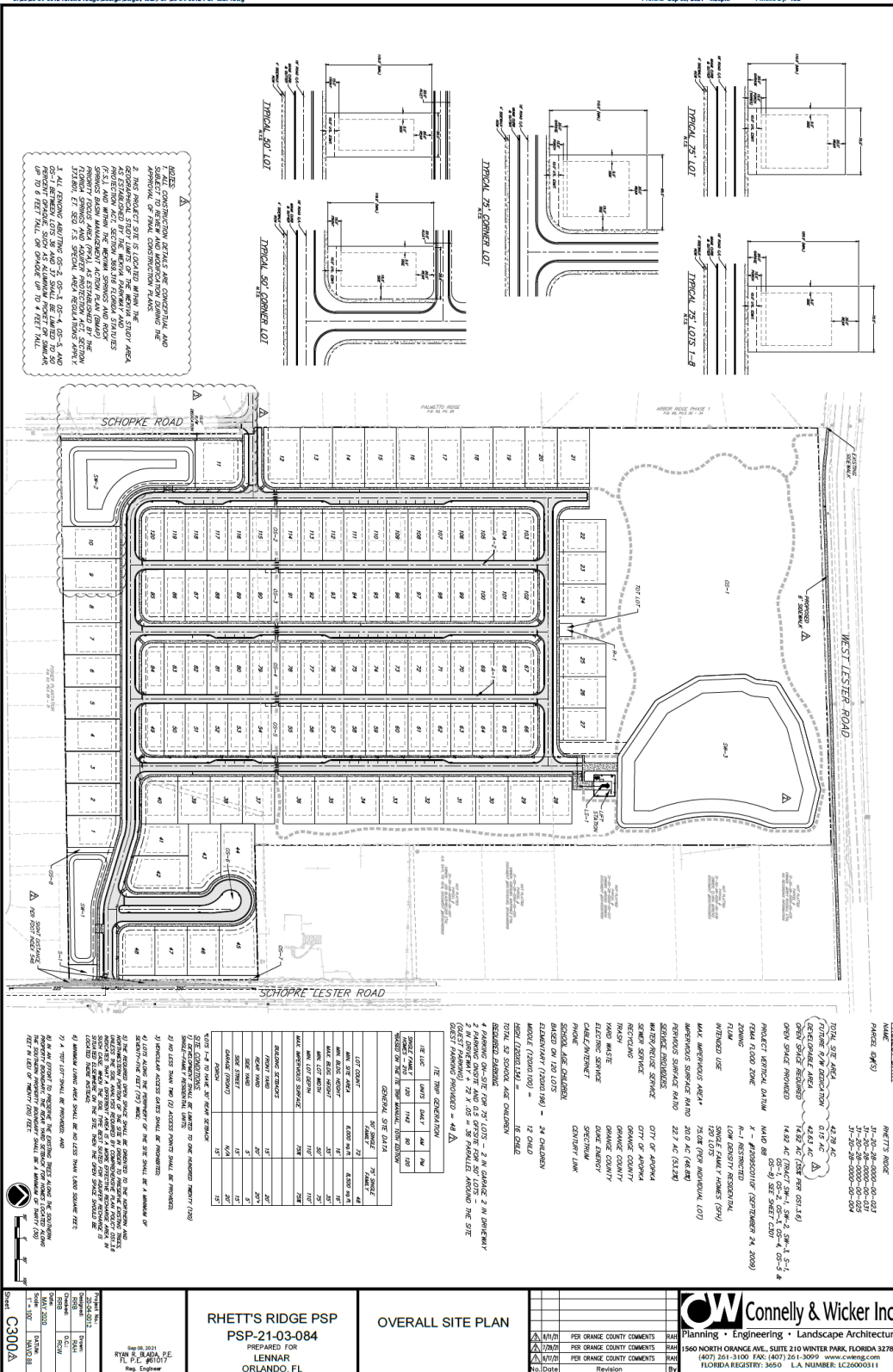

NOTES:
 1. ALL FINISH ELEVATIONS ARE TO FINISH GRADE UNLESS OTHERWISE NOTED.
 2. ALL LOT DIMENSIONS ARE TO BE TAKEN FROM THE CENTERLINE OF THE LOT.
 3. ALL LOT DIMENSIONS ARE TO BE TAKEN FROM THE CENTERLINE OF THE LOT.
 4. ALL LOT DIMENSIONS ARE TO BE TAKEN FROM THE CENTERLINE OF THE LOT.
 5. ALL LOT DIMENSIONS ARE TO BE TAKEN FROM THE CENTERLINE OF THE LOT.
 6. ALL LOT DIMENSIONS ARE TO BE TAKEN FROM THE CENTERLINE OF THE LOT.
 7. ALL LOT DIMENSIONS ARE TO BE TAKEN FROM THE CENTERLINE OF THE LOT.
 8. ALL LOT DIMENSIONS ARE TO BE TAKEN FROM THE CENTERLINE OF THE LOT.
 9. ALL LOT DIMENSIONS ARE TO BE TAKEN FROM THE CENTERLINE OF THE LOT.
 10. ALL LOT DIMENSIONS ARE TO BE TAKEN FROM THE CENTERLINE OF THE LOT.

PROJECT DATA
 NAME: RHETT'S RIDGE
 ADDRESS: 1560 NORTH ORANGE AVE., SUITE 210 WINTER PARK, FLORIDA 32789
 PHONE: (407) 261-3100 FAX: (407) 261-3009 www.cwong.com
 LICENSE NUMBER: 1270000111

GENERAL NOTES:
 1. THE SITE PLAN IS SUBJECT TO THE APPROVAL OF THE CITY OF ORANGE AND THE FLORIDA DEPARTMENT OF TRANSPORTATION (FDOT).
 2. THE SITE PLAN IS SUBJECT TO THE APPROVAL OF THE FLORIDA DEPARTMENT OF TRANSPORTATION (FDOT).
 3. THE SITE PLAN IS SUBJECT TO THE APPROVAL OF THE FLORIDA DEPARTMENT OF TRANSPORTATION (FDOT).
 4. THE SITE PLAN IS SUBJECT TO THE APPROVAL OF THE FLORIDA DEPARTMENT OF TRANSPORTATION (FDOT).
 5. THE SITE PLAN IS SUBJECT TO THE APPROVAL OF THE FLORIDA DEPARTMENT OF TRANSPORTATION (FDOT).
 6. THE SITE PLAN IS SUBJECT TO THE APPROVAL OF THE FLORIDA DEPARTMENT OF TRANSPORTATION (FDOT).
 7. THE SITE PLAN IS SUBJECT TO THE APPROVAL OF THE FLORIDA DEPARTMENT OF TRANSPORTATION (FDOT).
 8. THE SITE PLAN IS SUBJECT TO THE APPROVAL OF THE FLORIDA DEPARTMENT OF TRANSPORTATION (FDOT).
 9. THE SITE PLAN IS SUBJECT TO THE APPROVAL OF THE FLORIDA DEPARTMENT OF TRANSPORTATION (FDOT).
 10. THE SITE PLAN IS SUBJECT TO THE APPROVAL OF THE FLORIDA DEPARTMENT OF TRANSPORTATION (FDOT).

TYPE	DATE	BY	REVISION
1	09/06/2021	rob	ISSUED FOR PERMITS
2	09/06/2021	rob	REVISED PER COMMENTS
3	09/06/2021	rob	REVISED PER COMMENTS
4	09/06/2021	rob	REVISED PER COMMENTS
5	09/06/2021	rob	REVISED PER COMMENTS
6	09/06/2021	rob	REVISED PER COMMENTS
7	09/06/2021	rob	REVISED PER COMMENTS
8	09/06/2021	rob	REVISED PER COMMENTS
9	09/06/2021	rob	REVISED PER COMMENTS
10	09/06/2021	rob	REVISED PER COMMENTS

RHETT'S RIDGE PSP
PSP-21-03-084
 PREPARED FOR
LENNAR
 ORLANDO, FL

OVERALL SITE PLAN

CW Connelly & Wicker Inc.
 Planning • Engineering • Landscape Architecture
 1560 NORTH ORANGE AVE., SUITE 210 WINTER PARK, FLORIDA 32789
 (407) 261-3100 FAX: (407) 261-3009 www.cwong.com
 FLORIDA REGISTERED PROFESSIONAL ENGINEER LICENSE NUMBER: 1270000111