



Interoffice Memorandum

Received: June 30, 2021 @ 10:51am

Publish: July 11, 2021

Deadline: July 6, 2021

DATE: June 30, 2021

TO: Katie A. Smith, Deputy Clerk of the Board of County Commissioners, County Comptroller's Office

THROUGH: Cheryl Gillespie, Supervisor, Agenda Development Office

FROM: Lisette M. Egipciaco, Development Coordinator Planning Division *Jme*

CONTACT PERSON(S): **Lisette M. Egipciaco,**
Development Coordinator
Planning Division 407-836-5684
Lisette.Egipciaco@ocfl.net

SUBJECT: Request for Board of County Commissioners Public Hearing

Project Name: Thompson Road Townhomes Planned Development / Thompson Road Townhomes Preliminary Subdivision Plan Case # PSP-20-08-228

Type of Hearing: Preliminary Subdivision Plan

Applicant(s): Stephen Orosz
Thompson Road, LLC
605 Commonwealth Avenue
Orlando, Florida 32803

Commission District: 2

General Location: North side of East 1st Street / East of South Thompson Road

Parcel ID #(s) 11-21-28-0000-00-246, 11-21-28-0000-00-005

of Posters: 1

Use: 92 Single-Family Attached Residential Dwelling Units

Size / Acreage: 15.33

BCC Public Hearing Required by: Orange County Code, Chapter 34, Article III, Section 34-69 and Chapter 30, Article III, Section 30-89

Clerk's Advertising Requirements: (1) At least 7 days before the BCC public hearing date, publish an advertisement in the Legal Notices section of *The Orlando Sentinel* describing the particular request, the general location of the subject property, and the date, time, and place when the BCC public hearing will be held;

and

(2) At least 7 days before the BCC public hearing date, send notices of BCC public hearing by U.S. mail to owners of property within 300 feet of the subject property and beyond.

Spanish Contact Person: Para más información referente a esta vista pública, favor de comunicarse con la División de Planificación (Planning Division) al número 407-836-8181.

Advertising Language:

This Preliminary Subdivision Plan (PSP) is a request to subdivide 15.33 acres in order to construct 92 single-family attached residential dwelling units, District 2, North side of East 1st Street / East of South Thompson Road.

Material Provided:

- (1) Names and last known addresses of property owners (*via email from Fiscal and Operational Support Division*);
- (2) Location map (*to be mailed to property owners*);
- (3) Site plan sheet (*to be mailed to property owners*).

Special Instructions to Clerk (if any):

Unless stated otherwise, the public hearing should be advertised to begin at 2:00 p.m., or as soon thereafter as the matter may be heard.

Please notify Lisette Egipciano of the scheduled date and time. The Planning Division will notify the applicant.

Attachments (location map and site plan sheet)

Location Map

PSP-20-08-228

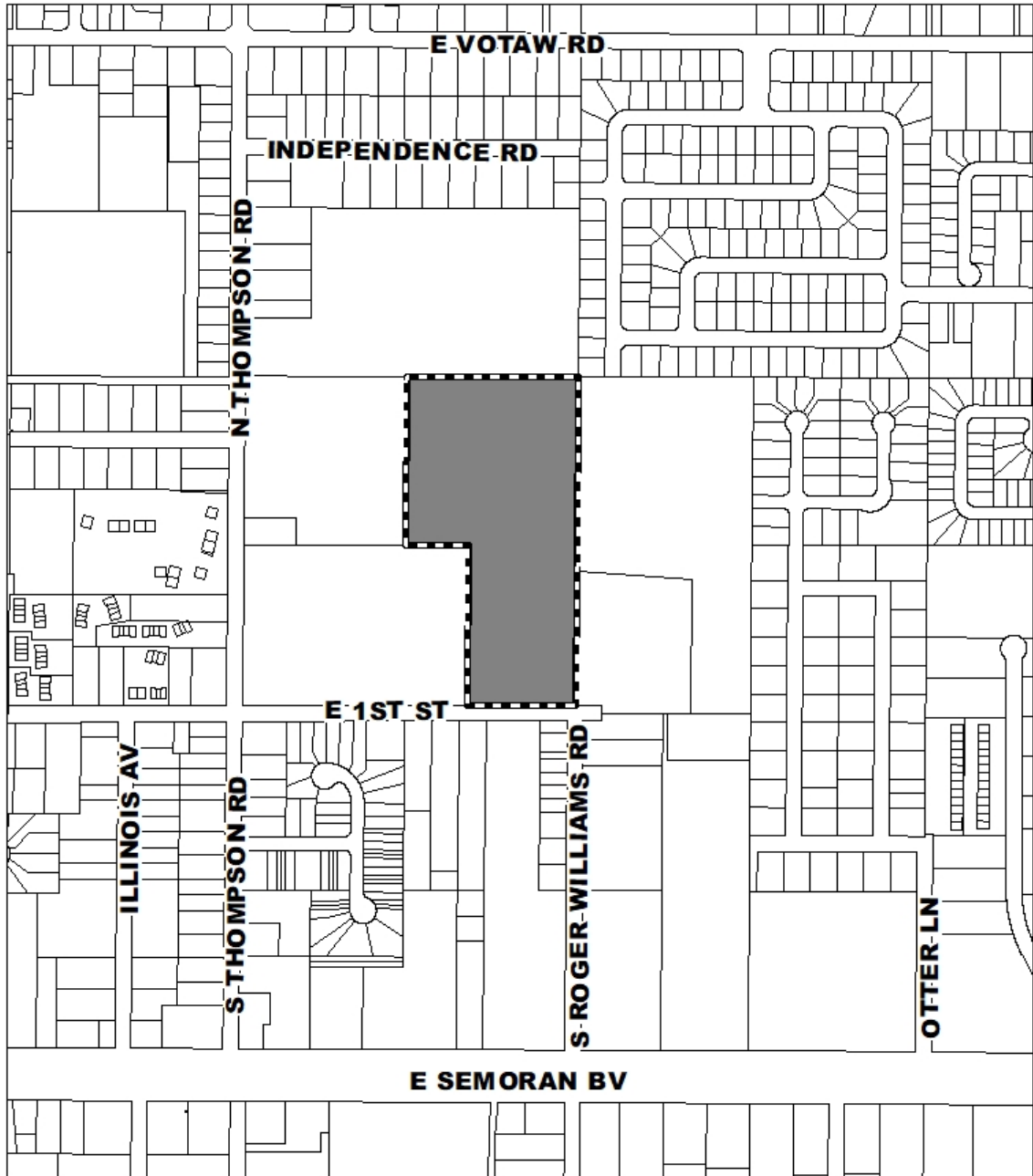

 Subject Property



1 inch = 500 feet

For questions regarding this map, please call Lisette Egipciaco at 407.836.5684

