



Interoffice Memorandum

REAL ESTATE MANAGEMENT ITEM 9

**DATE:** July 2, 2021

**TO:** Mayor Jerry L. Demings  
-AND-  
County Commissioners

**THROUGH:** Mindy T. Cummings, Manager  
Real Estate Management Division *MTC*

**FROM:** Mary Tiffault, Senior Title Examiner  
Real Estate Management Division *MT/MTC*

**CONTACT PERSON:** **Mindy T. Cummings, Manager**

**DIVISION:** **Real Estate Management**  
**Phone: (407) 836-7090**

**ACTION REQUESTED:** Approval of Signalization and Sidewalk Easement from Pointe Orlando Development Company to Orange County and authorization to record instrument

**PROJECT:** Pointe Orlando  
  
District 6

**PURPOSE:** To provide for access, construction, operation, and maintenance of roadway improvements as a requirement of development.

**ITEM:** Signalization and Sidewalk Easement (Instrument 801.1)  
Cost: Donation  
Size: 5,144 square feet

**APPROVALS:** Real Estate Management Division  
Public Works Department

**REMARKS:** Grantor to pay all recording fees

APPROVED  
BY ORANGE COUNTY BOARD  
OF COUNTY COMMISSIONERS  
JUL 27 2021

THIS IS A DONATION

Instrument: 801.1  
Project: Pointe Orlando

**SIGNALIZATION AND SIDEWALK EASEMENT**

THIS SIGNALIZATION AND SIDEWALK EASEMENT, made and executed the 27<sup>th</sup> day of August, A.D. 2020, by Pointe Orlando Development Company, a California general partnership, whose address is C/O Thomson Reuters, Inc. P.O. Box 4900 Dept 124, Scottsdale, AZ 85261, GRANTOR, and ORANGE COUNTY, a charter county and a political subdivision of the state of Florida, whose address is P. O. Box 1393, Orlando, Florida 32802-1393, GRANTEE.

WITNESSETH, That the GRANTOR, in consideration of the sum of \$10.00 and other valuable considerations, paid by the GRANTEE, the receipt whereof is hereby acknowledged, does hereby give and grant to the GRANTEE, its successors and assigns, a Signalization and Sidewalk Easement more particularly defined in Schedule "B" over and upon the following described lands of the GRANTOR situate in Orange County, Florida, to-wit:

**SEE ATTACHED SCHEDULE "A" (the "Easement Area")**

**Property Appraiser's Parcel Identification Number:**

**a portion of**

**36-23-28-7165-00-017**

TO HAVE AND TO HOLD said easement unto said GRANTEE and its successors and assigns forever.

THE GRANTOR covenants with the GRANTEE that the GRANTOR is lawfully seized of said lands in fee simple; that the GRANTOR has good right and lawful authority to grant this easement and shall take no action to interfere with the GRANTEE'S lawful use of said easement; that the GRANTOR hereby fully warrants the easement being granted and will defend the same against the lawful claims of all persons whomsoever.

IN WITNESS WHEREOF, the GRANTOR has caused these presents to be executed in its name.

Signed, sealed, and delivered  
in the presence of:

Pointe Orlando Development Company,  
a California general partnership

[Signature]  
Witness

By: Brixmor ERT LLC, a Delaware limited  
liability company, its General Partner

Printed Name: Vandehi Patel

By: [Signature]  
Matthew Ryan, Senior Vice President

[Signature]  
Witness

Printed Name: Rishabh Patel

(Signature of TWO witnesses required by Florida law)

STATE OF GA

COUNTY OF Fulton

The foregoing instrument was acknowledged before me by means of  physical presence  
or  online notarization this 27 day of August, 2020, by Matthew Ryan, Senior Vice  
President of Brixmor ERT LLC, a Delaware limited liability company, as General Partner, of Pointe  
Orlando Development Company, a California general partnership on behalf of the partnership. He [ ] is  
personally known to me, or  has produced GA DL as identification.

(Notary Seal)

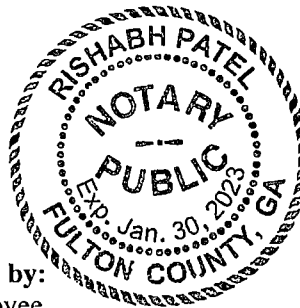

Rishabh Patel  
Notary Signature

Rishabh Patel  
Printed Notary Name

Notary Public in and for  
the County and State aforesaid

My commission expires: 01/30/2023

This instrument prepared by:  
Mary Tiffault, a staff employee  
in the course of duty with the  
Real Estate Management Division  
of Orange County, Florida

# SKETCH OF DESCRIPTION

SHEET 1 OF 2

## SCHEDULE "A"

### LEGAL DESCRIPTION:

A PARCEL OF LAND BEING A PORTION OF LOT 1, PLAZA INTERNATIONAL UNIT ELEVEN, ACCORDING TO THE PLAT THEREOF, AS RECORDED IN PLAT BOOK 28, PAGE 5, OF THE PUBLIC RECORDS OF ORANGE COUNTY, FLORIDA, BEING MORE PARTICULARLY DESCRIBED AS FOLLOWS:

COMMENCE AT THE MOST NORTHERLY CORNER LYING ON THE WEST LINE OF SAID LOT 1, SAID POINT BEING A POINT ON A CURVE CONCAVE NORTHWESTERLY; THENCE, ALONG WEST LINE OF SAID LOT 1, RUN THE FOLLOWING THREE (3) COURSES:

(1) RUN SOUTHWESTERLY ALONG THE ARC OF SAID CURVE, HAVING A RADIUS LENGTH OF 2562.50 FEET, A CENTRAL ANGLE OF 05°35'42", AN ARC LENGTH OF 250.22 FEET, A CHORD LENGTH OF 250.13 FEET, AND A CHORD BEARING OF SOUTH 26°38'21" WEST TO A POINT OF REVERSE CURVATURE OF A CURVE CONCAVE EASTERLY; (2) SOUTHERLY ALONG THE ARC OF SAID CURVE, HAVING A RADIUS LENGTH OF 2382.50 FEET, A CENTRAL ANGLE OF 45°18'19", AN ARC LENGTH OF 1883.90 FEET, A CHORD LENGTH OF 1835.21 FEET, AND A CHORD BEARING OF SOUTH 06°47'03" WEST TO THE NORTHWEST CORNER OF THE LANDS DESCRIBED IN OFFICIAL RECORDS BOOK 4993, PAGE 3856, PUBLIC RECORDS OF ORANGE COUNTY, FLORIDA; (3) CONTINUE SOUTHERLY ALONG THE ARC OF SAID CURVE CONCAVE EASTERLY, HAVING A RADIUS LENGTH OF 2382.50 FEET, A CENTRAL ANGLE OF 03°59'37", AN ARC LENGTH OF 166.06 FEET, A CHORD LENGTH OF 166.03 FEET, AND A CHORD BEARING OF S17°36'15"E FOR A POINT OF BEGINNING; THENCE S56°50'08"E A DISTANCE OF 99.80 FEET; THENCE S42°42'42"E A DISTANCE OF 59.60 FEET; THENCE S22°20'39"E A DISTANCE OF 13.91 FEET; THENCE S70°57'37"W A DISTANCE OF 79.89 FEET TO SAID WEST LINE OF LOT 1, BEING A NON-TANGENT POINT ON A CURVE CONCAVE NORTHEASTERLY, HAVING A RADIUS OF 2382.50 FEET, A CHORD BEARING OF N22°54'24"W, A CHORD DISTANCE OF 20.05 FEET, RUN THENCE NORTHWESTERLY ALONG THE ARC OF SAID CURVE AND SAID WEST LINE OF LOT 1, THROUGH A CENTRAL ANGLE OF 00°28'55", A DISTANCE OF 20.05 FEET; THENCE N70°57'37"E A DISTANCE OF 45.84 FEET; THENCE N47°43'13"W A DISTANCE OF 103.90 FEET TO SAID WEST LINE OF LOT 1 BEING A NON-TANGENT POINT ON A CURVE CONCAVE NORTHEASTERLY, HAVING A RADIUS OF 2382.50 FEET, A CHORD BEARING OF N20°02'10"W, A CHORD DISTANCE OF 36.18 FEET, RUN THENCE NORTHWESTERLY ALONG THE ARC OF SAID CURVE AND SAID WEST LINE OF LOT 1, THROUGH A CENTRAL ANGLE OF 00°52'13", A DISTANCE OF 36.18 FEET TO THE POINT OF BEGINNING.

CONTAINS 5,144 SQUARE FEET MORE OR LESS.

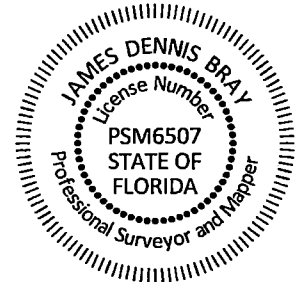

JOB #903127
CF #ORG-9101 INTERNATIONAL DR-TRAFFIC-SOD
DATE: 10/11/19
SCALE: 1" = 60'
DRAWN BY: SAH

**CERTIFIED TO:**  
Brixmor Property Group

LEGEND	
⊘	- CENTERLINE
CBW	- CONCRETE BLOCK WALL
CLF	- CHAIN LINK FENCE
CM	- CONCRETE MONUMENT
CONC	- CONCRETE
COVD	- COVERED
CW	- CONCRETE WALKWAY
Δ	- CENTRAL ANGLE
(D)	- DESCRIBED
DB	- DEED BOOK
DE	- DRAINAGE EASEMENT
DW	- DRIVEWAY
EP	- EDGE OF PAVEMENT
ESMT	- EASEMENT
FH	- FIRE HYDRANT
FFE	- FINISHED FLOOR ELEVATION
FND	- FOUND
INST	- INSTRUMENT NUMBER
IP	- IRON PIPE
IR	- IRON ROD
L	- ARC LENGTH
(M)	- MEASURED
MS	- METAL SHED
N&D	- NAIL AND DISK
ORB	- OFFICIAL RECORDS BOOK
OW	- OVERHEAD WIRE
(P)	- PLAT
PB	- PLAT BOOK
PG	- PAGE
POB	- POINT OF BEGINNING
POC	- POINT OF COMMENCEMENT
R/W	- RIGHT OF WAY
R	- RADIUS
TR	- TELEPHONE RISER
TYP	- TYPICAL
UE	- UTILITY EASEMENT
UP	- UTILITY POLE
#	- NUMBER

REVISIONS
2/4/2020; Correct typo; JB
2/14/2020; Remove vacated esmt; JB
2/27/2020; Corrected 3859 to 3856; JB
4/07/2020; New Boundary; SAH

**GENERAL NOTES:**

- Bearing structure based on the North line of the lands described in Official Records Book 4993, Page 3856, public records of Orange county, Florida being: N89°01'09"E
- This surveyor has not made a search of the public records for any dedications, limitations, restrictions or easements other than shown hereon.
- This Sketch of Description has been made for the exclusive use of the entities prepared for, heron and does not extend to any unnamed parties.
- This Sketch of Description is not a Survey.
- This Sketch is "Not Valid" without the signature and the original raised seal of this Florida licensed Surveyor and Mapper, unless provided with electronic signature with the ability to validate. (See: [www.altamaxsurveying.com](http://www.altamaxsurveying.com) for instructions on signature validation). The seal appearing on this document was authorized by signing Professional Surveyor and Mapper on the Date of the electronic signature.

**Altamax Surveying**  
910 Belle Avenue, Suite 1140  
Casselberry, FL 32708  
Phone: 407-677-0200  
Licensed Business No. 7833  
[www.altamaxsurveying.com](http://www.altamaxsurveying.com)

James D. Bray PSM 6507

# SKETCH OF DESCRIPTION

SHEET 2 OF 2

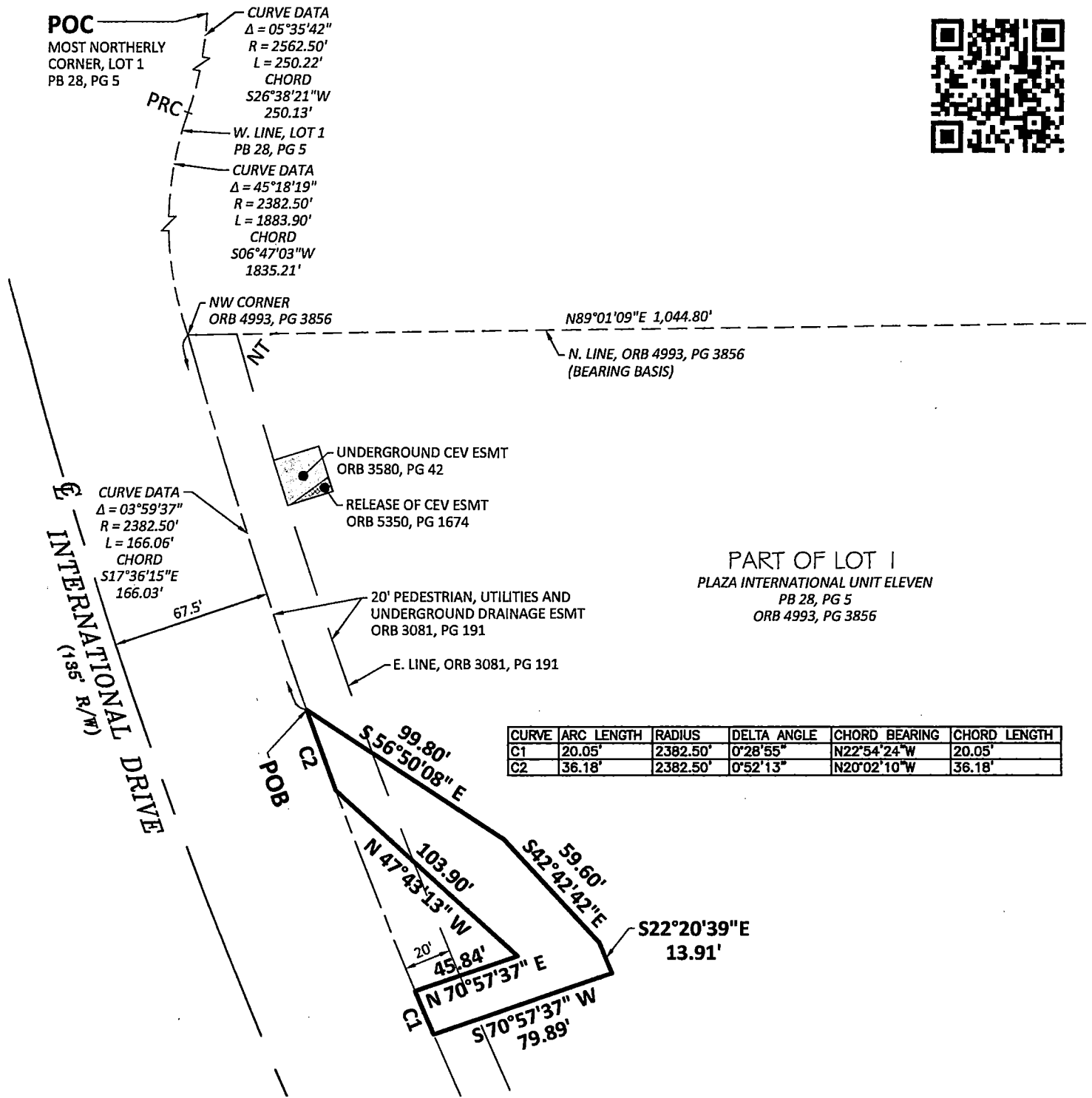

PART OF LOT 1  
PLAZA INTERNATIONAL UNIT ELEVEN  
PB 28, PG 5  
ORB 4993, PG 3856

CURVE	ARC LENGTH	RADIUS	DELTA ANGLE	CHORD BEARING	CHORD LENGTH
C1	20.05'	2382.50'	0°28'55"	N22°54'24"W	20.05'
C2	36.18'	2382.50'	0°52'13"	N20°02'10"W	36.18'

**Altamax Surveying**  
 910 Belle Avenue, Suite 1140  
 Casselberry, FL 32708  
 Phone: 407-677-0200  
 Licensed Business No. 7833  
 www.altamaxsurveying.com

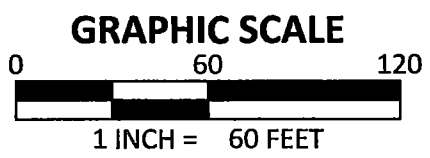
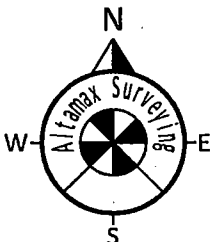

**SCHEDULE "B"**

**POINTE ORLANDO PARCEL 801**

**SIGNALIZATION AND SIDEWALK EASEMENT**

Parcel 801 is being acquired as a perpetual, non-exclusive easement for public traffic signal and traffic sign purposes, with full authority to enter upon, construct, operate, and maintain, as the GRANTEE and its assigns may deem necessary a mast arm assembly, pedestrian signal and pedestal pole, interconnect, traffic signs, sidewalk, and appurtenant facilities over, under, and upon the Easement Area.

THE GRANTEE and its assigns shall have the right to clear and keep clear all trees, undergrowth, and other obstructions that may interfere with normal operation or maintenance of the mast arm assembly, pedestrian signal and pedestal pole, interconnect, traffic signs, sidewalk, and appurtenant facilities out of and away from the Easement Area, and the GRANTORS and their heirs, successors and assigns shall not build, construct, or create, nor permit others to build, construct, or create any building, utilities, or other structures within the Easement Area that may interfere with the normal operation or maintenance of the mast arm assembly, pedestrian signal and pedestal pole, interconnect, traffic signs, sidewalk, and appurtenant facilities. The signalization work will be done in accordance with the Orange County Public Works Signalization Plan for International Drive and Samoan Court, Revision 1 Submittal dated, May 8, 2020, as approved and more particularly shown on the Schedule "C" attached. ("Signalization Plans")

THE GRANTOR may use the granted easement for any use not inconsistent with the GRANTEE'S intended use of the granted easement including, but not limited to, open space, setback area, or any activity that will not adversely affect the operation, maintenance and integrity of the mast arm assembly, pedestrian signal and pedestal pole, interconnect, traffic signs, sidewalk, and appurtenant facilities. This easement is for the purposes noted herein and will be maintained by the GRANTEE.

**SCHEDULE "C"**  
**("SIGNALIZATION PLANS")**

[Attached are pages T-1, T-6, T-7 and T-8 from the Orange County Public Works Signalization Plan for International Drive and Samoan Court, Revision 1 Submittal dated, May 8, 2020, as approved.  
The remaining pages, T-2 through T-5 and T-9 through T-12 have been omitted]

PLANS EXPIRE

05/04/2021

APPROVED 5/14/2020

ARIF KHAN, E.I.  
FOR THE MANAGER,  
ENGINEERING DIVISION  
ORANGE COUNTY UTILITIES DEPARTMENT

THIS APPROVAL IS SUBJECT TO EXISTING REQUIREMENTS  
OF ORANGE COUNTY UTILITIES DIVISION STANDARDS  
AND SPECIFICATIONS.

PARCEL NO.: 36-23-28-0000-00-017

APPROVED provided, however, that all other applicable state or federal permits be obtained before commencement of the development. This approval does not in any way create any rights on the part of the applicant to obtain a permit from a state or federal agency and does not create any liability on the part of the county for issuance of the permit if the applicant fails to obtain requisite approvals or fulfill the obligations imposed by a state or federal agency or undertake actions that result in a violation of state or federal law.

VICINITY MAP

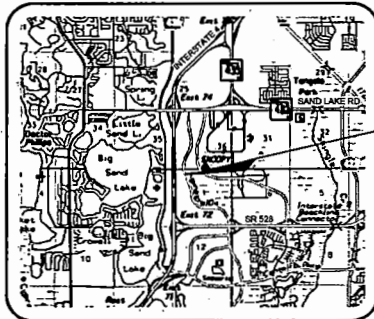

PROJECT LOCATION

NOTICE NOTICE

CONSTRUCTION IS NOT AUTHORIZED FOR SANITARY COLLECTION SYSTEMS, WATER DISTRIBUTION SYSTEMS, AND STORM WATER MANAGEMENT SYSTEMS UNTIL ALL APPLICABLE (FEDERAL, STATE, AND WATER MANAGEMENT DISTRICTS, ETC.) PERMITS ARE OBTAINED.

# ORANGE COUNTY PUBLIC WORKS

## SIGNALIZATION PLAN FOR

## INTERNATIONAL DRIVE AND SAMOAN COURT

PREPARED FOR:



POINTE ORLANDO DEVELOPMENT COMPANY  
BRIXMOR PROPERTY GROUP  
1003 HOLCOMB BRIDGE WOODS PARKWAY  
ROSWELL, GA 30076  
TEL: 770.360.8400  
WWW.BRIXMOR.COM

SIGNALIZATION ENGINEER

**ATKINS**  
452 SOUTH KELLER RD  
ORLANDO, FL 32810  
TEL: 407.543.7275  
FAX: 407.306.4500  
PAUL MANNIX, P.E., PTOE NO. 57712

REVISIONS:

- T-2, T-3, T-4, T-5, T-6, T-7, T-8, T-11, T-12, T-13

### UNDERGROUND UTILITY PERMIT AND FEE REQUIRED

REVISION 1 SUBMITTAL

MAY 8, 2020

THIS APPROVAL IS SUBJECT TO EXISTING REQUIREMENTS OF ORANGE COUNTY FLORIDA, AND ANY SPECIAL REQUIREMENTS OF THE ORANGE COUNTY COMMISSION

APPROVED

FRANCISCO J. VILLAR, P.E.  
FOR THE ORANGE COUNTY ENGINEER

May 14, 2020

DATE

THIS DOCUMENT HAS BEEN DIGITALLY  
SIGNED AND SEALED BY:

Paul J Mannix

2020.05.13

15:03:30 -04'00'

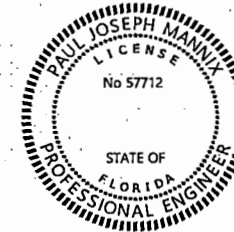

PRINTED COPIES OF THIS DOCUMENT ARE NOT CONSIDERED SIGNED AND SEALED. THE SIGNATURE MUST BE VERIFIED ON THE ELECTRONIC DOCUMENTS.

ATKINS NORTH AMERICA, INC.  
482 SOUTH KELLER ROAD  
ORLANDO, FLORIDA 32810  
CERTIFICATE OF AUTHORIZATION: 24  
PAUL MANNIX, P.E. #57712

LOCATION MAP

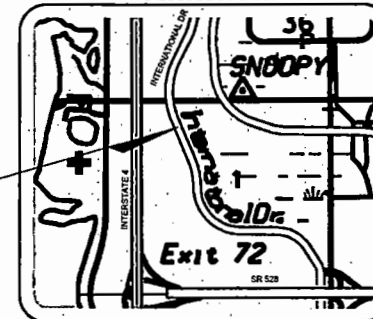

PROJECT LOCATION  
<https://goo.gl/maps/8eTprBnDM29RZDU9>

### RIGHT-OF-WAY PERMIT REQUIRED

ISSUE FOR PERMIT

SHEET NO.

7-1

THE OFFICIAL RECORD OF THIS SHEET IS THE ELECTRONIC FILE DIGITALLY SIGNED AND SEALED UNDER RULE 61G14-23.004, F.A.C.



THIS APPROVAL IS SUBJECT TO EXISTING REQUIREMENTS OF ORANGE COUNTY FLORIDA, AND ANY SPECIAL REQUIREMENTS OF THE ORANGE COUNTY COMMISSION

APPROVED

*Francisco Villar*

FRANCISCO J. VILLAR, P.E.  
FOR THE ORANGE COUNTY ENGINEER

May 14, 2020

DATE

APPROVED

5/14/2020

ARIF KHAN, E.I.

FOR THE MANAGER,  
ENGINEERING DIVISION  
ORANGE COUNTY UTILITIES DEPARTMENT

THIS APPROVAL IS SUBJECT TO EXISTING REQUIREMENTS OF ORANGE COUNTY UTILITIES DIVISION STANDARDS AND SPECIFICATIONS.

REMOVAL ITEMS

- SIGNAL CABLE, REMOVE
- 632-7-6 1 PI
- TRAFFIC SIGNAL CONTROLLER CABINET, REMOVE
- 676-1-600 1 EA

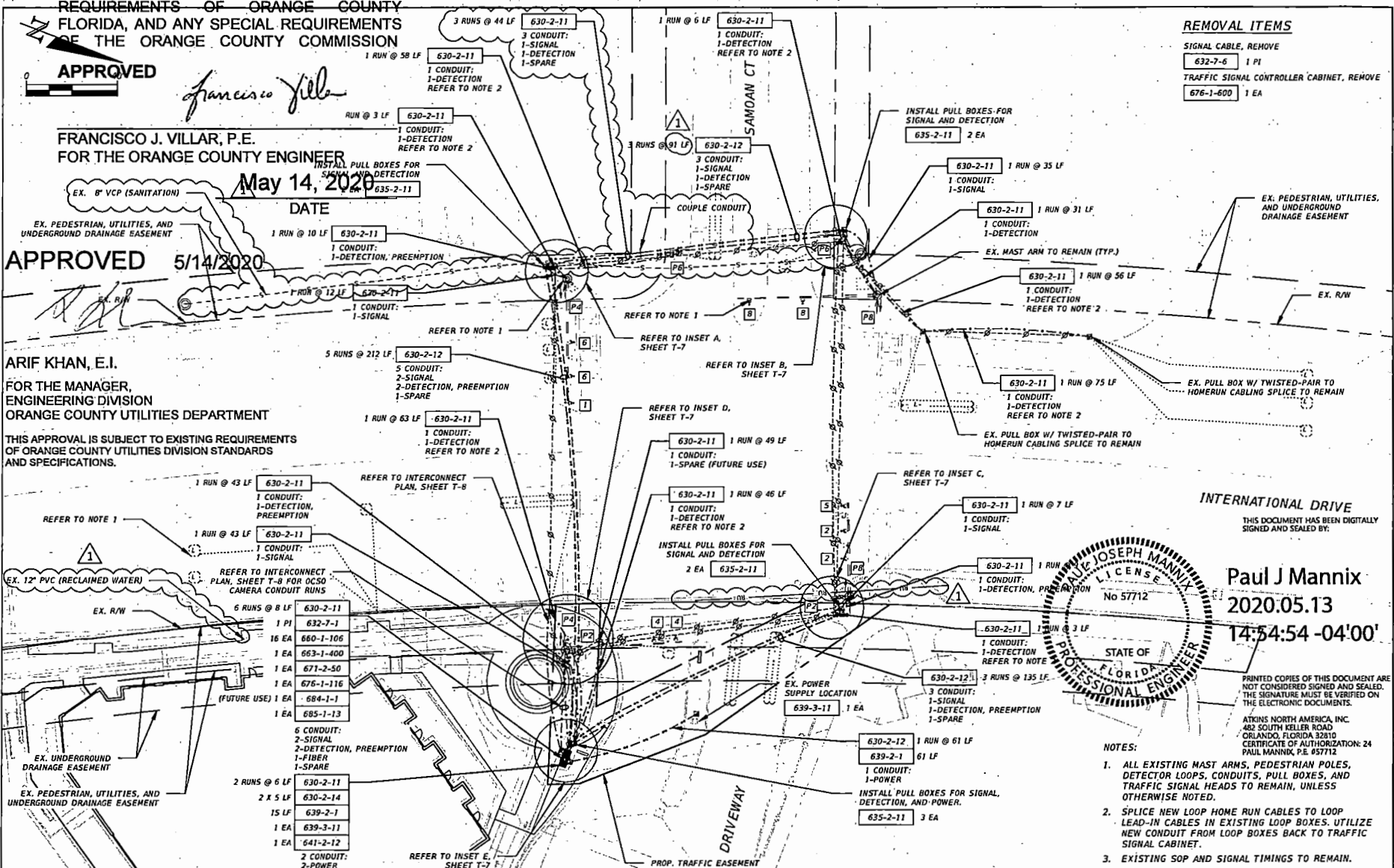

INTERNATIONAL DRIVE  
THIS DOCUMENT HAS BEEN DIGITALLY SIGNED AND SEALED BY:

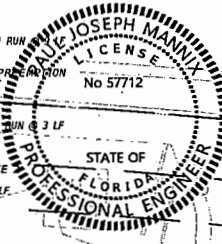

Paul J Mannix  
2020.05.13  
14:54:54 -04'00'

PRINTED COPIES OF THIS DOCUMENT ARE NOT CONSIDERED SIGNED AND SEALED. THE SIGNATURE MUST BE VERIFIED ON THE ELECTRONIC DOCUMENTS.

ATKINS NORTH AMERICA, INC.  
482 SOUTH KELLER ROAD  
ORLANDO, FLORIDA 32810  
CERTIFICATE OF AUTHORIZATION: 24  
PAUL MANNIX, P.E. 057712

NOTES:

1. ALL EXISTING MAST ARMS, PEDESTRIAN POLES, DETECTOR LOOPS, CONDUITS, PULL BOXES, AND TRAFFIC SIGNAL HEADS TO REMAIN, UNLESS OTHERWISE NOTED.
2. SPLICE NEW LOOP HOME RUN CABLES TO LOOP LEAD-IN CABLES IN EXISTING LOOP BOXES. UTILIZE NEW CONDUIT FROM LOOP BOXES BACK TO TRAFFIC SIGNAL CABINET.
3. EXISTING SOP AND SIGNAL TIMINGS TO REMAIN.

REVISIONS	
DATE	DESCRIPTION
5/8/20	ADDED CALLOUTS FOR EXISTING UTILITY LINES TO REMAIN & AVOID

ATKINS NORTH AMERICA, INC.  
482 SOUTH KELLER ROAD  
ORLANDO, FL 32810  
(407) 647-7275  
CERTIFICATE OF AUTHORIZATION NO. 24  
PAUL MANNIX, P.E., PTOE NO. 57712

ORANGE COUNTY  
PUBLIC WORKS  
INTERNATIONAL DRIVE  
AND SAMOAN COURT

SIGNALIZATION PLAN (1)

SHEET NO.  
T-6

THE OFFICIAL RECORD OF THIS SHEET IS THE ELECTRONIC FILE DIGITALLY SIGNED AND SEALED UNDER RULE 61G15-23.004, F.A.C.

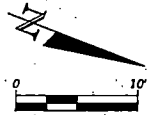

INSET A

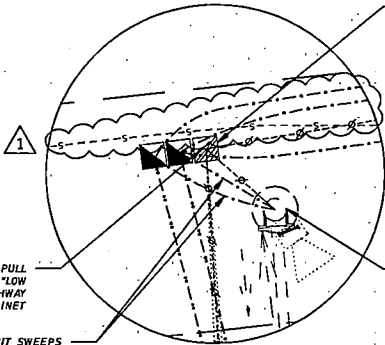

INSTALL CONDUIT TO TIE EX. PULL BOX (TO REMAIN) AND PROP. "LOW VOLTAGE" SIGNAL BOX FOR PATHWAY BACK TO CONTROLLER CABINET

INTERCEPT EXISTING CONDUIT SWEEPS INTO MAST ARM W/ NEW CONDUITS; ROUTE INTO PROP. PULL BOXES

EX. PULL BOX W/ TWISTED-PAIR TO HOMERUN CABLING SPLICE TO REMAIN; INSTALL NEW HOMERUN CABLING AND SPLICE.

THIS APPROVAL IS SUBJECT TO EXISTING REQUIREMENTS OF ORANGE COUNTY FLORIDA, AND ANY SPECIAL REQUIREMENTS OF THE ORANGE COUNTY COMMISSION

APPROVED

*Francisco Villar*

FRANCISCO VILLAR, P.E.  
FOR THE ORANGE COUNTY ENGINEER

May 14, 2020  
DATE

INSET B

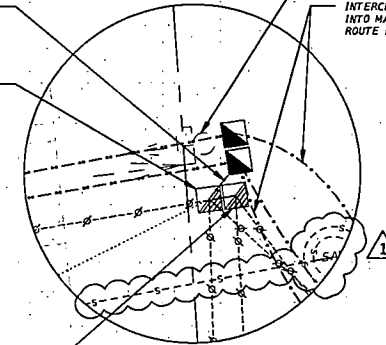

EX. PEDESTAL POLE TO REMAIN (TYP.)

INTERCEPT EXISTING CONDUIT SWEEPS INTO MAST ARM W/ NEW CONDUITS; ROUTE INTO PROP. PULL BOXES

INSTALL CONDUIT TO TIE EX. PULL BOX (TO REMAIN) AND PROP. "LOW VOLTAGE" SIGNAL BOX FOR PATHWAY BACK TO CONTROLLER CABINET

EX. PULL BOX W/ TWISTED-PAIR TO HOMERUN CABLING SPLICE TO REMAIN; INSTALL NEW HOMERUN CABLING AND SPLICE.

EX. PULL BOX TO REMAIN (TYP.)

THIS DOCUMENT HAS BEEN DIGITALLY SIGNED AND SEALED BY:

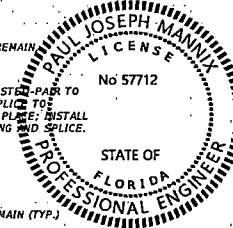

Paul J Mannix  
2020.05.13  
14:53:30 -04'00'

PRINTED COPIES OF THIS DOCUMENT ARE NOT CONSIDERED SIGNED AND SEALED. THE SIGNATURE MUST BE VERIFIED ON THE ELECTRONIC DOCUMENTS.

ATKINS NORTH AMERICA, INC.  
482 SOUTH KELLER ROAD  
ORLANDO, FLORIDA 32810  
CERTIFICATE OF AUTHORIZATION: 24  
PAUL MANNIX, P.E. #57712

INSET E

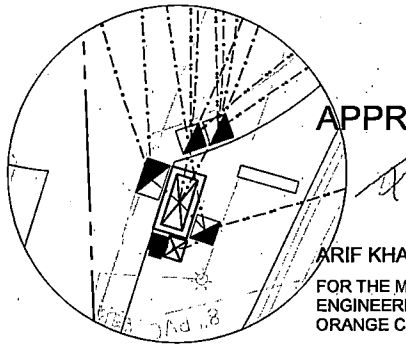

EX. PULL BOX W/ TWISTED-PAIR TO HOMERUN CABLING SPLICE TO REMAIN, PROTECT IN PLACE; INSTALL NEW HOMERUN CABLING AND SPLICE.

INTERCEPT EXISTING CONDUIT SWEEPS INTO MAST ARM W/ NEW CONDUITS; ROUTE INTO PROP. PULL BOXES

APPROVED 5/14/2020

ARIF KHAN, E.I.  
FOR THE MANAGER,  
ENGINEERING DIVISION  
ORANGE COUNTY UTILITIES DEPARTMENT

THIS APPROVAL IS SUBJECT TO EXISTING REQUIREMENTS OF ORANGE COUNTY UTILITIES DIVISION STANDARDS AND SPECIFICATIONS.

INSTALL CONDUIT RISER INTO EX. OSCO CABINET; ROUTE PROP. & SH FOC FROM EX. OSCO CABINET TO CONTROLLER CABINET

EX. PULL BOXES TO REMAIN PROTECT IN PLACE

EX. PULL BOX W/ TWISTED-PAIR TO HOMERUN CABLING SPLICE TO REMAIN; PROTECT IN PLACE; INSTALL NEW HOMERUN CABLING AND SPLICE.

EX. MAST ARM TO REMAIN (TYP.)

INSET C

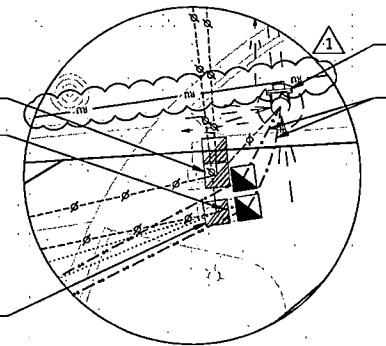

EX. MAST ARM TO REMAIN (TYP.)

INTERCEPT EXISTING CONDUIT SWEEPS INTO MAST ARM W/ NEW CONDUITS; ROUTE INTO PROP. PULL BOXES

INSTALL CONDUIT TO TIE EX. PULL BOX (TO REMAIN) AND PROP. "LOW VOLTAGE" SIGNAL BOX FOR PATHWAY BACK TO CONTROLLER CABINET

EX. PULL BOX W/ TWISTED-PAIR TO HOMERUN CABLING SPLICE TO REMAIN, PROTECT IN PLACE; INSTALL NEW HOMERUN CABLING AND SPLICE.

NOTES:

- 3-FOOT HORIZONTAL SEPARATION IS TO BE PROVIDED BETWEEN SANITARY MANHOLE AND CONDUIT. NOTE: SEPARATION IS TO BE MEASURED FROM OUTSIDE OF PIPE.

CONSTRUCTION DETAILS

REVISIONS		ATKINS NORTH AMERICA, INC. 482 SOUTH KELLER ROAD ORLANDO, FL 32810 (407) 647-7275 CERTIFICATE OF AUTHORIZATION NO. 24 PAUL MANNIX, P.E., PTOE NO. 57712	ORANGE COUNTY PUBLIC WORKS	INTERNATIONAL DRIVE AND SANDAN COURT	SIGNALIZATION PLAN (2)	SHEET NO.  T-7
DATE	DESCRIPTION					
5/8/20	ADDED CALLOUTS FOR EXISTING UTILITY LINES TO REMAIN & AVOID					

THE OFFICIAL RECORD OF THIS SHEET IS THE ELECTRONIC FILE DIGITALLY SIGNED AND SEALED UNDER RULE 61G15-23.004, F.A.C.

APPROVED 5/14/2020

ARIF KHAN, E.I.  
FOR THE MANAGER,  
ENGINEERING DIVISION  
ORANGE COUNTY UTILITIES DEPARTMENT

THIS APPROVAL IS SUBJECT TO EXISTING REQUIREMENTS OF ORANGE COUNTY UTILITIES DIVISION STANDARDS AND SPECIFICATIONS.

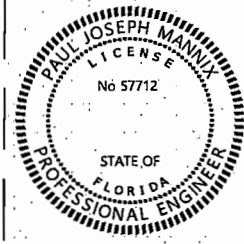

Paul J Mannix  
2020.05.13  
14:52:21 -04'00'

PRINTED COPIES OF THIS DOCUMENT ARE NOT CONSIDERED SIGNED AND SEALED. THE SIGNATURE MUST BE VERIFIED ON THE ELECTRONIC DOCUMENTS.

ATKINS NORTH AMERICA, INC.  
482 SOUTH KELLER ROAD  
ORLANDO, FLORIDA 32810  
CERTIFICATE OF AUTHORIZATION: 24  
PAUL J. MANNIX, P.E. #57712

THIS APPROVAL IS SUBJECT TO EXISTING REQUIREMENTS OF ORANGE COUNTY FLORIDA, AND ANY SPECIAL REQUIREMENTS OF THE ORANGE COUNTY COMMISSION

APPROVED

*Francisco Villar*

FRANCISCO J. VILLAR, P.E.  
FOR THE ORANGE COUNTY ENGINEER

May 14, 2020  
DATE

INTERNATIONAL DRIVE

FOR THE ORANGE COUNTY ENGINEER

May 14, 2020

DATE

EX. OCSO CABINET, CCTV CAMERA, AND HFES TO REMAIN

630-2-14	5 LF (6 SM)
633-1-121	5 LF
633-2-32	4 EA
633-3-14	1 EA
676-2-500	1 EA

REFER TO NOTES 2 & 3

INSTALL FIBER OPTIC PULL BOX

635-2-12	1 EA
----------	------

NOTES:

- DISCONNECT EX. 24 SM / 12 MM FOC FROM EX. TRAFFIC SIGNAL CABINET, PULL BACK EX. 24 SM / 12 MM FOC TO EX. FO PULL BOX, PULL THROUGH PROP. CONDUIT TO PROP. TRAFFIC SIGNAL CABINET. CONDUIT NECESSARY SPLICE WORK.
- INTERCEPT EX. SHARED FIBER/POWER CONDUIT SWEEP FOR CCTV CAMERA INTO MAST ARM, COUPLE PROP. POWER CONDUIT TO EX. CONDUIT SWEEP. INSTALL NEW POWER CABLE FROM EX. OCSO CCTV CAMERA CABINET TO PROP. TRAFFIC SIGNAL CABINET.
- INSTALL RISER INTO EX. OCSO CCTV CAMERA CABINET. COUPLE RISER TO UNDERGROUND FIBER CONDUIT. INSTALL NEW 6 SM FOC FROM EX. OCSO CCTV CAMERA CABINET TO PROP. TRAFFIC SIGNAL CABINET. CONDUIT NECESSARY TERMINATION WORK.

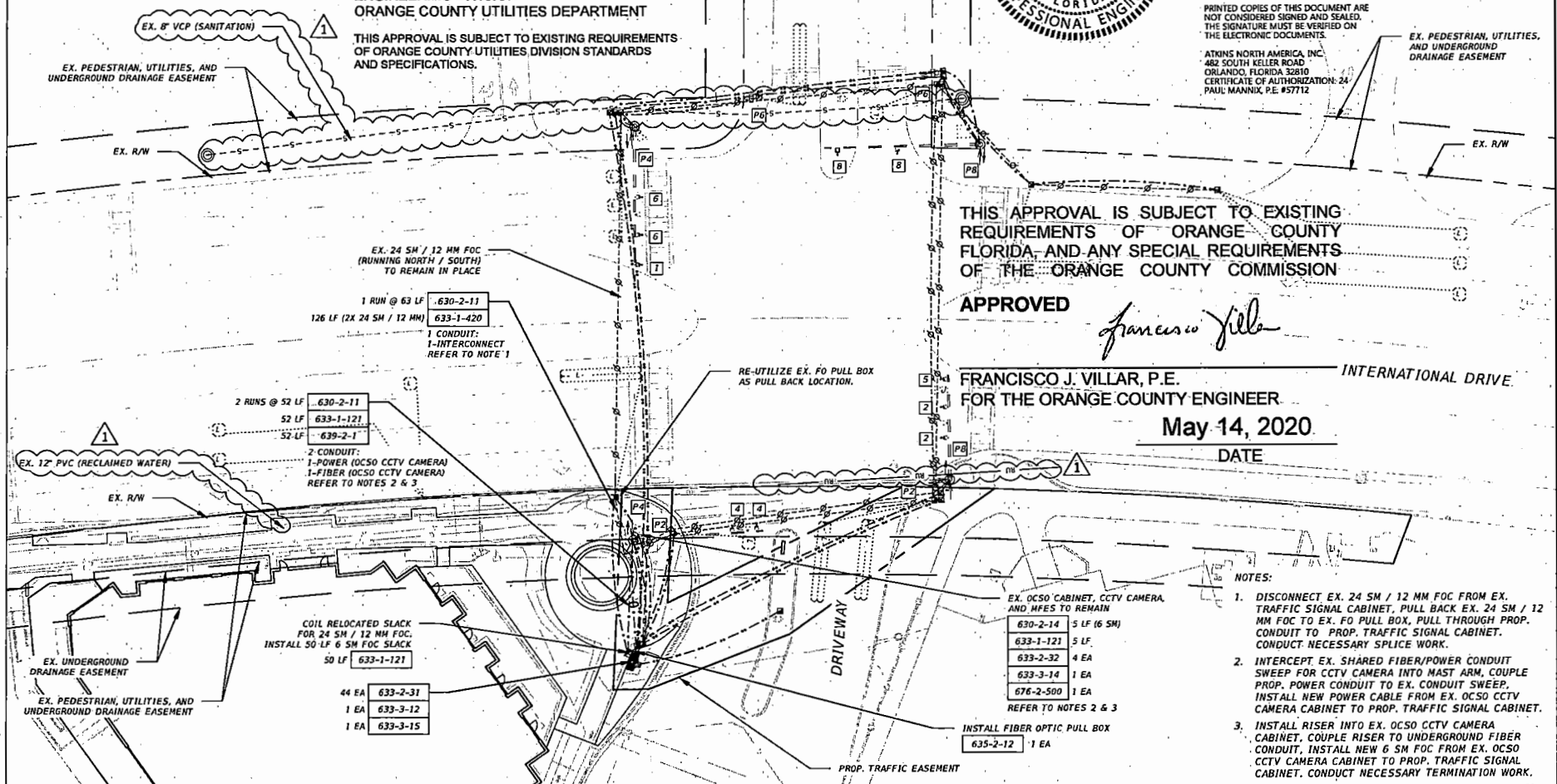
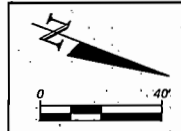

REVISIONS	
DATE	DESCRIPTION
5/8/20	ADDED CALLOUTS FOR EXISTING UTILITY LINES TO REMAIN & AVOID

ATKINS NORTH AMERICA, INC.  
482 SOUTH KELLER ROAD  
ORLANDO, FL 32810  
(407) 647-7275  
CERTIFICATE OF AUTHORIZATION NO. 24  
PAUL MANNIX, P.E., PTOE NO. 57712

ORANGE COUNTY  
PUBLIC WORKS  
INTERNATIONAL DRIVE  
AND SAMOAN COURT

INTERCONNECT PLAN

SHEET NO.  
T-8

THE OFFICIAL RECORD OF THIS SHEET IS THE ELECTRONIC FILE DIGITALLY SIGNED AND SEALED UNDER RULE 61G15-23.004, F.A.C.