

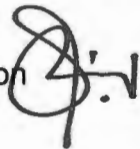

Interoffice Memorandum

August 6, 2019

TO: Mayor Jerry L. Demings
-AND-
Board of County Commissioners (BCC)

FROM: Alberto A. Vargas, MArch., Manager, Planning Division 

THROUGH: Jon V. Weiss, P.E., Director
Planning, Environmental, and Development Services Department

SUBJECT: Adoption Public Hearings – 2018-2 Regular Cycle Comprehensive Plan Amendment and Concurrent Substantial Change Request – Continued Session IV

The 2018-2 Continued Session IV Regular Cycle Comprehensive Plan Amendments are scheduled for a BCC adoption public hearing on August 6, 2019. These amendments were continued by the BCC at the July 2, 2019 public hearing. Fourteen amendments were heard by the Planning and Zoning Commission (PZC)/Local Planning Agency (LPA) at an adoption hearing on October 18, 2018. The report is also available under the Amendment Cycle section of the County's Comprehensive Planning webpage. See:

<http://www.orangecountyfl.net/PlanningDevelopment/ComprehensivePlanning.aspx>.

The two Continued 2018-2 Session IV **Regular Cycle – State-Expedited** Review amendments scheduled for consideration on August 6 includes one privately-initiated Future Land Use Map Amendment located in District 1 request and one staff-initiated text amendment. The proposed Future Land Use Map Amendment entails a change to the Future Land Use Map for a property greater than ten acres in size. The text amendment may include changes to the Goals, Objectives, and/or Policies of the Comprehensive Plan.

The 2018-2 Continued Session IV **Regular Cycle-State-Expedited** Review Amendments were heard by the PZC/LPA at a transmittal public hearing on June 21, 2018, and by the BCC at a transmittal public hearing on July 10, 2018. The amendments have been reviewed by the Department of Economic Opportunity (DEO), as well as other state and regional agencies. On August 28, 2018, DEO issued a comment letter, which did not contain any concerns about the amendments undergoing the State-Expedited Review process. Pursuant to 163.3184, F.S., the proposed amendments must be adopted within 180 days of the comment letter. The Regular Cycle Amendments undergoing the State-Expedited Review process will become effective 31 days after DEO notifies the County that the plan amendment package is complete. These amendments are expected

to become effective in September 2019, provided no challenges are brought forth for any of the amendments.

Any questions concerning this document should be directed to Alberto A. Vargas, Manager, Planning Division, at (407) 836-5802 or Alberto.Vargas@ocfl.net or Greg Gologowski, AICP, Chief Planner, Comprehensive Planning Section, at (407) 836-5624 or Gregory.Gologowski@ocfl.net.

AAV/sw

Enc: 2018-2 Regular Cycle Amendments – BCC Adoption Binder – Continued Session IV

- c: Christopher R. Testerman, AICP, Assistant County Administrator
- Joel Prinsell, Deputy County Attorney
- Roberta Alfonso, Assistant County Attorney
- Whitney Evers, Assistant County Attorney
- Gregory Gologowski, AICP, Chief Planner, Planning Division
- Olan D. Hill, AICP, Assistant Manager, Planning Division
- Eric P. Raasch, AICP, Planning Administrator, Planning Division
- Read File



ORANGE COUNTY
PLANNING DIVISION
2018-2-ADOPTION
AMENDMENTS
SESSION 4

2010 - 2030 COMPREHENSIVE PLAN

BOARD OF COUNTY
COMMISSIONERS

AUGUST 6, 2019
ADOPTION PUBLIC HEARING

PREPARED BY:
ORANGE COUNTY PLANNING, ENVIRONMENTAL
AND DEVELOPMENT SERVICES

PLANNING DIVISION
COMPREHENSIVE PLANNING SECTION



2018 SECOND REGULAR CYCLE

AMENDMENTS TO THE 2010-2030 COMPREHENSIVE PLAN BOARD OF COUNTY COMMISSIONERS ADOPTION BOOK CONTINUED SESSION IV

INTRODUCTION

This is the Board of County Commissioners (BCC) adoption public hearing book for the continued fourth session of the proposed Second Regular Cycle Amendments (2018-2) to the Future Land Use Map (FLUM) and Comprehensive Plan (CP) continued by the BCC from July 2, 2019 to August 6, 2019. The Planning and Zoning Commission (PZC)/Local Planning Agency (LPA) adoption public hearings were held on October 18, 2018.

Please note the following modifications to this report:

KEY TO HIGHLIGHTED CHANGES	
Highlight	When changes made
Blue	Following DEO transmittal (by staff)
Pink	Following the LPA adoption public hearing (by staff)

The Continued 2018-2 Session IV Regular Cycle – State-Expedited Review amendments scheduled for consideration on August 6 includes one privately-initiated Future Land Use Map Amendment located in District 1 and one staff-initiated text amendment. The proposed Future Land Use Map Amendment entails a change to the Future Land Use Map for a property greater than ten acres in size. The text amendment includes changes to the Goals, Objectives, and/or Policies of the Comprehensive Plan.

The Regular Cycle – State-Expedited Review Amendments have been reviewed by the Department of Economic Opportunity (DEO), as well as other state and regional agencies. On August 28, 2018, DEO issued a comment letter, which did not contain any concerns about the amendments undergoing the State-Expedited Review process. Pursuant to 163.3184, F.S., the proposed amendments must be adopted within 180 days of the comment letter. The Regular Cycle Amendments undergoing the State-Expedited Review process will become effective 31 days after DEO notifies the County that the adopted plan amendment package is complete. If adopted, these amendments are expected to become effective in September 2019, provided no challenges are brought forth for any of the amendments.

Any questions concerning this document should be directed to Alberto A. Vargas, MArch, Manager, Planning Division, at (407) 836-5802 or Alberto.Vargas@ocfl.net or Greg Gologowski, AICP, Chief Planner, Comprehensive Planning Section, at (407) 836-5624 or Gregory.Gologowski@ocfl.net.

TABLE OF CONTENTS

Introduction Tab 1

Regular Cycle Amendments..... Tab 2

Privately-Initiated Regular Cycle Future Land Use Map (FLUM) Amendments

Amendment		Page
1.	2018-2-A-1-2 BB Groves	Growth Center/Resort/Planned Development (GC/R/PD) to Growth Center-Planned Development-Resort/Low-Medium Density Residential (GC-PD-R/LMDR) 1

Staff Initiated Regular Cycle Future Land Use Map and Text Amendments.....Tab 3

2.	2018-2-B-FLUE-3 PD Densities	Text amendments to Future Land Use Element Policy FLU8.1.4 establishing the maximum densities and intensities for proposed Planned Developments within Orange County
----	---------------------------------	--

State Agencies Comments/ORC Report and Response.....Tab 4

Community Meeting Summaries.....Tab 5

Facilities Analyses.....Tab 6

Transportation Analyses.....Tab 7

Environmental AnalysesTab 8

SITE AERIAL



FUTURE LAND USE - CURRENT

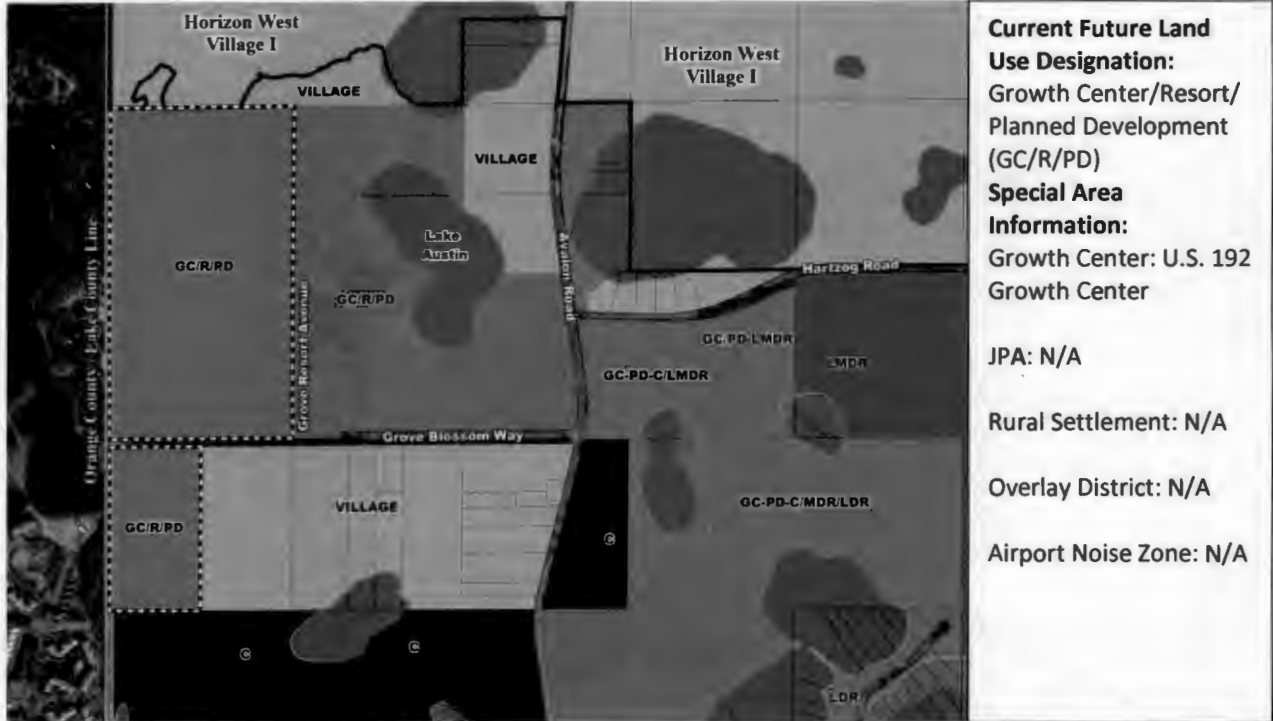

FUTURE LAND USE - AS PROPOSED

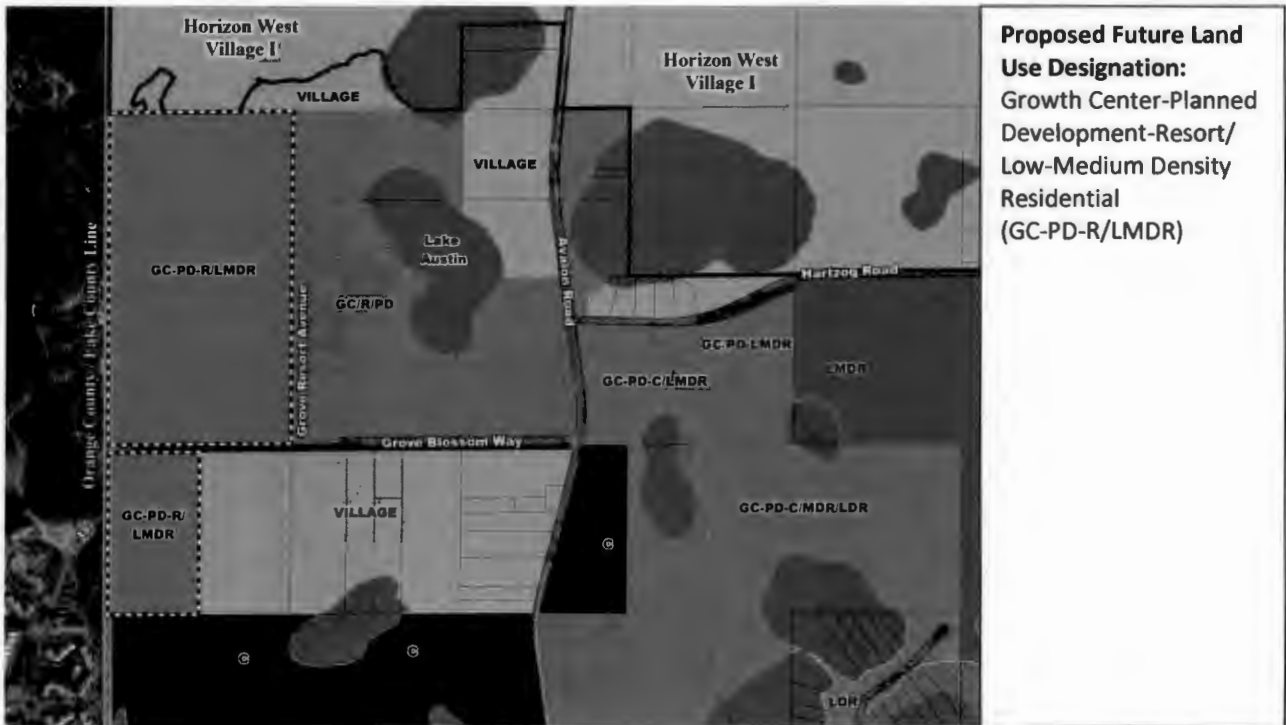

ZONING - CURRENT

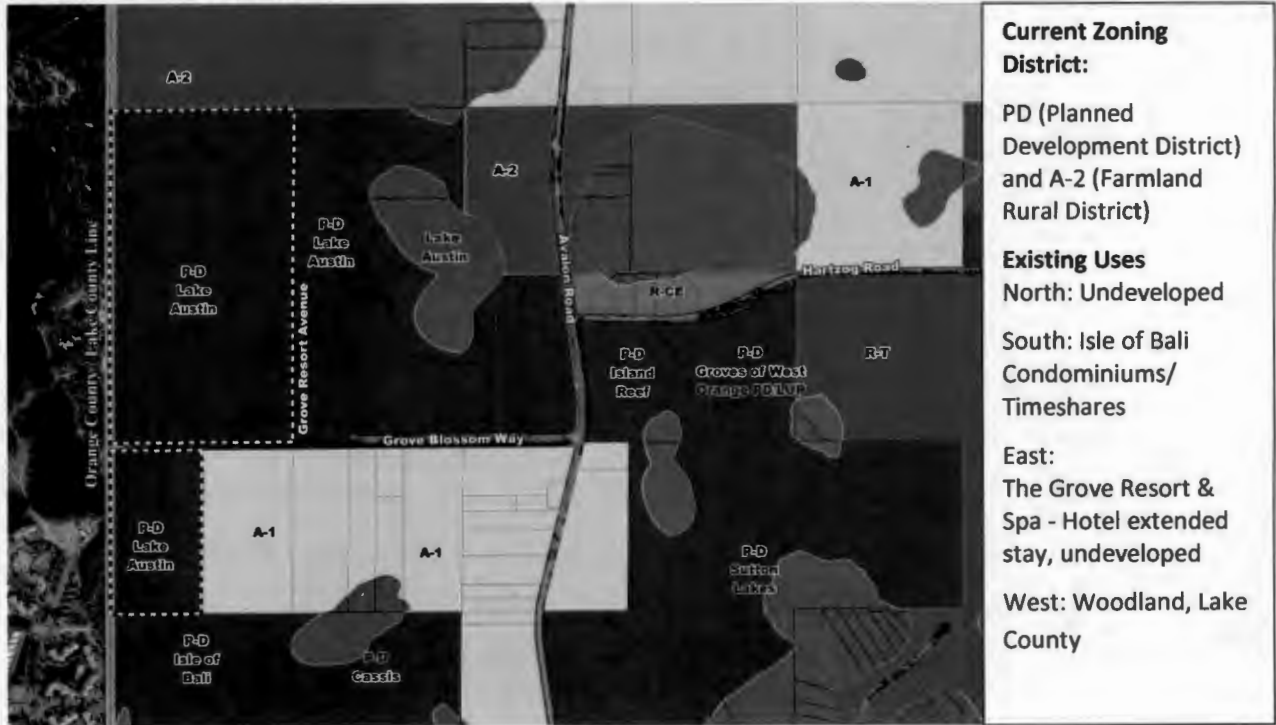

Staff Recommendations

Make a finding of **consistency** with the Comprehensive Plan (see Housing Element Goal H1, Housing Element Objective H1.1, Future Land Use Element Objective FLU8.2, and Policies FLU1.1.1, FLU1.1.2.A, FLU1.1.4.F, FLU7.4.4, FLU8.1.4, FLU8.2.1, and FLU8.2.2), determine that the amendment is in compliance, and **ADOPT** Amendment 2018-2-A-1-2, Growth Center/Resort/Planned Development (GC/R/PD) to Growth Center-Planned Development-Resort/Low-Medium Density Residential (GC-PD-R/LMDR).

Analysis

1. Background Development Program

The applicant has requested to change the Future Land Use Map (FLUM) designation of the 108.03-acre site from Growth Center/Resort/Planned Development (GC/R/PD) to Growth Center-Planned Development-Resort/Low-Medium Density Residential (GC-PD-R/LMDR). The applicant's original FLUM Amendment application entailed two requests that involved the South Parcel (GC/R/PD to GC-PD-R/LMDR) and the North Parcel. The North Parcel's FLUM Amendment request was to change the FLUM designation of the 9.83-acre parcels from Village (V) to Horizon West, Village I Special Planning Area (SPA) Greenbelt (GB). The North Parcels would not have an associated development program; they would be used for open space and stormwater for the South Parcels. Orange County Planning Division's Senior Staff determined that the North Parcels' FLUM Amendment request was not necessary. Senior Staff determined that the North Parcels could be aggregated into the existing Lake Austin Planned Development (PD) through a Land Use Plan Amendment (LUPA). The subject parcels would be rezoned from A-2 (Farmland Rural District) to PD (Planned Development District) and would be designated as open space/stormwater.

The subject parcels are part of the 210.98-acre Lake Austin PD which was originally approved on April 17, 2001, by the Board of County Commissioners (BCC). On July 12, 2016, the BCC approved a substantial change (CDR-16-01-027) to the Lake Austin PD to revise the use description from "Timeshare" to "Short Term Rental" and increase those entitlements from 4,159 units to 4,831 units (consistent with the previously approved DRI/DO); modify project phasing dates and amount of development per phase; revise traffic generation calculations; expand list of approved recreational facilities; identify previously dedicated road right-of-way; add two (2) parcel identification numbers not previously identified; modify and renumber existing notes on the plan; add Notes 11-22, some of which transfer DRI/DO environmental and transportation conditions; and add a Master Sign Plan (MSP) with three (3) related waivers from Orange County Code, that primarily relate to signage. Concurrent with the PD substantial change, the BCC rescinded the Grand Palisades Resort DRI/DO.

The subject parcels are identified as Phase Three on the currently-approved Lake Austin PD. Presently, Phase Three is approved for 3,332 short-term rental units, 10,000 square feet of commercial uses, and 20,000 square feet of administration uses. The applicant is now proposing a development program of 500 single-family residential dwelling units. (The units may be any combination of age-restricted, short-term rental, or market rate housing.)

The undeveloped subject property consists of two parcels located west of Avalon Road, north and south of Grove Blossom Way, immediately west of the Grand Palisades Resort, now known as The Grove Resort & Spa, and east of the Lake County Boundary. The subject site is located in an area where nearby properties in the U.S. 192 Growth Center have recently obtained approved FLUM Amendments:

- On June 28, 2016, the BCC approved FLUMA 2016-1-A-1-8 to change the FLUM designation of the 23.94-acre site located across the street at the corner of Avalon Road and Hartzog Road, east of the subject site, from Growth Center-Commercial (GC-C) to Growth Center-Planned Development-Commercial/Low-Medium Density Residential (GC-PD-C/LMDR). The proposed development program consists of up to 220 single-family dwelling units (attached and detached) and 20,000 square feet of retail commercial uses. The site is also known as the Island Reef PD.
- On December 16, 2014, the BCC approved FLUMA 2014-2-A-1-2 (fka 2013-2-A-1-4) to change the FLUM designation of the 139.88-acre property located across the street on Avalon Road, east of the subject property, from Growth Center-Commercial (GC-C) and Growth Center-Low Density Residential (GC-LDR) to Growth Center-Planned Development-Commercial/Medium Density Residential/Low Density Residential (GC-PD-C/MDR/LDR). The proposed development program consists of 700 single-family residential units (attached and detached) and 20,000 square feet of retail uses and is also known as the Sutton Lakes PD.
- On November 19, 2013, the BCC approved FLUMA 2013-2-A-1-3 to change the FLUM designation from Growth Center-Commercial (GC-C) to Growth Center-Planned Development-Low-Medium Density Residential (GC-PD-LMDR) for a 13.88-acre parcel also located across the street on Hartzog Road, east of the subject site. The development program is for up to 139 single-family dwelling units. The site is also known as the Groves of West Orange PD which the BCC approved the rezoning (LUP-14-01-009) on October 20, 2015, for a development program consisting of 108 single-family detached and attached (townhome) residential dwelling units.

If the currently proposed amendment is adopted by the BCC, a LUPA will be required to aggregate the North Parcels into the approved Lake Austin PD Land Use Plan and to allow for the single-family residential dwelling units. Instead of submitting a LUPA, the applicant has submitted a rezoning application to create a new PD, Case LUP-18-08-255, BB Groves South Planned Development/Land Use Plan (PD/LUP). The request is to add 109.06 acres from the Lake Austin PD (CDR-18-08-254) and to rezone 9.83 acres (North Parcels) from A-2 (Farmland Rural District) to PD (Planned Development District). At the time of this writing, the application is proceeding through the Development Review Committee review process.

A community meeting was held for this proposed amendment on May 24, 2018, with three (3) residents in attendance. The applicant, Ms. Kathy Hattaway, gave an overview of the proposed amendment request and stated the proposed development program would consist of 500 single-family dwelling units. Ms. Hattaway stated that the units may be any combination of age-restricted, short-term rentals, or market rate housing. She stated she was asking for the LMDR FLUM designation which allows for a maximum ten (10) dwelling units per acre, but she is limiting the development to about five (5) dwelling units per acre. One resident asked if the proposed project warrants signalization at Avalon Road and Grove Blossom Way. Orange County Engineer, Ms. Diana Almodovar, stated that a traffic study, paid for by the property owner, would need to be done by the Orange County Traffic Engineering Division, but as it stands today, the proposed development does not warrant signalization. Another resident asked why change from short-term rentals and the existing uses. Ms. Hattaway stated that the new property owner has a different business model. Ms. Hattaway informed the residents in attendance that she could not tell them the specific number of unit types (age-restricted, short-term rental, and market rate housing) at this time but they will be determined when the Lake Austin PD Land Use Plan Amendment package is submitted, if the BCC recommends to transmit the proposed amendment. The residents in attendance responded positively to the request.

2. Future Land Use Map Amendment Analysis

Consistency

The requested FLUM amendment appears to be consistent with the applicable Goals, Objectives, and Policies of the Comprehensive Plan. The subject property lies within the U.S. 192 Growth Center. Future Land Use Element **Policy FLU1.1.4F** states that Growth Centers are a Future Land Use designation implemented through Joint Planning Area agreements with an outside jurisdiction. These agreements provide at a minimum that the County will not incur initial capital costs for utilities. The subject property is located within Orange County Utilities' (OCU's) potable water, wastewater, and reclaimed water service areas. Per OCU, there is a 24-inch potable water main, a 15-inch gravity sewer main, and a 12-inch reclaimed water main located in Grove Blossom Way right-of-way to service the subject property. According to OCU, there is sufficient plant capacity to serve the proposed amendment and capacity will be reserved upon payment of capital charges in accordance with County resolutions and ordinances.

In accordance with **Policy 1.1.2.A**, the applicant has specified the maximum desired development program for the project, proposing 500 single-family residential dwelling units (The units may be any combination of age-restricted, short-term rental, or market rate housing.) under the Low-Medium Density Residential (LMDR) FLUM designation, which allows for residential development at a maximum density of ten (10) dwelling units per acre. **Policy FLU7.4.4** states that urban intensities shall be permitted in designated Growth Centers when urban services are available from other sources, as approved by Orange County, consistent with the appropriate policies of the Comprehensive Plan. **Policy FLU7.4.4** also states that if services and facilities sufficient to maintain adopted level of service standards are not available concurrent with the impacts of development, the development will be phased such that the services and facilities will be available when the impacts of development occur or the development orders and permits will be denied.

The subject property is located in an area characterized by a variety of housing types—including residential/agricultural home sites, conventional single-family subdivision development (Hartzog Subdivision), and a manufactured home development (the 925-unit Vista Del Lago Manufactured Home Park). The applicant's intent to develop 500 single-family residential dwelling units, with a mix of age-restricted, short-term rental, and market rate housing, is consistent with Housing Element **GOAL H1** and **Objective H1.1**, which state that the County will promote and assist in the provision of an ample housing supply, within a broad range of types and price levels, and will support private sector housing production capacity sufficient to meet current and anticipated housing needs. **Policy FLU8.2.2** states that continuous stretches of similar housing types and density of units shall be avoided. The proposed amendment will contribute to the mix of available housing options in an area of the County deemed appropriate for urban uses, as set forth in **Policy FLU1.1.1**. Staff notes that if this requested amendment is adopted, the development standards will be determined during the LUPA process.

Future Land Use Element **Policy FLU8.1.4** lists the development program for Planned Development (PD) FLUM designations adopted since January 1, 2007. The development program for this requested amendment is proposed for incorporation into **Policy FLU8.1.4** via a staff-initiated text amendment (Amendment 2018-2-B-FLUE-3). The maximum development program for Amendment 2018-2-A-1-2, if adopted, would be as follows: 500 single-family dwelling units (may be any combination of age-restricted, short-term rental, or market rate housing.)

Amendment Number	Adopted FLUM Designation	Maximum Density/Intensity	Ordinance Number
<u>2018-2-A-1-2</u>	<u>Growth Center-Planned Development-Resort/Low-Medium Density Residential GC-PD-R/LMDR</u>	<u>500 single-family dwelling units (may be any combination of age-restricted, short-term rental, or market rate housing)</u>	<u>2019-</u>

Compatibility

The proposed FLUM amendment appears to be **compatible** with the existing development and development trend of the surrounding area. Future Land Use Element **Objective FLU8.2** states that compatibility will continue to be the fundamental consideration in all land use and zoning decisions, while **Policy FLU8.2.1** requires land use changes to be compatible with the existing development pattern and development trends in the area. As stated above, the subject property is located in an area characterized by residential development and undeveloped land (much of which is due to the decreased demand for previously-approved commercial resort development on those properties). It is staff's belief that the proposed project is compatible with the existing mix of residential/agricultural home sites, conventional single-family subdivision development, and manufactured home uses within the U.S. 192 Growth Center.

Division Comments: Environmental, Public Facilities and Services

Environmental Protection Division

Orange County Conservation Area Determination CAD 07-119 delineated the wetlands and surface waters on the subject parcels but this determination expired in 2013. A new CAD must be completed with a certified wetland boundary survey approved by the Environmental Protection Division (EPD) prior to submittal of a subdivision, development plan, or permit application, in accordance with Orange County Code Chapter 15, Article X, Wetland Conservation Areas. [REDACTED] that CAD-18-02-021 was completed May 3, 2019, with an expiration date of May 3, 2024.

Until wetland permitting is complete, the net developable acreage is only an approximation. The net developable acreage is the gross acreage less the wetlands and surface waters acreage. The buildable area is the net developable acreage less protective buffer areas if required to prevent adverse secondary impacts. The applicant is advised not to make financial decisions based upon development within the wetland or the upland protective buffer areas. Any plan showing development in such areas without Orange County and other jurisdictional governmental agency wetland permits is speculative and may not be approved.

Density and Floor Area Ratio (FAR) calculations are determined by dividing the total number of units and the square footage by the net developable area. In order to include Class I, II and III conservation areas in the density and FAR calculations, the parcels shall have an approved Conservation Area Determination (CAD) and an approved Conservation Area Impact (CAI) permit from EPD. Please reference Comprehensive Plan Policy FLU1.1.2 C.

The applicant is responsible for addressing any adverse impacts, including secondary impacts, to surface waters or wetlands that may occur as a result of development of the site. Protective measures include but are not limited to: 25-foot minimum undisturbed upland buffer along the wetland boundary, signage, and pollution abatement swales upland of the buffer if adjacent to surface waters and if drainage is not diverted to treatment.

Development of the subject properties shall comply with all state and federal regulations regarding wildlife or plants listed as endangered, threatened, or species of special concern. The applicant is responsible for determining the presence of listed species and obtaining any required habitat permits from the U.S. Fish and Wildlife Service (USFWS) and/or the Florida Fish & Wildlife Conservation Commission (FWC). The ecological assessment dated February 14, 2018 submitted with this request reported the presence of listed species on site, including numerous gopher tortoise burrows and sand skink habitat, among others.

All development is required to pretreat storm water runoff for pollution abatement purposes, per Orange County Code Section 34-227. Discharge that flows directly into wetlands or surface waters without pretreatment is prohibited.

Transportation Planning Division

The applicant is requesting to change a total of 117.86 acres, divided into the South and North Parcels as follows: South Parcel from Growth Center/Resort/Planned Development (GC/R/PD) to Growth Center/Resort/Low-Medium Density Residential/Planned Development (GC/R/LMDR/PD) and North Parcel from Village (V) to Horizon West, Village I Special Planning Area (SPA)-Greenbelt (GB) and approval to develop 500 single family dwelling units.

- The subject property is not located within the County's Alternative Mobility Area or along a backlogged/constrained facility or multimodal corridor.
- The allowable development based on the approved future land use will generate 1,433 pm peak hour trips.
- The proposed use will generate 475 pm peak hour trips resulting in a net decrease of 958 pm peak hour trips.
- The subject property is located adjacent to Avalon Road, a two-lane collector. This facility currently has two (2) deficient roadway segments from US 192 to Hartzog Road and from Hartzog Road to Seidel Road within the project impact area.
- The traffic study did not include Hartzog Road segment from Avalon Road to Western Way, which falls within the project's one-mile impact area. A revision was requested to include an analysis of this segment to be included. Nonetheless, this segment is currently operating within its adopted capacity and will not be impacted by the proposed FLUM change.
- Based on the concurrency management system database dated 05-01-2018, the following two (2) roadway segments are operating below the adopted level of service standard within the project area:
 - Avalon Road, from US 192 to Hartzog Road
 - Avalon Road, from Hartzog Road to Seidel Road

This information is dated and subject to change

- Analysis of the short-term (interim year) 2023 and long-term (horizon year) 2030 conditions indicates that these deficiencies will continue with or without the proposed amendment.

Amending the FLUM for this property will decrease the number of trips generated by this development.

- Final permitting of any development on this site will be subject to review and approval under capacity constraints of the county's Transportation Concurrency Management System. Such approval will not exclude the possibility of a proportionate share payment in order to mitigate any transportation deficiencies. Finally, to ensure that there are no revisions to the proposed development beyond the analyzed use, the land use will be noted on the County's Future Land Use Map or as a text amendment to the Comprehensive Policy Plan.

Utilities

The subject property is located within Orange County Utilities' (OCU's) potable water, wastewater, and reclaimed water service areas. Per OCU, there is a 24-inch potable water main, a 15-inch gravity sewer main, and a 12-inch reclaimed water main located in Grove Blossom Way right-of-way.

OCPS

On February 26, 2019, the School Board approved the Capacity Enhancement Agreement (CEA) associated with this requested amendment, #OC-18-051.

3. Policy References

GOAL H1 – Orange County's goal is to promote and assist in the provision of an ample housing supply, within a broad range residents have the opportunity to purchase or rent standard housing.

OBJ H1.1 – The County will continue to support private sector housing production capacity sufficient to meet the housing needs of existing and future residents.

OBJ FLU8.2 – COMPATIBILITY. Compatibility will continue to be the fundamental consideration in all land use and zoning decisions. For purposes of this objective, the following polices shall guide regulatory decisions that involve differing land uses.

FLU1.1.1 – Urban uses shall be concentrated within the Urban Service Area, except as specified for the Horizon West Village and Innovation Way Overlay (Scenario 5), Growth Centers, and to a limited extent, Rural Settlements.

FLU1.1.2.A – The Future Land Use Map shall reflect the most appropriate maximum and minimum densities for residential development. Residential development in Activity Centers and Mixed Use Corridors, the Horizon West Village and Innovation Way Overlay (Scenario 5) and Growth Centers may include specific provisions for maximum and minimum densities. The densities in the International Drive Activity Center shall be those indicated in the adopted Strategic Development Plan.

FLU1.1.4.F – GROWTH CENTER(S) – Growth Centers are a Future Land Use designation implemented through Joint Planning Area agreements with an outside jurisdiction. These agreements provide at a minimum that the County will not incur initial capital costs for utilities. Orange County has two Growth Centers – one in the northwest referred to as the Northwest Growth Center and one in the southeast referred to as Growth Center/Resort/PD.

FLU7.4.4 – Urban intensities shall be permitted in designated Growth Centers when urban services are available from other sources as approved by Orange County, consistent with the appropriate policies of the Comprehensive Plan. If services and facilities sufficient to maintain adopted level of service standards are not available concurrent with the impacts of development, the development

will be phased such that the services and facilities will be available when the impacts of development occur or the development orders and permits will be denied.

FLU8.1.4 – The following table details the maximum densities and intensities for the Planned Development (PD) Future Land Use designations that have been adopted subsequent to January 1, 2007.

FLU8.2.1 – Land use changes shall be required to be compatible with the existing development and development trend in the area. Performance restrictions and/or conditions may be placed on property through the appropriate development order to ensure compatibility. No restrictions or conditions shall be placed on a Future Land Use Map change.

FLU8.2.2 – Continuous stretches of similar housing types and density of units shall be avoided. A diverse mix of uses and housing types shall be promoted.

Site Visit Photos

Subject Site –Undeveloped



North – Undeveloped



South – Timeshare Resort



West – Lake County



East – Timeshare Resort



PUBLIC NOTIFICATION MAP

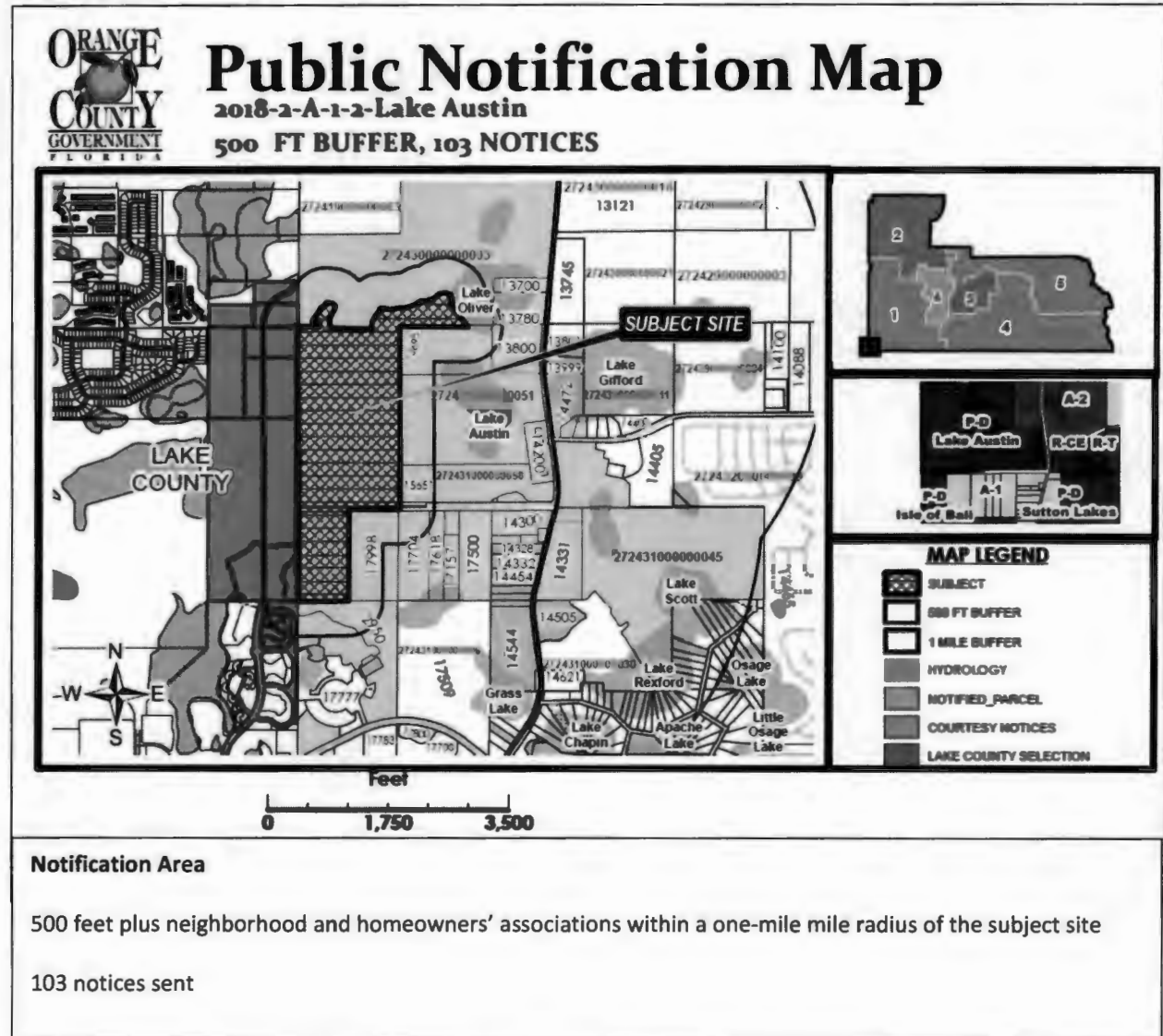

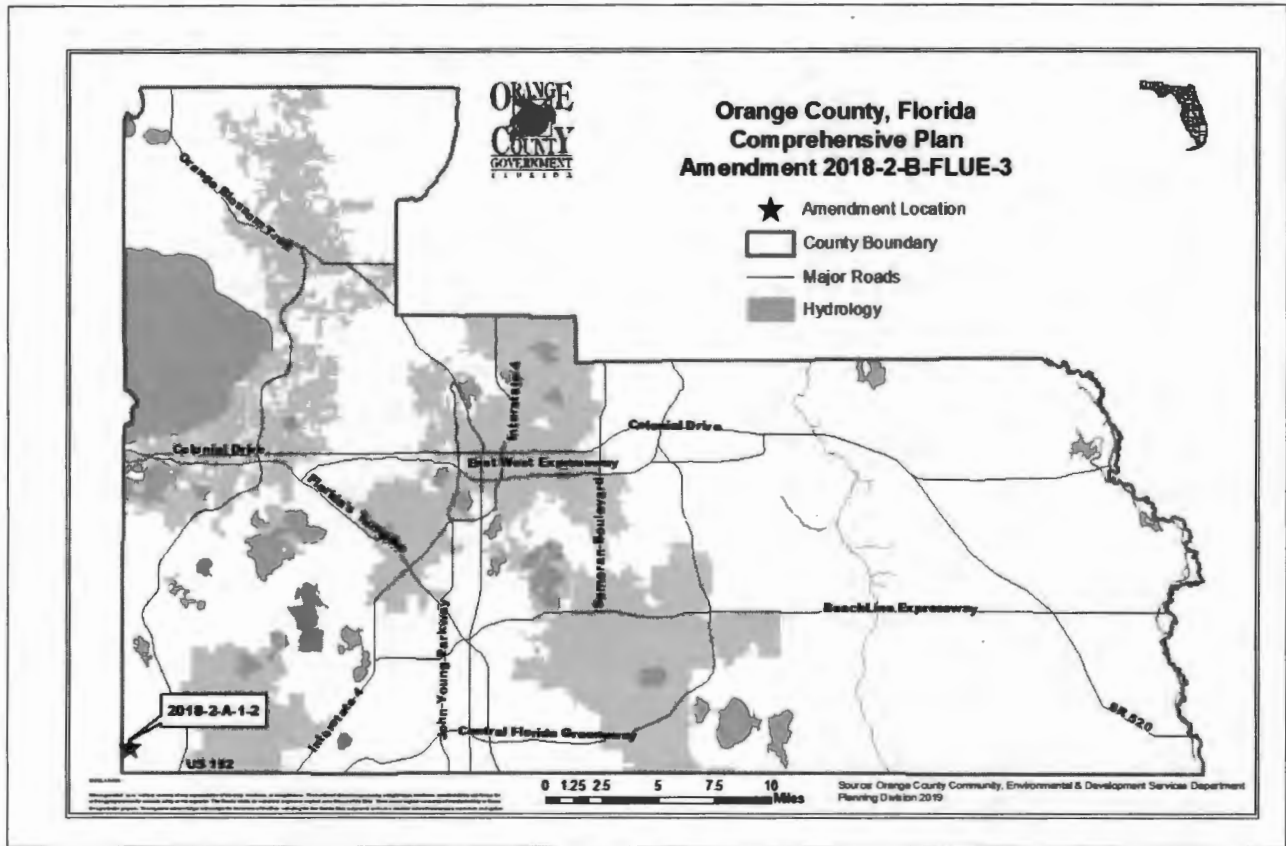

The following meetings and hearings have been held for this proposal:			Project/Legal Notice Information	
Report/Public Hearing		Outcome	Title: Amendment 2018-2-B-FLUE-3	
✓	Staff Report	Recommend Transmittal	Division: Planning	
✓	LPA Transmittal June 21, 2018	Recommend Transmittal (8-0)	Request: Amendments to Future Land Use Element Policy FLU8.1.4 establishing the maximum densities and intensities for proposed Planned Developments within Orange County	
✓	BCC Transmittal July 10, 2018	Transmit (6-0)		
✓	State Agency Comments August 28, 2018.	No comments or concerns were identified		
✓	LPA Adoption October 18, 2018	Recommend Adoption (8-1)		
	BCC Adoption	August 6, 2019	Revision: FLU8.1.4	

Staff Recommendation

Make a finding of consistency with the Comprehensive Plan, determine that the plan amendment is in compliance, and recommend **ADOPTION** of Amendment 2018-2-B-FLUE-3 to include the development programs for Amendment 2018-2-A-1-2 in Future Land Use Element Policy FLU8.1.4.

A. Background

The Orange County Comprehensive Plan (CP) allows for a Future Land Use designation of Planned Development. While other Future Land Use designations define the maximum dwelling units per acre for residential land uses or the maximum floor area ratio (FAR) for non-residential land uses, this is not the case for the Planned Development (PD) designation. Policy FLU8.1.3 establishes the basis for PD designations such that “specific land use designations...may be approved on a site-specific basis”. Furthermore, “such specific land use designation shall be established by a comprehensive plan amendment that identifies the specific land use type and density/intensity.” Each comprehensive plan amendment involving a PD Future Land Use designation involves two amendments, the first to the Future Land Use Map and the second to Policy FLU8.1.4. The latter serves to record the amendment and the associated density/intensity established on a site-specific basis. Any change to the uses and/or density and intensity of approved uses for a PD Future Land Use designation requires an amendment of FLU8.1.4.

Staff is recommending the Board make a finding of consistency with the Comprehensive Plan and approve Amendment 2018-2-A-1-2; therefore, the development programs for these amendments would be added to Policy FLU8.1.4. For specific references of consistency with the Comprehensive Plan, please refer to the staff report for each amendment.

B. Policy Amendments

Following are the policy changes proposed by this amendment. The proposed changes are shown in underline/strikethrough format. Staff recommends transmittal of the amendment.

FLU8.1.4 The following table details the maximum densities and intensities for the Planned Development (PD) and Lake Pickett (LP) Future Land Use designations that have been adopted subsequent to January 1, 2007.

Amendment Number	Adopted FLUM Designation	Maximum Density/ Intensity	Ordinance Number
<u>2018-2-A-1-2</u> <u>BB Groves</u>	<u>Growth Center-Planned Development-Resort/Low-Medium Density Residential (GC-PD-R/LMDR)</u>	<u>500 single-family dwelling units (may be any combination of age-restricted, short-term rental, or market rate housing)</u>	<u>2019-</u>

ORDINANCE NO. 2019-_____

AN ORDINANCE PERTAINING TO COMPREHENSIVE PLANNING IN ORANGE COUNTY, FLORIDA; AMENDING THE ORANGE COUNTY COMPREHENSIVE PLAN, COMMONLY KNOWN AS THE "2010-2030 COMPREHENSIVE PLAN," AS AMENDED, BY ADOPTING AMENDMENTS PURSUANT TO SECTION 163.3184(3), FLORIDA STATUTES, FOR THE 2018 CALENDAR YEAR (SECOND CYCLE); AND PROVIDING EFFECTIVE DATES.

BE IT ORDAINED BY THE BOARD OF COUNTY COMMISSIONERS OF ORANGE COUNTY:

Section 1. Legislative Findings, Purpose, and Intent.

a. Part II of Chapter 163, Florida Statutes, sets forth procedures and requirements for a local government in the State of Florida to adopt a comprehensive plan and amendments to a comprehensive plan;

b. Orange County has complied with the applicable procedures and requirements of Part II of Chapter 163, Florida Statutes, for amending Orange County's 2010-2030 Comprehensive Plan;

c. On June 21, 2018, the Orange County Local Planning Agency ("LPA") held a public hearing on the transmittal of the proposed amendments to the Comprehensive Plan, as described in this ordinance; and

d. On July 10, 2018, the Orange County Board of County Commissioners ("Board") held a public hearing on the transmittal of the proposed amendments to the Comprehensive Plan, as described in this ordinance; and

30 e. On August 28, 2018, the Florida Department of Economic Opportunity (“DEO”)
31 issued a letter to the County relating to the DEO’s review of the proposed amendments to the
32 Comprehensive Plan, as described in this ordinance; and

33 f. On October 18, 2018, the LPA held a public hearing at which it reviewed and made
34 recommendations regarding the adoption of the proposed amendments to the Comprehensive Plan,
35 as described in this ordinance; and

36 g. On June 4, 2019, the Board opened a public hearing on the adoption of the proposed
37 amendments to the Comprehensive Plan, as described in this ordinance, and decided to continue
38 the hearing on the adoption to July 2, 2019; and

39 h. On July 2, 2019, the Board opened a public hearing on the adoption of the proposed
40 amendments to the Comprehensive Plan, as described in this ordinance, and decided to continue
41 the hearing on the adoption to August 6, 2019; and

42 i. On August 6, 2019, the Board held a public hearing on the adoption of the proposed
43 amendments to the Comprehensive Plan, as described in this ordinance, and decided to adopt them.

44 **Section 2. Authority.** This ordinance is adopted in compliance with and pursuant to
45 Part II of Chapter 163, Florida Statutes.

46 **Section 3. Amendments to Future Land Use Map.** The Comprehensive Plan is
47 hereby amended by amending the Future Land Use Map designations as described at **Appendix**
48 **“A,”** attached hereto and incorporated herein.

49 **Section 4. Amendments to the Text of the Future Land Use Element.** The
50 Comprehensive Plan is hereby further amended by amending the text of the Future Land Use
51 Element to read as follows, with underlines showing new numbers and words, and strike-throughs

52 indicating repealed numbers and words. (Words, numbers, and letters within brackets identify the
 53 amendment number and editorial notes, and shall not be codified.)

54 * * *

55 **[Amendment 2018-2-B-FLUE-3:]**

56 FLU8.1.4 The following table details the maximum densities and intensities for the
 57 Planned Development (PD) and Lake Pickett (LP) Future Land Use
 58 designations that have been adopted subsequent to January 1, 2007.

59

Amendment Number	Adopted FLUM Designation	Maximum Density/Intensity	Ordinance Number
* * *	* * *	* * *	* * *
<u>2018-2-A-1-2</u> <u>BB Groves</u>	<u>Growth Center –</u> <u>Planned Development –</u> <u>Resort/Low-Medium</u> <u>Density Residential</u> <u>(GC-PD-R/LMDR)</u>	<u>500 single-family dwelling</u> <u>units (may be any combination</u> <u>of age-restricted, short-term</u> <u>rental, or market rate housing)</u>	<u>2019-</u> <u>[insert</u> <u>ordinance</u> <u>number]</u>

60 Such policy allows for a one-time cumulative density or intensity differential of 5% based on
 61 ADT within said development program.

62 * * *

63 ***Section 5. Effective Dates for Ordinance and Amendments.***

64 (a) This ordinance shall become effective as provided by general law.

65 (b) In accordance with Section 163.3184(3)(c)4., Florida Statutes, no plan amendment
 66 adopted under this ordinance becomes effective until 31 days after the DEO notifies the County
 67 that the plan amendment package is complete. However, if an amendment is timely challenged,
 68 the amendment shall not become effective until the DEO or the Administration Commission issues
 69 a final order determining the challenged amendment to be in compliance.

70 (c) No development orders, development permits, or land uses dependent on any of
71 these amendments may be issued or commence before the amendments have become effective.

72

73 ADOPTED THIS 6th DAY OF AUGUST, 2019.

74

ORANGE COUNTY, FLORIDA
By: Board of County Commissioners

75

76

77

78

79

80

By: _____
Jerry L. Demings
Orange County Mayor

81

82

83

84 ATTEST: Phil Diamond, CPA, County Comptroller
85 As Clerk to the Board of County Commissioners

86

87

88

89

By: _____
Deputy Clerk

90

91

92

93

94

75
96
97
98
99
100

APPENDIX "A"

FUTURE LAND USE MAP AMENDMENTS

Appendix A*		
<i>Privately Initiated Future Land Use Map Amendments</i>		
Amendment Number	Future Land Use Map Designation FROM:	Future Land Use Map Designation TO:
2018-2-A-1-2	Growth Center/Resort/Planned Development (GC/R/PD)	Growth Center-Planned Development-Resort/Low-Medium Density Residential (GC-PD-R/LMDR)
*The Future Land Use Map (FLUM) shall not depict the above designations until such time as they become effective.		

101
102
103
104
105
106
107
108
109
110
111
112
113
114
115
116
117
118
119
120
121
122
123
124
125
126
127
128
129



Community Meeting Memorandum

DATE: May 25, 2018
TO: Alberto A. Vargas, MArch., Planning Manager
FROM: Sue Watson, Planner
SUBJECT: Amendment 2018-1-A-1-2 (Lake Austin) Community Meeting Synopsis
C: Project File

Location of Project: Generally described as located west of Avalon Road, and north and south of Grove Blossom Way

Meeting Date and Location: Thursday, May 24, 2018 at 6:00 PM at Independence Elementary School, 6255 New Independence Parkway, Winter Garden, FL 34787

Attendance:

District Commissioner	District 1 Commissioner Betsy VanderLey Diana Dethlefs, Commissioner's Aide, District 1
PZC/LPA Commissioner	District 1 Commissioner Jimmy Dunn
Orange County Staff	Sue Watson, Jennifer DuBois, and Alyssa Henriquez Planning Division Diana Almodovar, County Engineer, Public Works Department
Applicant	
Residents	Kathy Hattaway, Poulos & Bennett

103 notices sent; 3 residents in attendance

Overview of Project: The applicant, Kathy Hattaway, is requesting to change the Future Land Use Map (FLUM) designation of the 108.03-acre subject property from Growth Center/Resort/Planned Development (GC/R/PD) to Growth Center-Planned Development-Resort/Low-Medium Density Residential (GC-PD-R/LMDR). The applicant proposes a development program of up to 500 single-family residential dwelling units. (The units may be any combination of age-restricted, short-term rental, or market rate housing.) The property lies within the existing Lake Austin Planned Development with approval for 3,332 short-term rental units, 10,000 square feet of commercial uses, and 20,000 square feet of administration uses.

Meeting Summary: Planner Sue Watson opened the meeting at 6:14 PM and introduced District 1 Commissioner Betsy VanderLey, who provided the ground rules for the format of the community meeting. Ms. Watson then introduced District 1 Commissioner Aide, Diana Dethlefs, District 1 PZC/LPA Commissioner Jimmy Dunn, Jennifer DuBois and Alyssa Henriquez of the Orange County Planning Division, Diana Almodovar, County

Engineer, Orange Public Works Department, and the applicant, Ms. Kathy Hattaway. Ms. Watson informed the residents in attendance that the original request involved two requests - South Parcel: Growth Center/Resort/Planned Development (GC/R/PD) to Growth Center-Planned Development-Resort/Low-Medium Density Residential (GC-PD-R/LMDR) and North Parcel: Village (V) to Horizon West, Village I Special Planning Area (SPA) Greenbelt (GB), but the Orange County Planning Division's Senior Staff determined that the North Parcel Future Land Use Map Amendment request was not necessary. The applicant will just have to rezone the north parcels from A-2 (Farmland Rural District) to P-D (Planned Development District) and bring them into the existing Lake Austin Planned Development through a Land Use Plan Amendment. Ms. Watson stated that the applicant, Ms. Hattaway, agreed with Orange County Planning Division's Senior Staff decision. Ms. Watson provided an overview of the project and informed those in attendance that the applicant is seeking to change the future land use designation of the subject site from Growth Center/Resort/Planned Development (GC/R/PD) to Growth Center-Planned Development-Resort/Low-Medium Density Residential (GC-PD-R/LMDR). Staff summarized the Future Land Use Map Amendment process and the schedule for the LPA and BCC public hearings. Ms. Watson asked the citizens if they had any questions. There were no questions and staff turned the meeting over to the applicant, Kathy Hattaway.

Ms. Hattaway provided an overview of the proposal. She stated the Future Land Use Map Amendment request is to be able to construct a maximum of 500 single-family dwelling units. The units would consist of a combination of age-restricted, short-term rentals, and market rate housing. Ms. Hattaway stated that the proposed owner-occupied homes would comply with the Horizon West Architectural Design Standards. She stated access to the proposed units would be provided through Grove Blossom Way and through an internal road that will be provided to the north through Horizon West Village I because the same property owner owns both properties. Ms. Hattaway stated that a Capacity Enhancement Agreement (CEA) is required from the Orange County School Board for the owner-occupied homes. Ms. Hattaway also stated that a Conservation Area Determination (CAD) was previously done for the property but it has expired a new one has been submitted to the Orange County Environmental Protection Division. Ms. Hattaway informed the residents in attendance that she could not tell them the specific number of unit types at this time but they will be determined when the PD package is submitted after the BCC transmittal public hearing. She also informed the residents that the North Parcels that were part of the original request would be used for stormwater ponds. Ms. Hattaway asked if there were any questions.

Questions and Comments from area residents:

Question: Why change from short-term rentals and the existing uses?

Answer: Ms. Hattaway stated the new property owner has a different business model.

Question: County Engineer, Ms. Diana Almodovar, asked what is happening in Lake County, west of the subject property.

Answer: Ms. Hattaway stated that a Planned Development, Summer Bay P.U.D, and agricultural uses are located to the west of the subject property.

Comment: Ms. Almodovar stated that County will have to request right-of-way dedication for Grove Blossom Way.

Question: Mr. David Hume, Grove Resort representative asked if the proposed project warrants signalization at Avalon Road and Grove Blossom Way.

Question: Ms. Almodovar stated a traffic study paid for by the property owner would need to be done by the Orange County Traffic Engineering Division, but as it stands today, the proposed development does not warrant signalization.

Question: Mr. Hume stated that previously the Grove Resort showed an east-west internal street connection to the proposed property and he wanted to know if the internal road would still be built.

Answer: Ms. Hattaway stated the property owner does not have any need for the connection.

Comment: Ms. Hattaway stated that the proposed neighborhoods within the PD would have to be separated from each other—short-term rentals and market rate homes. The uses could not be mixed with each other.

Comment: Ms. Hattaway stated she was asking for Low-Medium Density Residential (LMDR) to limit the request to about five (5) units per acre and that they did not want to build at the maximum of ten (10) units per acre.

Question: What is age-restricted and what is short-term rentals?

Answer: Ms. Hattaway informed the resident that age-restricted is 55+ and short-term rentals can be rented for less than 180 days.

Comment: Commissioner VanderLey stated that the County is watching the City of Orlando's Airbnb Ordinance. The County wants to see how it is working before they draft their own.

The meeting concluded at approximately 6:44 PM.

Rick Scott
GOVERNOR



Cissy Proctor
EXECUTIVE DIRECTOR

August 28, 2018

The Honorable Teresa Jacobs
Mayor, Orange County
201 South Rosalind Avenue, 5th Floor
Orlando, Florida 32801

Dear Mayor Jacobs:

The Department of Economic Opportunity has completed its review of the proposed comprehensive plan amendment for Orange County (Amendment No. 18-5ESR), which was received on July 31, 2018. We have reviewed the proposed amendment pursuant to Sections 163.3184(2) and (3), Florida Statutes (F.S.), and identified no comment related to important state resources and facilities within the Department of Economic Opportunity's authorized scope of review that will be adversely impacted by the amendment if adopted.

The County is reminded that pursuant to Section 163.3184(3)(b), F.S., other reviewing agencies have the authority to provide comments directly to the County. If other reviewing agencies provide comments, we recommend the County consider appropriate changes to the amendment based on those comments. If unresolved, such comments could form the basis for a challenge to the amendment after adoption.

The County should act by choosing to adopt, adopt with changes, or not adopt the proposed amendment. Also, please note that Section 163.3184(3)(c)1, F.S., provides that if the second public hearing is not held within 180 days of your receipt of agency comments, the amendment shall be deemed withdrawn unless extended by agreement with notice to the Department of Economic Opportunity and any affected party that provided comment on the amendment. For your assistance, we have enclosed the procedures for adoption and transmittal of the comprehensive plan amendment.

We appreciate the opportunity to work with the County's staff in the review of the amendment. If you have any questions concerning this review, please contact Jennie Leigh Copps, at (850) 717-8534, or by email at jennie.copps@deo.myflorida.com.

Sincerely,

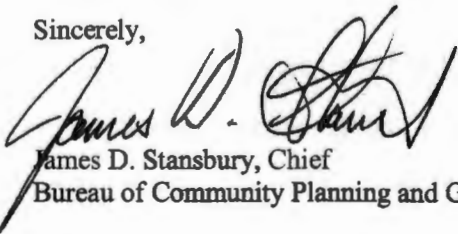

James D. Stansbury, Chief
Bureau of Community Planning and Growth

JS/jlc

Enclosure(s): Procedures for Adoption

cc: Alberto A. Vargas, MArch., Manager, Orange County Planning Division
Hugh W. Harling, Jr., P.E., Executive Director, East Central Florida Regional Planning Council

Florida Department of Economic Opportunity | Caldwell Building | 107 E. Madison Street | Tallahassee, FL 32399
850.245.7105 | www.floridajobs.org

www.twitter.com/FLDEO | www.facebook.com/FLDEO

SUBMITTAL OF ADOPTED COMPREHENSIVE PLAN AMENDMENTS

FOR EXPEDITED STATE REVIEW

Section 163.3184(3), Florida Statutes

NUMBER OF COPIES TO BE SUBMITTED: Please submit three complete copies of all comprehensive plan materials, of which one complete paper copy and two complete electronic copies on CD ROM in Portable Document Format (PDF) to the State Land Planning Agency and one copy to each entity below that provided timely comments to the local government: the appropriate Regional Planning Council; Water Management District; Department of Transportation; Department of Environmental Protection; Department of State; the appropriate county (municipal amendments only); the Florida Fish and Wildlife Conservation Commission and the Department of Agriculture and Consumer Services (county plan amendments only); and the Department of Education (amendments relating to public schools); and for certain local governments, the appropriate military installation and any other local government or governmental agency that has filed a written request.

SUBMITTAL LETTER: Please include the following information in the cover letter transmitting the adopted amendment:

_____ State Land Planning Agency identification number for adopted amendment package;

_____ Summary description of the adoption package, including any amendments proposed but not adopted;

_____ Identify if concurrency has been rescinded and indicate for which public facilities. (Transportation, schools, recreation and open space).

_____ Ordinance number and adoption date;

_____ Certification that the adopted amendment(s) has been submitted to all parties that provided timely comments to the local government;

_____ Name, title, address, telephone, FAX number and e-mail address of local government contact;

_____ Letter signed by the chief elected official or the person designated by the local government.

ADOPTION AMENDMENT PACKAGE: Please include the following information in the amendment package:

_____ In the case of text amendments, changes should be shown in strike-through/underline format.

_____ In the case of future land use map amendments, an adopted future land use map, **in color format**, clearly depicting the parcel, its future land use designation, and its adopted designation.

_____ A copy of any data and analyses the local government deems appropriate.

Note: If the local government is relying on previously submitted data and analysis, no additional data and analysis is required;

_____ Copy of the executed ordinance adopting the comprehensive plan amendment(s);

Suggested effective date language for the adoption ordinance for expedited review:

"The effective date of this plan amendment, if the amendment is not timely challenged, shall be 31 days after the state land planning agency notifies the local government that the plan amendment package is complete. If the amendment is timely challenged, this amendment shall become effective on the date the state land planning agency or the Administration Commission enters a final order determining this adopted amendment to be in compliance. No development orders, development permits, or development dependent on this amendment may be issued or commence before it has become effective. "

_____ List of additional changes made in the adopted amendment that the State Land Planning Agency did not previously review;

_____ List of findings of the local governing body, if any, that were not included in the ordinance and which provided the basis of the adoption or determination not to adopt the proposed amendment;

_____ Statement indicating the relationship of the additional changes not previously reviewed by the State Land Planning Agency in response to the comment letter from the State Land Planning Agency.

Rick Scott
GOVERNOR



Cissy Proctor
EXECUTIVE DIRECTOR

RECEIVED
July 31, 2018
AUG 03 2018
Planning Manager

Mr. Alberto A. Vargas, MArch, Manager
Orange County Planning Division
201 South Rosalind Avenue, 2nd Floor
Post Office Box 1393
Orlando, Florida 32802-1393

Dear Mr. Vargas, MArch:

Thank you for submitting the Orange County's proposed comprehensive plan amendments submitted for our review pursuant to the Expedited State Review process. The reference number for this amendment package is **Orange County 18-5ESR**.

The proposed submission package will be reviewed pursuant to Section 163.3184(3), Florida Statutes. Once the review is underway, you may be asked to provide additional supporting documentation by the review team to ensure a thorough review. You will receive the Department's Comment Letter no later than **August 30, 2018**.

If you have any questions please contact Anita Franklin, Plan Processor at (850) 717-8486 or Kelly Corvin, Regional Planning Administrator, whom will be overseeing the review of the amendments, at (850) 717-8503.

Sincerely,

D. Ray Eubanks, Administrator
Plan Review and Processing

DRE/af

Florida Department of Economic Opportunity | Caldwell Building | 107 E. Madison Street | Tallahassee, FL 32399
850.245.7105 | www.floridajobs.org
www.twitter.com/FLDEO | www.facebook.com/FLDEO

An equal opportunity employer/program. Auxiliary aids and service are available upon request to individuals with disabilities. All voice telephone numbers on this document may be reached by persons using TTY/TTD equipment via the Florida Relay Service at 711.

Rick Scott
GOVERNOR



Cissy Proctor
EXECUTIVE DIRECTOR

MEMORANDUM

TO: Florida Department of Environmental Protection
Florida Department of Education
Florida Department of State
Florida Department of Transportation District 5
East Central Florida Regional Planning Council
St Johns River Water Management
South Florida Water Management District
Florida Fish and Wildlife Conservation Commission
Florida Department of Agriculture and Consumer Services

DATE: July 31, 2018

SUBJECT: COMMENTS FOR PROPOSED EXPEDITED STATE REVIEW PLAN AMENDMENT

LOCAL GOVERNMENT/ STATE LAND PLANNING AGENCY AMENDMENT #: ORANGE CO 18-05ESR

STATE LAND PLANNING AGENCY CONTACT PERSON/PHONE NUMBER: Kelly Corvin/(850)717-8503

The referenced proposed comprehensive plan amendment is being reviewed pursuant the Expedited State Review Process according to the provisions of Section 163.3184(3), Florida Statutes. Please review the proposed documents for consistency with applicable provisions of Chapter 163, Florida Statutes.

Please note that your comments must be sent directly to and received by the above referenced local government within 30 days of receipt of the proposed amendment package. A copy of any comments shall be sent directly to the local government and to the State Land Planning Agency to the attention of Ray Eubanks, Administrator, Plan Review and Processing at the Department E-mail address: DCPexternalagencycomments@deo.myflorida.com

Please use the above referenced State Land Planning Agency AMENDMENT NUMBER on all correspondence related to this amendment.

Note: Review Agencies - The local government has indicated that they have mailed the proposed amendment directly to your agency. See attached transmittal letter. Be sure to contact the local government if you have not received the amendment. Also, letter to the local government from State Land Planning Agency acknowledging receipt of amendment is attached.

Florida Department of Economic Opportunity | Caldwell Building | 107 E. Madison Street | Tallahassee, FL 32399
850.245.7105 | www.floridajobs.org
[www.twitter.com/FLDEO](https://twitter.com/FLDEO) | www.facebook.com/FLDEO

An equal opportunity employer/program. Auxiliary aids and service are available upon request to individuals with disabilities. All voice telephone numbers on this document may be reached by persons using TTY/TTD equipment via the Florida Relay Service at 711.



RECEIVED
Comm. of Econ. Development and Growth
JUL 31 2018
Div. of Planning and Community Development
Dep.

July 24, 2018

Mr. Ray Eubanks, Plan Processing Administrator
Florida Department of Economic Opportunity (DEO)
State Land Planning Agency
Caldwell Building
107 East Madison – MSC 160
Tallahassee, Florida 32399

Re: Orange County Transmittal of the 2018-2 Regular Cycle State-Expedited Review Comprehensive Plan Amendments

Dear Mr. Eubanks:

The Orange County Board of County Commissioners (BCC) is pleased to transmit to the Florida Department of Economic Opportunity (DEO) this 2018-2 transmittal packet, which consists of Regular Cycle – State-Expedited Review amendments to the Orange County 2010-2030 Comprehensive Plan. This is the second amendment package of the calendar year 2018 and therefore is referred to as 2018-2 for Orange County filing purposes. Transmittal public hearings for these amendments were held on June 21, 2018, and July 10, 2018, before the Local Planning Agency (LPA) and BCC, respectively. One paper and two electronic copies (CD) of the proposed amendments are enclosed.

Regular Cycle Amendments

Per 163.3184(3), Florida Statutes, please note the following:

The Regular Cycle – State-Expedited Review amendments included seven privately-initiated Future Land Use Map amendments, one privately-initiated text amendment, and two staff-initiated map and/or text amendments. All of the proposed amendments were on a regular agenda.

Privately-Initiated Map Amendments

- 2018-2-A-1-1 Kathy Hattaway, Poulos & Bennett, LLC, for Daniel A. and Susan Berry/Thistledown Farm, Inc.
Village (V) to Horizon West, Village of Bridgewater Special Planning Area (SPA)
- 2018-2-A-1-2 Kathy Hattaway, Poulos & Bennett, LLC, for BB Groves, LLC
Growth Center/ Resort/Planned Development (GC/R/PD) to Growth Center-Planned Development-Resort/Low-Medium Density Residential (GC-PD-R/LMDR)
- 2018-2-A-1-3 Miranda F. Fitzgerald, Esq., Lowndes, Drosdick, Doster, Kantor & Reed, P.A., for Fairwinds Credit Union
Activity Center Mixed Use (ACMU) to Activity Center Residential (ACR)
- 2018-2-A-1-4 Miranda F. Fitzgerald, Esq., Lowndes, Drosdick, Doster, Kantor & Reed, P.A., for Kerina Wildwood, Inc., Kerina Village, Inc., Kerina Inc., and Kerina Parkside Master, Inc.

- Low Density Residential (LDR), Low-Medium Density Residential (LMDR), and Rural/Agricultural (R) to Planned Development-Commercial/Office/Medium Density Residential/Low Density Residential/Senior Living/Conservation (PD-C/O/MDR/LDR/Senior Living/CONS)
- 2018-2-A-1-6 VHB, Inc., for Daryl M. Carter Trustee and Carter-Orange 105 Sand Lake Land Trust
 Activity Center Mixed Use (ACMU), Activity Center Residential (ACR), and Low-Medium Density Residential (LMDR) to Planned Development-Commercial/Medium-High Density Residential (PD-C/MHDR)
- 2018-2-A-1-7 Momtaz Barq, P.E., Terra-Max Engineering, Inc., for Macomb Oakland Sand Lake, LLC
 Planned Development-Time Share/Medium Density Residential/Hotel/Office (PD-TS/MDR/HOTEL/O) to Planned Development-Time Share/Medium-High Density Residential/Hotel/Office (PD-TS/MHDR/HOTEL/O)
- 2018-2-A-5-1 Julie Salvo, AICP, Orange County Public Schools, for Hamilton, LLC
 Rural/Agricultural (R) to Educational (EDU)

Privately-Initiated Text Amendment

- 2018-2-P-1-5 Marc Skorman for Audrey L. Arnold Revocable Trust, Audrey L. Arnold and James P. Arnold Life Estate, Ron Marlow and Kathy Darlene Marlow, and Billy Kenneth Williams, and Lynn A. Williams
 Text amendment to proposed Future Land Use Element Policy FLU2.5.5 and creating Policy FLU2.5.5.1 related to the proposed Lake Mabel Rural Residential Enclave

Staff-Initiated Amendments

- 2018-2-B-FLUE-1 Text amendments to Future Land Use Element Policy FLU8.1.4 establishing the maximum densities and intensities for proposed Planned Developments within Orange County
- 2018-2-B-FLUE-2 Text amendment to the Horizon West Village policies for perimeter remnant parcels

Orange County certifies that the proposed amendments, including associated data and analysis and all supporting documents, have been submitted to the parties listed below simultaneously with submittal to DEO, pursuant to 163.3184(3)(b)2, Florida Statutes. The amendment package is available for public inspection at the Orange County Planning Division as well as online at:

<http://www.orangecountyfl.net/PlanningDevelopment/ComprehensivePlanning> or www.tinyurl.com/OCCompPlan

Agency	Contact
Department of Agriculture and Consumer Services	Comprehensive Plan Review
Department of Education	Tracy D. Suber, Education Consultant-Growth Management Liaison
Department of Environmental Protection	Suzanne E. Ray
Department of State	Deena Woodward, Historic Preservation Planner

DEO Letter to Ray Eubanks
2018-2 Regular Cycle Transmittal – State-Expedited Review Amendments
July 24, 2018
Page 3

Florida Fish and Wildlife Conservation Commission Governor's Office of Tourism, Trade, and Economic Development Department of Transportation, District Five	Scott Sanders Sherri Martin, Sr. Analyst Heather S. Garcia, Planning & Corridor Development Manager
East Central Florida Regional Planning Council St. Johns River Water Management District South Florida Water Management District	Andrew Landis, Regional Planner Steven Fitzgibbons, Intergovernmental Planner Terry Manning, AICP, Policy and Planning Analyst

We look forward to working with DEO staff during your review of the amendment packet. If you have any questions, please contact Greg Golgowski, AICP, Chief Planner, Comprehensive Planning Section, at 407.836.5624 or via email at Gregory.Golgowski@ocfl.net.

Sincerely,

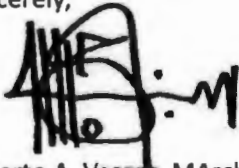

Alberto A. Vargas, MArch., Manager
Orange County Planning Division

AAV/GG/tp

enc: 2018-2 Regular Cycle State-Expedited Review Amendments DEO Transmittal Binder

c w/enclosures: Chris Testerman, AICP, Assistant County Administrator
Jon V. Weiss, P.E., Director, Community, Environmental, and Development Services Dept.
Joel Prinsell, Deputy County Attorney
Roberta Alfonso, Assistant County Attorney
John Smogor, Planning Administrator, Planning Division
Gregory Golgowski, Chief Planner, Planning Division
Sue Watson, Planner II, Planning Division