



Interoffice Memorandum

Received on August 2, 2023
Deadline: September 5, 2023
Publish: September 10, 2023

August 1, 2023

To: Jennifer Lara-Klimetz, Assistant Manager
Comptroller Clerk's Office

Through: Cheryl Gillespie, Agenda Development Supervisor
Agenda Development

From: Elizabeth R. Johnson, CEP, PWS, MPA
Interim Environmental Protection Officer
(407) 836-1511

**Staff Person: Tim Hull
Environmental Programs Administrator, PWS
(407) 836- 1428**

Subject: Request for Public Hearing on September 26, 2023, at 2:00 p.m., for a Shoreline Alteration/Dredge and Fill Permit Application (SADF-23-01-000) to authorize the construction of a seawall on the shoreline of Lake Tibet-Butler at 10017 Lone Tree Lane, Orlando, FL, 32836, Parcel ID No. 32-23-28-1874-00-090; District 1

=====
Applicants: Federico and Danielle Hollander

Type of Hearing: Shoreline Alteration/Dredge and Fill Permit Application

Hearing required by
Florida Statute # or Code: Chapter 33, Article IV, Windermere Water and Navigation Control District

Advertising requirements: Publish once in a newspaper of general circulation in Orange County at least (7) seven days prior to public hearing.

Advertising timeframes: At least (7) seven days prior to public hearing.

Abutters to be notified: The applicants and the property owners within five hundred (500) feet of the project area will be notified at least (7) seven days prior to the public hearing by the Environmental Protection Division (EPD).

Estimated time required
For public hearing: 2 minutes

August 1, 2023

Request for Public Hearing – Shoreline Alteration/Dredge and Fill Permit Application for Federico and Danielle Hollander (SADF-23-01-000)

Lake Advisory Board

To be notified:

Butler Chain of Lakes Advisory Board –
Ijaz Ahmed (Chairman) – ijazahmed736@gmail.com

Municipality or other

Public Agency to be notified:

Florida Department of Environmental Protection,
DEP_CD@dep.state.fl.us

Hearing Controversial: No

District #: 1

Materials being submitted as backup for public hearing request:

1. Location Map
2. Site Plan
3. Site Photos

Special Instructions to Clerk:

1. Once the Board of County Commissioners makes a decision on the Shoreline Alteration/Dredge and Fill Permit Application, please submit the decision letter to Liz Johnson with EPD. EPD will issue the decision to the applicants.

Advertising Language:

1. Applicants, Federico and Danielle Hollander, are requesting a Shoreline Alteration/Dredge and Fill Permit (SADF-23-01-000) to authorize the construction of a seawall, with riprap and plantings, on the shoreline of Lake Tibet-Butler at 10017 Lone Tree Lane, Orlando, FL, 32836, pursuant to Chapter 33, Article IV, Windermere Water and Navigation Control District. Parcel ID No. 32-23-28-1874-00-090; District 1 (property legal description on file at EPD).

NS/KGK/TMH/ERJ: jk

Attachments

Shoreline Alteration/Dredge and Fill Permit Request



Shoreline Alteration/Dredge and Fill Permit Request SADF-23-01-000 District #1

Applicants: Federico and Danielle
Hollander

Address: 10017 Lone Tree Lane

Parcel ID: 32-23-28-1874-00-090

Project Site 

Property Location 

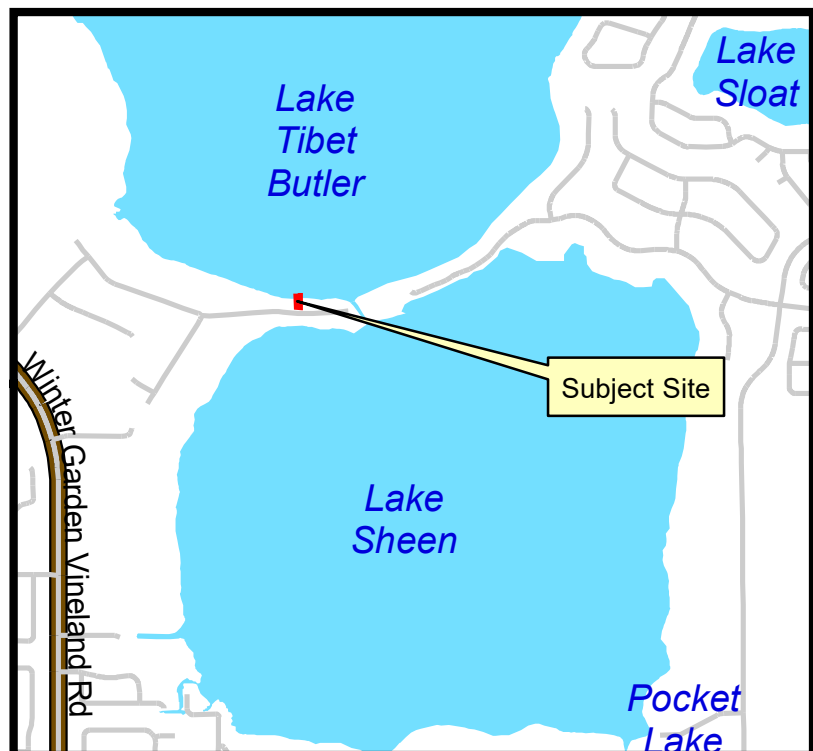

received
6/29/2023

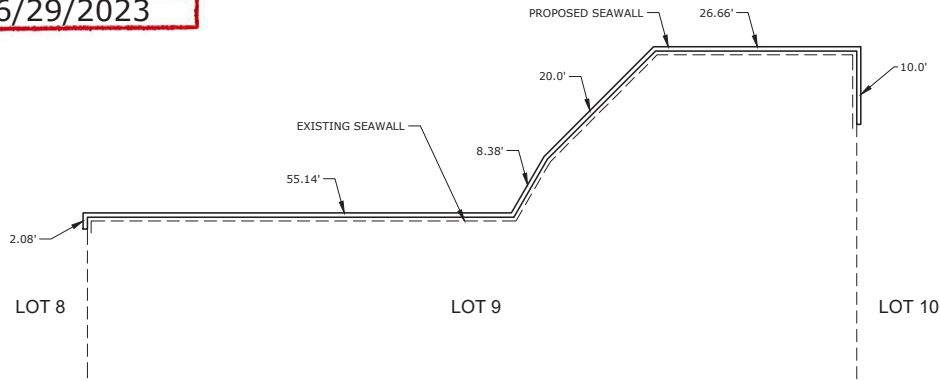

1 SEA WALL PLAN VIEW
SW-1 SCALE: 1/16" = 1'-0"

1. BUILDING CODES
- A. ALL CONSTRUCTION SHALL CONFORM WITH THE 2020 (7th EDITION) FLORIDA BUILDING CODE.
 - B. IN ADDITION, ALL CONSTRUCTION SHALL CONFORM WITH THE GOVERNING LOCAL BUILDING CODE OR LOCAL JURISDICTIONAL REQUIREMENTS.

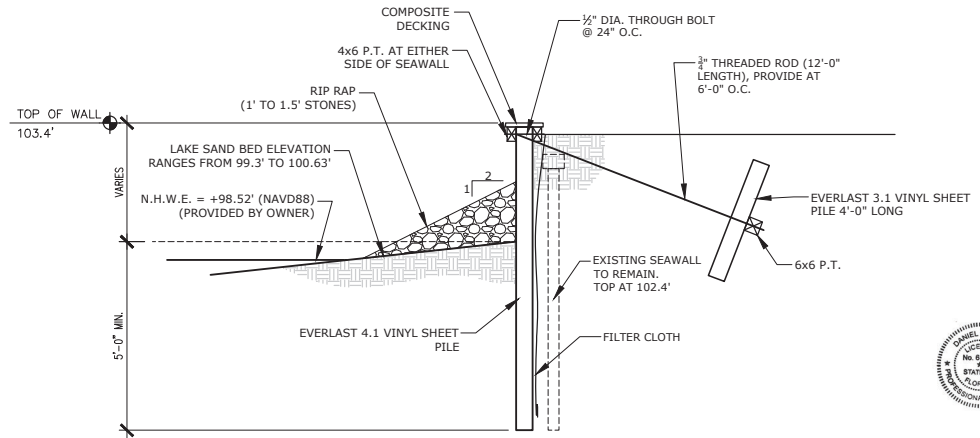

2 SEA WALL SECTION
SW-1 SCALE: NTS



DANIEL SOUTER, P.E.
P.E. # 63901
P.O. BOX 54777A
ORLANDO, FL 32854
PHONE: (407) 427-4866

alba
ENGINEERING
C.A. 800566

HOLLANDER SEAWALL
10017 LONE TREE LANE
ORLANDO, FL 32836

SEAWALL
DETAIL

Seal of Engineer:

This item has been digitally signed and sealed by Daniel Souter, P.E. on the date shown below. Printed copies of this document are not considered signed and sealed and the signature must be verified on electronic copies.
2023.06.29 14:47:00-04'00'

Daniel Souter, P.E.
FL. Reg No. 63901

Job Number: 23-135
Date: 06.29.23
Drawn: EL
Checked: DS

Sheet No.
SW-1

Shoreline Length & Maximum Distance between Current Wall & Proposed Retaining Wall

received
3/17/2023

Shoreline Length Current Wall (CW) = 109.08ft

Shoreline Length Proposed Retaining Wall (PR) = 110.18ft

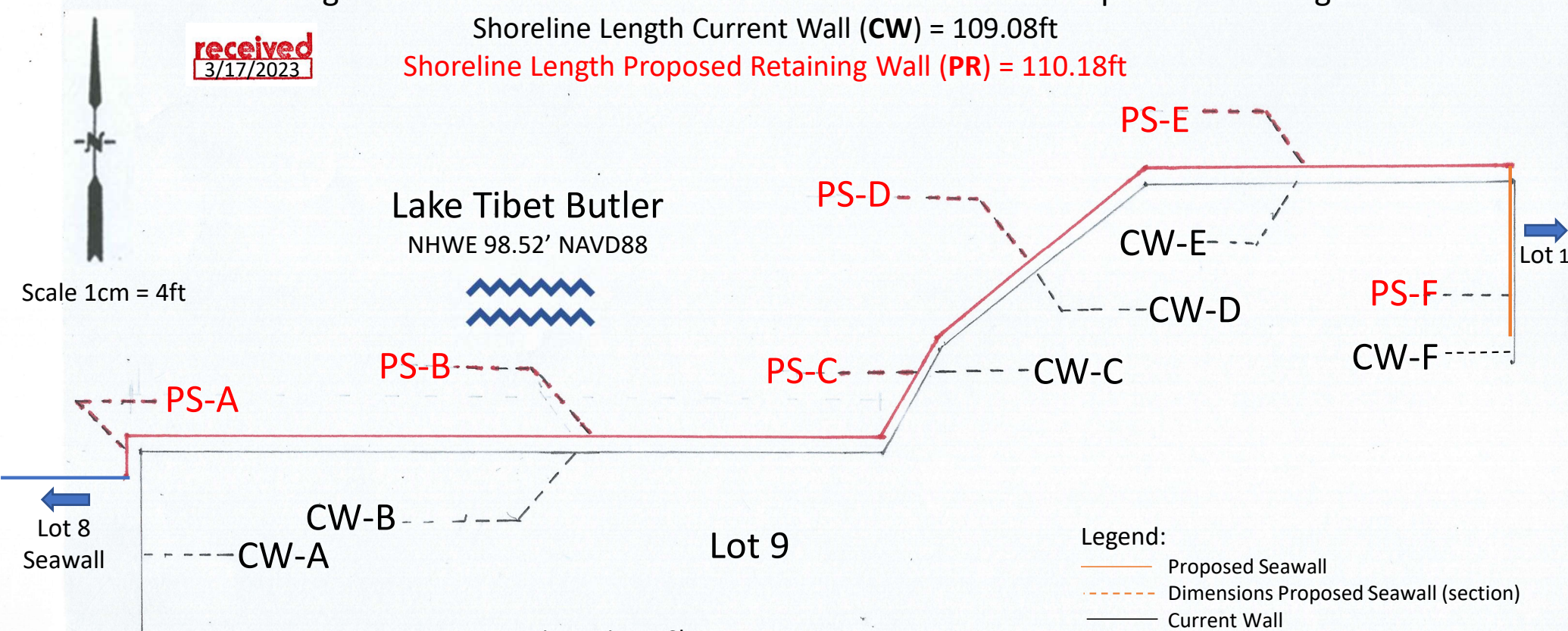

Legend:

- Proposed Seawall
- - - Dimensions Proposed Seawall (section)
- Current Wall
- - - Dimensions Current Wall (section)
- Existing Neighboring Wall (Lot 8)

Dimensions Chart
CW= Current Wall / PS= Proposed Seawall

Section	Current Wall (CW)	Proposed Seawall (PS)	Distance between Current to End of Proposed Seawall
A	13.27ft	2.08ft	12 inches
B	54.17ft	55.14ft	10 inches
C	8.66ft	8.38ft	9.75 inches
D	19.25ft	20.00ft	9.75 inches
E	27.00ft	26.66ft	12 inches
F	13.00ft	10.00ft	1 inch
Shoreline	109.08ft	110.18ft	

Federico and Danielle Hollander
10017 Lone Tree Ln.
Orlando, FL. 32836
Application No.: SADF-23-01-00
Date: March 10, 2023
Page 4 of 8

Scale 1/2 inch = 1 ft

Proposed Retaining Wall - Materials Specifications

received
3/17/2023



Back Wale

Front Wale

Lake Tibet Butler
NHWE 98.52' NAVD88



Eel Grass

Riprap

St. Augustin Sod (5lope is 5" for every 10')

Top Soil

Clean Granular Material to replace sand and soil washed into the lake due to failure of the existing wall caused by hurricane Ian

Current Concrete Anchor

Proposed Anchor

Proposed Retaining Wall 10'

Current Wall 8'

Element	Specification	Notes
Wall	Vinyl Sheet ESP 4.1	10' long 8" wide, 5' min. into sand bed
Wall Wales	6"x6" front, 6"x2" back	Pressure treated marine grade, staggered
Anchor	Vinyl Sheet ESP 3.1	20 x 4' long 40" wide; waler 6"x6"
Anchor Rod	3/4 SS Tie Rod	20 x 12' long 6' apart starting 3' from West
Riprap	1- 1.5' in diameter	Ordovician Dolomitic Limestone
Plantings	100 x American Eel Grass	2 rows of 50 each 18" apart staggered first row 1ft end of riprap 3' underwater, second row 18" from first row seaward. Total of 100 plants
Landward fill	Clean granular material compacted to 95%, 1' deep soil, St. Augustin sod	
Drainage	12 x S/O Everdrain Weep Hole 10' apart 2' from top of Proposed Retaining Wall	

Sediment and Erosion Control Using a Floating Turbidity Curtain

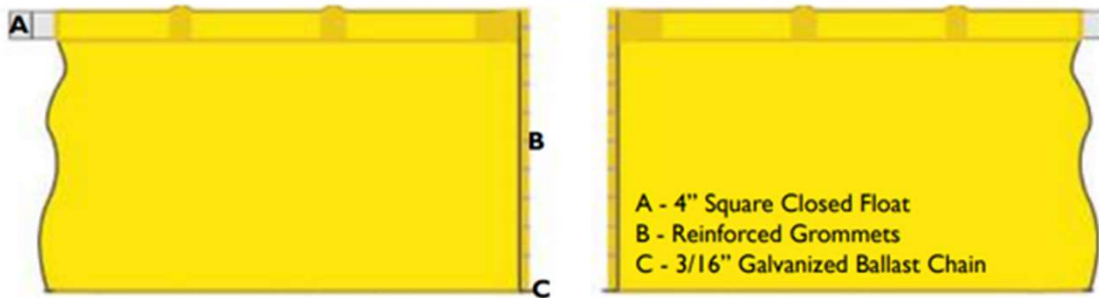
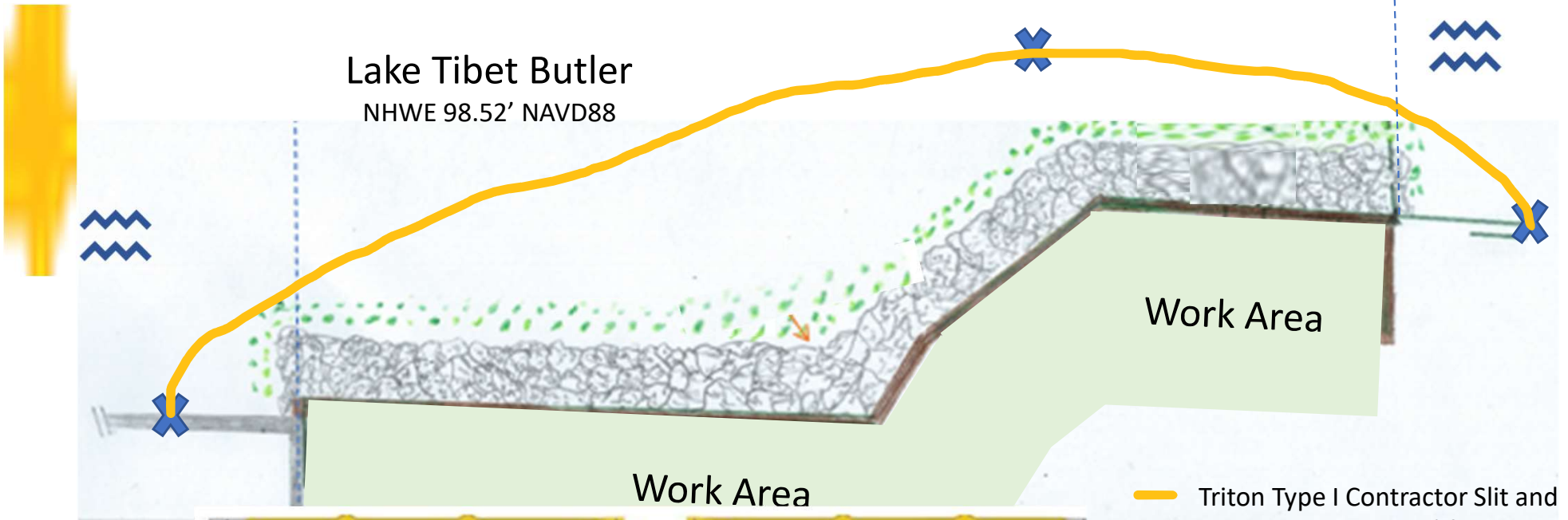

— Triton Type I Contractor Slit and Turbidity Barrier 150' floating turbidity curtain. In 50'x3' sections

✕ Anchor Points . Since the water is shallow manufacturer recommends using rebar or wooden stake at both ends and somewhere near the middle to hold the curtain in place so it doesn't wash up to job site

Triton Type I Contractor Slit and Turbidity Barrier Specifications

Length	150' in sections of 50'
Depth	3'
Fabric	13 oz. PVC
Flotation	Square Foam Filled Flotation (A)
Flotations Size	4"
Bottom Ballast Chain	3/16" Galvanized Chain (C)
Section Connectors	Grommets (B)
Color	Yellow

Federico and Danielle Hollander
10017 Lone Tree Ln.
Orlando, FL. 32836
Application No.: SADF-23-01-00
Date: Feb 07, 2023
Page 8 of 8



