

NOTICE

Shoreline Alteration/Dredge & Fill

Planning, Environmental & Development Services / EPD

The applicant and/or agent are required to attend this meeting. All other interested parties are invited to attend and be heard. If you have any questions regarding the public hearing, contact EPD at (407) 836-1400

SADF-24-08-020

SUMMARY OF REQUEST

The applicants, Walter and Elizabeth Schwarz, are requesting an After-the-Fact Shoreline Alteration Dredge and Fill permit (SADF-24-08-020) to authorize the replacement of the existing concrete rubble shoreline stabilization with a natural stone riprap revetment and plantings, on the shoreline of Lake Ola. The property is located at 5039 Dora Drive, Mount Dora, FL 32757. (Parcel ID No. 07-20-27-0000-00-024); District 2.

Project Name: Schwarz - 5039 Dora Dr
Applicant: Walter and Elizabeth Schwarz
Parcel ID: 07-20-27-0000-00-024
Location: 5039 Dora Dr.,
Mount Dora, FL 32757
Lake Name: Ola

The plans can be viewed here:
https://fasttrack.ocfl.net/OnlineServices/Permit_Environmental.aspx
or by contacting the project manager

March 25, 2025

2:00 P.M.

BOARD OF COUNTY
COMMISSIONERS

201 S. Rosalind Ave
Orlando, FL 32801

COMMISSIONER
Christine Moore,
District 2

PROJECT MANAGER
Sarah Given-Jameson
(407)-836-1523

ENVIRONMENTAL PROTECTION DIVISION
(407) 836-1400

SUBJECT PROPERTY / LOCATION MAP

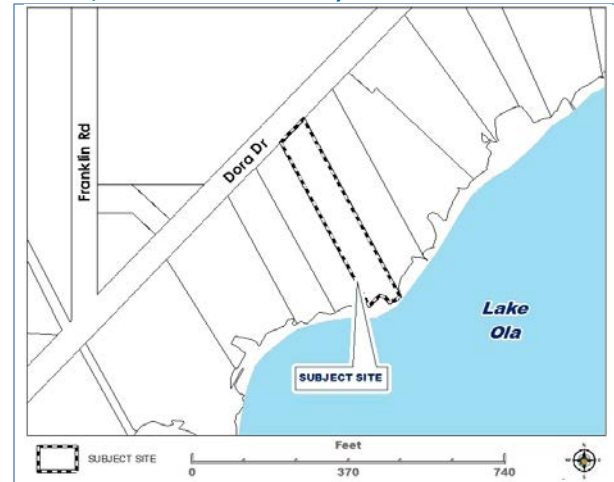



Orange County Government
201 S. Rosalind Avenue, 2nd Fl.
Orlando, FL 32801

Any party requesting additional information regarding the proposed Shoreline Alteration should contact the Orange County Environmental Protection Division: 3165 McCrory Place, Suite 200 Orlando, FL 32803, (407) 836-1400 or email EPD@ocfl.net.

In accordance with the Americans with Disabilities Act (ADA), any person requiring special accommodations to participate in this proceeding should contact the Orange County Communications Division no later than two (2) business days prior to the proceeding, at 201 S.Rosalind Ave., 3rd Floor. Orlando, FL, (407) 836-6568.

Para más información, favor de comunicarse con la división de protección ambiental, al número (407) 836-3111.

Pou plis enfòmasyon, kontaké pwoteksyon anviwònman divizyon, nan nimewo (407) 836-3111.

SCAN ME

for more Information



«ORDER», («HEARING»)
CURRENT RESIDENT or
«AddressBlock»

Public Notification Map

SADF-24-08-020

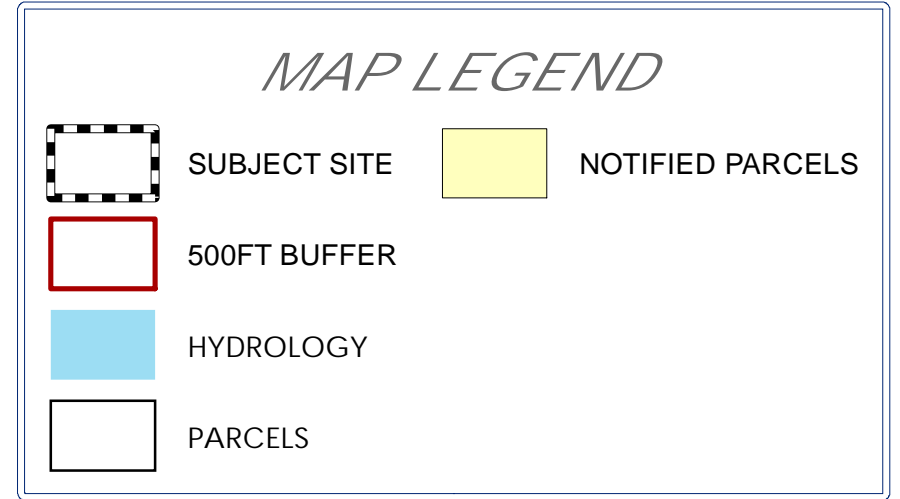
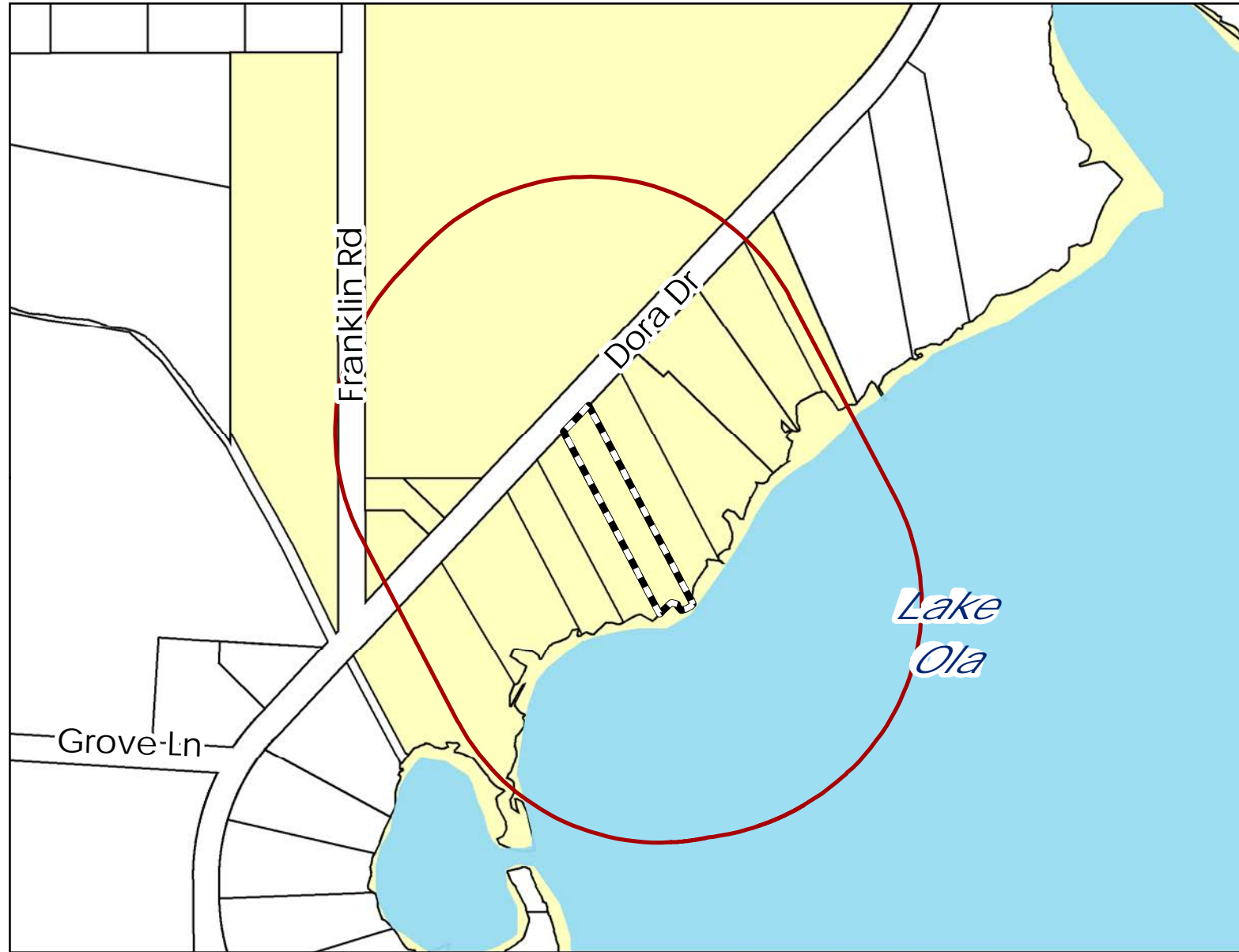

BUFFER DISTANCE: 500
OF NOTICES: 18

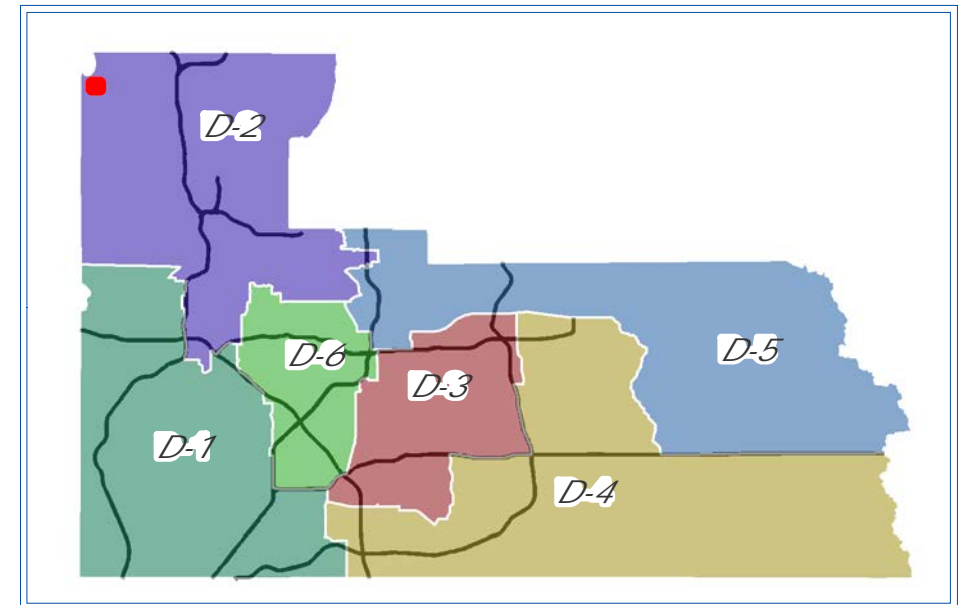

SUBJECT SITE

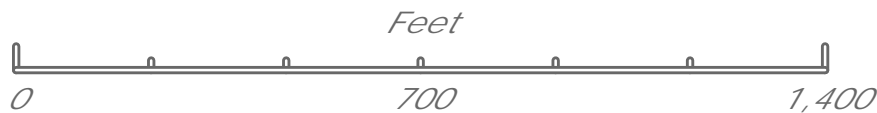

SADF-24-08-020

500FT BUFFER, 18 NOTICES

ORDER	NAME	BUSINESS	ADDRESS	CITY	STATE	ZIP	PARCEL	HEARING
1	**SHEILA CICHRA	STREAMLINE PERMITTING, INC.	1002 FORT MASON DRIVE	EUSTIS	FL	32726		SADF-24-08-020
2	BAGWELL STANLEY E		5025 FRANKLIN RD	MOUNT DORA	FL	32757	272007000000019	SADF-24-08-020
3	BAGWELL STANLEY E		5020 DORA DR	MOUNT DORA	FL	32757	272007000000021	SADF-24-08-020
4	FRANKLIN DORA HOLDINGS LLC		PO BOX 1263	LONGWOOD	FL	32752	272007000000018	SADF-24-08-020
5	GRINNELL CHARLES E JR		5023 DORA DR	MOUNT DORA	FL	32757	272007000000038	SADF-24-08-020
6	GRINNELL JOHN M		PO BOX 2	TANGERINE	FL	32777	272007000000025	SADF-24-08-020
7	GRINNELL JOHN M		5013 DORA DR	MOUNT DORA	FL	32757	272007000000025	SADF-24-08-020
8	JAMES JASON L		5005 DORA DR	MOUNT DORA	FL	32757	272007000000028	SADF-24-08-020
9	LAKE CARLTON ESTATES HOLDING LLC		PO BOX 1263	LONGWOOD	FL	32752	272007000000013	SADF-24-08-020
10	MCCALLUM DONALD R		5159 DORA DR	MOUNT DORA	FL	32757	272007000000051	SADF-24-08-020
11	MOORE CHERYL A LIFE ESTATE		5032 DORA DR	MOUNT DORA	FL	32757	272007000000040	SADF-24-08-020
12	OSHMANN HAROLD B		5147 DORA DR	MOUNT DORA	FL	32757	272007000000023	SADF-24-08-020
13	RAPALJE PHILIP		5047 DORA DR	MOUNT DORA	FL	32757	272007000000039	SADF-24-08-020
14	SCHWARZ WALTER J		5039 DORA DR	MOUNT DORA	FL	32757	272007000000024	SADF-24-08-020
15	SMITH NELSON MICHAEL		5171 DORA DR	MOUNT DORA	FL	32757	272007000000052	SADF-24-08-020
16	STAMMEL SYLVIA		5107 DORA DR	MOUNT DORA	FL	32757	272007000000020	SADF-24-08-020
17	TIITF		3900 COMMONWEALTH BLVD	TALLAHASSEE	FL	32399	272007000000066	SADF-24-08-020
18	WALLIS STEPHANIE MICHELLE		5011 DORA DR	MOUNT DORA	FL	32757	272007000000026	SADF-24-08-020