

Case Information

Case Number: SS-23-07-043 & RZ-23-07-044

Project Name: 8516 Old Winter Garden Road
and 109 Lake Rose Drive

Parcel ID: 27-22-28-7660-00-021,
27-22-28-7660-00-030

Location: 8516 Old Winter Garden Road; generally
located at the southwest corner of the Lake Rose
Drive, Old Winter Garden Road intersection.

Acreeage: 0.32 acre

Subject Property Location Map

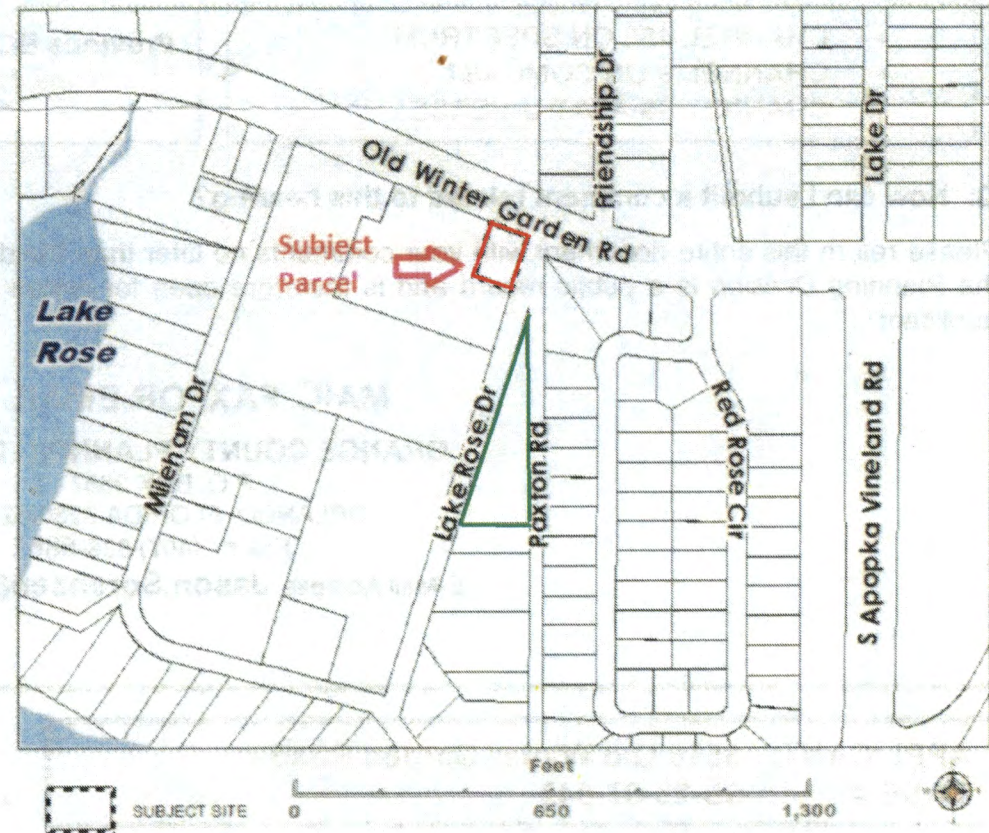

Request

This request was previously heard by the Board of County Commissioners on February 6, 2024, where it was continued to May 7, 2024. The applicant has since withdrawn the portion of the request that pertained to 109 Lake Rose Drive (the triangle parcel). The request that will be heard by the Board on May 7th will involve only a Future Land Use Map amendment from Low Density Residential (LDR) to Commercial (C) for the property located at 8516 Old Winter Garden Road (Parcel 27-22-28-7660-00-021). The property is already zoned C-1 (Retail Commercial District). The purpose of the FLU amendment to Commercial is for consistency between the FLU and zoning. The applicant intends to keep the existing office on the property.