



Interoffice Memorandum

AGENDA ITEM

May 28, 2020

TO: Mayor Jerry L. Demings  
–AND–  
Board of County Commissioners

FROM: Jon V. Weiss, P.E., Chairman  
Roadway Agreement Committee

SUBJECT: June 23, 2020 – Consent Item  
Proportionate Share Agreement for Poinciana Boulevard Multifamily  
Winter Garden-Vineland Road from Osceola County Line to World  
Center Drive

The Roadway Agreement Committee has reviewed a Proportionate Share Agreement for Poinciana Boulevard Multifamily Winter Garden-Vineland Road from Osceola County Line to World Center Drive ("Agreement") by and between Vineland Apartments Owner, LLC, and Orange County for a proportionate share payment in the amount of \$89,592. Pursuant to Section 163.3180(5)(h), Florida Statutes, an applicant may mitigate capacity deficiencies by entering into a Proportionate Share Agreement and contributing a proportionate share payment. The Proportionate Share Payment is due within 90 days of the effective date of this Agreement.

The Agreement follows the recommendation of the Roadway Agreement Committee providing for the mitigation of road impacts for eight deficient trips on the road segments of Winter Garden-Vineland Road from Osceola County Line to SR 536/World Center Drive in the amount of \$11,199 per trip.

The Roadway Agreement Committee approved the Agreement on May 20, 2020. The Specific Project Expenditure Report and Relationship Disclosure Forms are on file with the Transportation Planning Division.

If you have any questions, please feel free to contact me at 407-836-5393.

**ACTION REQUESTED: Approval and execution of Proportionate Share Agreement for Poinciana Boulevard Multifamily Winter Garden-Vineland Road from Osceola County Line to World Center Drive by and between Vineland Apartments Owner, LLC and Orange County for a proportionate share payment in the amount of \$89,592. District 1**

JVW/HEGB/fb  
Attachment

BCC Mtg. Date: June 23, 2020

This instrument prepared by  
and after recording return to:

M. Rebecca Wilson, Esquire  
Lowndes, Drosdick, Doster, Kantor & Reed, P.A.  
215 North Eola Drive  
Post Office Box 2809  
Orlando, FL 32802-2809  
(407) 843-4600

Parcel ID Numbers:  
35-24-28-5844-00-732  
35-24-28-5844-00-741  
35-24-28-5844-00-870

-----[SPACE ABOVE THIS LINE FOR RECORDING DATA]-----

**PROPORTIONATE SHARE AGREEMENT FOR  
POINCIANA BOULEVARD MULTIFAMILY**

---

**WINTER GARDEN-VINELAND ROAD FROM OSCEOLA COUNTY LINE  
TO WORLD CENTER DRIVE**

This Proportionate Share Agreement (the “Agreement”), effective as of the latest date of execution (the “**Effective Date**”), is made and entered into by and between VINELAND APARTMENTS OWNER, LLC, a Delaware limited liability company (“**Owner**”), whose principal place of business is 1555 Palm Beach Lake Boulevard, Suite 840, West Palm Beach, FL 33401 and ORANGE COUNTY, a charter county and political subdivision of the State of Florida (“**County**”), whose address is P.O. Box 1393, Orlando, FL 32802-1393.

WHEREAS, Owner is the owner of fee simple title to certain real property, as generally depicted on Exhibit “A” and more particularly described on Exhibit “B,” both of which exhibits are attached hereto and incorporated herein by this reference (the “**Property**”); and

WHEREAS, the Property is located in County Commission District 1, within the County’s Urban Service Area, and the proceeds of the PS Payment, as defined herein, will be allocated to Winter Garden-Vineland Road; and

WHEREAS, Owner intends to develop the Property as 296 multi-family units referred to and known as Poinciana Boulevard Multifamily (the “**Project**”); and

WHEREAS, Owner received a letter from County dated April 23, 2020, stating that Owner’s Capacity Encumbrance Letter (“**CEL**”) application # 19-10-081 for the Project was denied; and

WHEREAS, the Project will generate eight (8) deficient PM Peak Hour trips (the “**Excess Trips**”) for the deficient roadway segment on Winter Garden-Vineland Road from Osceola County Line to World Center Drive (the “**Deficient Segment**”), and zero (0) PM Peak Hour trips were available on the Deficient Segment on the date the CEL was denied, as further described in Exhibit “C” attached hereto and incorporated herein; and

WHEREAS, the Excess Trips will cause the Deficient Segment to operate below adopted Level of Service standards; therefore, pursuant to Section 163.3180(5)(h), Florida Statutes, as amended, the Owner shall provide the County with proportionate share mitigation for the Excess Trips; and

WHEREAS, Owner and County have agreed that the proportionate share payment necessary to mitigate the impact of the Excess Trips on the Deficient Segment through the current anticipated Project buildout is Eighty-Nine Thousand, Five Hundred Ninety-Two and 00/100 Dollars (\$89,592.00) (the “**PS Payment**”); and

WHEREAS, County and Owner desire to set forth certain terms, conditions, and agreements between them as to the development of the Property into the Project.

NOW, THEREFORE, in consideration of the premises contained herein and other good and valuable consideration exchanged by and between Owner and County, the receipt and sufficiency of which are hereby acknowledged, the parties hereto stipulate and agree as follows:

**Section 1. Recitals.** The above recitals are true and correct and are incorporated herein by this reference.

**Section 2. PS Payment; CEL.**

(a) **Calculation of PS Payment:** The amount of the PS Payment for the Deficient Segment, as described in Exhibit “C,” totals Eighty-Nine Thousand, Five Hundred Ninety-Two and 00/100 Dollars (\$89,592.00). This PS Payment was calculated in accordance with the methodology outlined in Section 163.3180, Florida Statutes. Owner and County agree that the Excess Trips will constitute the Project’s impact on the aforementioned Deficient Segment based upon (i) Owner’s Traffic Study titled “POINCIANA WORLD RESORT” prepared by Traffic & Mobility, dated January, 2020 for Avention Companies (the “**Traffic Study**”), which is incorporated herein by this reference, and (ii) upon the calculations described in Exhibit “C.” The Traffic Study was accepted by the Orange County Transportation Planning Division on April 21, 2020, (CMS # 2019081). Owner and County further acknowledge and agree that the PS Payment as set forth above shall be the final and binding calculation of the amount the Owner is required to pay through the buildout of the currently approved Project as proportionate share mitigation for impacts of the Project upon roadways within Orange County’s jurisdiction, notwithstanding any subsequent variance in the actual cost of improvement to the Deficient Segment or actual traffic impacts created by the Project; provided, however, that if Owner subsequently increases the number of units and/or square footage, as applicable, of the Project, the Project may then be subject to an additional concurrency evaluation and proportionate share agreement as set forth in Section 2(d) below. Owner and County further acknowledge and agree that the calculation of, and agreement regarding, the amount of the PS Payment constitute material inducements for the parties to enter into this Agreement.

(b) *Timing of PS Payment, Issuance of CEL.* Within ninety (90) days following the Effective Date, Owner shall deliver a check to County in the amount of Eighty-Nine Thousand, Five Hundred Ninety-Two and 00/100 Dollars (\$89,592.00) as the PS Payment. The check shall be made payable to "Orange County Board of County Commissioners" and shall be delivered to the Fiscal and Operational Support Division of the Planning, Environmental, and Development Services Department. Within twenty-one (21) days following its receipt of the PS Payment, if the Property's future land use designation and zoning are consistent with the Project's proposed development, County shall issue a CEL sufficient to encumber traffic capacity for the Project, irrespective of any actual traffic deficiency on the Deficient Segments. Within the time frame provided in the CEL, the Owner must reserve the encumbered trips by obtaining a Capacity Reservation Certificate as provided in Section 30-591 of the Orange County Code, as may be amended. An amount equal to the PS Payment shall be applied toward the amount of the initial capacity reservation payment (and any subsequent reservation payment(s), if the initial reservation payment does not exceed the amount of the PS Payment) as further set forth in Section 3 below. In the event Owner has not paid the PS Payment within ninety (90) days of the Effective Date, one extension of ninety (90) days may be granted by the manager of County's Transportation Planning Division. In the event Owner has not paid the PS Payment to County within one hundred eighty (180) days after the Effective Date, this Agreement shall become null and void.

(c) *Project Development.* Recordation of a subdivision plat or approval of a commercial site plan for the Project shall not be permitted prior to the issuance of a Capacity Reservation Certificate as contemplated in subparagraph 2(b) above.

(d) *Increase in Project Trips.* Any change to the Project which increases the unit count and/or square footage, as applicable, may result in an increase in trips on the Deficient Segment or other segments within the transportation impact area, as defined by County. Owner understands and agrees that any such additional trips are neither vested nor otherwise permitted under this Agreement, and that Owner is precluded from asserting any such vesting. In addition, Owner understands and agrees that any such changes resulting in an increase in trips may cause this Agreement to become null and void, and/or may require application for and execution of an additional Proportionate Share Agreement, along with any other required documentation, for the number of increased trips.

(e) *Satisfaction of Transportation Improvement Requirements.* County hereby acknowledges and agrees that upon Owner's payment of the PS Payment as required herein, and absent any change in the Project increasing the number of trips as set forth in subparagraph 2(d) above, Owner shall be deemed to have satisfied all requirements for the mitigation of the traffic impacts of the Project on all roads affected by the Project within County's jurisdiction through buildout of the Project. Owner shall be entitled to fully and completely develop the Project, without regard to whether the improvements to the Deficient Segment are actually constructed; provided, however, Owner shall be required to obtain a Capacity Reservation Certificate prior to the expiration of Owner's Capacity Encumbrance Letter and shall be required to maintain the validity of the Capacity Reservation Certificate in accordance with its terms. Additionally, nothing herein shall be construed to exempt Owner from meeting the requirements of all other applicable laws, regulations, and/or Orange County Code provisions or from making the required payment of transportation impact fees applicable to the Project, subject to credits as set forth in Section 3 below.

**Section 3. Transportation Impact Fee Credits.** County and Owner agree that Owner shall be entitled to receive transportation impact fee credits on a dollar for dollar basis in an amount up to but not exceeding the PS Payment in accordance with Section 163.3180, Florida Statutes, and as specifically described in Exhibit "C." County further agrees that such credits may be applied on a dollar for dollar basis against capacity reservation fees at such time as capacity reservation fees may be required to be paid by Owner in connection with the issuance of a Capacity Reservation Certificate as contemplated in Section 2 above. In no event shall Owner receive credits in excess of the PS Payment and in the event the PS Payment exceeds either the applicable transportation impact fees or capacity reservation fees, as the case may be, Owner shall not be entitled to a refund for the amount of the PS Payment in excess of such transportation impact fees or capacity reservation fees.

**Section 4. No Refund.** The PS Payment (including any capacity reservation fees paid with the PS Payment) is non-refundable.

**Section 5. Notice.** With the exception of the timing of the PS Payment as set forth in Section 2(b) hereof, the parties acknowledge and agree that no party shall be considered in default for failure to perform under this Agreement until such party has received written notice specifying the nature of such default or failure to perform and said party fails to cure said default or fails to perform within thirty (30) days of receipt of written notice. Any notice delivered with respect to this Agreement shall be in writing and be deemed to be delivered (whether or not actually received) (i) when hand delivered to the person(s) hereinafter designated, or (ii) upon deposit of such notice in the United States Mail, postage prepaid, certified mail, return receipt requested, addressed to the person at the address set forth opposite the party's name below, or to such other address or other person as the party shall have specified by written notice to the other party delivered in accordance herewith:

As to Owner: Vineland Apartments Owner, LLC  
1555 Palm Beach Lake Boulevard, Suite 840  
West Palm Beach, FL 33401

With copy to: Rebecca Wilson  
Lowndes, Drosdick, Doster, Kantor & Reed, P.A.  
215 N. Eola Drive  
Orlando, FL 32801

As to County: Orange County Administrator  
P. O. Box 1393  
Orlando, Florida 32802-1393

With copy to: Orange County  
Planning, Environmental, and Development Services Department  
Manager, Fiscal and Operational Support Division  
201 South Rosalind Avenue, 2<sup>nd</sup> Floor  
Orlando, Florida 32801

Orange County  
Planning, Environmental, and Development Services Department  
Manager, Transportation Planning Division  
4200 South John Young Parkway, 2nd Floor  
Orlando, Florida 32839

Orange County  
Planning, Environmental, and Development Services Department  
Manager, Planning Division  
201 South Rosalind Avenue, 2nd Floor  
Orlando, Florida 32801

**Section 6. Covenants Running with the Property.** This Agreement shall be binding and shall inure to the benefit and burden of the heirs, legal representatives, successors, and assigns of the parties, and shall be a covenant running with the Property and be binding upon the successors and assigns of the Owner and upon any person, firm, corporation, or entity who may become the successor in interest to the Property.

**Section 7. Recordation of Agreement.** The parties hereto agree that this Agreement shall be recorded in the Public Records of Orange County, Florida, at Owner's expense, within ten (10) business days after the Effective Date.

**Section 8. Applicable Law.** This Agreement and the provisions contained herein shall be construed, controlled, and interpreted according to the laws of the State of Florida and in accordance with the Orange County Code.

**Section 9. Specific Performance.** County and Owner shall each have the right to enforce the terms and conditions of this Agreement only by an action for specific performance. Venue for any action(s) initiated under or in connection with this Agreement shall lie in the Circuit Court of the Ninth Judicial Circuit in and for Orange County, Florida.

**Section 10. Attorney Fees.** In the event either party hereto brings an action or proceeding including any counterclaim, cross-claim, or third party claim, against the other party arising out of this Agreement, each party in such action or proceeding, including appeals therefrom, shall be responsible for its own attorney and legal fees.

**Section 11. Construction of Agreement; Severability.** Captions of the Sections and Subsections of this Agreement are for convenience and reference only; any words contained therein shall in no way be held to explain, modify, amplify, or aid in the interpretation, construction, or meaning of the provisions of this Agreement. If any provision of this Agreement, the deletion of which would not adversely affect the receipt of any material benefits by any party hereunder or

substantially increase the burden of any party hereunder, shall be held to be invalid or unenforceable to any extent by a court of competent jurisdiction, the same shall not affect in any respect whatsoever the validity or enforceability of the remainder of this Agreement.

**Section 12. Amendments.** No amendment, modification, or other change(s) to this Agreement shall be binding upon the parties unless in writing and formally executed by all of the parties.

**Section 13. Termination.** In the event either (i) Owner has not paid the PS Payment to County within one hundred eighty (180) days after the Effective Date, as contemplated in Subsection 2(b), or (ii) Owner has timely paid the PS Payment to County and the Project has been constructed on the Property pursuant to a County building permit, this Agreement shall automatically terminate and thereafter be null and void for all purposes.

**Section 14. Counterparts.** This Agreement may be executed in up to three (3) counterparts, each of which shall be deemed to be an original and all of which together shall constitute one and the same instrument.

[Signatures appear on following pages]

Proportionate Share Agreement, Poinciana Boulevard Multifamily  
Vineland Apartments Owner, LLC for Winter Garden-Vineland Road, 2020

IN WITNESS WHEREOF, the parties have caused this Agreement to be duly executed by  
their respective duly authorized representatives on the dates set forth below.

“COUNTY”

ORANGE COUNTY, FLORIDA  
By: Board of County Commissioners

By: *Jerry L. Demings*  
for Jerry L. Demings  
Orange County Mayor

Date: JUN 23 2020

ATTEST: Phil Diamond, CPA, County Comptroller  
As Clerk of the Board of County Commissioners

By: *Katie Smith*  
Deputy Clerk

Print Name: Katie Smith

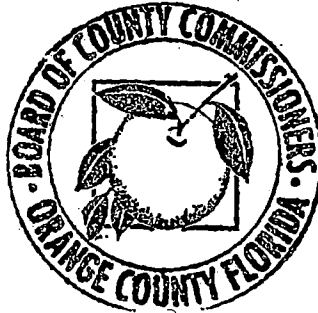



WITNESSES:

“OWNER”

VINELAND APARTMENTS OWNER,  
LLC, a Delaware limited liability company

By: Aventon Manager, LLC,  
a Delaware limited liability company,  
its Manager

*Ch Lockett*  
Print Name: CHRISTOPHER M. LUCKETT

By: *[Signature]*  
Paul DeCain, President

*Sherry Paylor*  
Print Name: SHERRY A. PAYLOR

STATE OF: DISTRICT OF  
COUNTY OF: COLUMBIA

The foregoing instrument was acknowledged before me by means of  physical presence  
or  online notarization, this 26<sup>TH</sup> day of MAY, 2020, by Paul DeCain, as President of  
Aventon Manager, LLC, as manager of VINELAND APARTMENTS OWNER, LLC, a Delaware  
limited liability company. He  is personally known to me or  has produced  
DC DRIVER LICENSE as identification.

WITNESS my hand and official seal in the County and State last aforesaid this 26<sup>TH</sup>  
day of MAY, 2020.

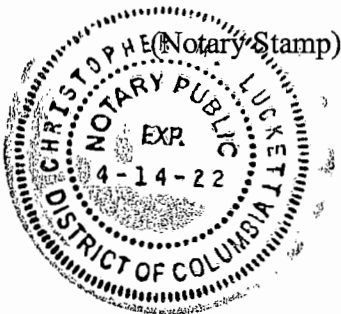

*Ch Lockett*  
Signature of Notary Public  
Print Name: CHRISTOPHER M. LUCKETT  
Notary Public, State of: DISTRICT OF COLUMBIA  
Commission Expires: 4/14/2022

**Exhibit A**

**POINCIANA BOULEVARD MULTIFAMILY**

**Project Location Map**

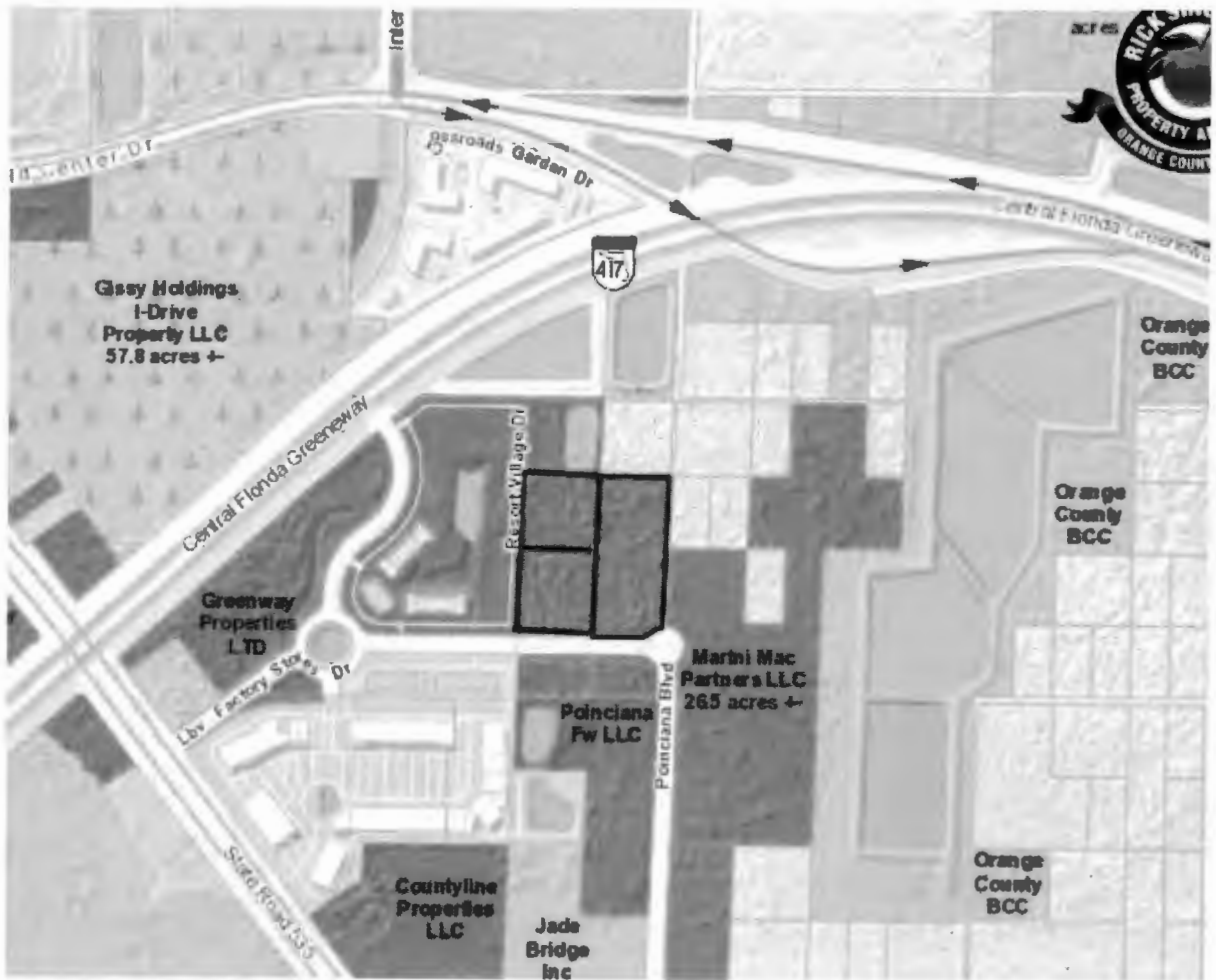

**Exhibit "B"**

**POINCIANA BOULEVARD MULTIFAMILY**

Parcel IDS: 35-24-28-5844-00-732

35-24-28-5844-00-741

35-24-28-5844-00-870

**Legal Description:**

A parcel of land being the South 1/2 of Tract 73 along with the South 1/2 of Tract 74, and a portion of Tracts 87 and 88, and a portion of the 15.00 foot wide right of way of MUNGER LAND COMPANY SUBDIVISION, in Section 35, Township 24 South, Range 28 East, according to the Plat thereof as recorded in Plat Book E, Page 23, of the Public Records of Orange County, Florida, lying North of the right-of-way of Parcel #1 as described in Official Records Book 6265, Page 1430, of the Public Records of Orange County, Florida, being more particularly described as follows:

Commence at the Southwest corner of said Tract 87, and run North 02°09'06" East along the West line of Tract 87, a distance of 250.16 feet to the Point of Beginning; thence continue North 02°09'06" East along the West line of said Tract 87, for a distance of 400.50 feet to the Northwest corner of said Tract 87; thence continue North 02°09'06" East, along the West line of said Tract 74, a distance of 325.40 feet to the Northwest corner of the South 1/2 of said Tract 74; thence run South 89°45'09" East, along the North line of the South 1/2 of said Tract 74, a distance of 331.41 feet to the Northwest corner of the South 1/2 of said Tract 73; thence run South 89°45'09" East, along the North line of the South 1/2 of said Tract 73, for a distance of 331.31 feet to the West line of the Southeast 1/4 of Section 35, Township 24 South, Range 28 East; thence South 02°14'15" West, along the West line of said Southeast 1/4, for a distance of 678.62 feet to a point on a non-tangent curve concave to the South and having a radius of 86.00 feet; thence from a tangent bearing of North 86°05'00" West run through a delta angle of 48°44'44" run Southwesterly along the arc of said curve for a distance of 73.17 feet to a point of reverse curvature of a curve concave to the North and having a radius of 71.00 feet; thence, through a delta angle of 44°56'15", run Southwesterly along the arc of said curve for a distance of 55.69 feet to a point of tangency; thence North 89°53'29" West for a distance of 546.76 feet to the Point of Beginning.

LESS AND EXCEPT that certain 15 foot right of way per Plat Book E, Page 23, along the East property line.

**Exhibit "C"**

**POINCIANA BOULEVARD MULTIFAMILY**

Log of Project Contributions  
Winter Garden-Vineland Road from Osceola County Line to World Center Drive

[See attached 1 page]

**Log of Project Contributions**  
**Winter Garden-Vineland Rd (Osceola County Line to SR 536/World Center Dr)**

**Roadway Improvement Project Information**

Planned Improvement Roadway(s)	Limits of Improvement (From - To)		Segment Length	Adopted LOS	Existing Generalized Capacity	Type of Improvement	Improved Generalized Capacity	Capacity Increase	Total Project Cost	Cost / Trip
Winter Garden-Vineland Road	Osceola County Line	SR 536 / World Center Dr	0.91	E	2000	Widen from 4 to 6 lanes	3020	1020	\$11,422,817	\$11,100

**County Share of Improvement**

Planned Improvement Roadway(s)	Limits of Improvement (From - To)		Segment Length	Adopted LOS	Existing Generalized Capacity	Backlogged Trips	Improved Generalized Capacity	Capacity Increase	County (Backlog) Responsibility
Winter Garden-Vineland Road	Osceola County Line	SR 536 / World Center Dr	0.91	E	2000	543	3020	1020	\$8,080,970

**Developer Share of Improvement**

Planned Improvement Roadway(s)	Limits of Improvement (From - To)		Segment Length	Adopted LOS	Existing Generalized Capacity	Improved Generalized Capacity	Capacity Increase	Backlogged Trips	Capacity Increase for New Development	Remaining Project Cost	Cost / Trip
Winter Garden-Vineland Road	Osceola County Line	SR 536 / World Center Dr	0.91	E	2000	3020	1020	543	477	\$5,341,847	\$11,100

Updated: 4/23/20

**Log of Project Contributions**

	Date	Project	Project Trips	Prop Share
Existing	Apr-14	Existing plus Committed	479	\$4,937,532
	Apr-14	Outer Circle	15	\$154,620
	Sep-16	Downey SR 535	16	\$155,824
	Mar-19	Martini Property Hotel (Nadeen Tanmore)	15	\$146,085
	Apr-19	The Addison on Lake Bryan	7	\$68,173
	Jun-19	Kadmar Plaza	11	\$107,129
			<b>Backlogged Totals:</b>	<b>543</b>
Proposed	Apr-20	Ponciana Blvd MF	8	\$89,592
				\$0
				\$0
				\$0
				\$0
		<b>Totals:</b>	<b>551</b>	<b>\$5,658,955</b>