

Board of County Commissioners

**After-the-Fact Shoreline Alteration/Dredge
and Fill Permit Application**

SADF-20-03-008

Applicants: John and Jean Amm

July 28, 2020



Location Map

4091 Conway Place Circle, Orlando



Parcel ID No.: 17-23-30-1685-01-010

4091 Conway Place Circle, Orlando



Parcel ID No.: 17-23-30-1685-01-010



Pre-Existing Conditions





Existing Conditions





Background

- Applicants installed a new seawall without authorization in early 2020.
 - Photos taken prior to installation of the seawall show erosion was occurring.
- Portion of vinyl privacy fence installed in 2018 extends below NHWE.
 - SADF permit is also needed for that portion of the wall.
- Due to installation of a weir in the 1960s, lake levels were lowered.
 - Subsequently lands below the NHWE that were previously wet became dry, including areas around the seawall and a portion of the privacy fence.
 - Division of State Lands verified that land between NHWE and shoreline where the seawall and fence are located would not be considered sovereignty submerged lands.
- Neighboring property to the north has an existing seawall and to the south is an HOA lot with boat ramp.



Site Plan

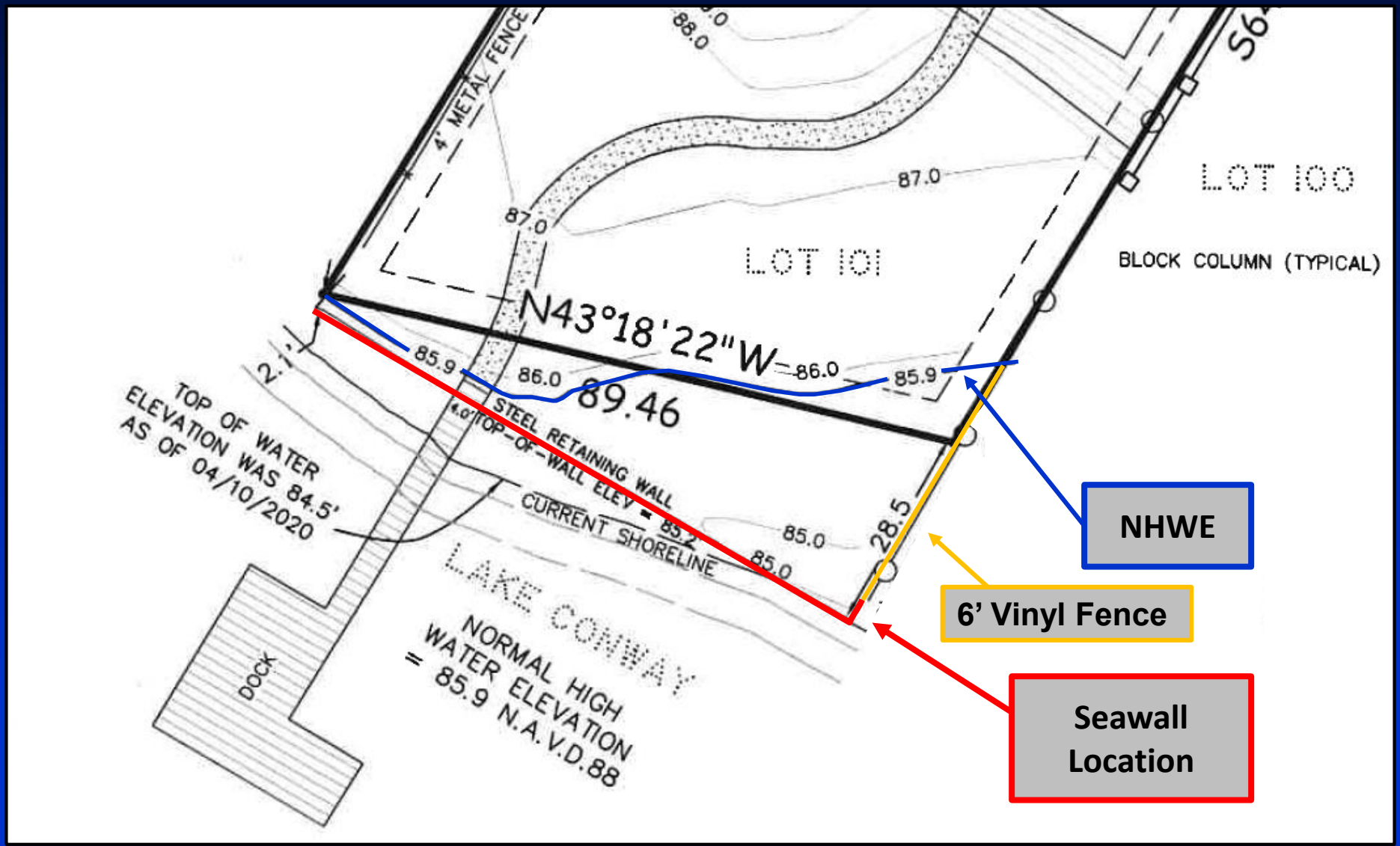



Cross-Section

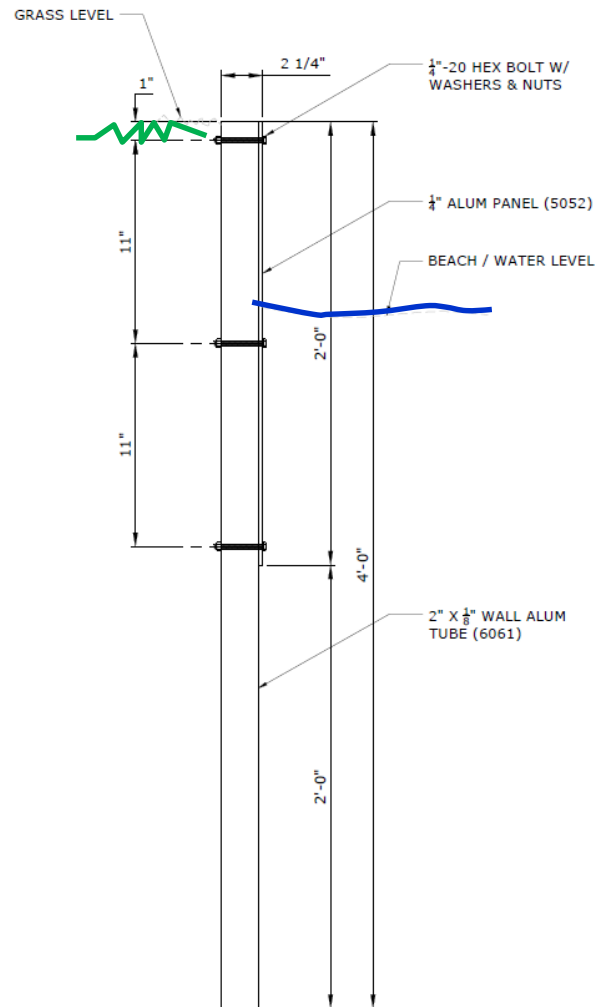



Riprap and Plantings

- Based on prior Board direction, riprap and plantings are generally required for new seawalls and replacement seawalls.
- In this case, riprap is not being requested due to:
 - The height of the wall (~12”) is only as high as the existing adjacent sod.
 - The existing wall will not redirect wave energy or adversely affect adjacent properties to the same extent a higher wall would.
 - The required minimum riprap size is 12” in diameter. The required slope to place riprap is 2:1. This would completely cover the seawall.
- Due to the abundance of the existing submerged vegetation, additional plantings are not being required. A condition has been added prohibiting the removal of native plants outside of the access corridor.



Existing Conditions





Considerations

- **Project reviewed in accordance with Chapter 33, Article II and the review criteria and conditions of issuance therein.**
- **Notification of the public hearing was sent to property owners within 500 feet of the project site. No written objections were received.**



Finding

- Pursuant to Orange County Code, Chapter 33, Article II, EPD staff has evaluated the proposed Shoreline Alteration/Dredge and Fill application and required documents and has made a finding that the request is consistent with Section 33-37.



Action Requested

- **Acceptance of the findings and recommendation of the Environmental Protection Division staff and approval of the Shoreline Alteration/Dredge and Fill Permit SADF-20-03-008 for John and Jean Amm, subject to the conditions listed in the staff report. District 3**



Shoreline Conditions

Aerial 2016



Aerial 2020





Shoreline Conditions

Aerial 2018



Aerial 2020





Existing Conditions

