

Orlando Health Central Porter Road Medical Campus PD / Orlando Health Horizon West Phase 1 PSP/DP

Case:	CDR-16-11-377
Project Name:	Orlando Health Central Porter Road Medical Campus PD / Orlando Health Horizon West Phase 1 PSP/DP
Applicant:	Selby Weeks, Klima Weeks Civil Engineering
District:	1
Acreage:	73.59 gross acres
Location:	South of Porter Road / East of County Road 545
Request:	To modify the July 19, 2016 BCC Condition of Approval #7 regarding notification of proximity of the development to the West Orange and 545 Solid Waste Disposal Facilities

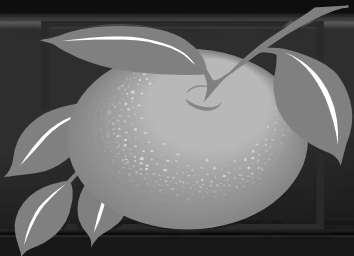

Orlando Health Central Porter Road Medical Campus PD / Orlando Health Horizon West Phase 1 PSP/DP Future Land Use Map

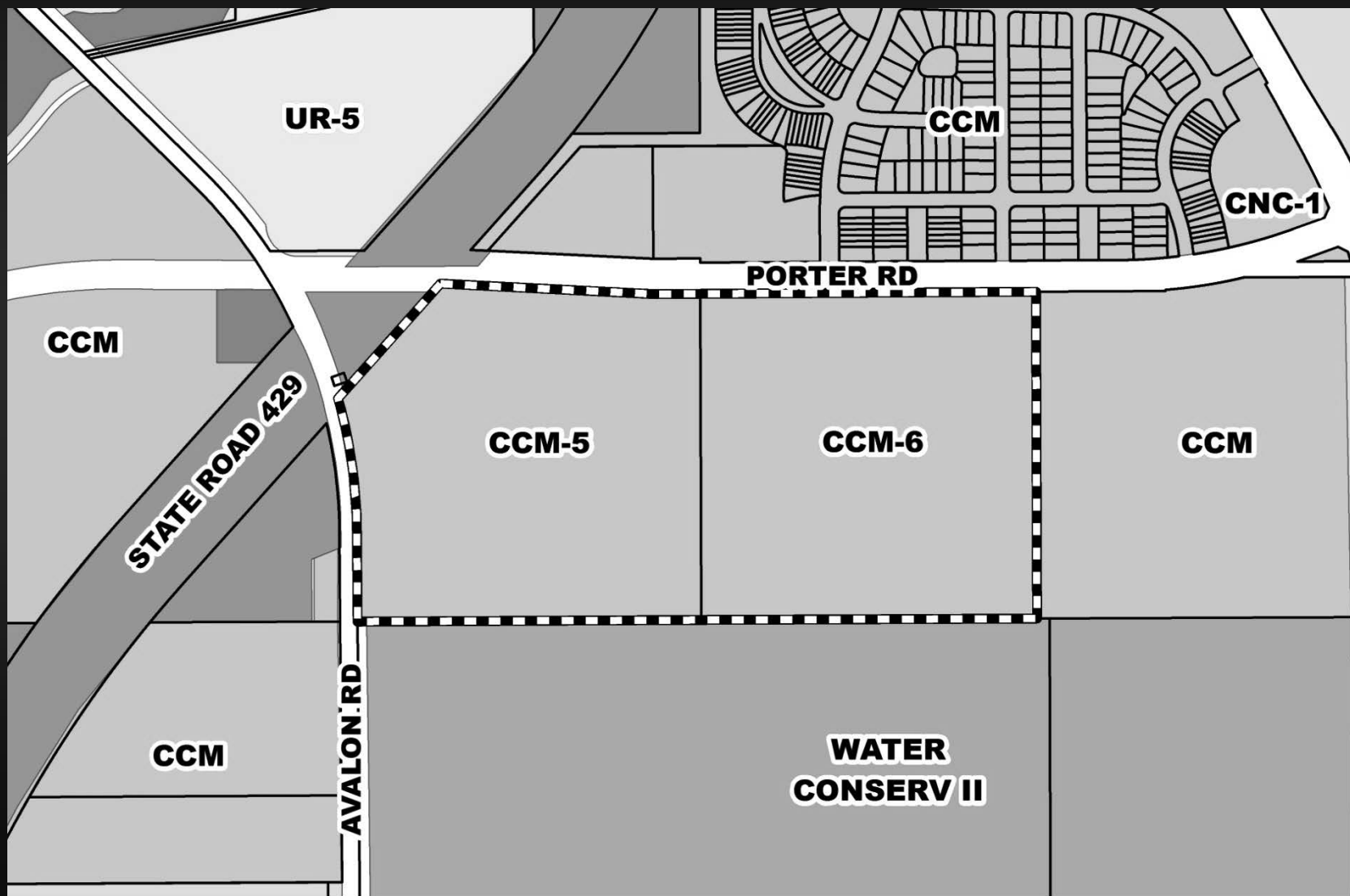

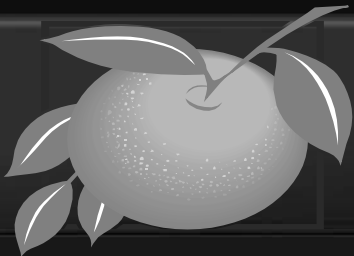

Orlando Health Central Porter Road Medical Campus PD / Orlando Health Horizon West Phase 1 PSP/DP Zoning Map

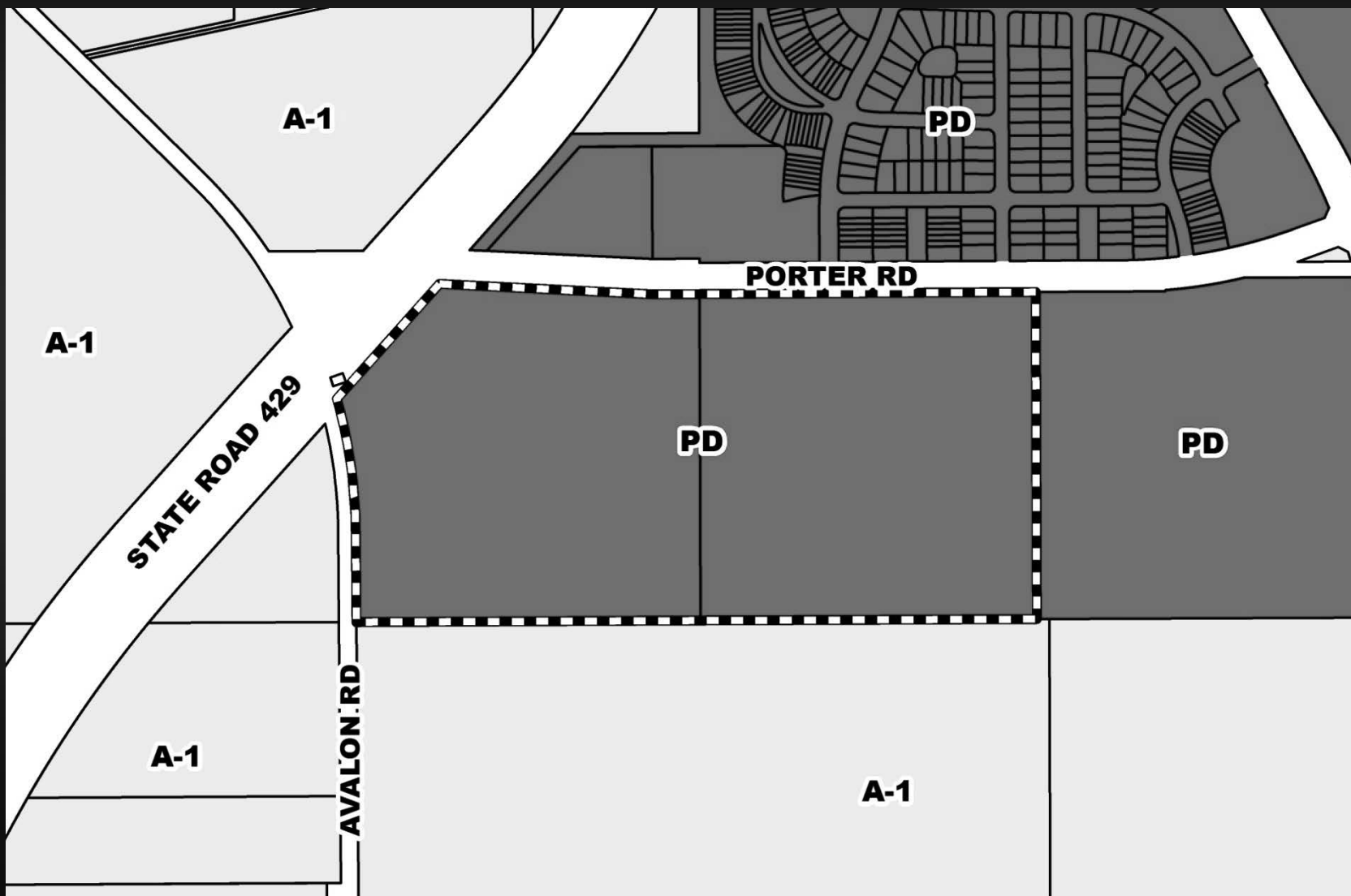

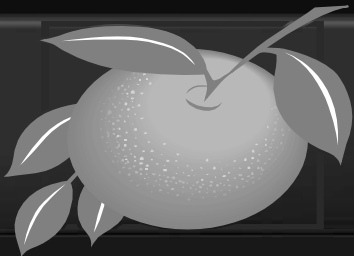

Orlando Health Central Porter Road Medical Campus PD / Orlando Health Horizon West Phase 1 PSP/DP Aerial Map



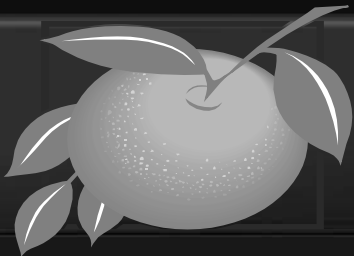

Orlando Health Central Porter Road Medical Campus PD / Orlando Health Horizon West Phase 1 PSP/DP

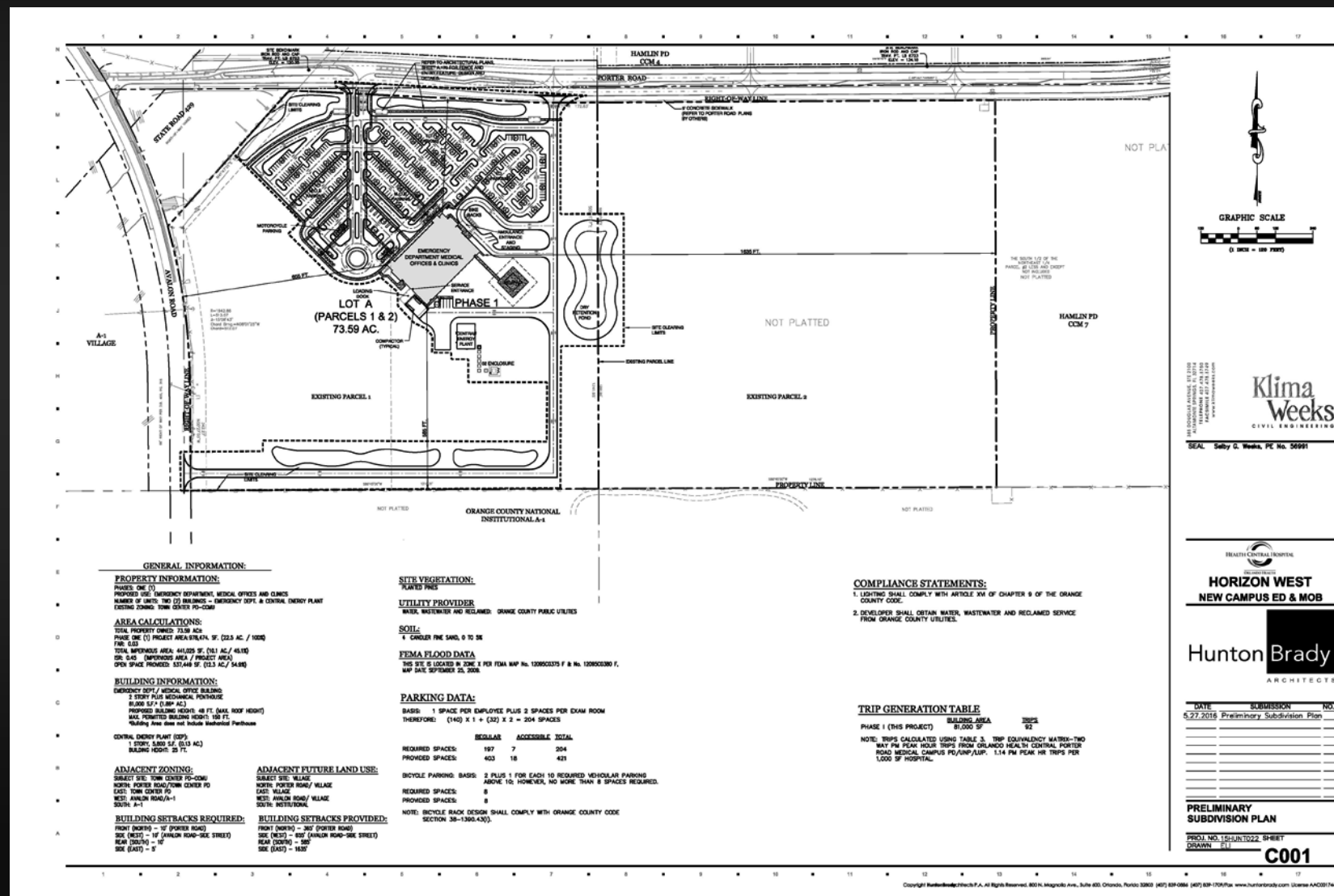

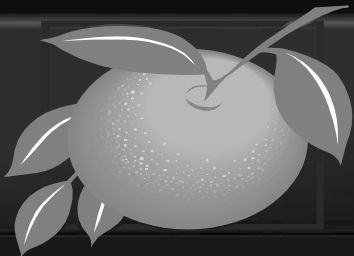

Action Requested

Make a finding of consistency with the Comprehensive Plan (CP) and approve the Orlando Health Central Porter Road Medical Campus PD / Orlando Health Horizon West Phase 1 Preliminary Subdivision Plan / Development Plan (PSP/DP) dated “Received May 31, 2016”, subject to the conditions listed under the DRC Recommendation in the Staff Report.

District 1