



Interoffice Memorandum

05-04-17A07:59 RCVD

05-04-17A08:06 RCVD

04-19-17P04:14 RCVD

DATE: April 18, 2017

TO: Katie A. Smith, Deputy Clerk of the
Board of County Commissioners,
County Comptroller's Office

THROUGH: Cheryl Gillespie, Supervisor,
Agenda Development Office

FROM: Sapho F. Vatel, Development Coordinator 
Planning Division

CONTACT PERSON(S): Sapho F. Vatel
Development Coordinator
Planning Division 407-836-5686
Sapho.Vatel@ocfl.net

SUBJECT: Request for Board of County Commissioners
Public Hearing

Project Name: Royal Estates PD/ Parcel 1 PSP
Case # PSP-16-09-337

Type of Hearing: Preliminary Subdivision Plan

Applicant(s): Momtaz Barq – Terra-Max Engineering, Inc.
1507 S Hiawassee Road Suite 211
Orlando, Florida 32835

Commission District: 1

General Location: North of Reams Road / West of Taborfield
Avenue

Parcel ID #(s): 01-24-27-0000-00-006

of Posters: 1

Use: 35 Single-Family Attached Residential Dwelling
Units

LEGISLATIVE FILE #

17-621

June 20, 2017
@ 2pm

Size / Acreage: 6.55

BCC Public Hearing
Required by: Sections 34-69 and 30-89 Orange County Code

Clerk's Advertising
Requirements: (1) At least 7 days before the BCC public hearing date, publish an advertisement in the Legal Notices section of *The Orlando Sentinel* describing the particular request, the general location of the subject property, and the date, time, and place when the BCC public hearing will be held;

and

(2) At least 7 days before the BCC public hearing date, send notices of BCC public hearing by U.S. mail to owners of property within 300 feet of the subject property and beyond.

Spanish Contact Person: Para más información referente a esta vista pública, favor de comunicarse con la División de Planificación (Planning Division) al número 407-836-8181.

Advertising Language:

This Preliminary Subdivision Plan (PSP) is a request to subdivide 6.55 acres in order to construct 35 single family attached residential dwelling units; District 1; North of Reams Road / West of Taborfield Avenue.

Material Provided:

- (1) Names and last known addresses of property owners (*via email from Fiscal and Operational Support Division*);
- (2) Location map (*to be mailed to property owners*);
- (3) Site plan sheet (*to be mailed to property owners*)

SPECIAL INSTRUCTIONS TO CLERK (IF ANY):

Unless stated otherwise, the public hearing should be advertised to begin at 2:00 p.m., or as soon thereafter as the matter may be heard.

Please notify Lisette Egipciaco and Sapho Vatel of the scheduled date and time.
The Planning Division will notify the applicant.

Attachments (location map and site plan sheet)

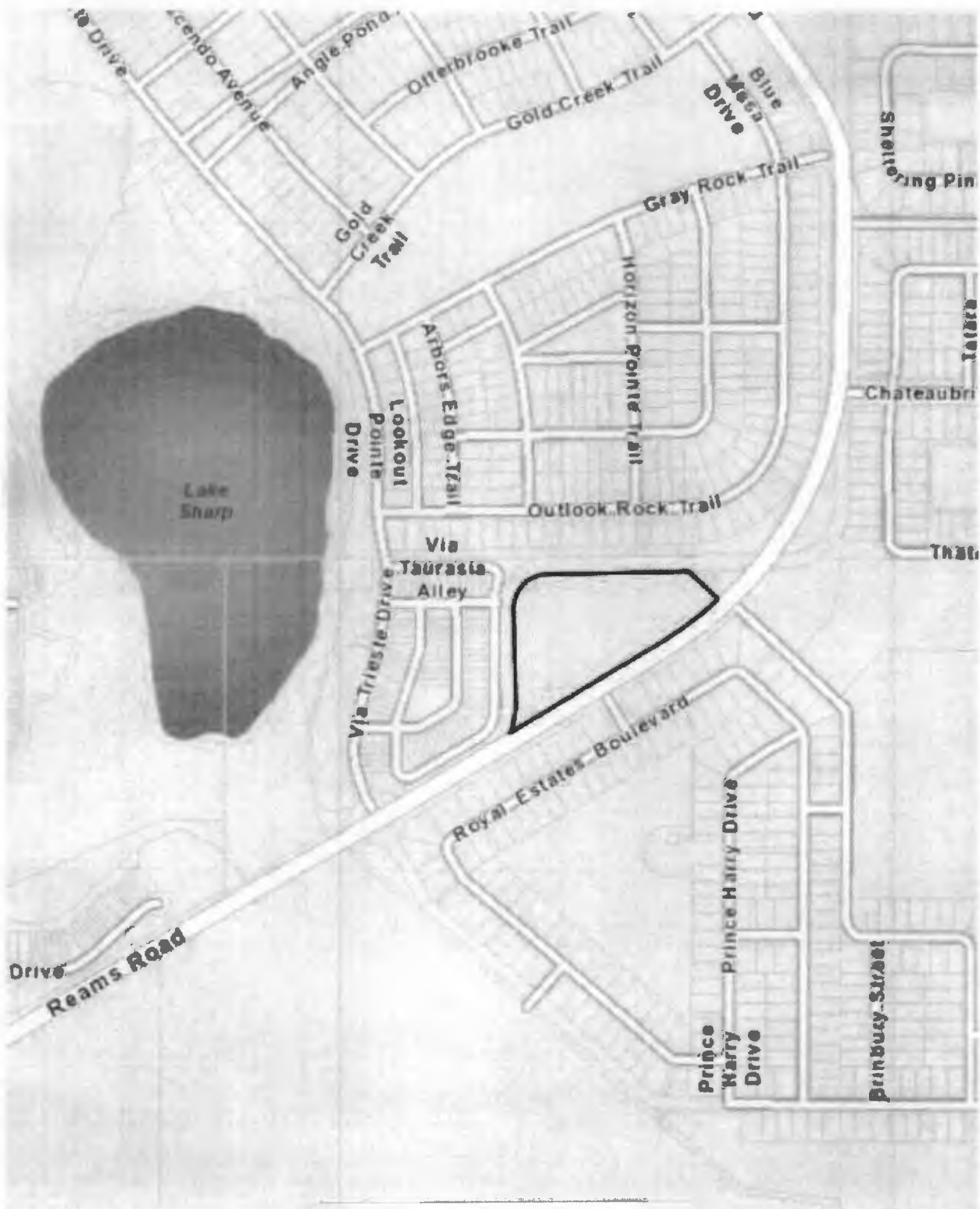

For questions regarding this
map, please call Sapho Vatel at
407.836.5686

