



## Interoffice Memorandum

03-01-18P03:37 RCVD

A handwritten signature or initials in the top right corner of the document.

**DATE:** March 1, 2018

**TO:** Katie A. Smith, Deputy Clerk of the  
Board of County Commissioners,  
County Comptroller's Office

**THROUGH:** Cheryl Gillespie, Supervisor,  
Agenda Development Office

**FROM:** Alberto A. Vargas, MArch., Manager,  
Planning Division

**CONTACT PERSON:** John Smogor, Planning Administrator  
Planning Division 407-836-5616 and  
[john.smogor@ocfl.net](mailto:john.smogor@ocfl.net)

**SUBJECT:** Request for Board of County Commissioners  
(BCC) Public Hearing

---

**Project Name:** Waterleigh Planned Development / Land Use Plan  
(PD / LUP) – Case # CDR-17-05-160

**Type of Hearing:** Substantial Change

**Applicant:** Adam Smith, VHB, Inc.

**Commission District:** 1

**General Location:** North Flamingo Crossings Boulevard and east of  
Avalon Road.

**BCC Public Hearing  
Required by:** Orange County Code, Chapter 30, Article III,  
Section 30-89 and Orange County Code, Chapter  
38, Article VIII, Division 1, Section 38-1207

LEGISLATIVE FILE #

18-324

 April 10, 2018  
 @ 2 pm

**Clerk's Advertising  
Requirements:**

(1) At least 15 days before the BCC public hearing date, publish an advertisement in the Legal Notices section of *The Orlando Sentinel* describing the particular request, the general location of the subject property, and the date, time, and place when the BCC public hearing will be held;

and

(2) At least 10 days before the BCC public hearing date, send notices of BCC public hearing by U.S. mail to owners of property within 300 feet of the subject property and beyond.

**Spanish Contact Person:**

IF YOU HAVE ANY QUESTIONS REGARDING THIS NOTICE, CONTACT THE ORANGE COUNTY PLANNING DIVISION: Front Desk, 407-836-8181

PARA MÁS INFORMACIÓN, REFERENTE A ESTA VISTA PUBLICA CON RESPECTO A UNA AUDENCIA PUBLICA SOBRE PROPIEDAD EN SU AREA/VECINDAD, FAVOR COMUNICARSE CON LA DIVISIÓN DE PLANIFICACION, AL NUMERO, 407-836-8181

**Advertising Language:**

A PD substantial change to move the Adequate Public Facilities (APF) Utility Tract from the Springhill PD and place the 4.5 acre tract in PD Parcel 10. This request is associated with a change to the Waterleigh APF Agreement.

**Material Provided:**

(1) Names and last known addresses of property owners within 300 feet and beyond (*via email from Fiscal and Operational Support Division*); and

(2) Location map (*to be mailed to property owners*).

**Special instructions to the Clerk:**

Please place this request on the next available BCC agenda. Unless stated otherwise, the public hearing should be advertised to begin at 2:00 p.m., or as soon thereafter as the matter may be heard.

Attachment (location map)

c: Chris R. Testerman, AICP, Assistant County Administrator  
Jon V. Weiss, Director, Community Environmental Development Services  
Department

## Location Map

CDR-17-05-160

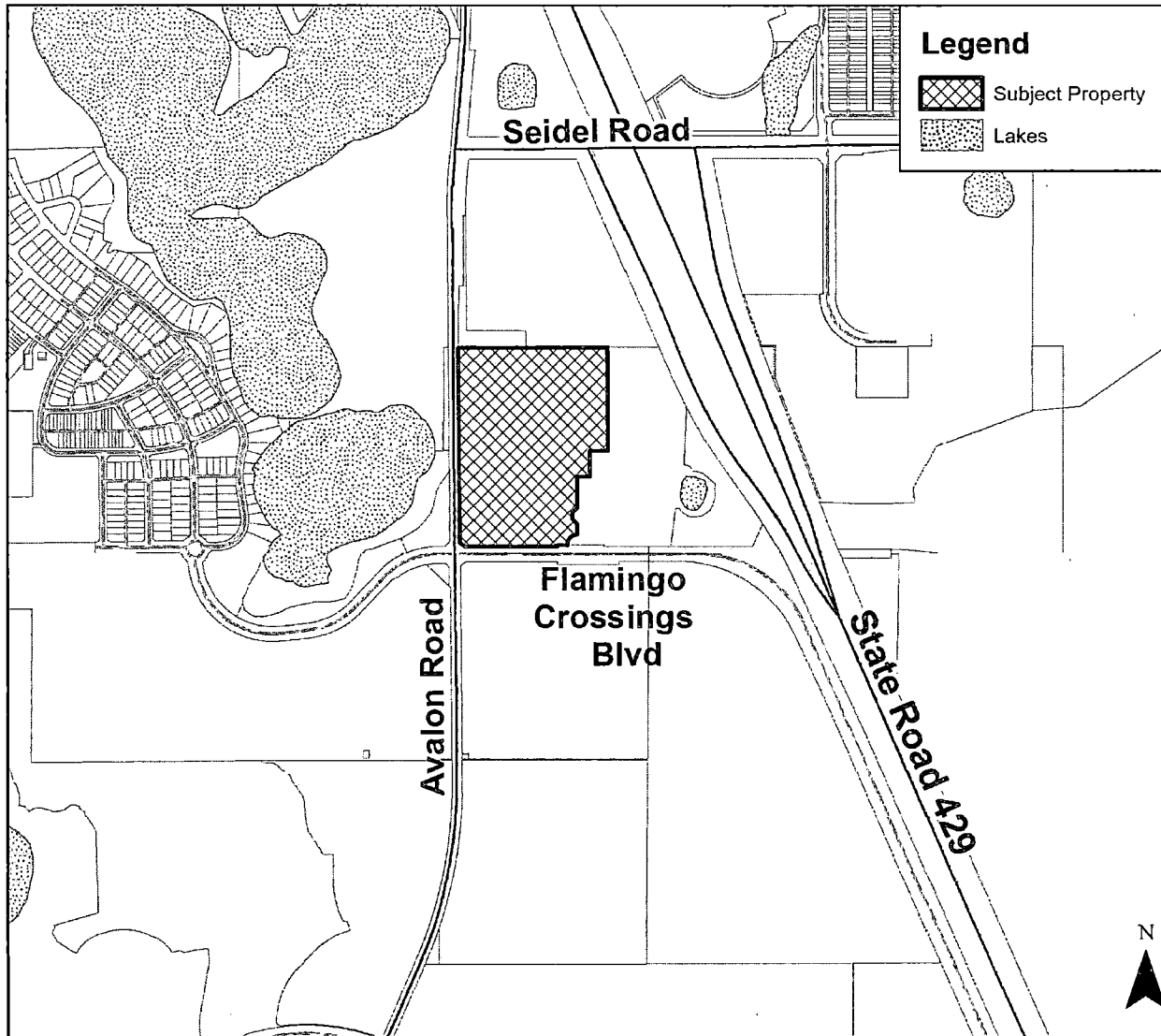

If you have any questions  
regarding this map, please call  
John Smogor at 407-836-5616.

## Legal Description

**CDR-17-05-160**

THE SE1/4 OF NW1/4 OF SEC 08-24-27 EAST OF AVALON RD AKA CR 545 & NORTH OF FLAMINGO CROSSINGS BLVD & (LESS PT DESC AS COMM AT THE N 1/4 CORNER OF SEC 8-24-27 TH ALONG W LINE OF THE NE 1/4 S0-22-50W 1326.1 FT TO THE NW CORNER OF THE SW 1/4 OF THE NE 1/4 & THE POB TH ALONG THE N LINE OF THE SW 1/4 OF THE NE 1/4 N89-51-56E 56.7 FT TO THE WLY R/W OF ST RD 429 TH ALONG SAID WLY R/W THE FOLLOWING COURSES S23-38-23E 228.01 FT TO PT OF CURV CONCAV NELY HAV RAD OF 2952 FT & CENTRAL ANGLE OF 3-50-38 & CHORD BEARING OF S25-33-42E TH SELY ALONG SAID CURV 198.05 FT TH DEPARTING SAID WLY R/W S2-36-59W 368.5 FT TH S78-13-54E 40.47 FT TH S31-14-50E 36.37 FT TH S82-18-15E 28.13 FT TH S74-7-46E 44.54 FT TH S47-24-47E 50.35 FT TH S49-9-32E 50.17 FT TH S8-8-57W 32.8 FT TH S1-23-16E 55.09 FT TH S17-17-6W 46.76 FT TH S30-27-55W 41.55 FT TH S54-47-20W 54.64 FT TH S76-20-18W 40.02 FT TH S87-36-34W 44.76 FT TH N57-46-59W 54.61 FT TH N39-0-33W 35.76 FT TH S89-10-37W 25.1 FT TH S6-26-35W 245.41 FT TO THE N R/W OF FLAMINGO CROSSINGS BLVD TH ALONG SAID N R/W THE FOLLOWING COURSES S89-53-49W 429.01 FT TH N0-6-11W 11 FT TH S89-53-49W 231.79 FT TH DEPARTING SAID R/W ON NON-TANG CURV CONCAV SELY HAV RAD OF 66.78 FT & CENTRAL ANGLE OF 86-48-14 & CHORD BEARING OF N42-10-34E TH NELY ALONG SAID CURV 101.17 FT TH N0-6-18W 67.72 FT TH N44-19-28W 44.67 FT TH N0-6-18W 39 FT TH N47-48-25E 44.67 FT TH N0-6-18W 198.58 FT TH N89-53-42E 82 FT TH N0-6-18W 163.02 FT TH N89-53-42E 115.89 FT TH N0-6-18W 666.21 FT TO PT ON THE N LINE OF THE SE 1/4 OF THE NW 1/4 TH ALONG SAID N LINE N89-45-26E 268.41 FT TO POB)