

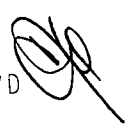

Interoffice Memorandum

04-02-18A11:10 RCVD 

March 28, 2018

04-02-18A11:23 RCVD

TO: Katie Smith, Manager
Comptroller Clerk's Office

THROUGH: Cheryl Gillespie, Agenda Development Supervisor
Agenda Development

FROM: David D. Jones, P.E., CEP, Manager
Environmental Protection Division
(407) 836-1405 

STAFF PERSON: **Elizabeth R. Johnson, CEP, Assistant Manager
Environmental Protection Division
(407) 836-1511**

SUBJECT: Request for Public Hearing on May 8, 2018, at 2:00 p.m., for a Shoreline Alteration/Dredge and Fill Permit Application (SADF-18-02-003) located at 2200 Woodlawn Drive, on Lake Sue, Parcel ID No. 18-22-30-0000-00-020

Applicant: David Hilleren and Tracy Wagner-Hilleren.

Type of Hearing: Shoreline Alteration/Dredge and Fill Permit Application to re-construct an existing seawall and add rip rap.

Hearing required by
Florida Statute # or Code: Chapter 15, Article VI. Pumping and Dredging Control; Section 15-218(d).

Advertising requirements: Publish once in a newspaper of general circulation in Orange County at least seven (7) days prior to public hearing.

Advertising timeframes: At least (7) seven days prior to public hearing.

Abutters to be notified: The applicant and the property owners within 500 feet of the project area will be notified at least seven (7) days prior to public hearing by the Environmental Protection Division (EPD).

Lake Advisory Board
to be notified: N/A.

LEGISLATIVE FILE #

18-409

May 8, 2018
@ 2pm

March 28, 2018

Request for Public Hearing—Shoreline Alteration/Dredge and Fill Permit Application for David Hilleren and Tracy Wagner-Hilleren (SADF-18-02-003)

Page 2

Municipality or other

Public Agency to be

notified: Florida Department of Environmental Protection – DEP_CD@dep.state.fl.us

Estimated time required

For public hearing: 2 minutes.

Hearing Controversial: No.

District #: 5.

Materials being submitted as backup for public hearing request:

1. Location Map
2. Site Plans

Special Instructions to Clerk:

1. Once the Board of County Commissioners makes a decision on the Shoreline Alteration/Dredge and Fill Permit Application, please submit the decision letter to Michelle Gonzalez of EPD. EPD will issue the decision to the applicant.

Advertising Language:

2. David Hilleren and Tracy Wagner-Hilleren, Parcel ID: 18-22-30-0000-00-020, Request to reconstruct an existing seawall and add rip rap on Lake Sue, pursuant to Chapter 15, Article VI. Pumping and Dredging Control; Section 15-218(d). District 5. Legal Description on file at EPD.

JS/NT/ERJ/DJ: mg

Attachments

c: Chris Testerman, Assistant County Administrator
Jon V. Weiss, P.E., Director, Community, Environmental and Development Services
Joel D. Prinsell, Deputy County Attorney

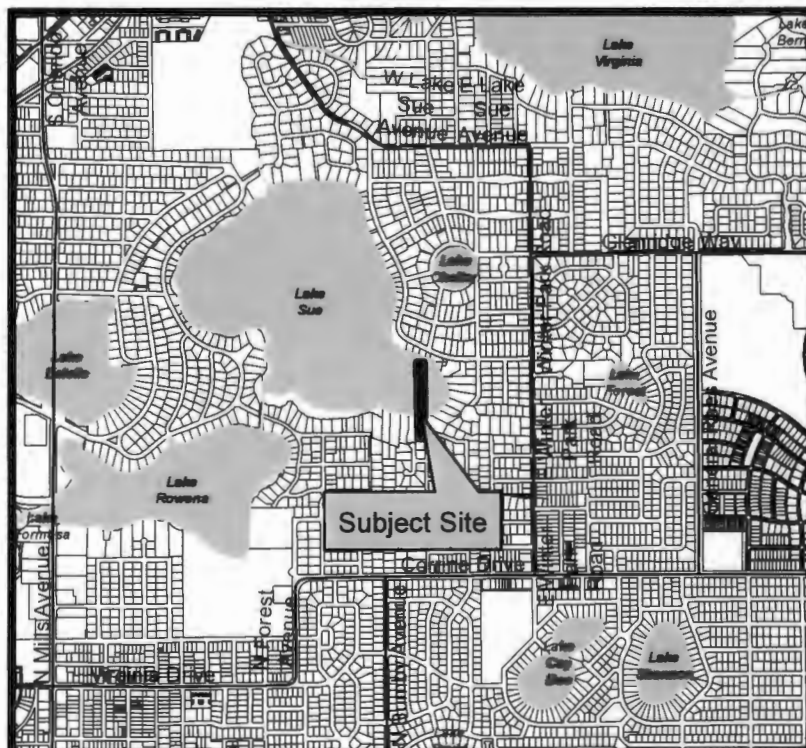

GENERAL REQUIREMENTS

REPRODUCTIONS OF CONTRACT DRAWINGS BY CONTRACTOR IN LIEU OF PREPARATION OF SHOP DRAWINGS SIGNIFIES ACCEPTANCE OF INFORMATION SHOWN AS CORRECT AND OBLIGATES HIMSELF TO ANY EXPENSE, REAL OR IMPLIED, ARISING FROM THEIR USE. A CHANGE TO THE STRUCTURAL DRAWINGS DUE TO THE ACCEPTANCE OF ALTERNATES AND/OR SUBSTITUTES IS THE RESPONSIBILITY OF THE CONTRACTOR AND MUST BE SUBMITTED TO THE ENGINEER FOR APPROVAL. THE GENERAL CONTRACTOR AND EACH SUBCONTRACTOR SHALL VERIFY ALL EXISTING CONDITIONS PRIOR TO START OF ANY WORK. ALL INCONSISTENCIES SHALL BE REPORTED TO THE DESIGNER AND/OR STRUCTURAL ENGINEER, IF NEEDED, SHOULD CONTRACTOR CONSTRUCT THE PREMISES IN A FASHION NOT CONSISTENT WITH THE PLANS PREPARED BY THE DESIGNER AND/OR STRUCTURAL ENGINEER. THEN DESIGNER AND/OR STRUCTURAL ENGINEER SHALL BEAR NO RESPONSIBILITY OR LIABILITY FOR THE CONSTRUCTION OF PREMISES AND ACCURACY OF THE DRAWINGS.

DESIGN CODES

FLORIDA BUILDING CODE 2017
THE ALUMINUM ASSOCIATION, LATEST EDITION
ASCE 7-10

GALVANIZED BOLTS

ALL BOLTS SHALL BE GALVANIZED TO BE ASTM A572
GRADE 50 THREADED ROUND STOCK WITH A MINIMUM
YIELD STRESS OF 50,000 PSI

DESIGN LOADS

PURSUANT TO CHAPTER 1609 LL (TABLE 1607; WL-SECTION 1609)
ULTIMATE WIND: 140 MPH AT 3 SECOND GUST (30 PSF MINIMUM)
RISK CATEGORY II (TABLE 1604.5)
EXPOSURE CATEGORY "D" (FBC 1609.4.3 AND ASCE 7-10, SECTION 26.7.2)
DECK LIVE LOAD: 60 PSF
DEAD LOAD: 10 PSF
ROOF LIVE LOAD: 20 PSF
GUARDRAILS AND HANDRAILS: 200 PSF
GUARDRAIL IN-FILL COMPONENTS: 50 PSF
COMPONENTS AND CLADDING, DESIGN WIND PRESSURES: +38PSF/-38PSF

GENERAL NOTES

1. DETAILS SHOWN ON PLANS MAY BE FOR TYPICAL CONDITIONS. FOR CONDITIONS NOT SHOWN, PROVIDE DETAILS OF A SIMILAR NATURE.
2. DIMENSIONS SHOWN ON THESE PLANS SHALL BE VERIFIED BY THE CONTRACTOR OR BUILDER PRIOR TO CONSTRUCTION. THESE PLANS MAY NOT BE DRAWN TO SCALE. SCALING OF DRAWINGS IS STRONGLY DISCOURAGED. DIMENSIONED DRAWINGS TAKE PRECEDENT OVER SCALED. IF CONFLICTS EXIST IN THE DRAWINGS, THE MORE STRINGENT SHALL PREVAIL.
3. THE CONTRACTOR SHALL COORDINATE ALL NEW WORK WITH EXISTING CONDITION AND SHALL REPORT ANY DISCREPANCIES TO THE ENGINEER AND OWNER.
4. OBTAIN APPROVAL FROM THE ENGINEER PRIOR TO ALL STRUCTURAL CHANGES.
5. CONTRACTOR IS RESPONSIBLE FOR ALL CONSTRUCTION PRACTICES, INCLUDING TECHNIQUES, PROCEDURES, SHORING AND THE SEQUENCE OF CONSTRUCTION. CONTRACTOR SHOULD NOTIFY ENGINEER IF A CONFLICT ARISES DUE TO VARIATIONS OR OTHER PROBLEMS WITH THE CONSTRUCTION DOCUMENTS.
6. SURVEY AND WETLAND INFORMATION IS PROVIDED TO ENGINEER AND IS PORTRAYED FOR CONCEPTUAL LOCATION ONLY. DISPLAY DOES NOT CONSTITUTE REVIEW ACCEPTANCE OR ENDORSEMENT OF INFORMATION CONTAINED THEREIN. (BASED ON PROPERTY SURVEY BY OTHERS)

APPLICABLE CODES AND STANDARDS

CONSTRUCTION SHALL CONFORM TO THE REQUIREMENTS OF THESE STRUCTURAL SPECIFICATIONS AND THE REQUIREMENTS CONTAINED IN THE FOLLOWING CODES AND STANDARDS. WHEN A DIFFERENCE EXIST BETWEEN THESE SPECIFICATIONS AND ANY OTHER GOVERNING CODE, THE MORE STRINGENT SHALL CONTROL. ANY OTHER ITEMS NOT COVERED THEREIN SHALL BE CONSENSUATE WITH SOUND ENGINEERING AND STANDARD CONSTRUCTION PRACTICES.

2017 FLORIDA BUILDING CODE
AISC MANUAL OF STEEL CONSTRUCTION
AMERICAN CONCRETE INSTITUTE (ACI 318-02)
AMERICAN WOOD COUNCIL - NATIONAL DESIGN SPECIFICATIONS FOR WOOD CONSTRUCTION 1997 EDITION
AMERICAN SOCIETY OF CIVIL ENGINEERS (ASCE 7-02) MINIMUM DESIGN LOADS FOR BUILDINGS AND OTHER STRUCTURES.

DECK LIVE LOAD 100 PSF
WIND SPEED 139 MPH
EXPOSURE "D"
OPEN STRUCTURE WITH A ZERO PRESSURE COEFFICIENT

DESIGN STANDARDS

THE FOLLOWING ARE GENERAL DESIGN STANDARDS. MORE STRINGENT DESIGN STANDARDS MAY BE NOTED ON THE PLANS.

GENERAL REQUIREMENTS:

REPRODUCTIONS OF CONTRACT DRAWINGS BY CONTRACTOR IN LIEU OF PREPARATION OF SHOP DRAWINGS SIGNIFIES ACCEPTANCE OF INFORMATION SHOWN AS CORRECT AND OBLIGATES HIMSELF TO ANY EXPENSE, REAL OR IMPLIED, ARISING FROM THEIR USE. A CHANGE TO THE STRUCTURAL DRAWINGS DUE TO ACCEPTANCE OF ALTERNATES AND/OR SUBSTITUTES IS THE REAL RESPONSIBILITY OF THE CONTRACTOR AND MUST BE SUBMITTED TO THE ENGINEER FOR APPROVAL. THE GENERAL CONTRACTOR AND EACH SUBCONTRACTOR SHALL VERIFY ALL EXISTING CONDITIONS PRIOR TO THE START OF ANY WORK. ALL INCONSISTENCIES SHALL BE REPORTED TO THE DESIGNER AND/OR STRUCTURAL ENGINEER, IF NEEDED, SHOULD CONTRACTOR CONSTRUCTS THE PREMISES IN A FASHION NOT CONSISTENT WITH THE PLANS PREPARED BY THE DESIGNER AND/OR STRUCTURAL ENGINEER. THEN DESIGNER AND/OR STRUCTURAL ENGINEER SHALL BEAR NO RESPONSIBILITY OR LIABILITY FOR THE CONSTRUCTION OF PREMISES AND ACCURACY OF THE DRAWINGS.

DESIGN CODE:

FLORIDA BUILDING CODE 2017
THE ALUMINUM ASSOCIATION, LATEST EDITION
ASCE 7-10

GALVANIZED BOLTS:

ALL BOLTS SHALL BE GALVANIZED, BE ASTM
A572, GRADE 50 THREADED ROUND STOCK WITH
A MINIMUM YIELD STRESS OF 50,000 PSI.

TIMBER:

DESIGN IN ACCORDANCE WITH THE NATIONAL DESIGN SPECIFICATION FOR WOOD CONSTRUCTION, WITH LOADING IN ACCORDANCE WITH THE FLORIDA BUILDING CODE. ALL GRADED STRUCTURAL LUMBER SHALL BE PRESSURE TREATED AND MEET THE FOLLOWING MINIMUM REQUIREMENTS:

MINIMUM BENDING STRESS = 1250 PSI (NO. 1 DENSE SO. PINE)
YOUNG MODULES = 1600 KSI
MAXIMUM OF 15% MOISTURE CONTENT
CONTRACTOR MAY USE SOUTHERN YELLOW PINE NO. 2 OR U.O.N.

LUMBER SIZES SHOWN ARE NOMINAL SIZES. LUMBER SHALL BE FURNISHED IN FINISHED SIZES MEETING THE REQUIREMENTS OF THE AMERICAN SOFTWOOD LUMBER STANDARD.

STRUCTURAL ALUMINUM:

CONFIRM TO LATEST EDITION OF ALUMINUM
ASSOCIATION OF FLORIDA STANDARD PRACTICE FOR
ALUMINUM DESIGN.
ALL ALUMINUM SHALL BE 6061-T6 (E=10,000 KSI;
F_y = 35 KSI).

CONCRETE:

CONFORM TO ACI 318, LATEST EDITION AND ACI 301
COMPRESSIVE ULTIMATE STRENGTH (MINIMUM AT
28 DAYS) SHALL BE 3,000 PSI
EXPOSED CHAMFER EDGES SHALL BE 3/4".

REINFORCING STEEL:

CONFORM TO ACI 318 AND 315, LATEST EDITION
ALL REINFORCEMENT STEEL SHALL BE ASTM A615
GRADE 60, MIN. FOOTING COVER 3"
SMOOTH DOWELS & TIES SHALL BE ASTM A185

DESIGN LOADS:

PURSUANT TO CHAPTER 1609 LL (TABLE 1607; WL-SECTION 1609)
ULTIMATE WIND: 140 MPH AT 3 SECOND GUST 930 PSF MINIMUM
RISK CATEGORY II (TABLE 1604.5)
EXPOSURE CATEGORY: "D" (FBC 1609.4.3 & ASCE 7-10, SECTION 26.7.2)
DECK LIVE LOAD: 60 PSF DEAD LOAD: 10 PSF
ROOF LIVE LOAD: 20 PSF GUARDRAILS AND HANDRAILS: 200 PSF
GUARDRAIL IN FILL COMPONENTS: 50 PSF STAIRS 40 PSF HCI
COMPONENTS AND CLADDING, DESIGN WIND PRESSURES +38 PSF/-38 PSF

STRUCTURAL STEEL:

CONFORM TO LATEST EDITION OF AISC "SPECIFICATION FOR STRUCTURAL STEEL BUILDING" AND AISC "CODE OF STANDARD PRACTICES FOR STEEL BUILDINGS AND BRIDGES".
ALL STRUCTURAL STEEL SHALL BE ASTM A36 (E=29,000 KSI; F_y = 36 KSI)
SPlicing PROHIBITED WITHOUT PRIOR APPROVAL AS TO LOCATION AND TYPE.
BURNING OF HOLES IN STEEL MEMBERS IS PROHIBITED. ANY MEMBER WITH BURNED HOLES MUST BE REPLACED.

WELDING:

CONFORMED TO "CODE FOR WELDING IN BUILDING CONSTRUCTION" BY THE AMERICAN WELDING SOCIETY, LATEST EDITION.
STEEL WELD IAW AWS D1.1 (LATEST EDITION) - E70XX ELECTRODES
ALUMINUM WELD IAW AWS D1.2 (LATEST EDITION) - FILLER ALLOY 5356 OR EQUAL.
CONNECTION WELDS TO BE SIZED FOR FORCES AND REACTIONS INDICATED.
ALL STEEL WELDS SHALL BE E70XX LOW HYDROGEN, 250 DEGREES MIN.
WELDS SHALL BE FULL PENETRATION WELDS AT ALL POINTS OF CONTACT.

FENDER MARINE CONSTRUCTION
1201 W. JACKSON ST.
ORLANDO, FLORIDA 32805
407-481-2750



JENNIFER A. TELIGA, P.E.
P.E. NO. 64621
11534 BRIAR HOLLOW LANE
CLERMONT, FL 34711

HILLEREN
SEAWALL
NOTES

SCALE: NT S
SHEET: 1



Digitally signed
by Jennifer
Teliga
Date: 2018.03.27
10:44:53 -04'00'

RECEIVED

MAR 27 2018

BY: EPD

Updated November 1, 2014

SG-325

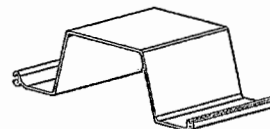

Allowable Moment (M)	2,960 ft-lb/ft	13.17 kN-m/m
Section Modulus (Z)	11.1 in ³ /ft	597 cm ³ /m
Moment of Inertia (I)	39 in ⁴ /ft	5,326 cm ⁴ /m
Impact Strength	13,750 in-lbs/in ²	2,406 N-mm/mm ²
Thickness (t)	0.250 in	6.4 mm
Section Depth	7.0 in	178 mm
Section Width	24 in	610 mm
Material	Weatherable Rigid Vinyl	
Standard Colors	Grey, Clay	
Technology	Box Profile, I-Beam Lock, XCR™	
Standard Packaging	20 sheets/bundle	

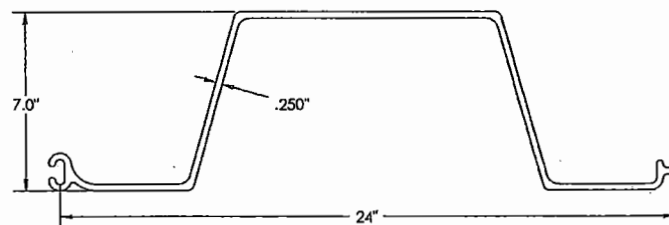
[illegible]

cmilc.com



Digitally signed
by Jennifer
Teliga
Date:
2018.03.27
10:46:37 -04'00'

FENDER MARINE CONSTRUCTION
1201 W. JACKSON ST.
ORLANDO, FLORIDA 32805
407-481-2750

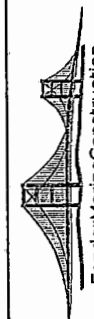

JENNIFER R. TELIGA, P.E.
P.E. NO. 64621
111534 BRIAR HOLLOW LANE
CLERMONT, FL 34711

HILLEREN
SEAWALL

SCALE: 1" = 10' 0"

SHEET: 5

RECEIVED

MAR 27 2018

BY: EPD

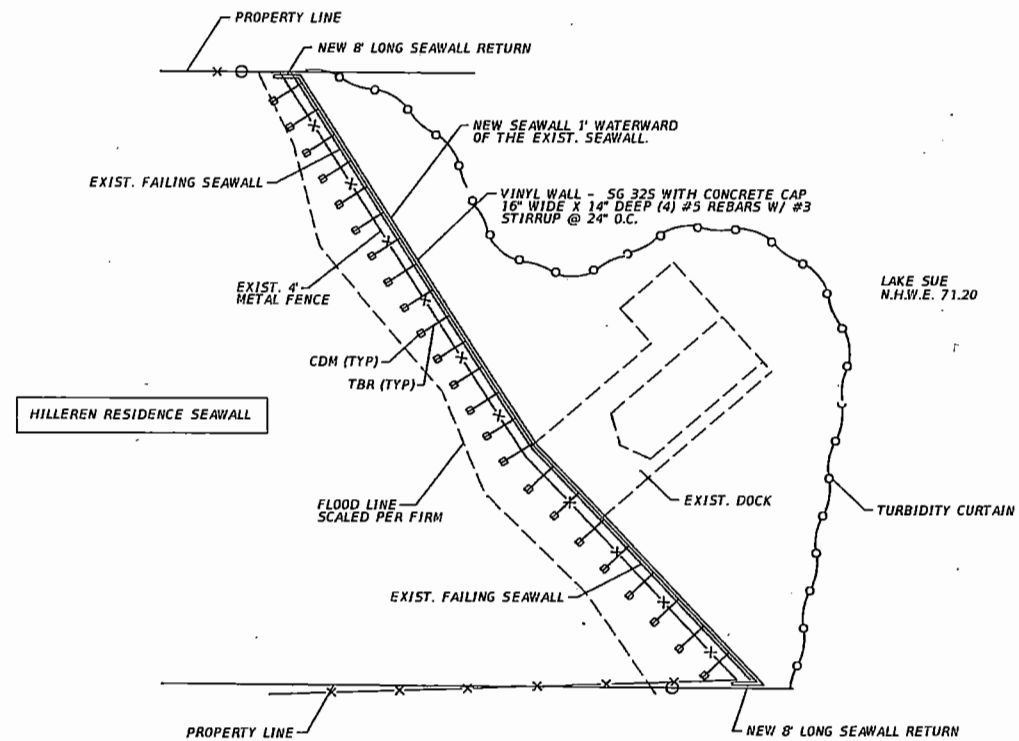

SITE PLAN

NOTES:
 CDM - CONCRETE DEADMAN
 Z X Z X Z
 TBR - TIEBACK ROD @ 10' O.C. MAX.
 #5 REBAR



Digitally signed by
 Jennifer Teliga
 Date: 2018.03.27
 10:44:10 -04'00'

RECEIVED
 MAR 27 2018
 BY: EPD

FENDER MARINE CONSTRUCTION
 1201 W. JACKSON ST.
 ORLANDO, FLORIDA 32805
 407-481-2750



JENNIFER R. TELIGA, P.E.
 P.E. NO. 64621
 11534 BRIAR HOLLOW LANE
 CLERMONT, FL 34711

HILLEREN SEAWALL	
PLAN VIEW	
SCALE:	1"=20'
SHEET:	3

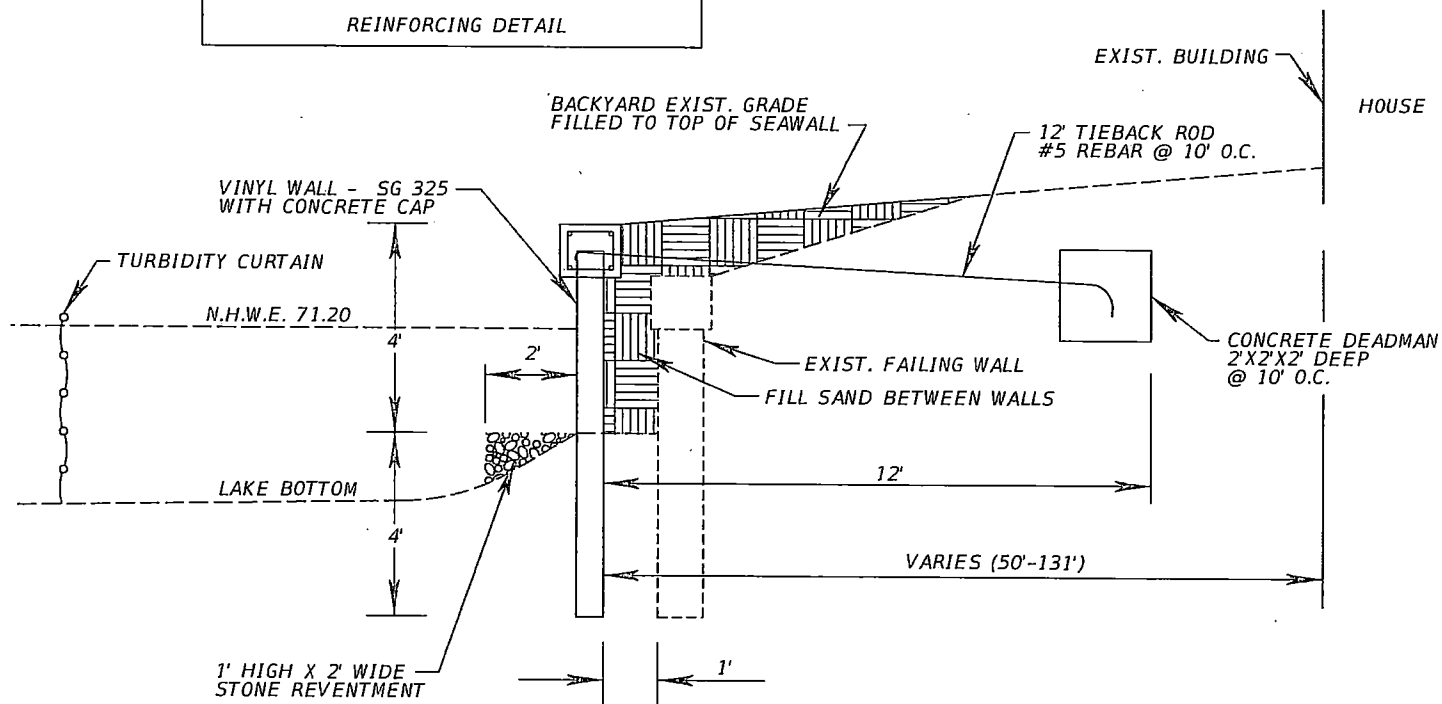
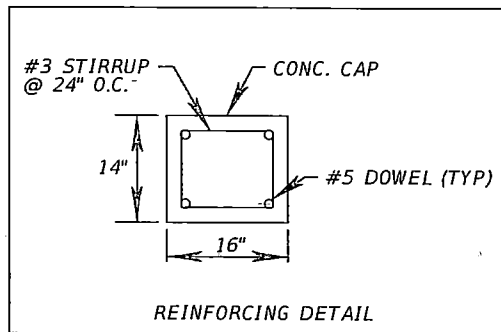

Digitally signed
by Jennifer
Teliga
Date: 2018.03.27
10:45:41 -04'00'

FENDER MARINE CONSTRUCTION
1201 W. JACKSON ST.
ORLANDO, FLORIDA 32805
407-481-2750

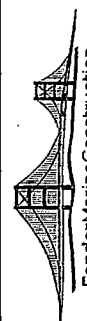

JENNIFER R. TELIGA, P.E.
P.E. NO. 64621
11534 BRIAR HOLLOW LANE
CLERMONT, FL 34711

HILLEREN
SEAWALL
CROSS SECTION
DETAIL

SCALE: N.T.S.

SHEET: 4

RECEIVED

MAR 27 2018

BY: EPD

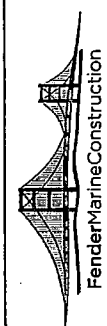
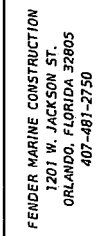

JENNIFER R. TELIGA, P.E.
P.E. NO. 64621
11534 BRIAR HOLLOW LANE
CLERMONT, FL 34711



ASBUILTS SHOWN ARE FROM
ACCURIGHT SURVEYS
NDARY SURVEY 2200 WOODLAWN DRIVE
18, TOWNSHIP 22 SOUTH, RANGE 30 EAST
JOB NO. 30173
FIELD DATE 8/31/2010

HILLEREN SEAWALL	SCALE:	1"=40'
	SHEET:	

RECEIVED

MAR 27 2018

BY: EPD