



Interoffice Memorandum

April 27, 2018

TO: Mayor Teresa Jacobs  
and Board of County Commissioners

FROM: Mark V. Massaro, P.E., Director, Public Works Department

CONTACT PERSON: Christine N. Lofye, P. E., Manager  
Traffic Engineering Division

PHONE NUMBER: (407) 836-7890

SUBJ: Installation of "No Parking" signs in Avalon Park

Citizens within the Avalon Park community have expressed concerns relating to the ability of emergency vehicles to access their homes when vehicles are parked on-street on both sides. The Orange County Fire Rescue Department reviewed the on-street parking situation within this community and has confirmed that allowing parking on both sides of the street impedes emergency apparatus from accessing certain portions of the community, thereby creating a public safety hazard.

Florida Fire Prevention Code, Section 18.2.3.4.1.1, requires that fire department access roads shall have an unobstructed width of no less than 20 feet. Also, the Florida Fire Prevention Code, Section 18.2.4.1.1, states that the required width of a fire department access road shall not be obstructed in any manner, including the parking of vehicles. For this reason, the implementation of one-sided street parking only on roadways without designated parking bays is required to ensure safe access of emergency vehicles within the Avalon Park community.

The Fire Marshal recommends that "No Parking" signs be installed on one side of the street in Avalon Park within the following subdivisions according to the attached maps:

Install "NO PARKING" signs within:

- Avalon Park Northwest Village Phase 1
- Avalon Park South Phase I
- Avalon Park South Phase 2
- Avalon Park South Phase 3
- Avalon Park Village 2
- Avalon Park Village 3
- Avalon Park Village 4 (1 of 2)
- Avalon Park Village 4 (2 of 2)
- Avalon Park Village 5
- Avalon Park Village 6
- Avalon Park Village 4A and 4B

April 27, 2018

TO: Mayor Teresa Jacobs  
and Board of County Commissioners

SUBJ: **Installation of "No Parking" signs in Avalon Park**

Page 2

Avalon Park Northwest Village Phases 2, 3, and 4  
Avalon Town Center Tracts 20, 21, 22, and 23  
Live Oak Village Phase 1A in Avalon Park  
Live Oak Village Phase 1B in Avalon Park  
Live Oak Village Phase 2 in Avalon Park

**Action Requested: Approval of "No Parking" signs installation in the Avalon Park community. District 4.**

MVM/CNL/FCY/AHW/wjn

Attachments

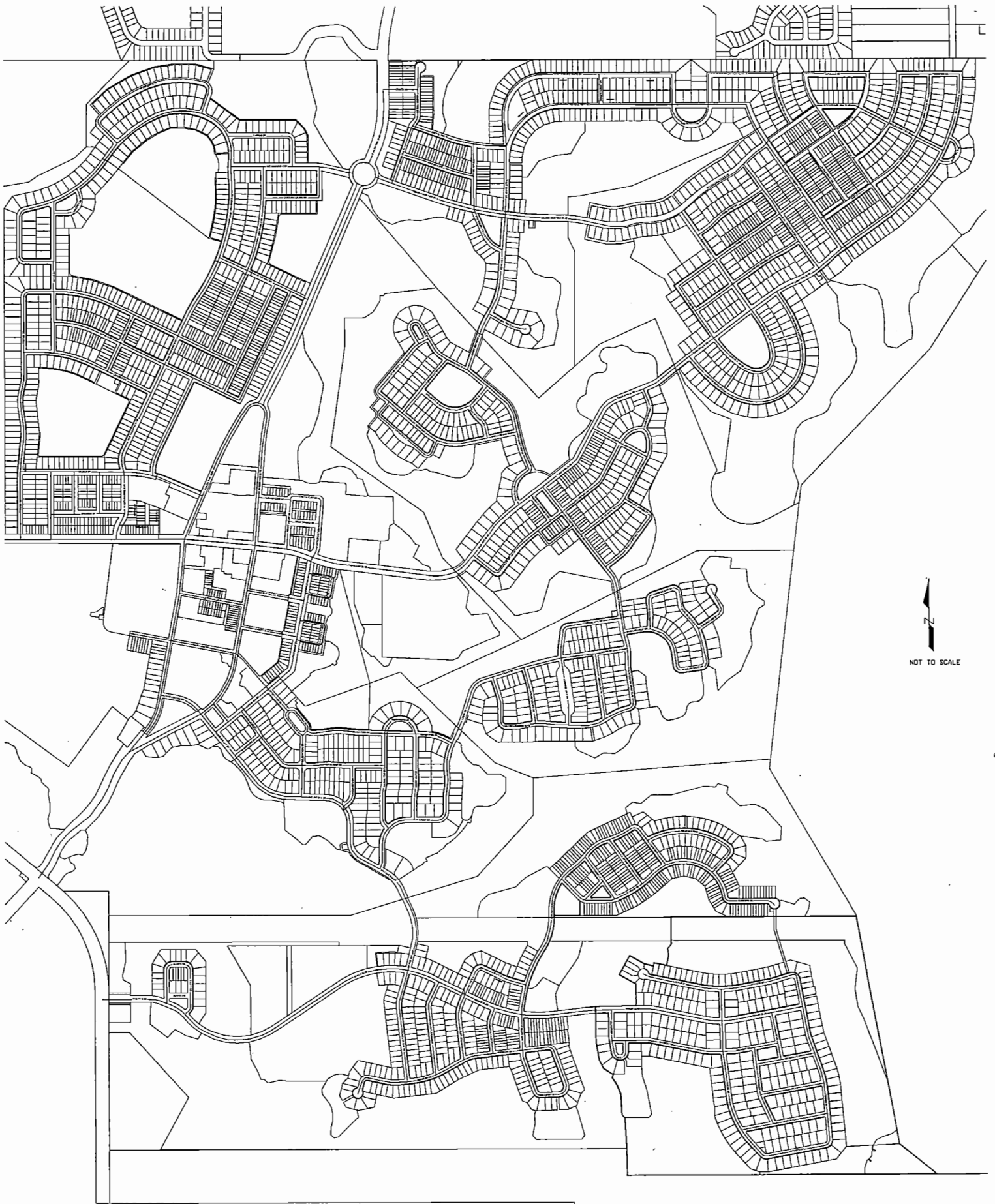

AVALON PARK NO PARKING AREA MAP

LEGEND  
NO PARKING —

# AVALON PARK NORTHWEST VILLAGE PHASE 1

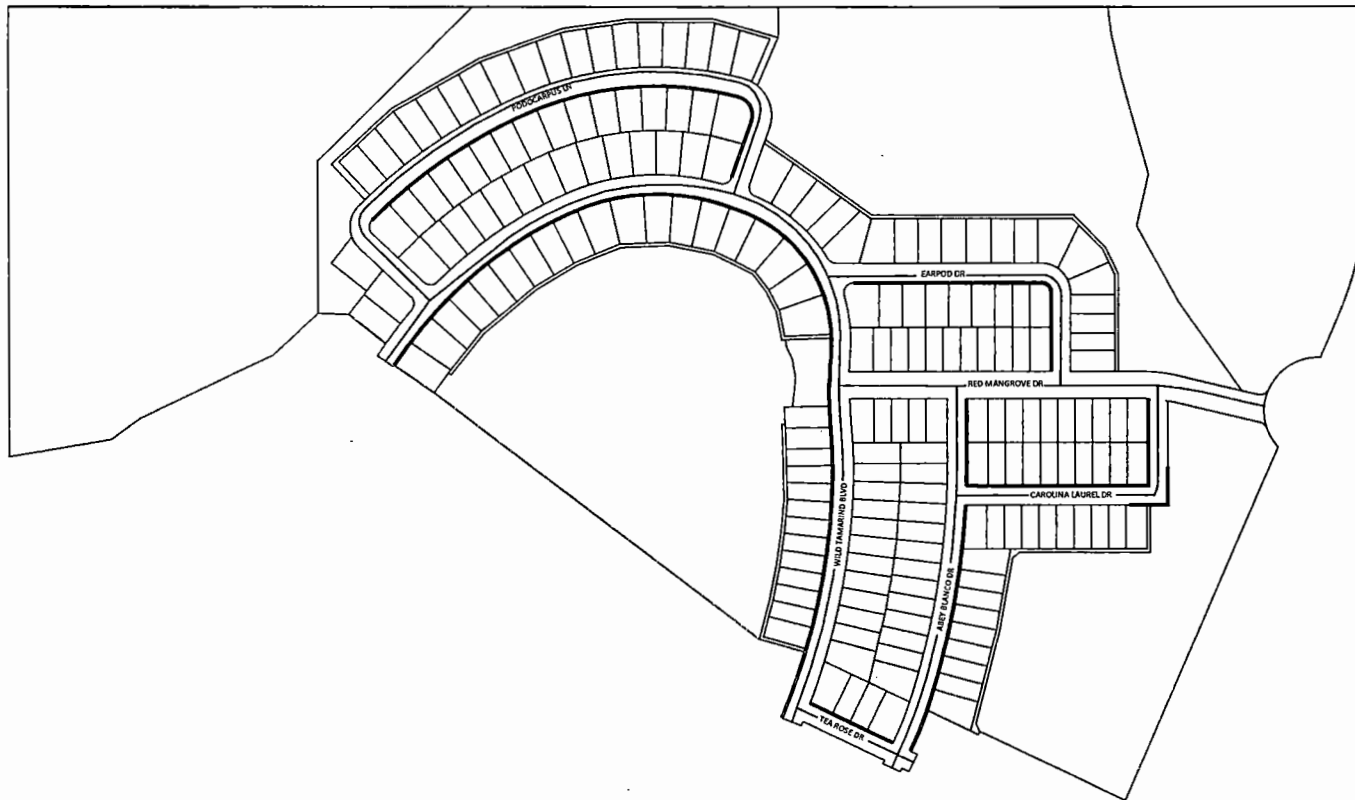
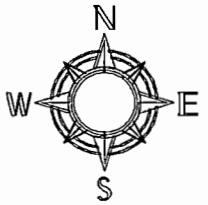

LEGEND:  
NO PARKING



# AVALON PARK SOUTH PHASE 1

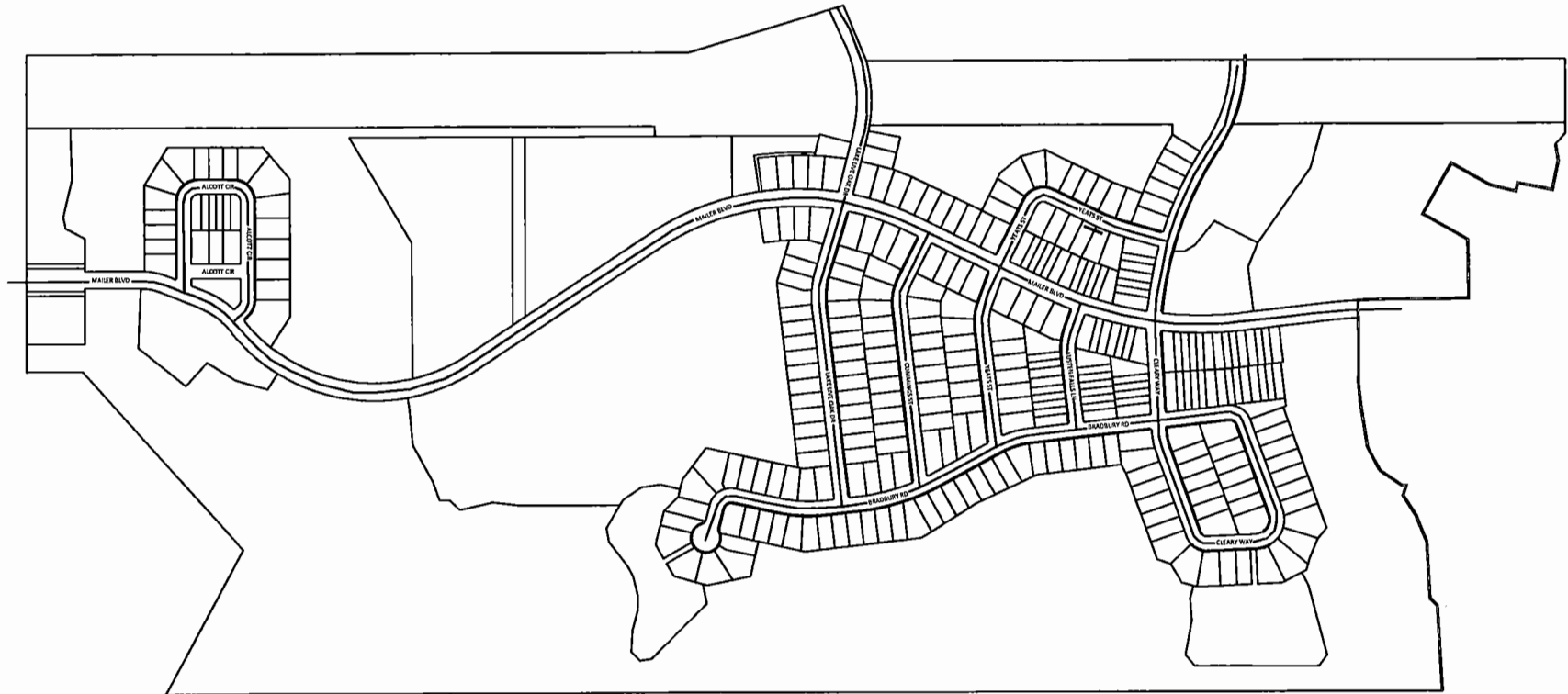

LEGEND:  
NO PARKING



# AVALON PARK SOUTH PHASE 2

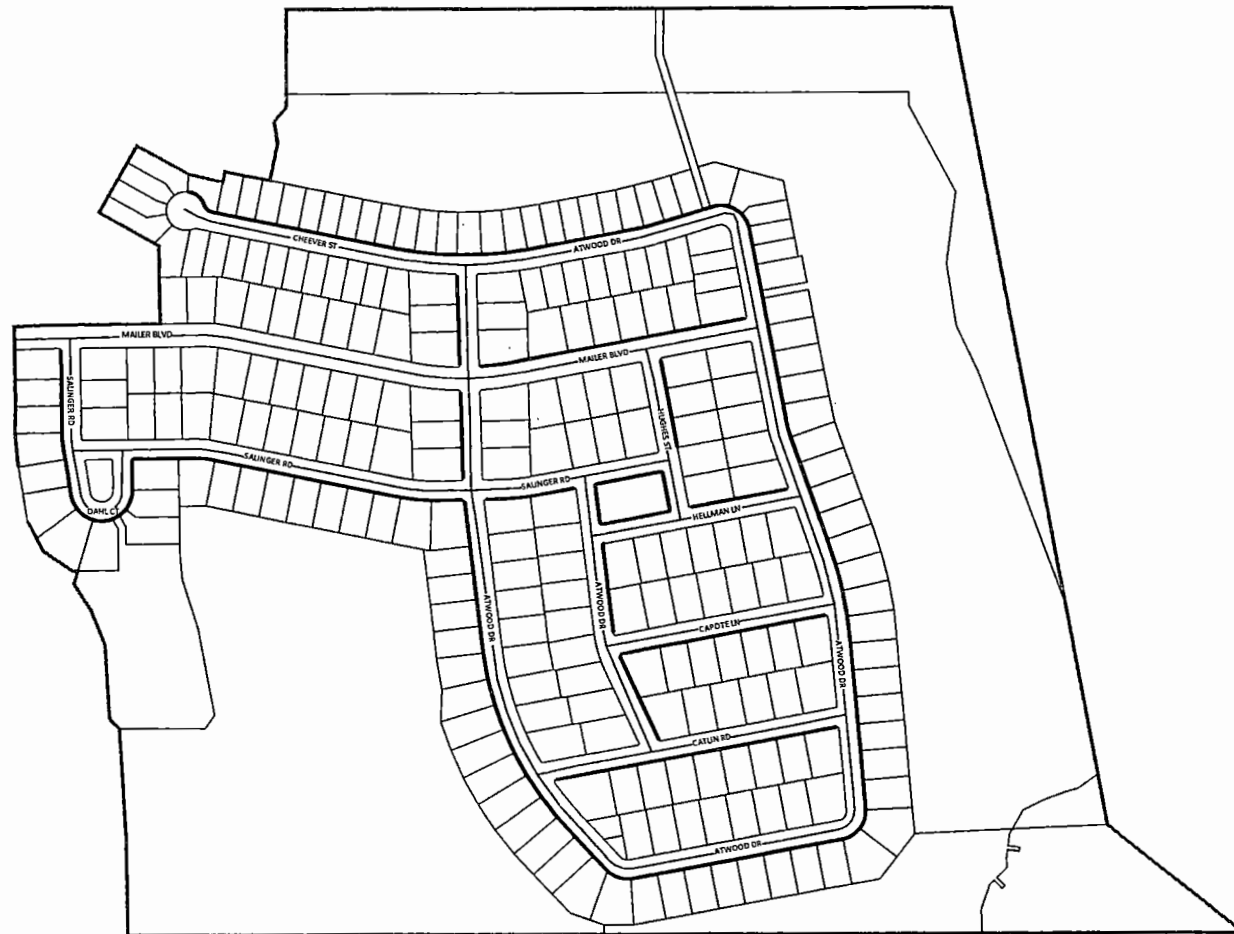

LEGEND:  
NO PARKING



AVALON PARK SOUTH PHASE 3

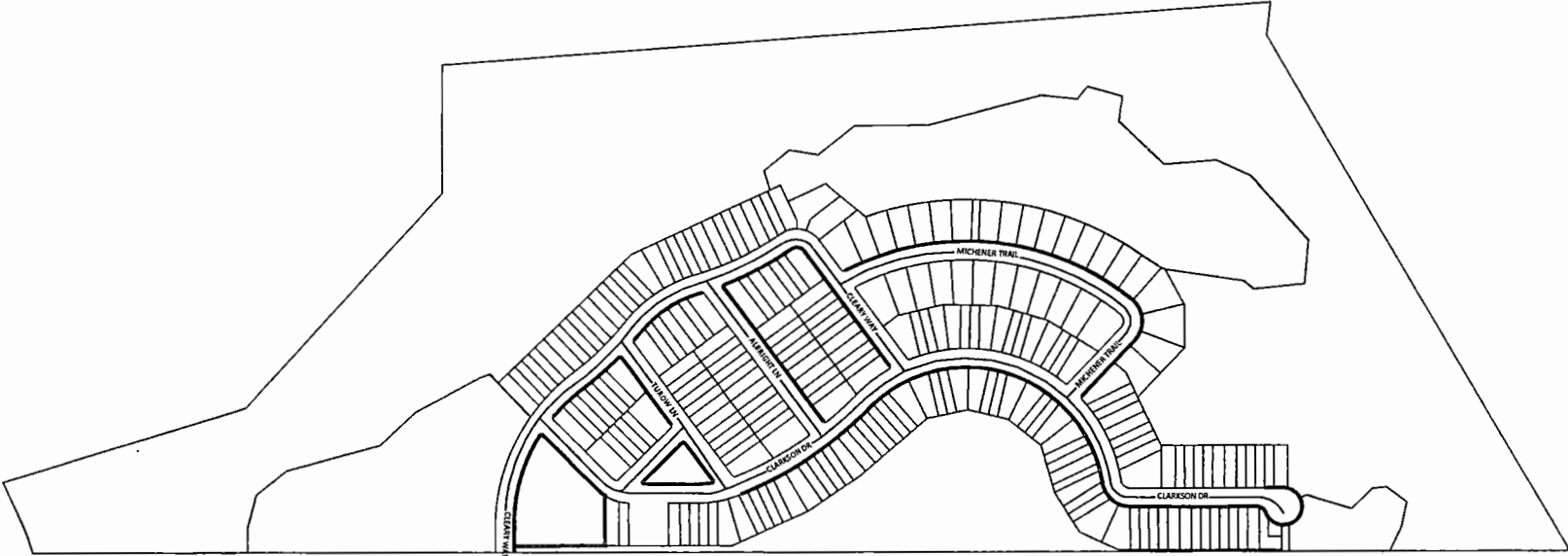

LEGEND:  
NO PARKING 

# AVALON PARK VILLAGE 2

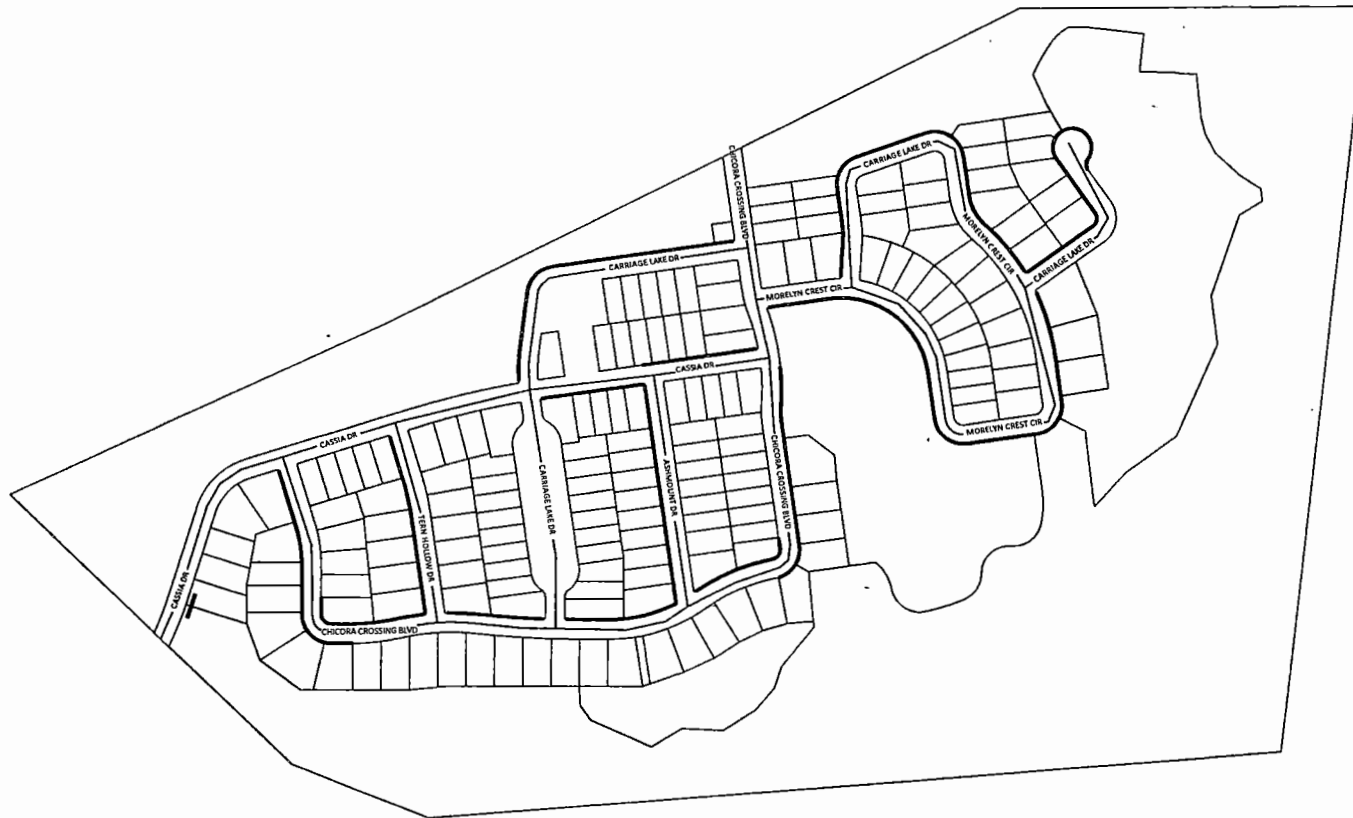

LEGEND:  
NO PARKING





NG

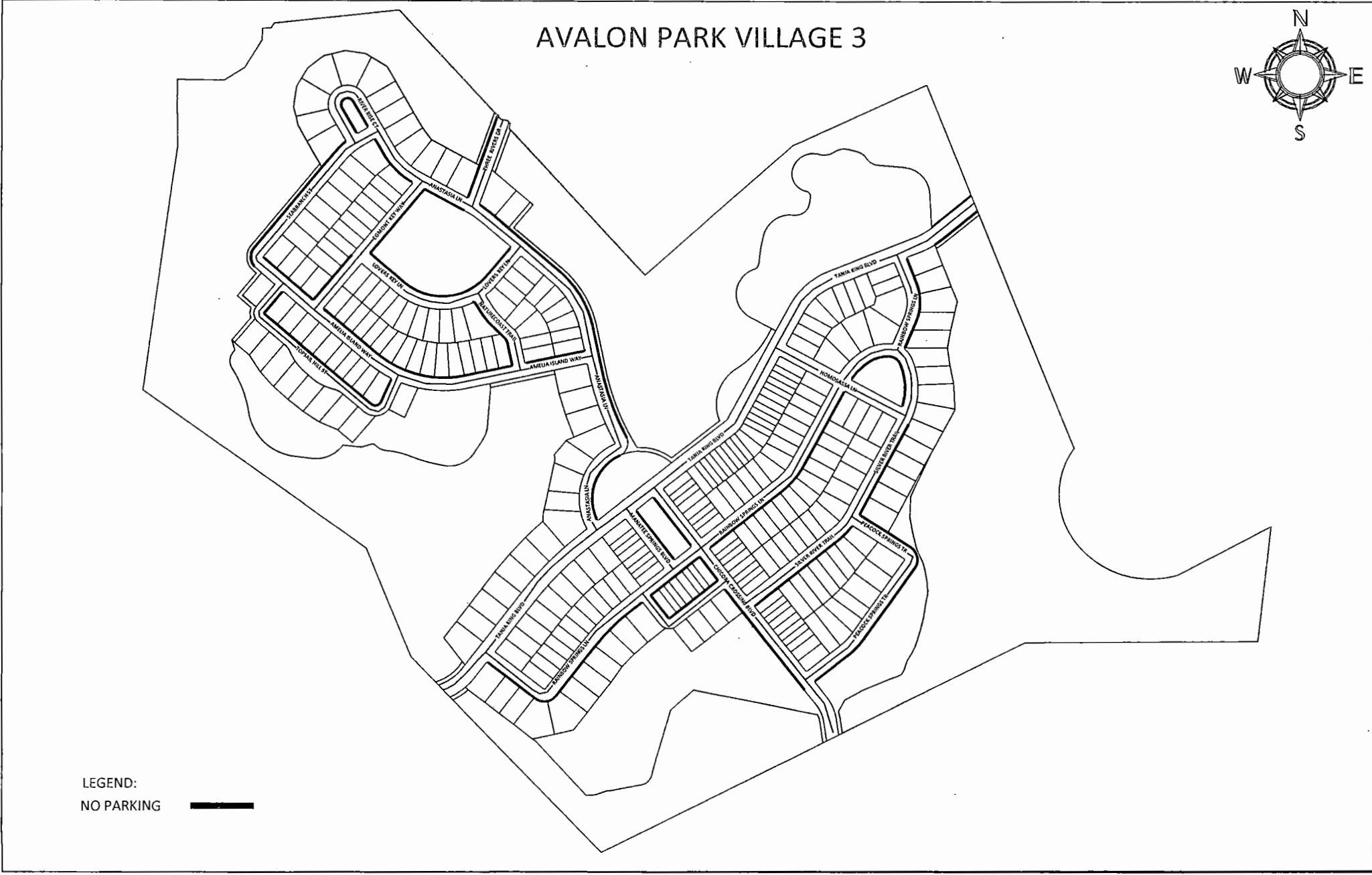

\_\_\_\_\_

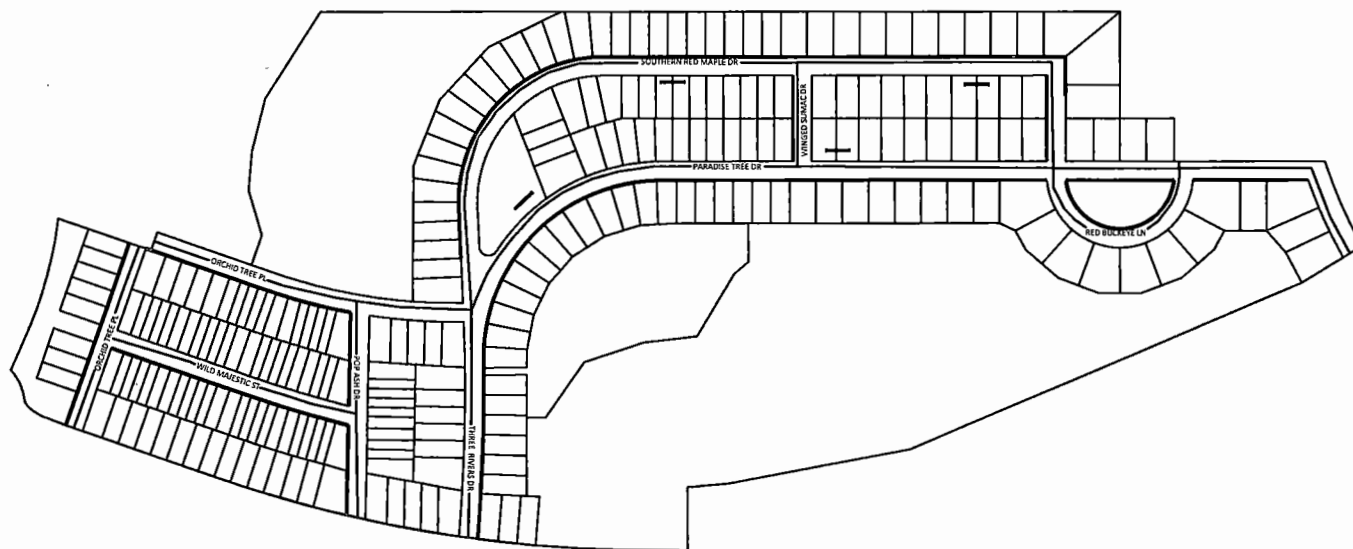

\_\_\_\_\_

AVALON PARK VILLAGE 4 (2 OF 2)

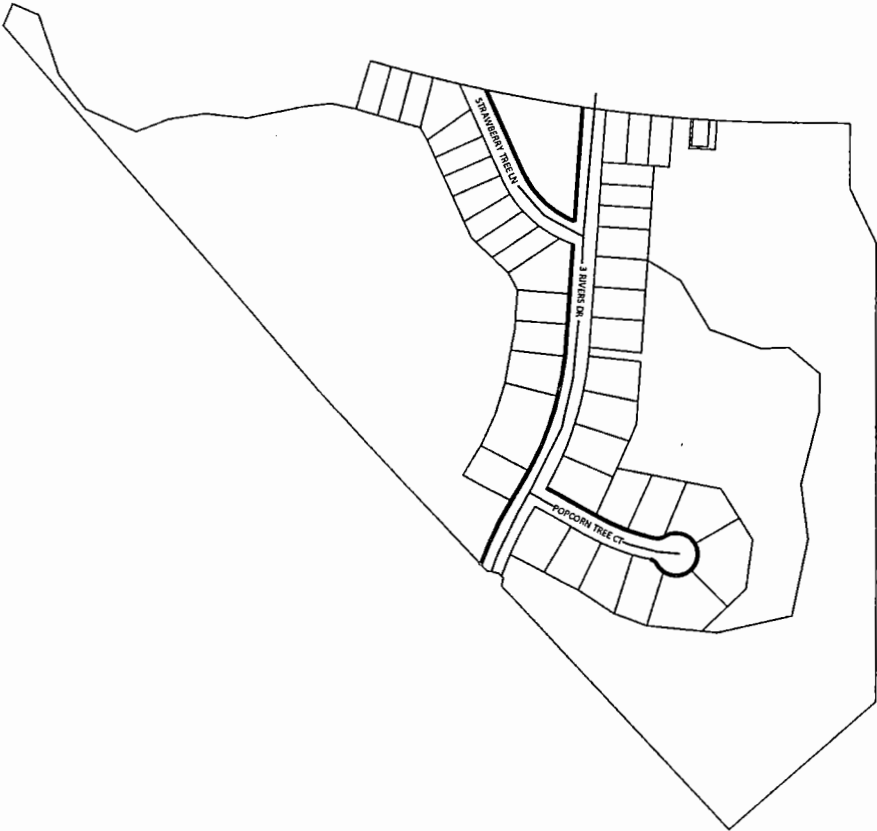
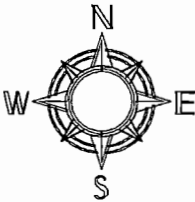

LEGEND:  
NO PARKING 

# AVALON PARK VILLAGE 5

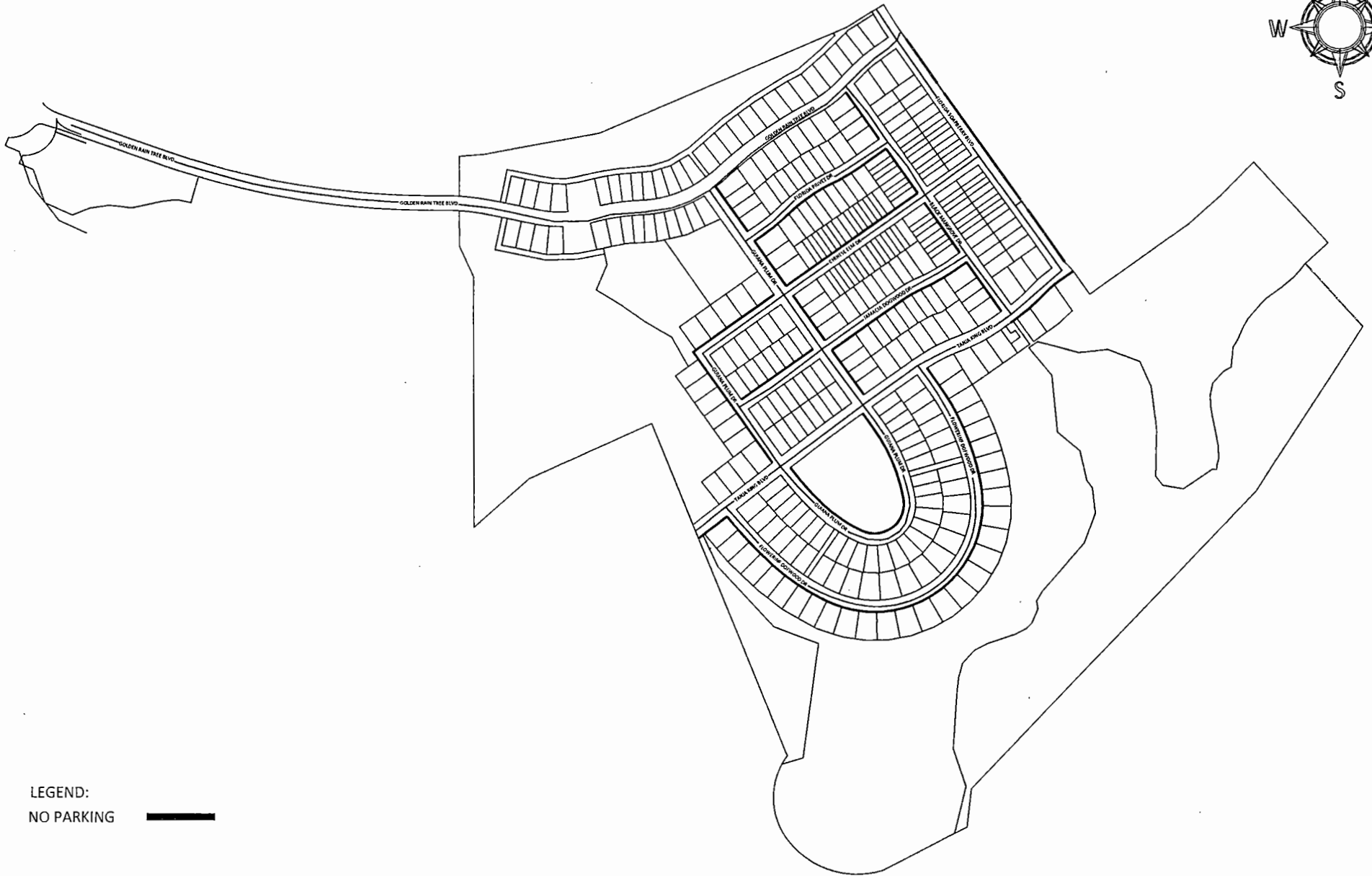
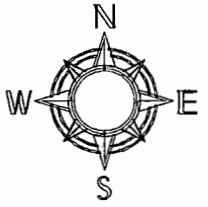

LEGEND:  
NO PARKING



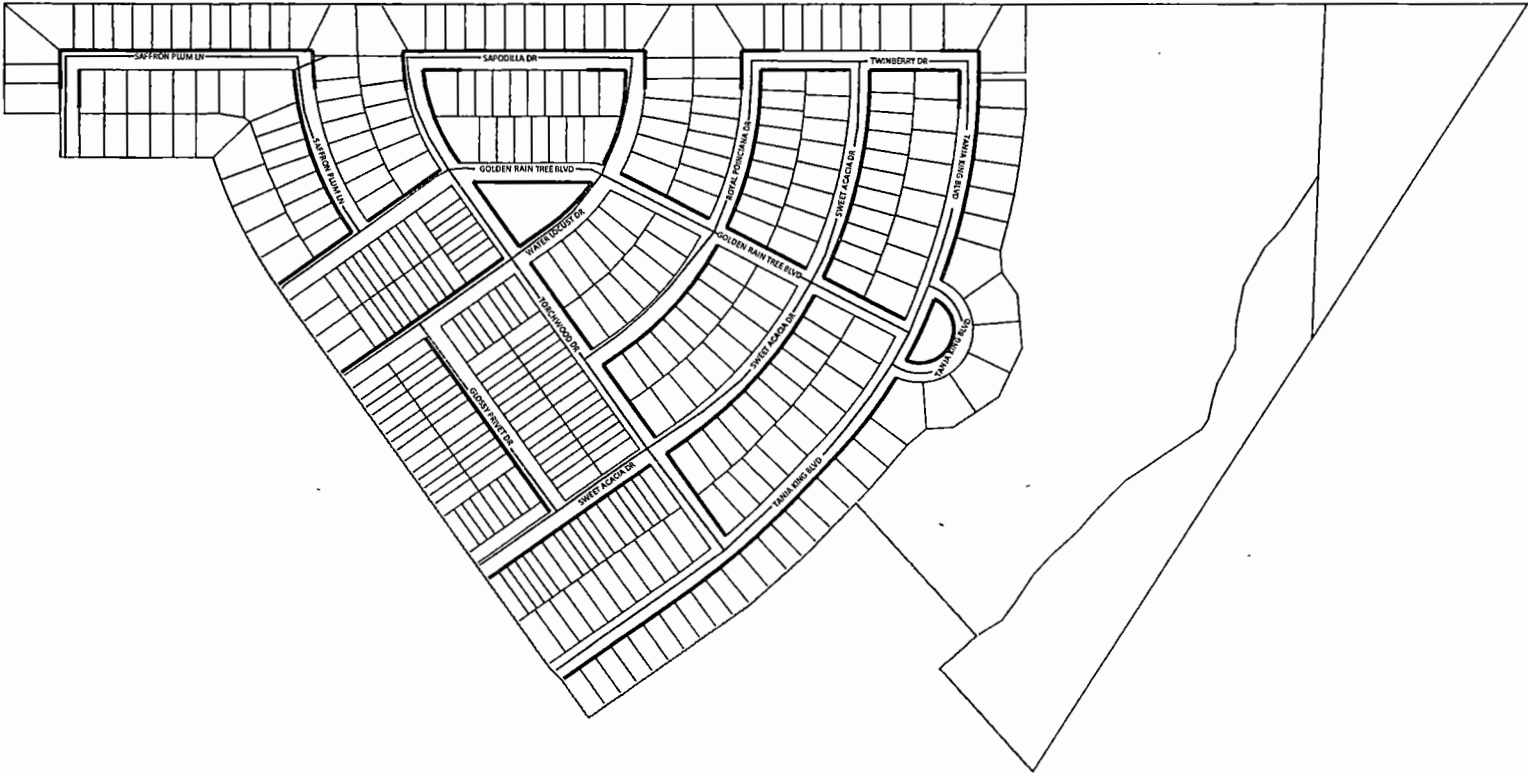
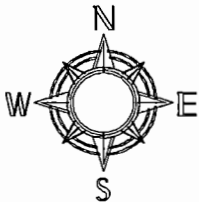

AVALON PARK VILLAGE 6

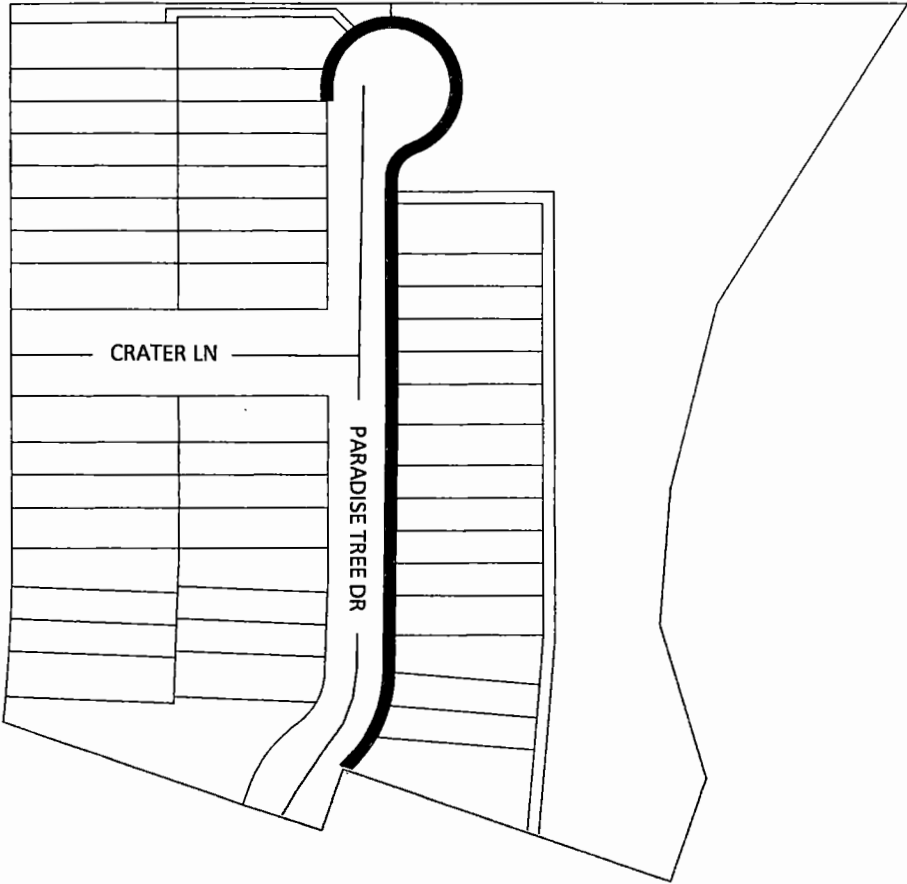

LEGEND:  
NO PARKING 

AVALON PARK VILLAGE 4A AND 4B



LEGEND:  
NO PARKING 

AVALON TOWN CENTER TRACTS  
20,21,22 AND 23

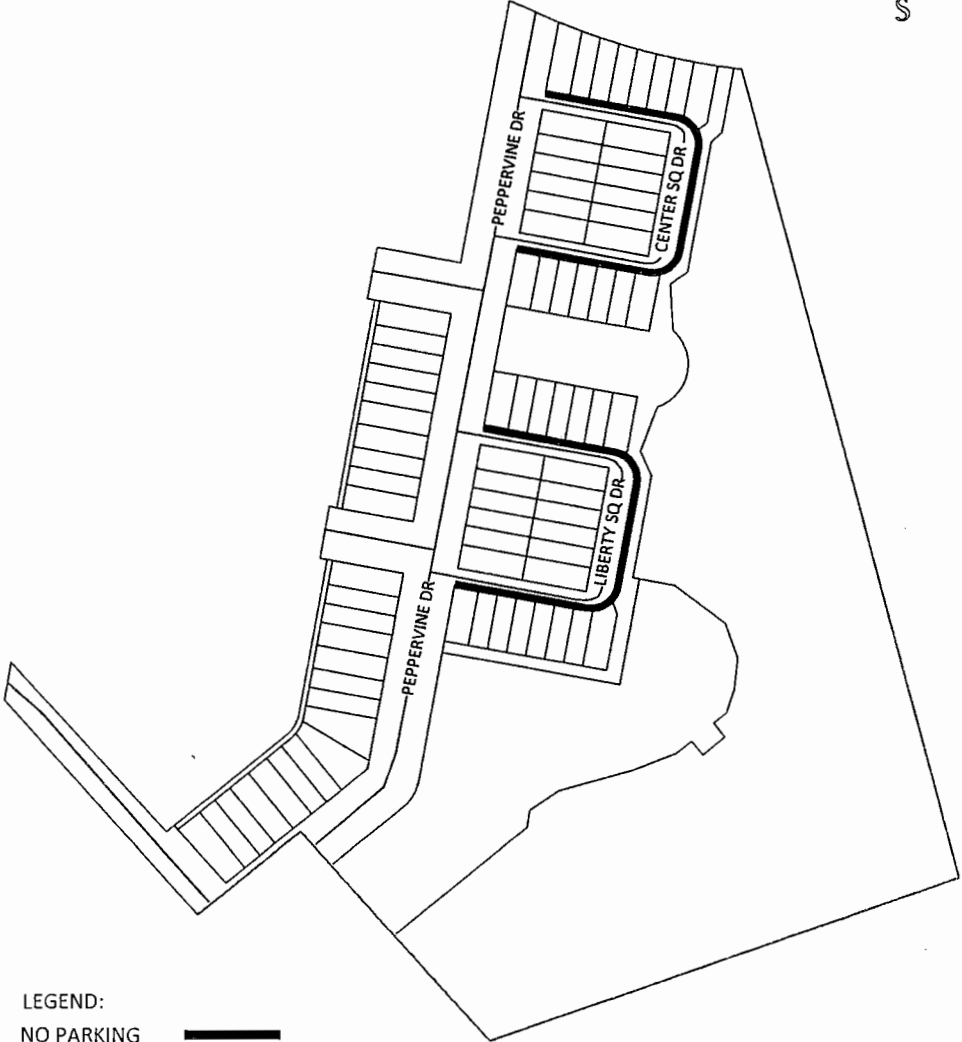
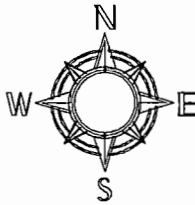

LEGEND:  
NO PARKING 

# AVALON PARK NORTHWEST VILLAGE PHASES 2,3 AND 4

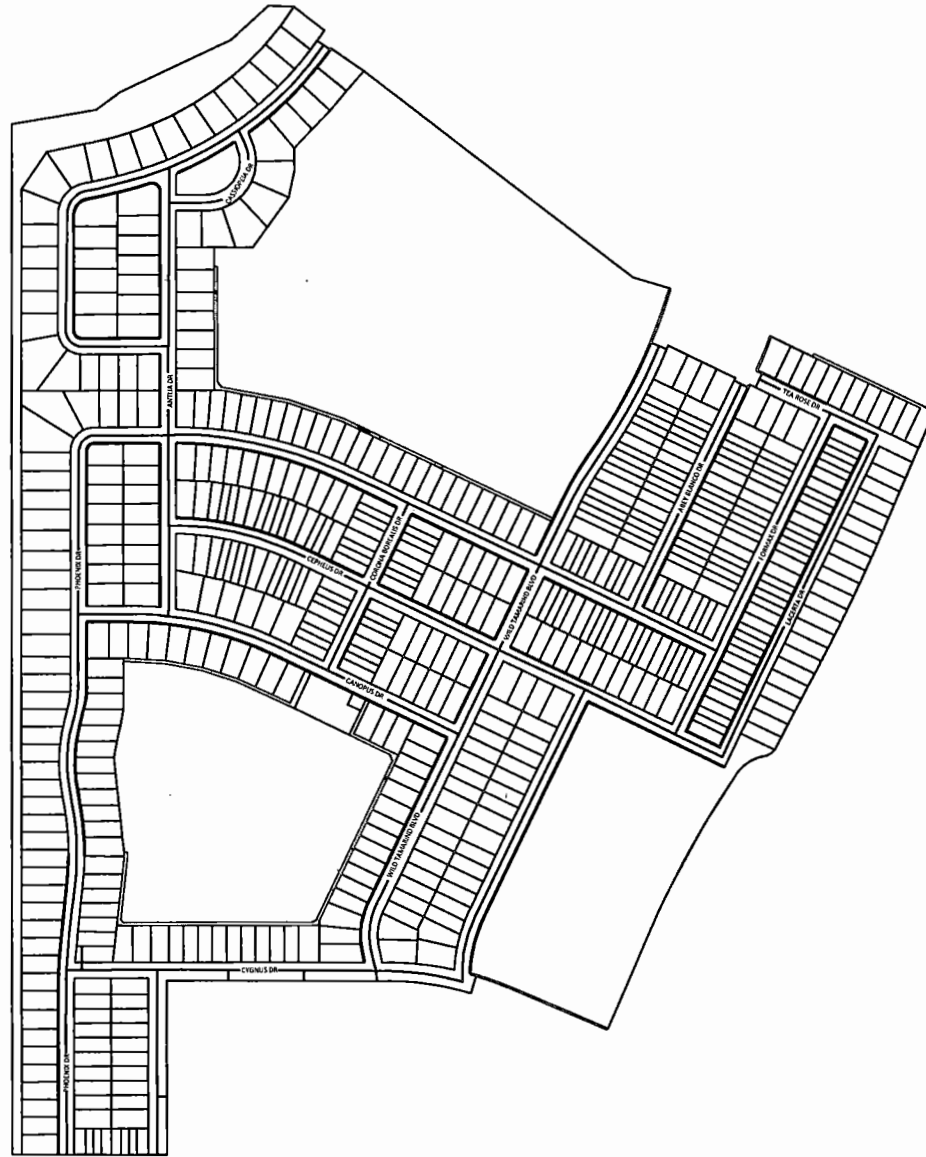

LEGEND: ·  
NO PARKING



# LIVE OAK VILLAGE PHASE 1A IN AVALON PARK

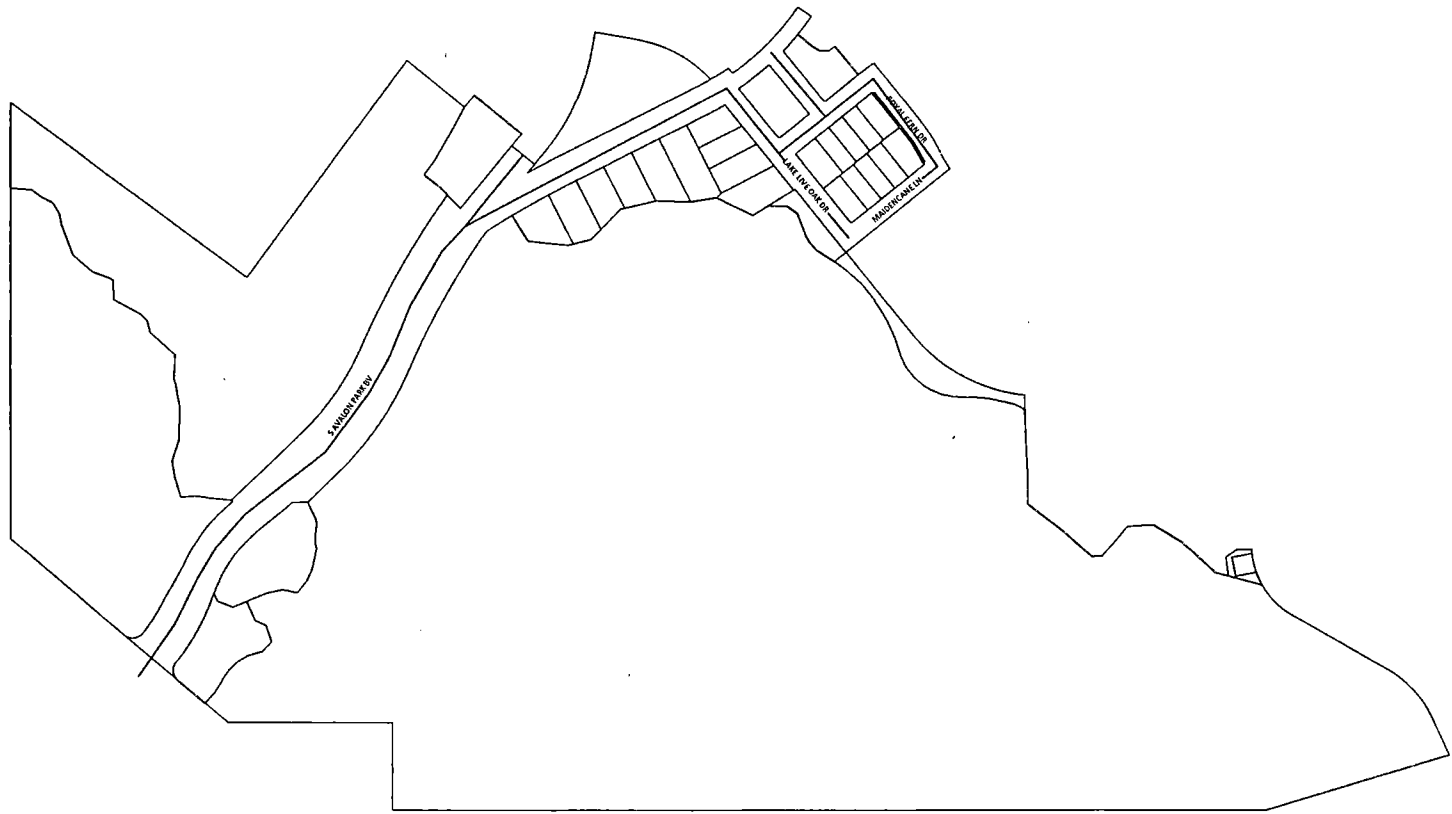
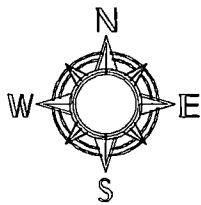

LEGEND:  
NO PARKING





# LIVE OAK VILLAGE PHASE 1B IN AVALON PARK

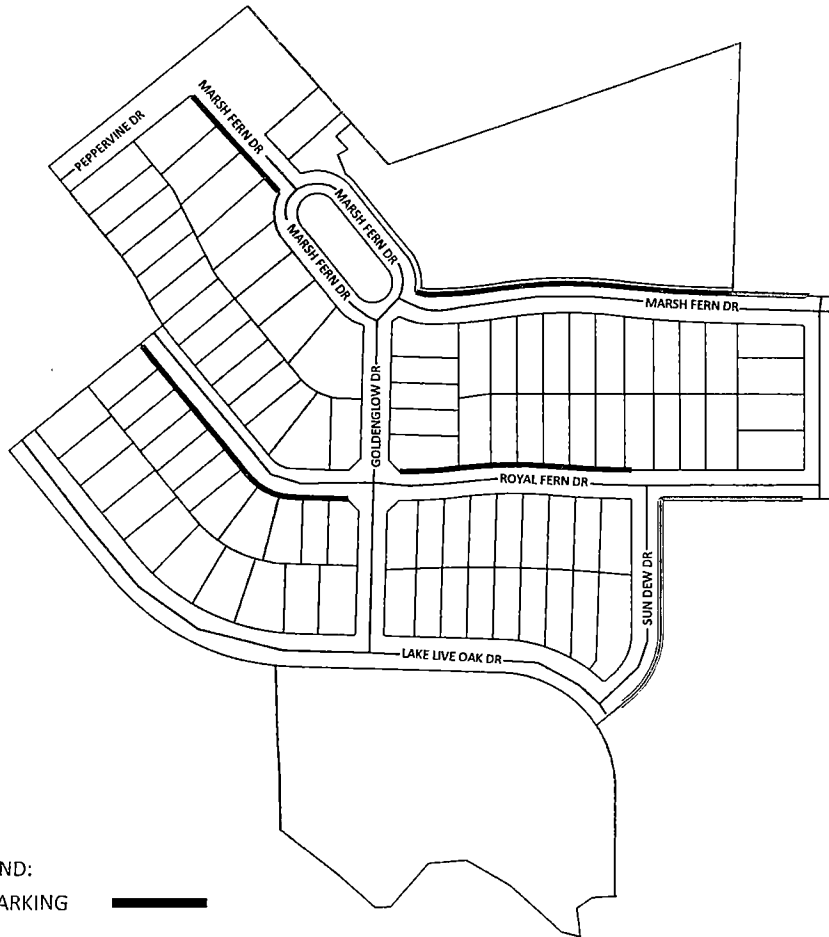
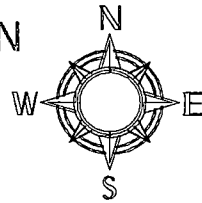

# LIVE OAK VILLAGE PHASE 2 IN AVALON PARK

