



Interoffice Memorandum

06-13-18P01:42 RCVD

06-13-18P01:42 RCVD

May 25, 2018

TO: Katie Smith, Manager
Comptroller Clerk's Office

THROUGH: Cheryl Gillespie, Agenda Development Supervisor
Agenda Development

FROM: David D. Jones, P.E., CEP, Manager
Environmental Protection Division

STAFF PERSON: **Elizabeth R. Johnson, CEP, Assistant Manager
Environmental Protection Division
(407) 836-1511**

SUBJECT: Request for Public Hearing on July 10, 2018, at 2:00 p.m., for a Conservation Area Impact Permit Application (CAI-18-02-009) for the Conway Center project site located at Conway Road, Orlando, FL 32812, Parcel ID Numbers 29-23-30-0000-00-030 and 29-23-30-0000-00-031

NOTE: **This CAI-18-02-009 must be scheduled with Rezoning Case (RZ-18-06-031) and a FLU Amendment already scheduled for July 10, 2018**

Applicant: Orange County Investments, LLC, and Clermont Investments, LLC.

Type of Hearing: Conservation Area Impact Permit Application.

Hearing required by
Florida Statute # or Code: Orange County Comprehensive Plan.

Advertising requirements: None.

Advertising timeframes: None.

Notification requirements: The applicant will be notified at least ten days prior to public hearing by the Environmental Protection Division (EPD). Notification of abutters is not necessary.

Estimated time required
For public hearing: 2 minutes.

Hearing Controversial: No.

Municipality or other
Public Agency to be
notified: St. Johns River Water Management District - vnations@sjrwmd.com

July 10, 2018
@ 2pm

May 25, 2018

Request for Public Hearing – Conservation Area Impact Permit Application for Orange County Investments, LLC, and Clermont Investments, LLC (CAI-18-02-009)

Page 2 of 2

District #: 3.

Materials being submitted as backup for public hearing request:

1. Site Plan
2. Location Map

Special Instructions to Clerk:

1. Once the Board of County Commissioners makes a decision on the Conservation Area Impact Permit Application, please submit the decision letter to Michelle Gonzalez with EPD. EPD will issue the decision to the applicant.

AW/~~MT~~/ERJ/DJ: gfdjr/mg

Attachments

c: Chris Testerman, Assistant County Administrator
Jon V. Weiss, P.E., Director, Community, Environmental, and Development Services
Joel D. Prinsell, Deputy County Attorney

Conservation Area Impact Permit Request



Conservation Area Impact Permit Application Request District #3

**Applicant: Clermont Investments, LLC
Orange County Investments, LLC**

**Parcel IDs: 29-23-30-0000-00-030
29-23-30-0000-00-031**

**Conservation Area Impact
Permit No.: CAI-18-02-009**

Project Site 

Property Location 



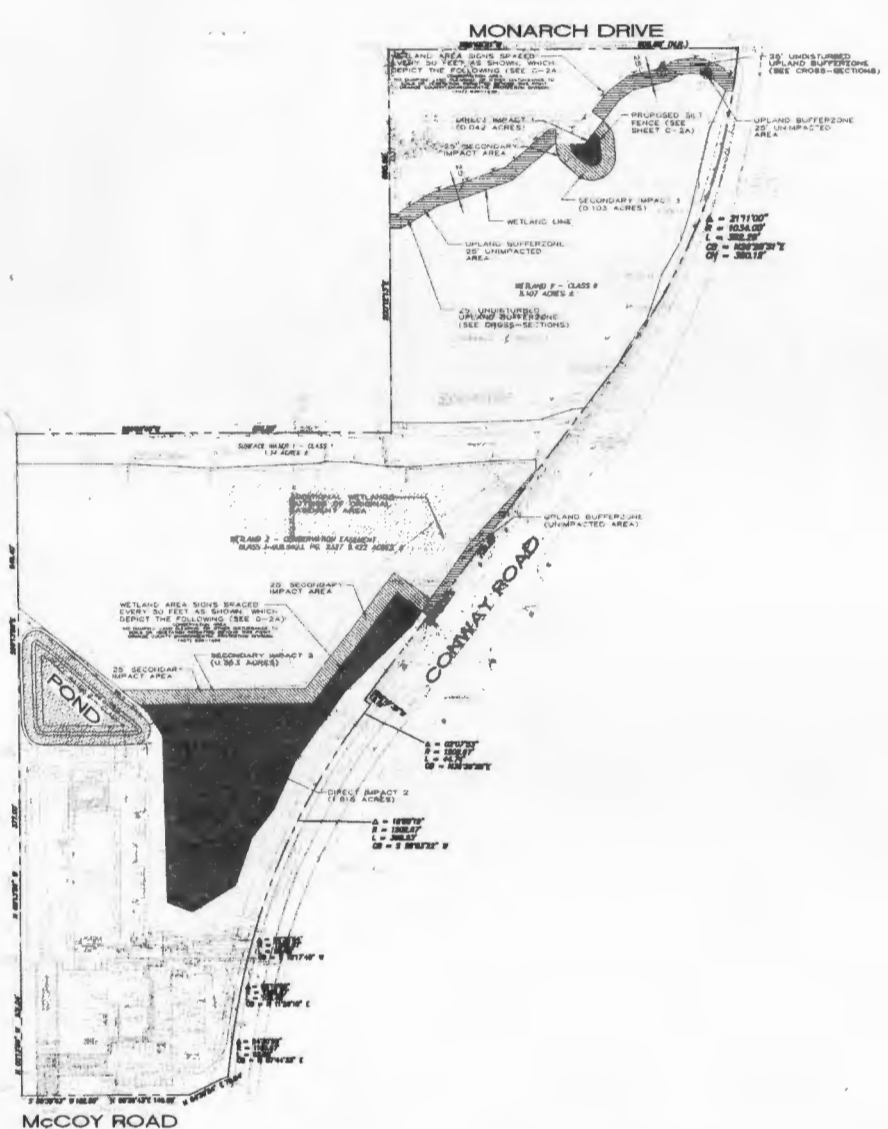

- SITE LEGEND**
- HANDICAP PARKING
 - PROPOSED DRAINAGE INLET
 - PROPOSED CURB
 - SITE BOUNDARY LINE
 - EXISTING EASEMENT (DEPICTED ON PLAN)
 - PROPOSED EASEMENT (DEPICTED ON PLAN)
 - CENTER LINE OF ROAD
 - EXISTING EDGE OF PAVEMENT
 - TYPICAL
 - HANDICAP
 - 8' OF PARKING SPACES
 - SIDEWALK
 - 5' RADIUS
 - LINEAR FEET
 - SQUARE FEET
 - BACK OF CURB
 - PROPOSED ASPHALT PAVEMENT (SEE DETAIL)
 - PROPOSED CONCRETE PAVEMENT (SEE DETAIL)
 - DIRECT WETLAND IMPACT AREA (1.880 ACRES)
 - SECONDARY WETLAND IMPACT AREA (0.488 ACRES)
 - 25' UNDISTURBED UPLAND BUFFERZONE
 - EXISTING CONSERVATION EASEMENT "WETLAND 2" (0.8422, PG. 2327)
 - SURFACE WATER IMPACT (EXISTING POND) (0.882 ACRES)
 - WETLAND 1-CLASS 2 (0.107 ACRES)
 - SURFACE WATER - CLASS 1 (EXISTING CANAL) (1.140 ACRES)

NOTE:
REPRODUCTION OF THIS PLAN IS INVALID UNLESS CONTAINING ORIGINAL SIGNATURE AND EMBOSSED WITH ENGINEER'S SEAL AS PER CHAPTER 314.23, C.S. FLORIDA ADMINISTRATIVE CODE

REV/DATE	BY
1-1-00	C.B.
AS PER PLANS	C.B.
AS PER PLANS	C.B.
5-2-00	M.C.
WETLAND LINE REVISION	M.C.
5-2-00	M.C.
AS PER PLANS	M.C.
1-1-00	M.C.
WETLAND LINE REVISION	M.C.

WETLAND IMPACT EXHIBIT

FOR

McCOY ROAD MASS

GRADING PLAN

ORANGE COUNTY, FLORIDA

CONWAY ROAD

DRAWN BY	M.C.
CHECKED BY	M.C.
DATE	5-2-00
SCALE	1" = 100'
JOB NO.	280-002
SHEET NO.	C-1A
OF C-4	

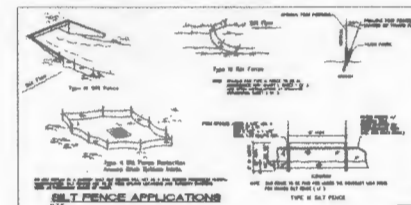
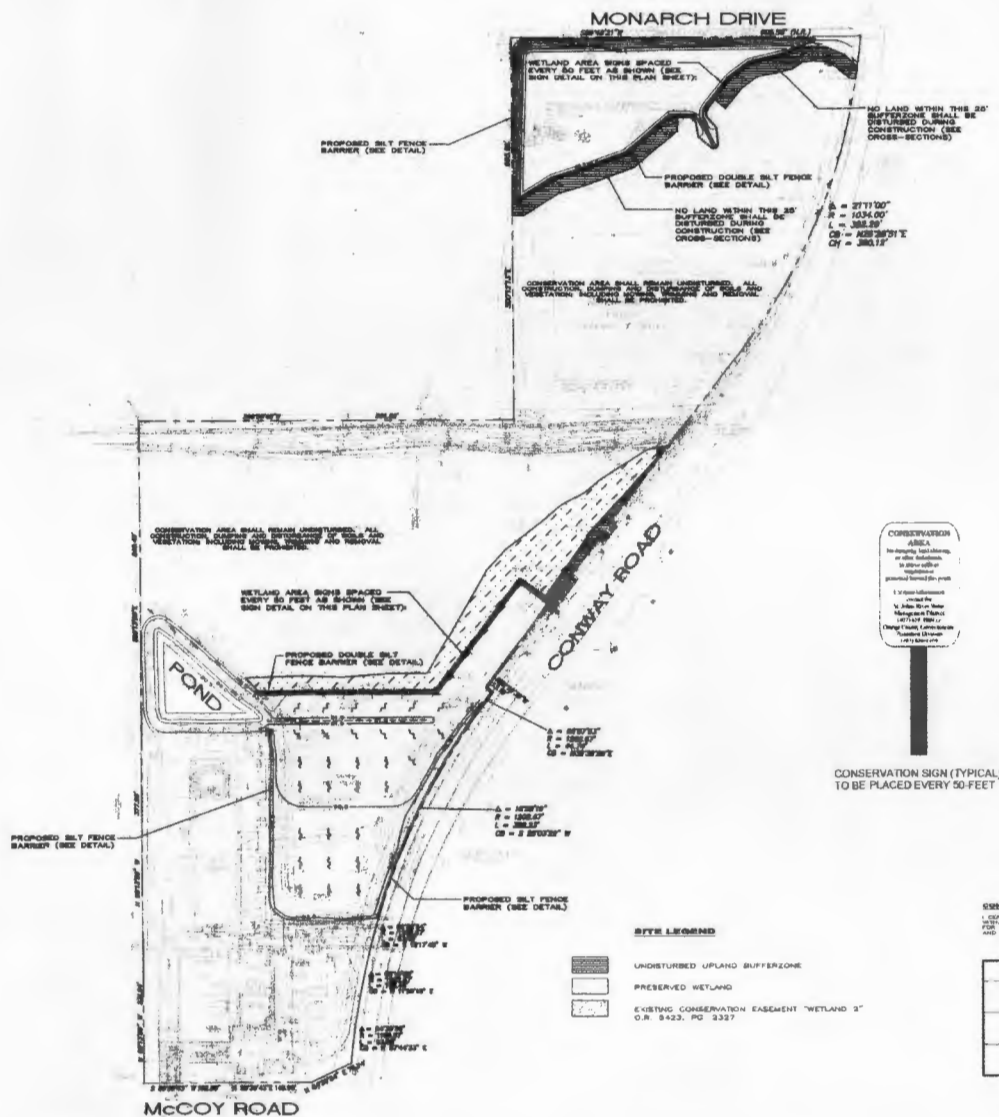

Task	Start (Weeks)	End (Weeks)	Duration (Weeks)
INSTALL EROSION CONTROL MEASURES	0	1	1
CLEANING AND GRUBBING	0	2	2
FACILITY CONSTRUCTION	1	11	10
MAINTAIN EROSION CONTROL MEASURES	1	11	10
GRASSING	10	11	1
REMOVE TEMPORARY EROSION CONTROL MEASURES	10	12	2

LOCATION:
SITE LOCATION: NE CORNER OF MOODY ROAD AND CONWAY ROAD
SITE AREA 1,010.203 SF = 27.9 ACRES
E, 1/4, 3546- 30°37'06" N, 61°03'00" W
UNIFORM LOCATION: ORANGE COUNTY S-B CANAL

CONSTRUCTION REQUIREMENTS:

1. INITIAL STABILIZED CONSTRUCTION ENTRANCE
2. INITIAL SITE PREP AS REQUIRED
3. STABILIZED PERSONNEL REQUIRED
4. INITIAL PERSONNEL TRAINING REQUIRED
5. INITIAL PERSONNEL TRAINING ON SITE AS REQUIRED
6. STABILIZED DURING AREAS AND STOCKPILES AS SOON AS PRACTICAL
7. STOCKPILE REMOVAL
8. CONSTRUCT BUILDING AND OTHER UNDERGROUND UTILITIES
9. INITIAL PERSONNEL AND SUPPLY
10. INITIAL UNDERGROUND AND ESD
11. INITIAL PERSONNEL TRAINING ON SITE AS REQUIRED
12. INITIAL PERSONNEL TRAINING ON SITE AS REQUIRED
13. INITIAL PERSONNEL TRAINING ON SITE AS REQUIRED
14. INITIAL PERSONNEL TRAINING ON SITE AS REQUIRED
15. INITIAL PERSONNEL TRAINING ON SITE AS REQUIRED
16. INITIAL PERSONNEL TRAINING ON SITE AS REQUIRED
17. INITIAL PERSONNEL TRAINING ON SITE AS REQUIRED
18. INITIAL PERSONNEL TRAINING ON SITE AS REQUIRED
19. INITIAL PERSONNEL TRAINING ON SITE AS REQUIRED
20. INITIAL PERSONNEL TRAINING ON SITE AS REQUIRED

SOIL TYPE:
SANDY LOESS
AT JORDON

OPERATIONS WITHIN SAN LOCATIONS:

OPERATIONS SHALL BE UTILIZED ONLY IF NECESSARY BY MEANS OF A WELL POINT SYSTEM DISCHARGING FROM THE WELL POINT SYSTEM SHALL BE DISCHARGED TO THE PROPOSED DRAINAGE STRUCTURES. THE CONTRACTOR SHALL OBTAIN ALL NECESSARY PERMITS FOR WELL POINT SYSTEM PRIOR TO CONSTRUCTION.

[illegible]

PERMANENT BROWN CONTROL MEASURES (BMP#1)

A. PERMANENT BROWDING ALL AREAS WHICH HAVE BEEN DISTURBED BY CONSTRUCTION WILL, AS A MINIMUM, BE SOOBER THE NEED FOR MUST PROVIDE BOTH LONG-TERM VEGETATION AND RAPID GROWTH SEASONAL VEGETATION. SLOPES STEEPER THAN 1:1 SHALL BE RESEED AND MULCHED OR SOOBER.

B. MAINTENANCE OF STORMWATER MANAGEMENT SYSTEMS: THE PERMITTED STORMWATER MANAGEMENT SYSTEM SHALL BE MAINTAINED, CLEANED AND INSPECTED IN ACCORDANCE WITH THE SUPPLEMENT

[illegible][illegible]

CONTRIBUTOR VERIFICATION:

I CERTIFY UNDER PENALTY OF LAW THAT I UNDERSTAND AND SHALL COMPLY WITH THE TERMS AND CONDITIONS OF THE STATE OF FLORIDA BOILING PENALTY FOR STORMWATER DISCHARGE FROM LARGE AND SMALL CONSTRUCTION ACTIVITIES AND THIS STORMWATER POLLUTION PREVENTION PLAN PREPARED THEREUNDER

NAME	TITLE	COMPANY NAME ADDRESS PHONE NO	DATE	SIGNATURE

NOTE:
REPRODUCTION OF THIS PLAN IS INVALID UNLESS CONTAINING
ORIGINAL SIGNATURE AND EMBOSSED WITH ENGINEER'S SEAL AS
PER CHAPTER 214, F.S. 2002 FLORIDA ADMINISTRATIVE CODE

REV/DATE	BY
0-0-00	C.B.
AS PER SURROUND	
10-30-01	
WETLAND LINE REMOVED	M.C.
0-30-11	
AS PER SURROUND	M.C.
1-3-11	
S. WETLAND LINE REMOVED	M.C.
0-21-09	
AS PER COUNTY	M.C.

EROSION CONTROL PLAN
FOR
MCCOY ROAD MASS
GRADING PLAN
CONWAY ROAD
ORANGE COUNTY, FL



DRAWN BY	M.C.
CHECKED BY	M.C.
DATE	3-2-07
SCALE	1" = 100'
JOB NO.	260-002
SHEET NO.	
C-2A OF C-6	

