



Interoffice Memorandum

08-13-18P04:51 RCVD

08-13-18P04:26 RCVD

DATE: August 13, 2018

TO: Katie A. Smith, Deputy Clerk of the
Board of County Commissioners,
County Comptroller's Office

THROUGH: Cheryl Gillespie, Supervisor,
Agenda Development Office

FROM: Alberto A. Vargas, Manager,
Planning Division

CONTACT PERSON: John Smogor, Planning Administrator
Planning Division 407-836-5616 and
john.smogor@ocfl.net

SUBJECT: Request for Board of County Commissioners
(BCC) Public Hearing

Project Name: Butte Planned Development / Land Use Plan (PD / LUP) – Case # CDR-17-04-127

Type of Hearing: Substantial Change

Applicant: Rick Baldocchi, Avcon, Inc.

Commission District: 4

General Location: Generally south of Lake Underhill Road, approximately 970 feet west of Rouse Road.

BCC Public Hearing Required by: Orange County Code, Chapter 30, Article III, Section 30-89 and Orange County Code, Chapter 38, Article VIII, Division 1, Section 38-1207

LEGISLATIVE FILE # 18-1081

Sept. 18, 2018
@ 2:00p.m.

**Clerk's Advertising
Requirements:**

(1) At least 15 days before the BCC public hearing date, publish an advertisement in the Legal Notices section of *The Orlando Sentinel* describing the particular request, the general location of the subject property, and the date, time, and place when the BCC public hearing will be held;

and

(2) At least 10 days before the BCC public hearing date, send notices of BCC public hearing by U.S. mail to owners of property within 300 feet of the subject property and beyond.

Spanish Contact Person:

IF YOU HAVE ANY QUESTIONS REGARDING THIS NOTICE, CONTACT THE ORANGE COUNTY PLANNING DIVISION: Front Desk, 407-836-8181

PARA MÁS INFORMACIÓN, REFERENTE A ESTA VISTA PUBLICA CON RESPECTO A UNA AUDENCIA PUBLICA SOBRE PROPIEDAD EN SU AREA/VECINDAD, FAVOR COMUNICARSE CON LA DIVISIÓN DE PLANIFICACION, AL NUMERO, 407-836-8181

Advertising Language:

A PD substantial change to add a communication tower as a permitted use on Tract B. A waiver from Orange County Code is requested to reduce the distance separation requirement from 700 feet to 580 feet to the nearest residential building (memory care facility).

Material Provided:

- (1) Names and last known addresses of property owners within 300 feet and beyond (*via email from Fiscal and Operational Support Division*); and
- (2) Location map (*to be mailed to property owners*).

Special instructions to the Clerk:

Please place this request on the **September 18, 2018** BCC agenda. Unless stated otherwise, the public hearing should be advertised to begin at 2:00 p.m., or as soon thereafter as the matter may be heard.

Attachment (location map)

c: Chris R. Testerman, AICP, Assistant County Administrator
Jon V. Weiss, Director, Community Environmental Development Services
Department

Butte PD

CDR-17-04-127

Location Map

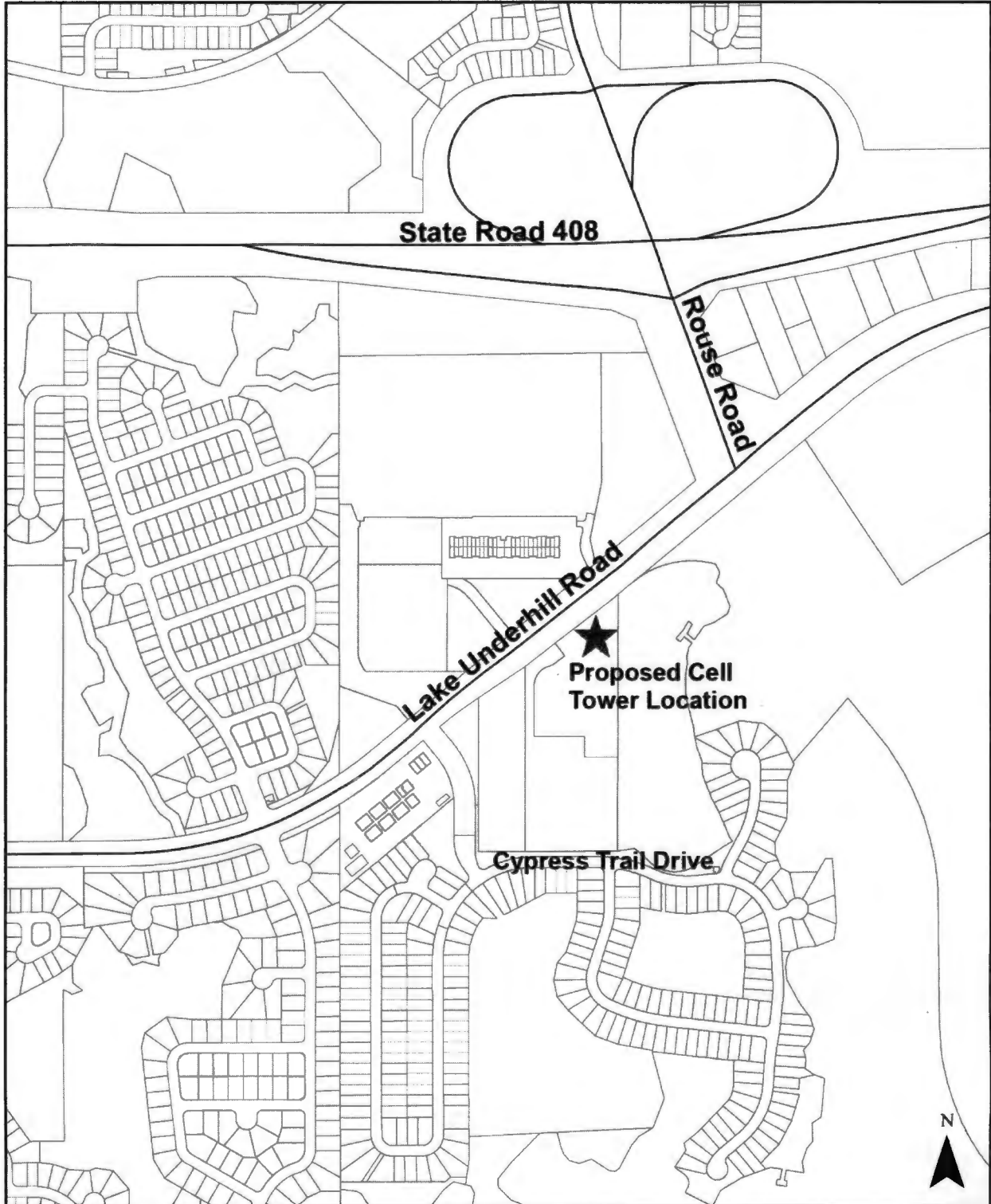

**If you have any questions
regarding this map, please call
John Smogor at 407-836-5616.**

Butte PD

CDR-17-04-127

Legal Description

COMM SW COR OF SW1/4 OF SW1/4 RUN E 872.96 FT FOR POB TH N 866.97 FT TH N 56 DEG E 2.79 FT TH N 52 DEG E 500.40 FT N 50 DEG E 47.59 FT TH S 1201.68 FT W 433.68 FT TO POB IN SEC 28-22-31 & (LESS A PORTION OF THE EAST 1/2 OF THE SW 1/4 OF THE SW 1/4 SEC 28-22-31 DESC: COMM AT THE SW CORNER SEC 28-22-31 TH N89-56-04E ALONG THE SOUTH SECTION LINE 872.96 FT TO THE POB TH N00-00-12E 866.97 FT TH N56-06-34E 2.79 FT TH N52-41-22E 173.13 FT TH S37-18-38E 73.5 FT TH S52-41-22W 49.1 FT TO A POC CONCAVE NWLY HAVING A RADIUS 130.5 FT DELTA 19-37-06 AN ARC LENGTH 44.68 FT TO A PRC CONCAVE SELY HAVING A RADIUS 93.5 FT DELTA 72-18-16 AN ARC LENGTH 117.99 FT TH S00-00-12W 333.65 FT TH S89-59-46E 393.88 FT TH S00-09-37W 441.49 FT TH S89-56-04W 433.68 FT TO THE POB PER DOC# 20160115373) & (LESS COMM AT SW COR OF SW1/4 OF SW1/4 SEC 28-22-31 FOR PT OF REF TH RUN N89-56-04E 872.96 FT TO PT LYING ON W LINE OF LANDS DESC IN DOC # 20160115373 TH DEPARTING SAID S LINE RUN N 00-00-12E 538.94 FT ALONG SAID W LINE TH DEPARTING SAID W LINE RUN N90-00-00E 41 FT TO POB TH CONT N90-00-00E 237.20 FT TH RUN S00-00-14W 96.96 FT TO PT LYING ON S LINE AS DESC IN 20170216641 TH RUN N89-59-46W 237.20 FT TO SW COR OF SAID LANDS TH RUN N00-00-12E 96.94 FT ALONG W LINE OF SAID LANDS TO POB PER 20170584644)