

OK



## Interoffice Memorandum

**DATE:** November 26, 2018

**TO:** Katie A. Smith, Deputy Clerk of the  
Board of County Commissioners,  
County Comptroller's Office

**THROUGH:** Cheryl Gillespie, Supervisor,  
Agenda Development Office

**FROM:** Alberto A. Vargas, MArch., Manager,  
Planning Division

**CONTACT PERSON:** Eric Raasch, Interim DRC Chairman  
Development Review Committee  
Planning Division  
(407) 836-5523 or Eric.RaaschJr@ocfl.net

**SUBJECT:** Request for Board of County Commissioners  
(BCC) Public Hearing

EPR

---

**Case Information:** Timber Creek Relief High School Planned  
Development / Land Use Plan (PD/LUPA) - Case  
# LUPA-18-09-287

**Type of Hearing:** Land Use Plan Amendment

**Applicant:** Julie C. Salvo, Orange County Public Schools

**Commission District:** 5

**General Location:** Generally located south of E. Colonial Drive, west  
of Story Partin Road, and north of Hamilton Drive.

**BCC Public Hearing  
Required by:** Orange County Code, Chapter 30

January 8, 2019  
@ 2pm

**Clerk's Advertising  
Requirements:**

(1) At least 15 days before the BCC public hearing date, publish an advertisement in the Legal Notices section of *The Orlando Sentinel* describing the particular request, the general location of the subject property, and the date, time, and place when the BCC public hearing will be held;

and

(2) At least 10 days before the BCC public hearing date, send notices of BCC public hearing by U.S. mail to owners of property within 300 feet of the subject property and beyond.

**Spanish Contact Person:**

IF YOU HAVE ANY QUESTIONS REGARDING THIS NOTICE, CONTACT THE ORANGE COUNTY PLANNING DIVISION: Front desk, 407-836-8181

PARA MÁS INFORMACIÓN, REFERENTE A ESTA VISTA PUBLICA CON RESPECTO A UNA AUDENCIA PUBLICA SOBRE PROPIEDAD EN SU AREA/VECINDAD, FAVOR COMUNICARSE CON LA DIVISIÓN DE PLANIFICACION, AL NUMERO, 407-836-8181

**Advertising Language:**

To rezone one (1) parcel containing 15.69 acres from A-2 (Farmland Rural District) to PD (Planned Development District), incorporate the property into the Timber Creek Relief High School PD, and develop athletic practice fields on the subject property. No waivers are associated with this request.

**Material Provided:**

- (1) Names and last known addresses of property owners within 300 feet and beyond (*via email from Fiscal and Operational Support Division*); and
- (2) Location map (*to be mailed to property owners*).

**Special instructions to the Clerk:**

Please place this request on the next available BCC agenda. Unless stated otherwise, the public hearing should be advertised to begin at 2:00 p.m., or as soon thereafter as the matter may be heard.

**Attachment (location map)**

c: Chris R. Testerman, AICP, Assistant County Administrator  
Jon V. Weiss, Director, Community Environmental Development Services  
Department

If you have any questions  
regarding this map, please call  
Eric Raasch at 407-836-5523.

**LUPA-18-09-287**

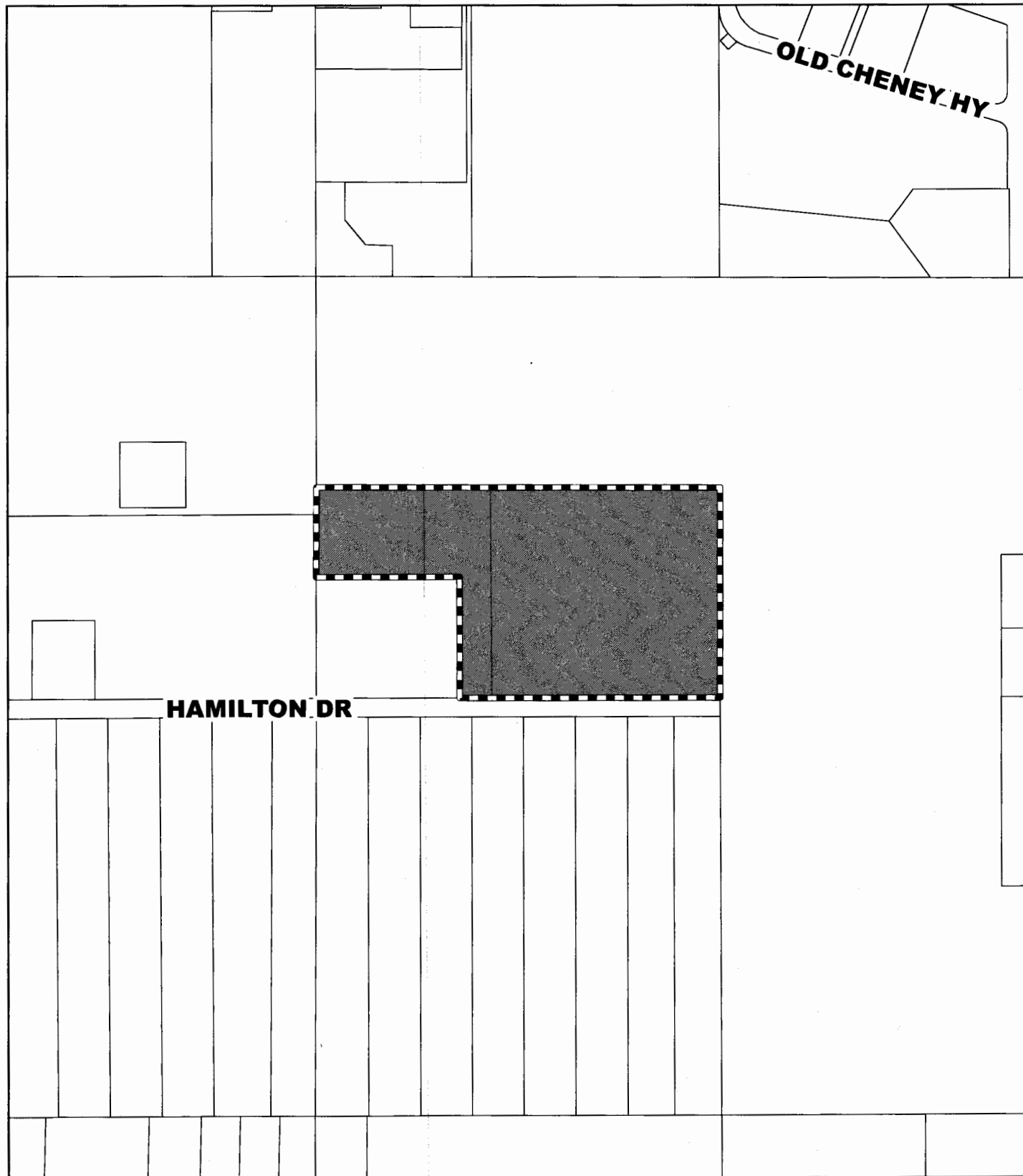

**Subject Parcel**



**1 inch = 417 feet**