



Interoffice Memorandum

02-04-19A10:52 RCVD

02-04-19A11:44 RCVD

qh

January 31, 2019

TO: Katie Smith, Manager
Comptroller Clerk's Office

THROUGH: Cheryl Gillespie, Agenda Development Supervisor
Agenda Development

FROM: David D. Jones, P.E., CEP, Manager
Environmental Protection Division
(407) 836-1405

qh

STAFF PERSON: **Elizabeth R. Johnson, CEP, Assistant Manager
Environmental Protection Division
(407) 836-1511**

SUBJECT: Request for Public Hearing on ~~February 26~~ ^{March 12}, 2019, at 2:00 p.m., for an after-the-fact Shoreline Alteration/Dredge and Fill Permit Application (SADF-17-11-019) for an existing seawall located on Lake Fairview at 1117 Venetian Ave, Orlando, Florida 32804; Parcel ID No. 10-22-29-8828-09-010; District 2

Applicants: Mark and Amy Brown

Type of Hearing: Shoreline Alteration/Dredge and Fill Permit Application

Hearing required by
Florida Statute # or Code: Chapter 15, Article VI, Pumping and Dredging Control

Advertising requirements: Publish once in a newspaper of general circulation in Orange County at least (7) seven days prior to public hearing.

Advertising timeframes: At least (7) seven days prior to public hearing

Abutters to be notified: The applicants and the property owners within 500 feet of the project area will be notified at least seven days prior to public hearing by the Environmental Protection Division (EPD).

Lake Advisory Board
to be notified: N/A

Estimated time required
For public hearing: 2 minutes

LEGISLATIVE FILE # 19-212

March 12,
2019 @ 2pm

January 31, 2019

Request for Public Hearing - After-the-Fact Shoreline Alteration/Dredge and Fill Permit Application (SADF-17-11-019) for Mark and Amy Brown

Page 2

Municipality or other
Public Agency to be
notified:

Florida Department of Environmental Protection–
DEP_CD@dep.state.fl.us

Hearing Controversial: No

District #: 2

Materials being submitted as backup for public hearing request:

1. Site Plan
2. Location Map

Special Instructions to Clerk:

Once the Board of County Commissioners makes a decision on the Shoreline Alteration/Dredge and Fill Permit Application, please submit the decision letter to Michelle Gonzalez with EPD. EPD will issue the decision to the applicants.

Advertising Language:

1. Mark and Amy Brown request an after-the-fact Shoreline Alteration/Dredge and Fill permit to authorize an existing seawall on Lake Fairview pursuant to Chapter 15, Article VI, Section 15-218(d). PID No.: 10-22-29-8828-09-010; District 2 (property legal description on file at EPD).

AW/NT/TMH/ERJ/DJ/gfdjr: mg

Attachments

After-the-Fact Shoreline Alteration/Dredge and Fill Permit Request



**After-the-Fact
Shoreline Alteration/Dredge and Fill
Permit Application Request
District #2**

Applicants: Mark and Amy Brown

Parcel ID: 10-22-29-8828-09-010

**Shoreline Alteration/Dredge and Fill
Permit No.: SADF-17-11-019**

Project Site 

Property Location 



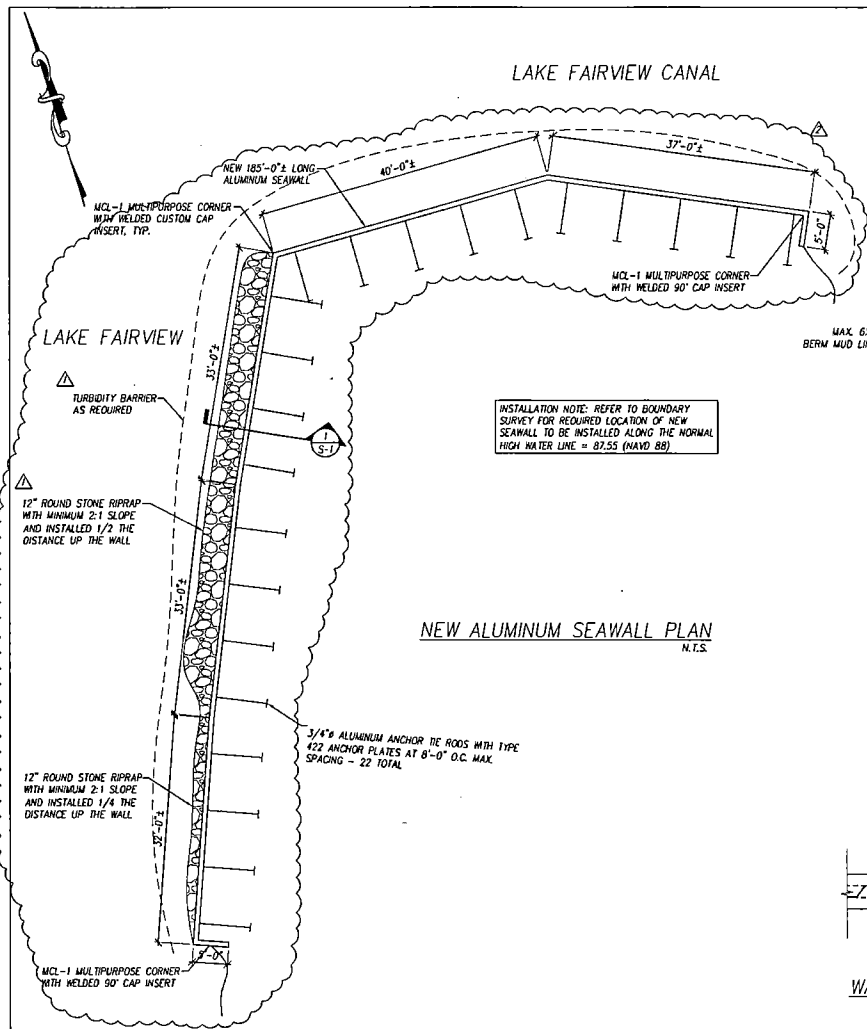

INSTALLATION NOTE: REFER TO BOUNDARY SURVEY FOR REQUIRED LOCATION OF NEW SEAWALL TO BE INSTALLED ALONG THE NORMAL HIGH WATER LINE = 87.55 (NAVD 88)

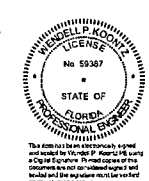
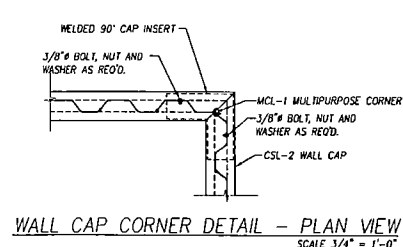
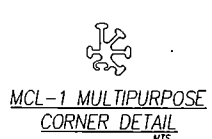
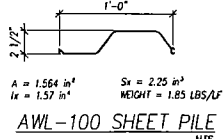
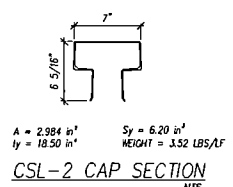
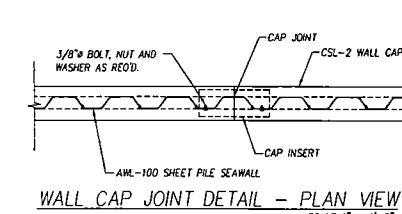
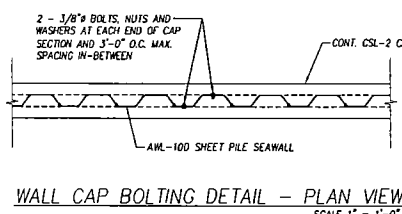
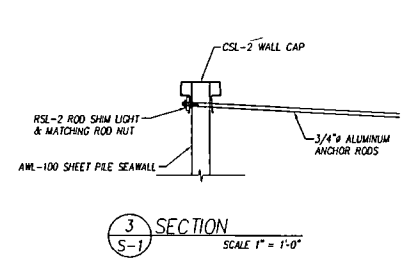
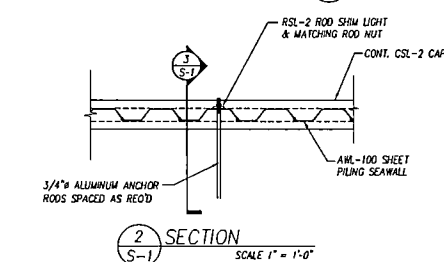
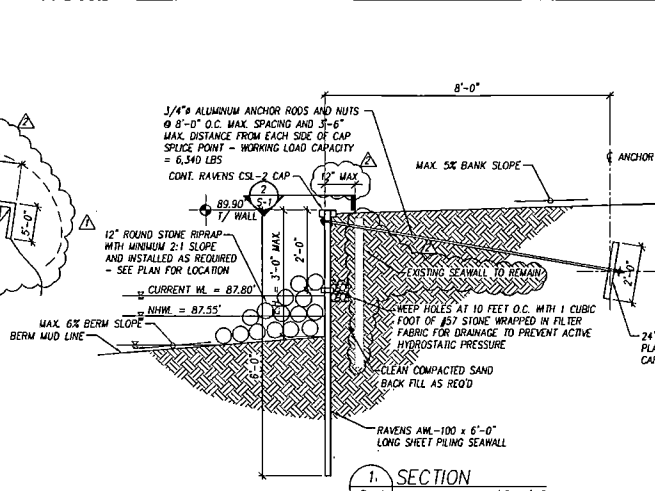

Wendell P Koontz
2018.11.3
0 14:52:54
-05'00'

- GENERAL NOTES:
1. FLORIDA BUILDING CODE, 2014 EDITION; ASCE 7-10; THE ALUMINUM ASSOCIATION SPECIFICATIONS & GUIDELINES, LATEST EDITION.
 2. DESIGN SUBMERGE LOAD = 100 PSE.
 3. ALL SEAWALL MATERIAL IS ALUMINUM ALLOY IS 6061-T6.
 4. ALL ATTACHMENT HARDWARE IS ASTM F959 TYPE 316 STAINLESS STEEL.
 5. USE OF ALUMINUM SEAWALL MATERIAL SHOULD ONLY BE USED WHEN pH LEVELS BETWEEN 4.5 TO 8.5 ARE FOUND IN THE SOIL AND WATER AT THE INTENDED BULKHEAD INSTALLATION LINE. IF MEASURED LEVELS ARE OUTSIDE THE "SAFE" RANGE, THE ALUMINUM SHOULD BE PROTECTED WITH A COAL TAR EPOXY OR OTHER APPROVED EPOXY COATING TO PREVENT CORROSION.
 6. TURBIDITY BARRIER SHALL BE USED TO CONTROL TURBIDITY AND SEDIMENT CONTAMINATION WHEN NECESSARY.
 7. SEAWALL SHEET PILE, CAP AND ANCHOR PLATES ARE MANUFACTURED BY RAVENS MARINE, INC. LOCATED IN KISSIMEE, FLORIDA OR APPROVED EQUAL.
 8. ALL ELEVATION SHOWN ARE REFERENCED FROM FOUNDATION SURVEYOR SUBMITTED BY ATLANTIC SURVEYING, DATED 2/2/2018 AND MANDATORY.
 9. NEW SEAWALL TO BE LOCATED NO MORE THAN 12" IN FRONT OF EXISTING SEAWALL.

REVISIONS	DATE	BY	DESCRIPTION
1	11/29/2018	WPK	GENERAL REVISION
2	7/24/2017	WPK	GENERAL REVISION

STRUCTURAL ENGINEERING SERVICES, INC. (SES)

CONTRACTOR SHALL VERIFY ALL CONDITIONS ON JOB SITE & NOTIFY THE OWNER OF ANY VARIATIONS FROM DIMENSIONS BEFORE PROCEEDING WITH ANY CONSTRUCTION.

SCALE: RETIRED SCALES BASED ON 24"x36" SHEET SIZE

DRAWN BY: WPK

DATE: 7/24/2017

BROWN RESIDENCE
1117 VENETIAN AVE
ORLANDO, FL 32804
NEW ALUMINUM SEAWALL

ALUMINUM SEAWALL PLAN, DETAILS AND NOTES

SHEET TITLE:

DRAWING NO.:

S-1

SHEET: 1 OF 1

Planting Plan: 1117 Venetian Ave., Orlando

X = Pitcher Weed
// = Duck Potato

Lake Fairview Canal

Lake Fairview

