

MISTY WOODS OF ORANGE COUNTY

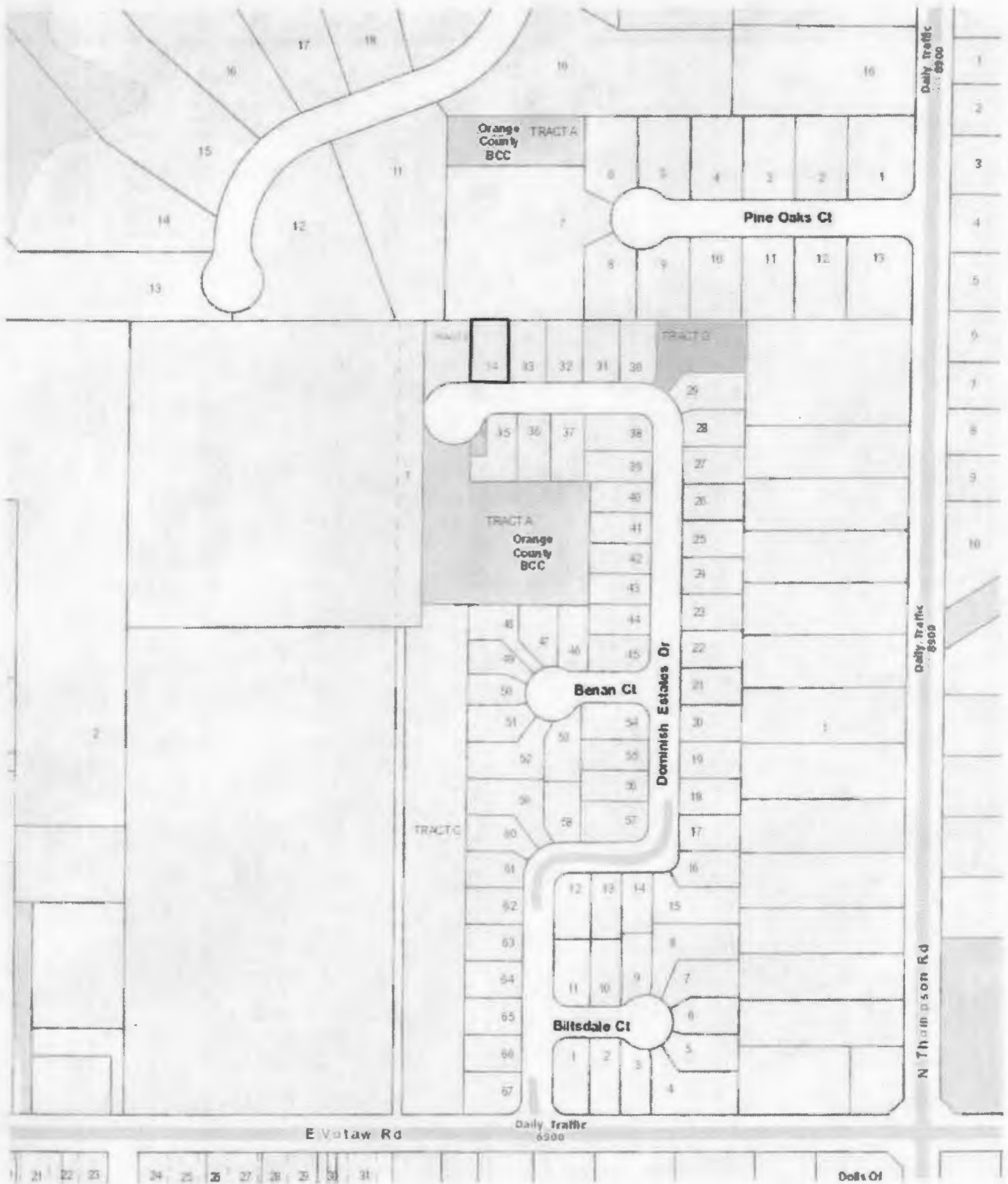

DOUBLE YELLOW REFLECTIVE LINE

2019-05-07 Public Hearing E.10 Exhibit 6 - Carolyn Duncan

20 ' PRIVATE ROAD ACCESS TO VOTAW FROM PARCEL



Carolyn Duncan

From: Carolyn Duncan <carolynd@mmgfl.com>
Sent: Tuesday, May 07, 2019 1:07 PM
To: Carolyn Duncan

